

CUSTOMER DRAWING

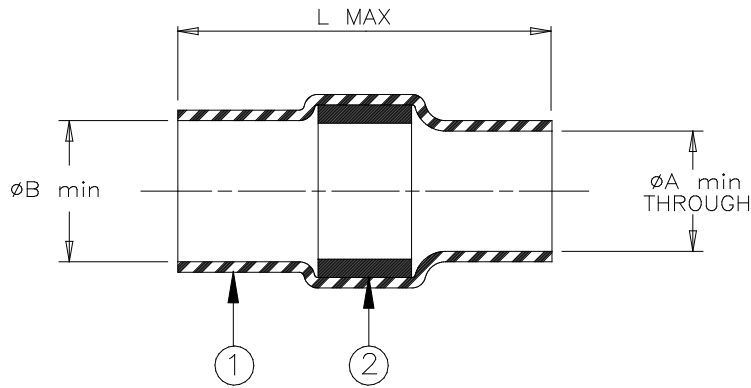

Product Name	Product Dimensions			Cable Dimensions		
	Ø A min	Ø B min	L max	Ø D max	Ø E min	Ø F min
B-005-00	2.8 (0.110)	3.2 (0.125)	31 (1.220)	3.2 (0.125)	1.6 (0.065)	1.5 (0.060)
B-005-01	4.5 (0.180)	5.0 (0.195)	30 (1.180)	5.2 (0.205)	2.3 (0.090)	2.2 (0.085)
B-005-02	7.0 (0.275)	7.6 (0.300)	39 (1.535)	7.6 (0.300)	3.4 (0.135)	3.2 (0.125)

MATERIALS

- INSULATION SLEEVE: Heat-shrinkable, transparent blue, radiation cross-linked modified polyvinylidene fluoride.
- SOLDER PREFORM WITH FLUX:
 - SOLDER: TYPE Sn63 per ANSI-J-STD-006.
 - FLUX: TYPE ROM1 per ANSI-J-STD-004.

APPLICATION

- These controlled soldering devices are designed for termination of a bare copper shield on a cable having an insulation rated for at least +125°C.
- Temperature range: -55°C to +150°C.
- For application tooling, consult your local TE Connectivity/Raychem technical service.

For best results, prepare the cable as shown:

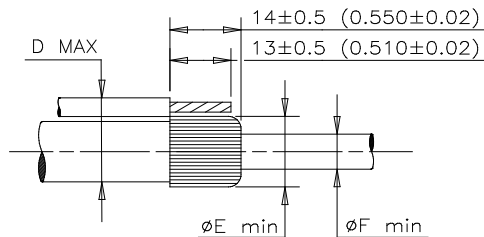

The cable shield should be folded back over the jacket and trimmed to the length as shown.

		Raychem THERMOFIT DEVICES	TITLE: SOLDERSLEEVE * SHIELD TERMINATOR			
Unless otherwise specified dimensions are in millimeters. [Inches dimensions are shown in brackets]			DOCUMENT NO.: B-005-00/ -01/ -02			
TOLERANCES: 0.00 N/A 0.0 N/A 0 N/A	ANGLES: N/A ROUGHNESS IN MICRON	TE Connectivity reserves the right to amend this drawing at any time. Users should evaluate the suitability of the product for their application.	REV : 6	DATE : 17-APR-2020		
DRAWN BY: M. FORONDA	DATE: 6-Nov-98	ECO: ECO-20-005247	SCALE: NTS	SIZE: A	SHEET: 1 of 1	

© 2020 TE Connectivity Ltd. Family of Companies. All Rights Reserved.

If this document is printed it becomes uncontrolled. Check for the latest revision.

*TE Connectivity, TE connectivity (logo), Raychem, THERMOFIT, SolderSleeve are trademarks