

PAGE 1/3	ISSUE 30-06-15A	SERIES ACC-COAX	PART NUMBER R280220027
----------	-----------------	-----------------	------------------------

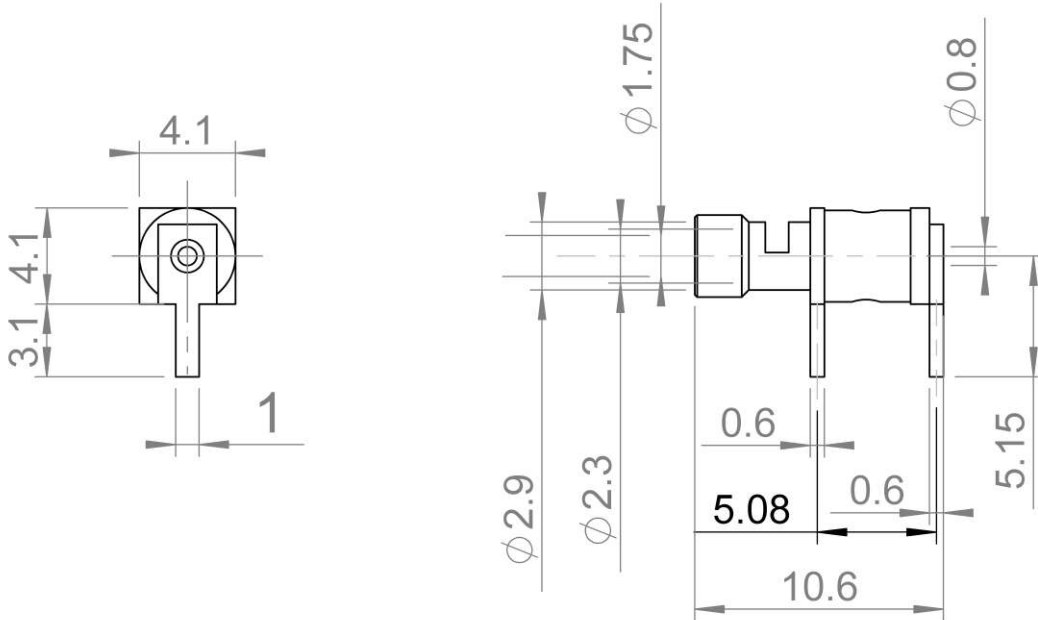

PANEL CUT OUT

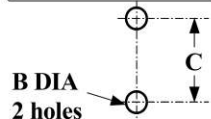

	mm	
	Maxi	mini
B	1.5	1.4
C	5.13	5.03

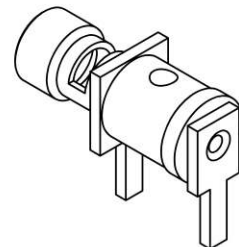
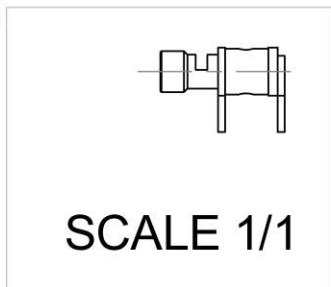

All dimensions are in mm.

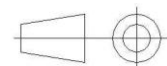

COMPONENTS	MATERIALS	PLATING (μm)
Body	NON MAGNETIC BRONZE	GOLD OVER COPPER
Center contact	NON MAGNETIC BRONZE	GOLD OVER COPPER
Outer contact		
Insulator	PTFE	
Gasket		
Others parts		
-	-	-
-	-	-

PAGE 2/3	ISSUE 30-06-15A	SERIES ACC-COAX	PART NUMBER R280220027
----------	-----------------	-----------------	------------------------

PACKAGING

Standard	Unit	Other
100	Contact us	Contact us

ELECTRICAL CHARACTERISTICS

Impedance		50	Ω
Frequency		0-3	GHz
VSWR	NA +	0.000	x F(GHz) Maxi
Insertion loss		NA	√F(GHz) dB Maxi
RF leakage	- (NA	- F(GHz)) dB Maxi
Voltage rating		335	Veff Maxi
Dielectric withstanding voltage		1000	Veff mini
Insulation resistance		1000	MΩ mini

MECHANICAL CHARACTERISTICS

Center contact retention			
Axial force – Mating End		NA	N mini
Axial force – Opposite end		NA	N mini
Torque		0.000	N.cm mini
Recommended torque			
Mating		NA	N.cm
Panel nut		NA	N.cm
Clamp nut		NA	N.cm
A/F clamp nut		0.000	mm
Mating life		0	Cycles mini
Weight		0.49	g

ENVIRONMENTAL

Operating temperature	-55/+155	°C
Hermetic seal	NA	Atm.cm3/s
Panel leakage	NA	

SPECIFICATION

CABLE ASSEMBLY

Stripping	a	b	c	d	e	f
mm	3	3	9.5	0	3.5	0

Assembly instruction:

Recommended cable(s)

NON MAGNETIC CABLE
RG 179 AMAG
RG 316 AMAG

Characteristics indicated on this data sheet are those that can be achieved with the highest performance cable. Intrinsic limitations of the cable may diminish the performance of the assembly

Cable retention

- pull off	120	N mini
- torque	NA	N.cm

TOOLING

Part Number	Description	Hexagon

OTHER CHARACTERISTICS

Distorsion of the magnetic field
<0.5 ppm at 10mm at Bo=1.5 Tesla
Non magnetic component

PAGE 3/3	ISSUE 30-06-15A	SERIES ACC-COAX	PART NUMBER R280220027
----------	-----------------	-----------------	------------------------

COMPOSANTS

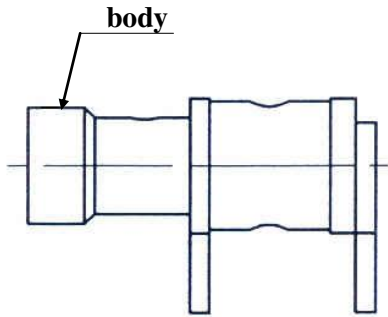

STRIPPING DIMENSIONS

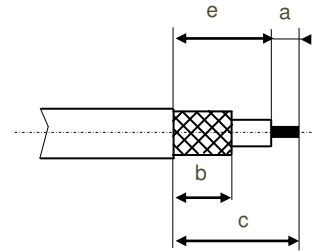

1

Strip the cable

2

Introduce cable into the connector body until contact with it
Solder braid
Solder cable core

