

| REVISIONS | | | | |
|-----------|---------------------------|-----------|-----|------|
| REV | DESCRIPTION | DATE | OWN | APVD |
| P3 | REVISED PER ECR-21-118795 | 28JUL2022 | SK | VS |

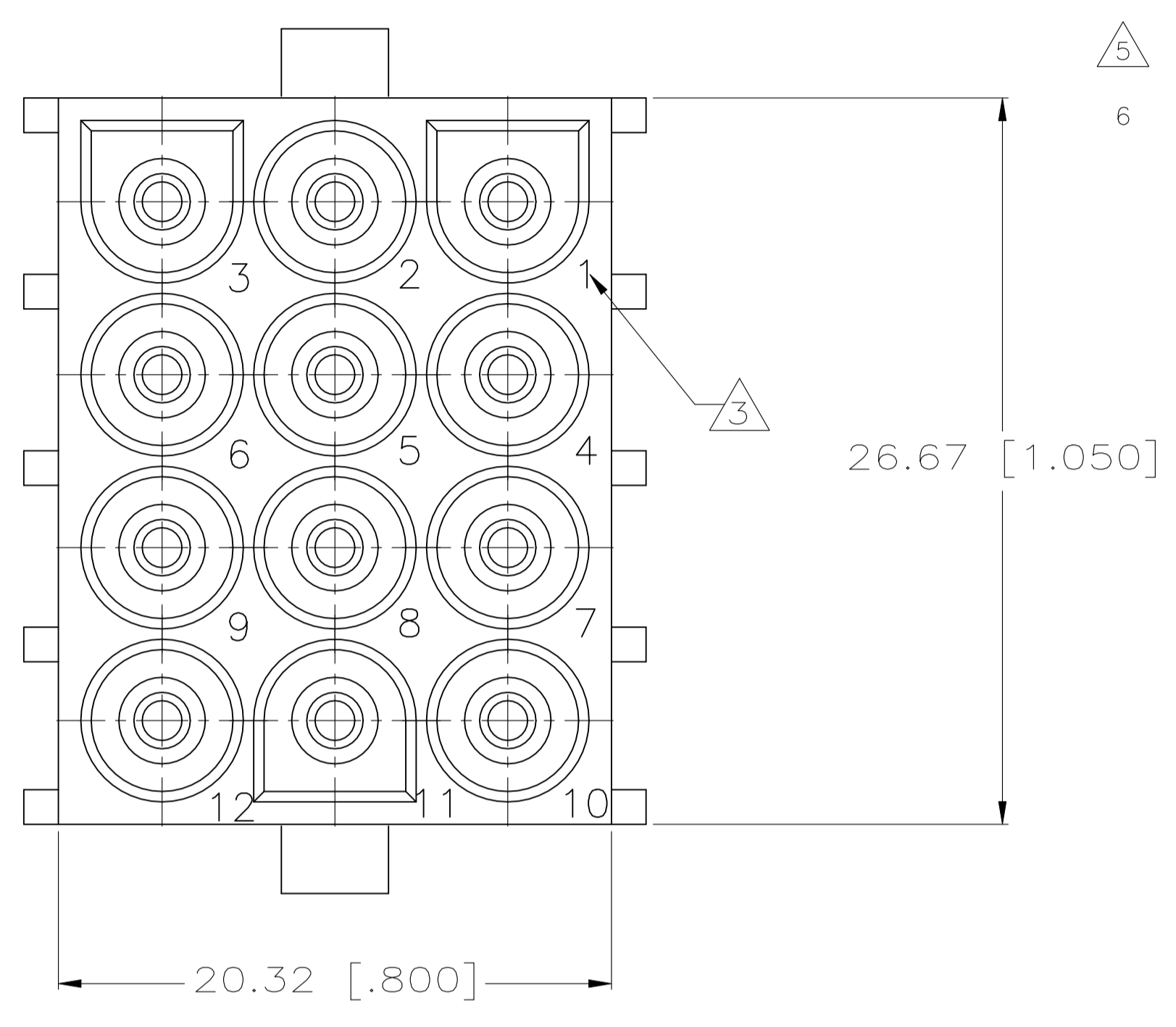

- 1 PARTS MUST COMPLY WITH AMP SOLDERABILITY SPEC 109-11-3.
- 2 CONTACT IS STAMPED FROM PRE-PLATED STOCK WHICH IS PLATED OVERALL WITH 0.00127 [.000050] NICKEL, THEN STRIPED WITH 0.00076 [.000030] GOLD IN CONTACT AREA INDICATED AND TIN-LEAD ON SOLDER TAIL END.
- 3 CIRCUIT IDENTIFICATION CHARACTERS ARE ADJACENT TO THE INDICATED CAVITIES, BUT LOCATION AND ORIENTATION MAY DIFFER FROM PRINT.
- 4 CONTACT IS PLATED OVERALL WITH 0.00127 [.000050] NICKEL, THEN 0.00076 [.000030] GOLD OVER CONTACT LENGTH INDICATED AND MATTE TIN ON SOLDER TAIL END.
- 5 SUPERSEDED BY 350764-5
- 6 DIMENSIONS WITH REPRESENT PRODUCT IN DRY CONDITION. ADDITIONAL 2% GROWTH DUE TO END USE LOCATION MOISTURE ABSORPTION MAY OCCUR AND SHOULD BE ACCOUNTED FOR.

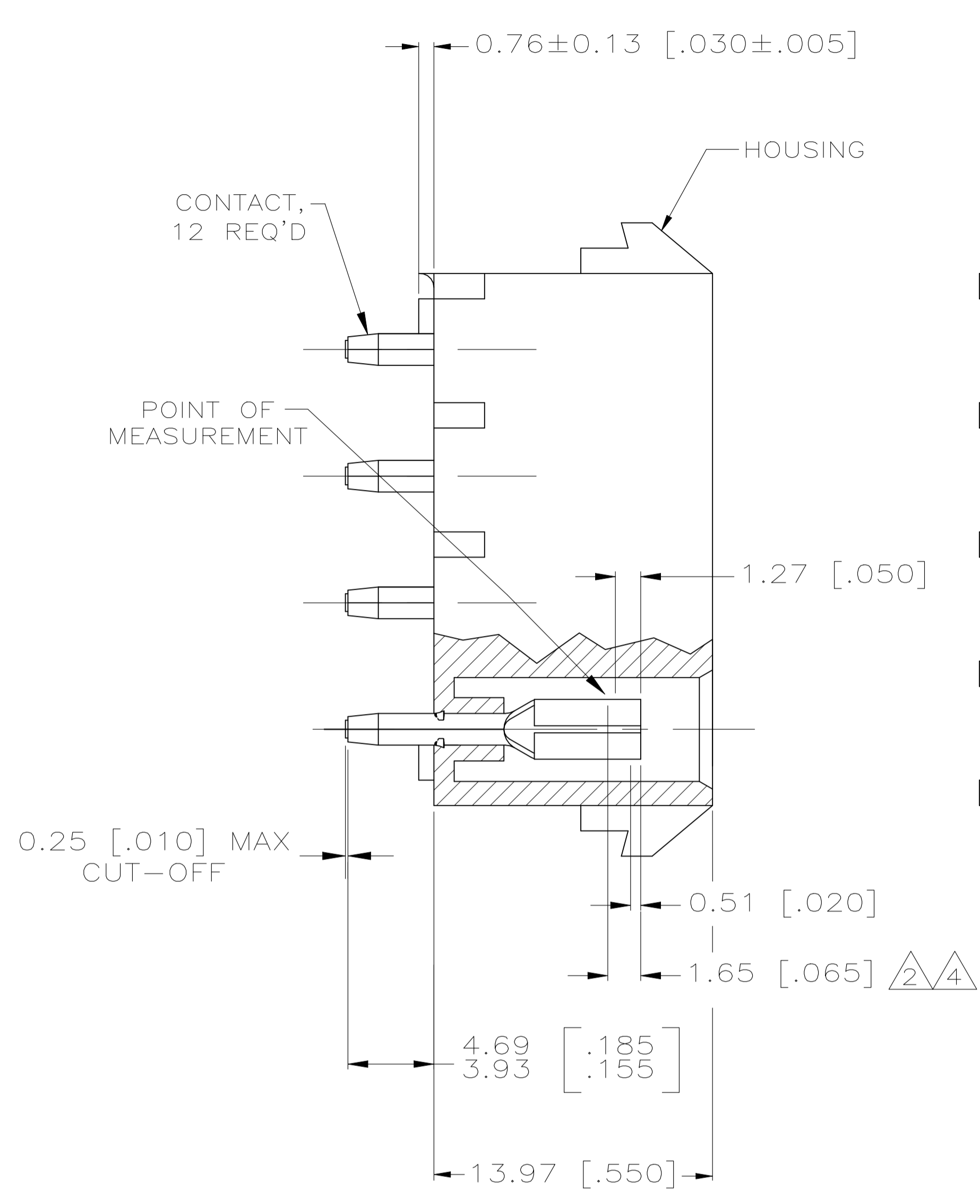
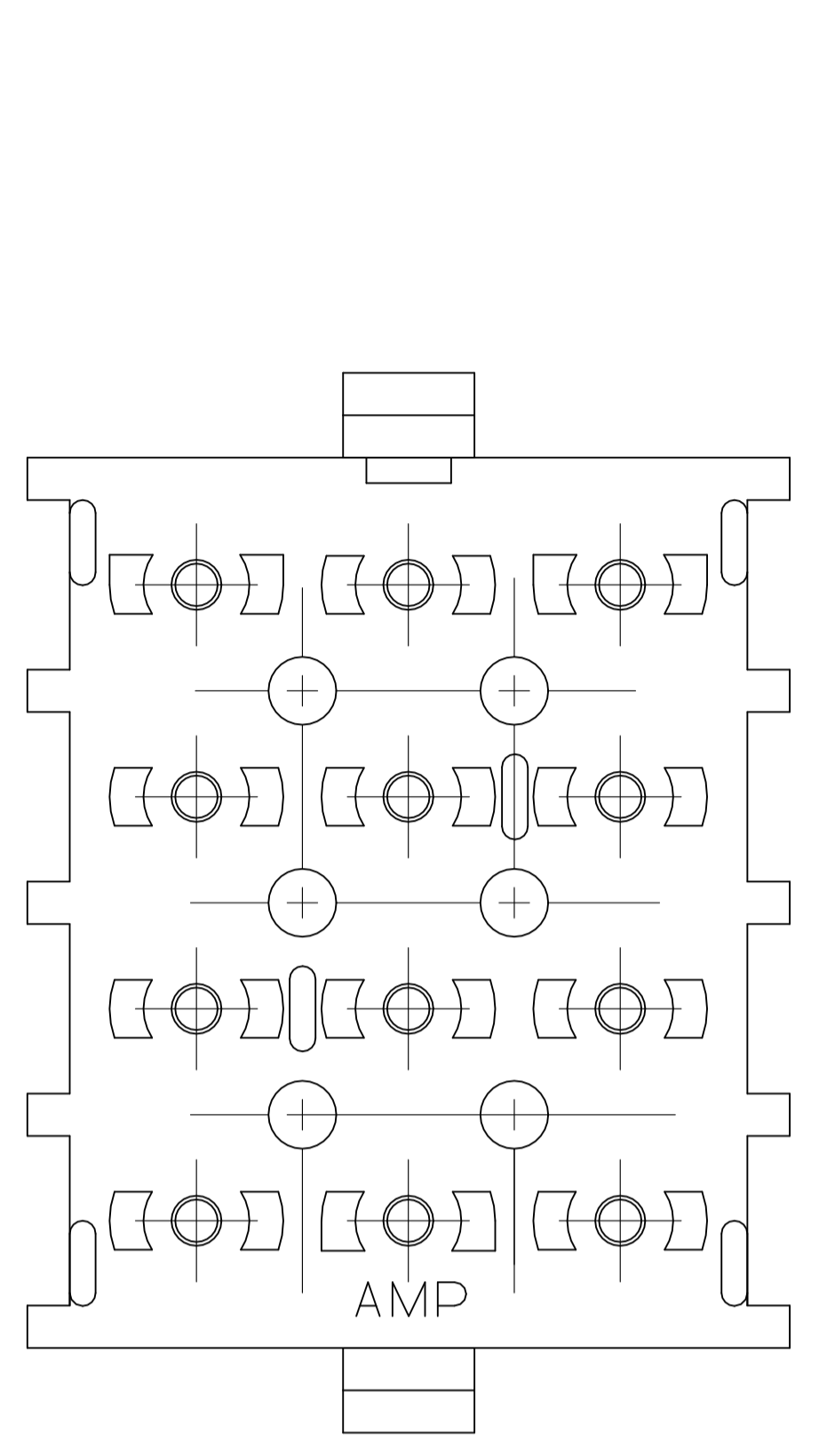
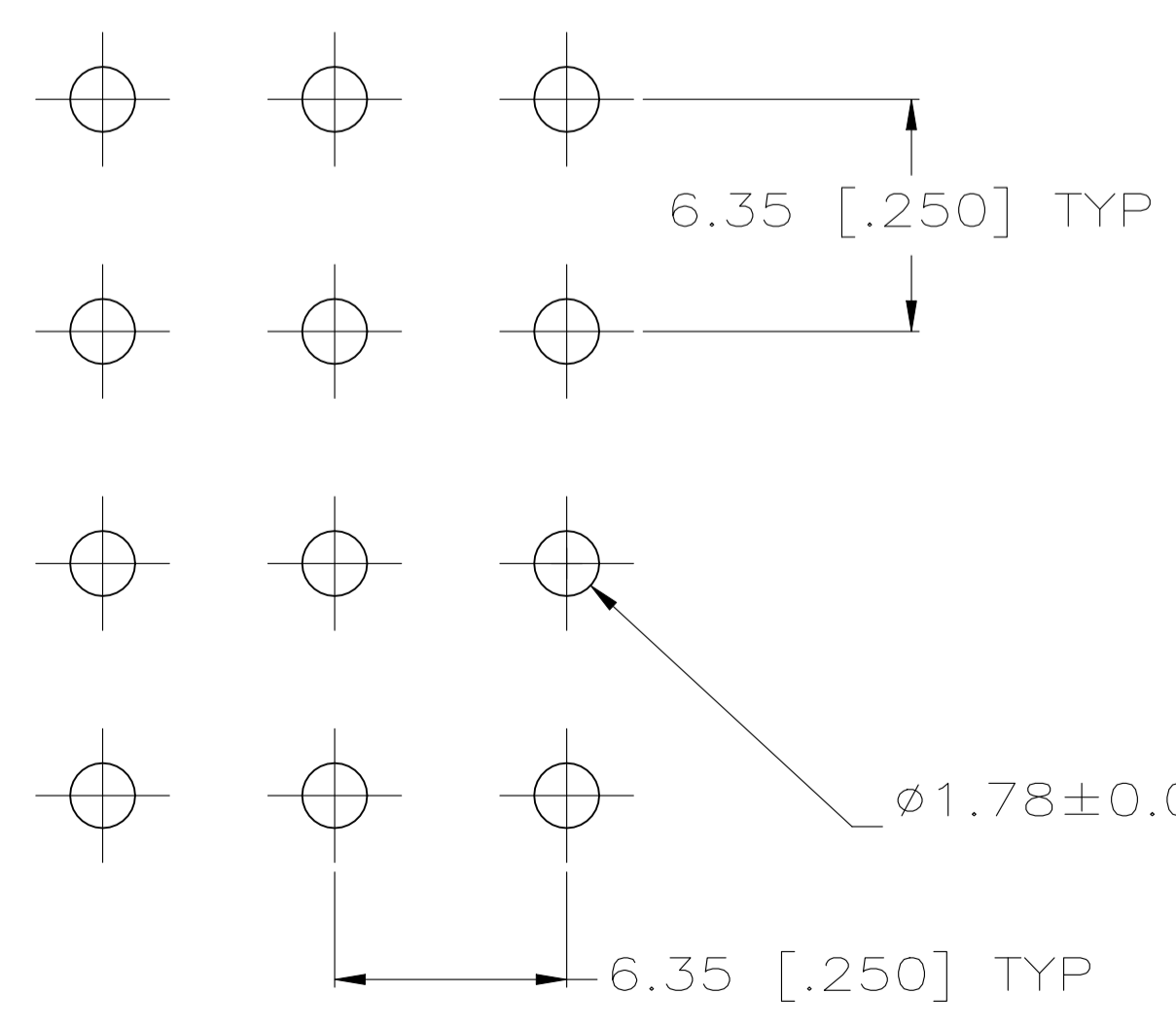

RECOMMENDED LAYOUT FOR 1.58 [.062] THICK PC BOARD

| | | |
|---------------|----------------|----------|
| PH BRZ GOLD 4 | NYLON, NATURAL | 350764-5 |
| PH BRZ TIN | NYLON, NATURAL | 350764-4 |
| PH BRZ GOLD 2 | NYLON, NATURAL | 350764-3 |
| CONTACT | HOUSING | PART NO |

| | | | |
|---|-------------------|--|---------------------|
| THIS DRAWING IS A CONTROLLED DOCUMENT. | | OWN: K. WHITAKER 11OCT2005 | TE Connectivity |
| DIMENSIONS: mm [INCHES] | | CHK: S. RIDGILL 11OCT2005 | |
| TOLERANCES UNLESS OTHERWISE SPECIFIED: | | APVD: S. RIDGILL 11OCT2005 | |
| 0 PLC ± 1 PLC ± 2 PLC ± 3 PLC ± 0.13 [.005] 4 PLC ± | | NAME: 12 CIRCUIT UNIVERSAL MATE-N-LOK (TM) P.C. BOARD SOCKET HEADER ASSEMBLY | |
| MATERIAL: SEE TABLE | FINISH: SEE TABLE | APPLICATION SPEC: -- | RESTRICTED TO: -- |
| WEIGHT: 0.000000 | | SIZE: A1 | CAGE CODE: 00779 |
| CUSTOMER DRAWING | | SCALE: 5:1 | DRAWING NO: 350764 |