

5

4

3

2

1

Mating face according to : MIL-C-24308 / DIN 41652 / CECC 75301-802

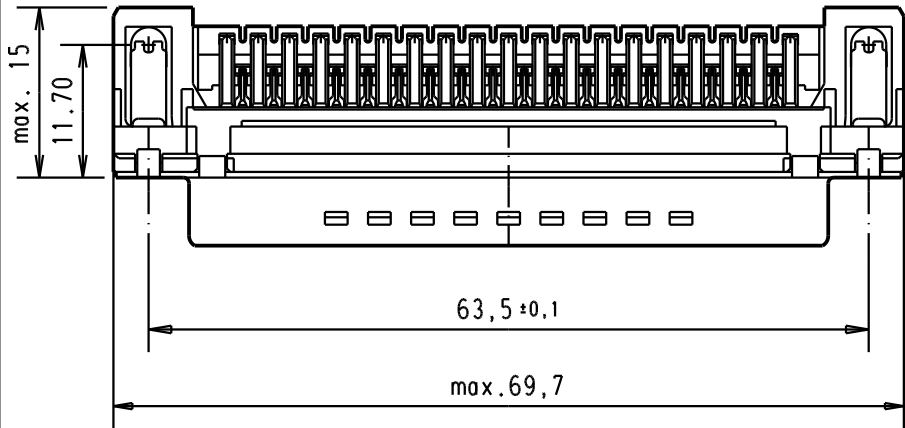
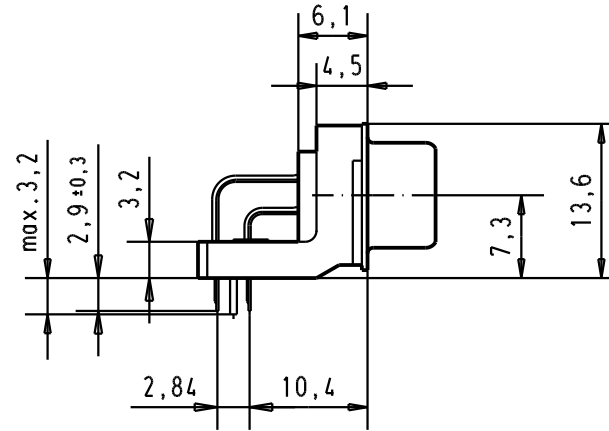
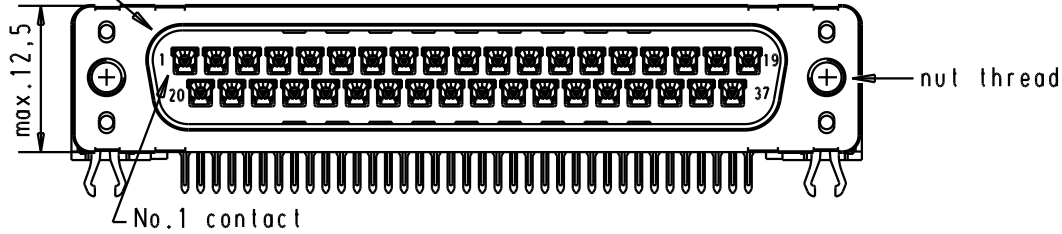

PCB layout hole component side

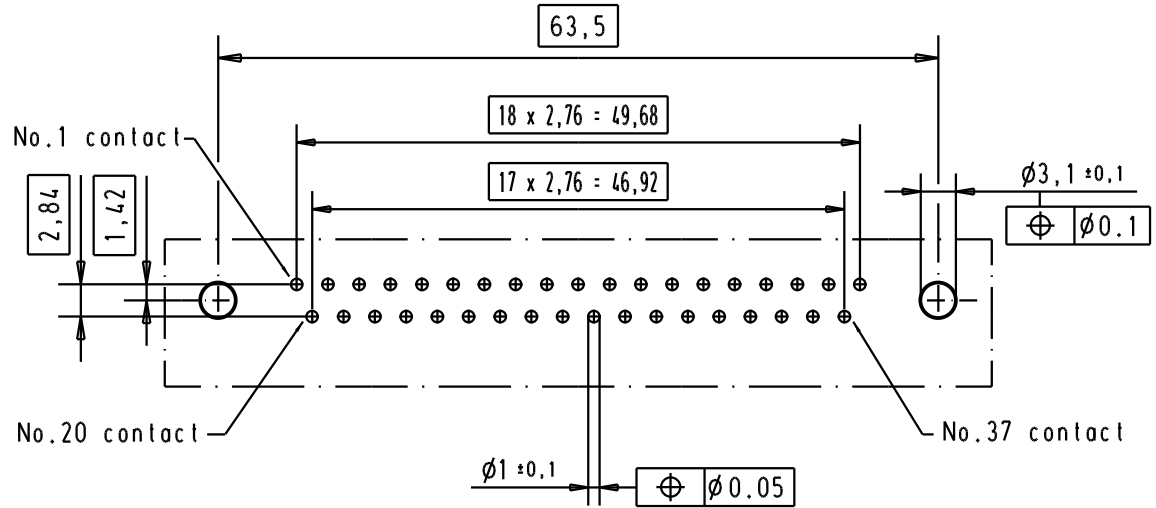

Connector retention and insertion forces on the PCB = 25 / 80 newtons

| | | | | | | | | | | | | |
|---|----------------|------------|-------------------|-------|-----------|---------|-------------------------------|-----------|--|--|----------------------------|---------|
| A | 09 65 463 3811 | M3 | 1 | | | | | | <p>All Dim. in mm Orig. Size DIN A 4</p> | D-Sub, male, standard angle, 37 poles, with solder pin, nut and grounding board lock | Maßstab/ Scale 1.5:1 | |
| | 09 65 463 6811 | M3 | 2 | | | | Detail. | 18/dec/00 | | | | ALSPACE |
| | 09 65 463 7811 | M3 | 3 | 31892 | 22/04/04 | JH | Insp. | | | | | |
| | 09 65 463 3812 | 4-40 UNC | 1 | 31084 | 04/09/02 | YT | Stand. | | | | | |
| | 09 65 463 6612 | 4-40 UNC | | 29689 | 03/07/01 | AA | | | | | | |
| | 09 65 463 7812 | 4-40 UNC | | 27960 | 18/dec/00 | ALSPACE | | | | | | |
| | Part number | Nut thread | Performance level | Mod. | Dat. | Name | HARTING EURL F-95972 Paris | | | TB 0965463x81x | Blatt/ Page 2 | |
| | | | | | | | | | | | | Sub. |