

LOADING PATTERN MATING SIDE

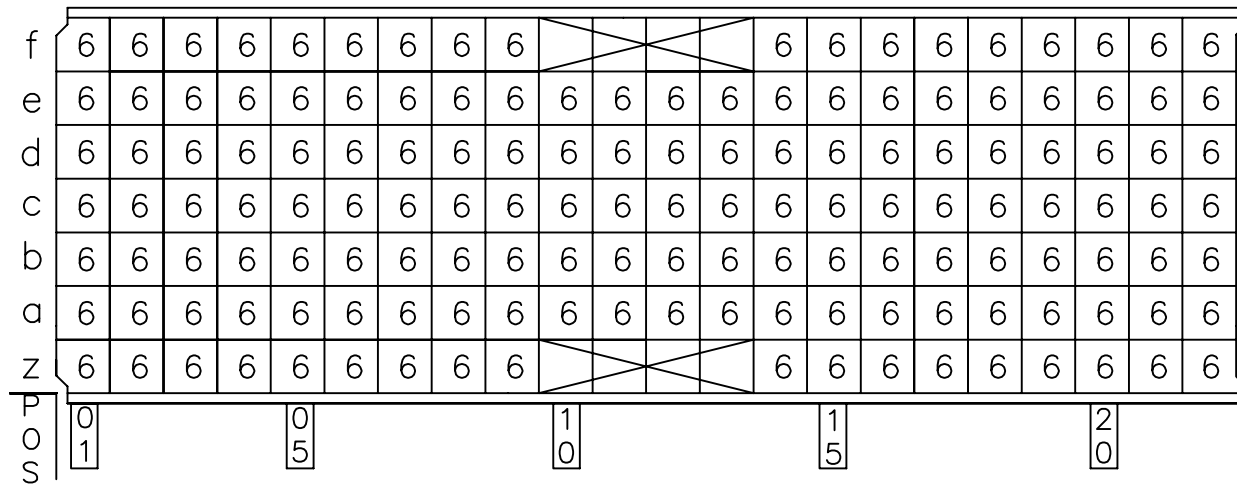

LOADED CONNECTOR ASSEMBLY (FOR EXAMPLE)

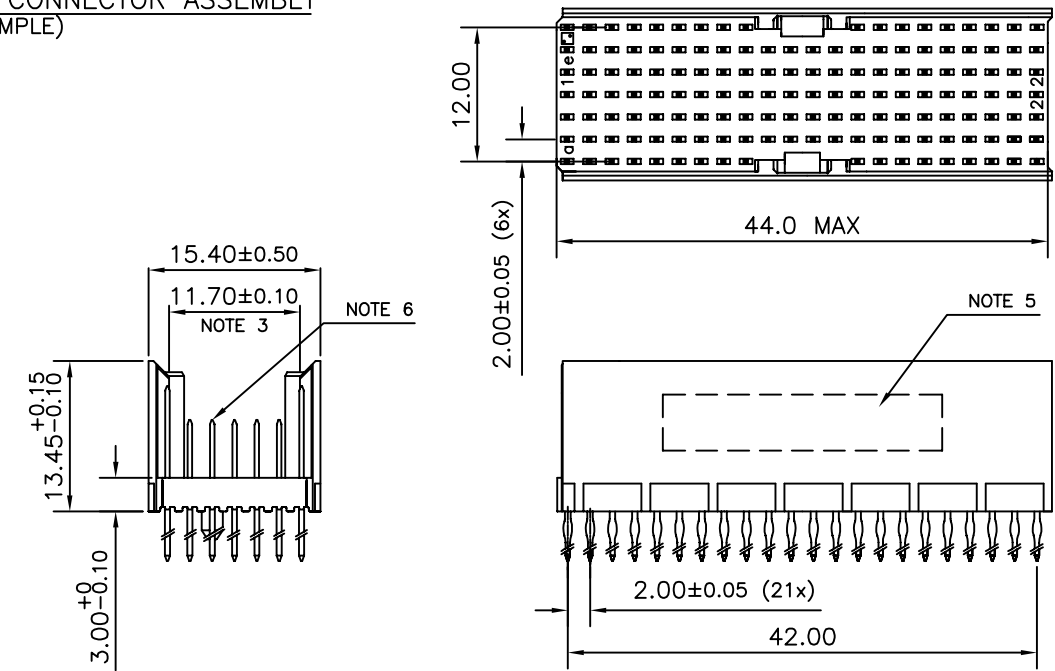

CONTACT OVERVIEW

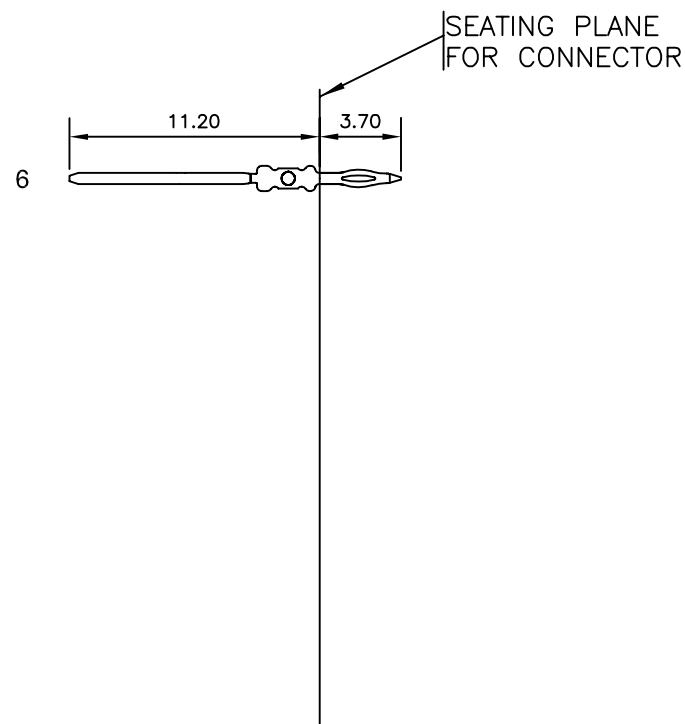

LAY-OUT P.C.B.-HOLE

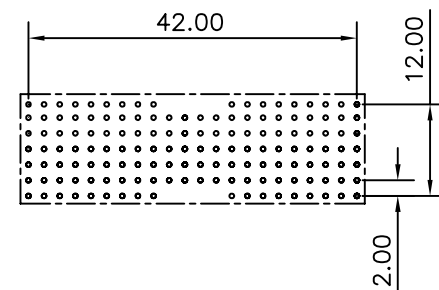

HM2P66PDH321 LEAD FREE INDICATOR : LF = LEAD FREE (DIGIT 15 & 16)

PLATING CODE (DIGIT 13 AND 14) (REF DRW NO. BS,C , 201844 , 003)

NOTES

- THIS PRODUCT IS CSA APPROVED.
- THIS PRODUCT IS UL RECOGNIZED.
- MEASURED AT THE BOTTOM.
- MATERIAL CONTACT: PHOSPHORBRONZE
HOUSING: CREAM WHITE GLASS FILLED POLYESTER UL-94V0
- CONNECTOR PRINTED WITH P/N AND DATE CODE.
- FOR ACTUAL CONTACT LOADINGS, SEE LOADING PATTERN MATING SIDE.
- SHAPE OF CONNECTOR HOUSING CAN ALTER DEPENDING ON PRODUCTION LOCATION
- THE PRODUCT (LF) MEETS EUROPEAN UNION DIRECTIVES AND OTHER COUNTRY REGULATIONS AS DESCRIBED IN GS-22-008
- FOR RECOMMENDED PTH DIMENSIONS REFER DRAWING : BS, A , 201572 , 001

CATALOG NO: HM2P66PDH321----

| | | | | | |
|---------------------------|----------|-----------------------|-------------------------------|--|-----------------------------|
| mat'l. code SEE NOTE 4 | | surface ISO 1302 ✓ | tolerance ISO 406 ISO 1101 | projection MM | product family MILLIPACS |
| ltr | ecn no | dr | date | title | |
| A | 105-0160 | MINI | 2005-09-09 | MPACS 5+2R STR HDR PF CONN TYPE AB 22 POS. | |
| B | 105-0099 | MINI | 2005-07-15 | | |
| | | angles | linear | scale | |
| | | 0°±1° | | | |
| | | dr | MINI K VANDANATH 2005-09-09 | dwg no | |
| | | enr | BIJU K PAUL 2005-09-09 | sheet 1 of 1 | |
| | | chr | BIJU K PAUL 2005-07-15 | size | |
| | | appd | BIJU K PAUL 2005-07-15 | A3 | |
| sheet index | | revision | B | type Product Customer Drawing | |
| | | sheet | 1 | | |