

REVISIONS				
P	LTR	DESCRIPTION	DATE	APPV
G4		REVISED PER ECO-22-160714	27JUN2022	MP JK

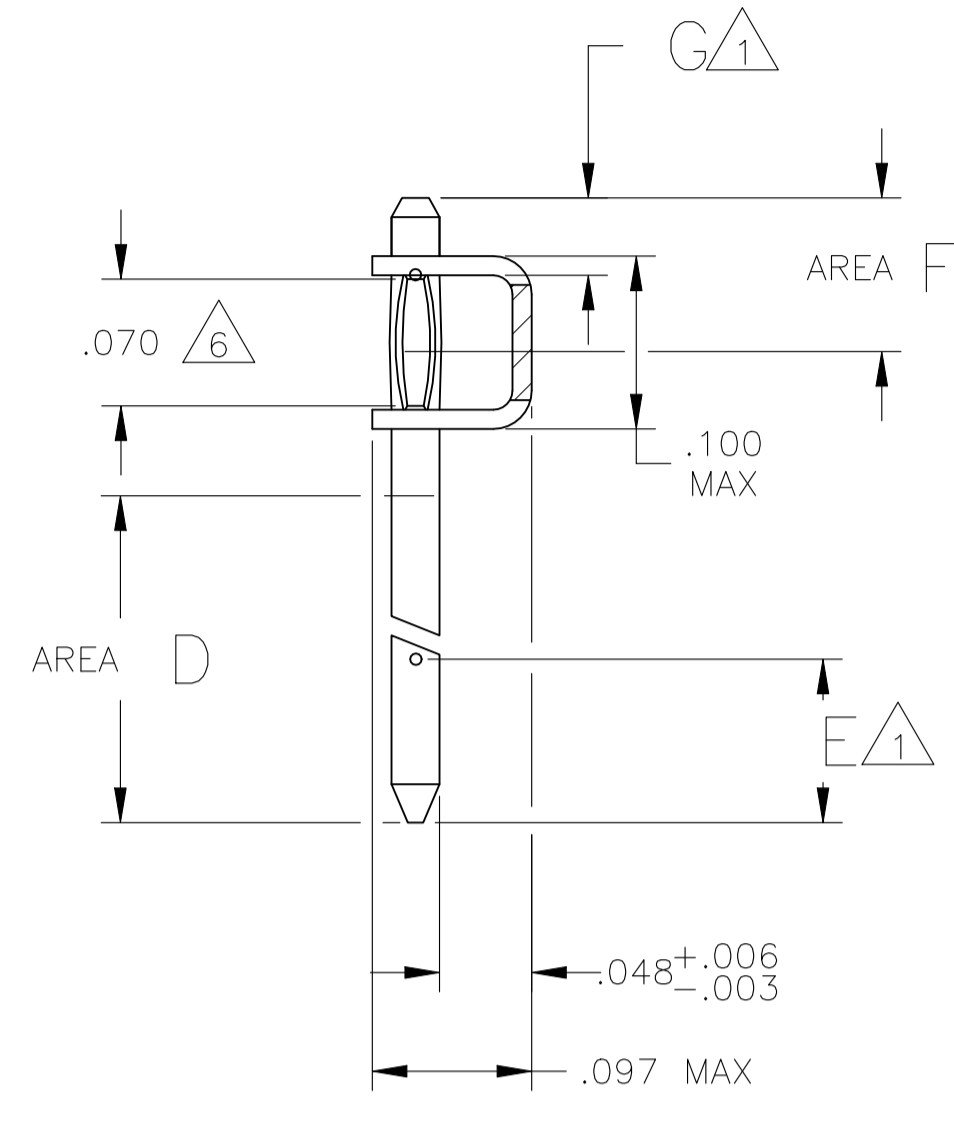
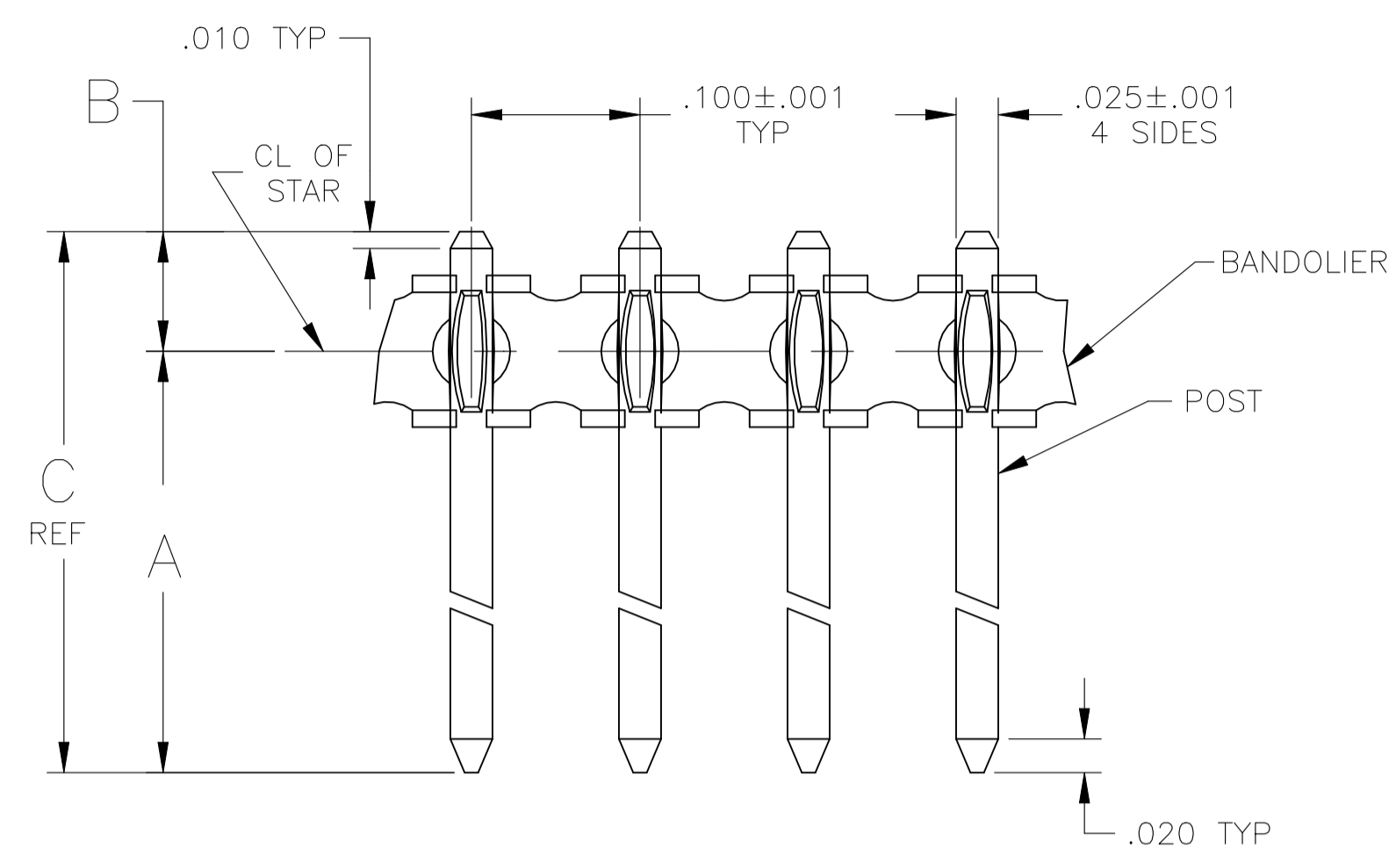

1 POINT OF MEASUREMENT FOR PLATING THICKNESS

2 .000030 GOLD ON AREA D, .000100 - .000200 MATTE TIN-LEAD ON AREA F, ALL OVER .000050 - .000100 NICKEL ENTIRE POST

3 .000100 - .000200 BRIGHT TIN-LEAD OVER .000050 - .000100 NICKEL ENTIRE POST

4. RECOMMENDED P.C.BOARD HOLE SIZE:

P C BOARD THICKNESS	PLATED HOLE SIZE	UNPLATED HOLE SIZE
.062	.034±.002	.036±.002
.093	.034±.002	.036±.002
.125	.034±.002	.036±.002

5 .000015 GOLD ON AREA D, .000100 - .000200 MATTE TIN-LEAD ON AREA F, ALL OVER .000050 - .000100 NICKEL ENTIRE POST.

6 DIMENSION PERTAINS TO THE LENGTH OF THE INTERFERENCE AREA OF THE STAR.

7 PRELIMINARY PART - NOT RELEASED FOR PRODUCTION.

8 .000030 GOLD ON AREA D, .000100-.000200 MATTE TIN ON AREA F. ALL OVER .000050 - .000100 NICKEL ENTIRE POST.

9 .000100-.000200 MATTE TIN OVER .000050 - .000100 NICKEL ENTIRE POST.

10 .000015 GOLD ON AREA D, .000100-.000200 MATTE TIN ON AREA F, ALL OVER .000050 - .000100 NICKEL ENTIRE POST.

11 ROHS 2002/95/EC COMPLIANT.

12 OBSOLETE PARTS: OBSOLETE CIS STREAMLINING PER D.RENAUD/D.SINISI

		.245	10	.015	.080	.080	.230	.451	.071	.380	11	6-103577-9	
12	OBSOLETE	.235	10	.015	.080	.100	.185	.341	.071	.270	11	6-103577-7	
		.283	10	.015	.080	.100	.185	.389	.071	.318	11	6-103577-5	
12	OBSOLETE	.318	10	.015	.080	.100	.200	.424	.071	.353	11	6-103577-3	
		.235	9	-	-	-	-	.341	.071	.270	11	6-103577-1	
12	OBSOLETE	.283	9	-	-	-	-	.389	.071	.318	11	5-103577-9	
12	OBSOLETE	.318	9	-	-	-	-	.424	.071	.353	11	5-103577-7	
		.235	8	.015	.080	.100	.185	.341	.071	.270	11	5-103577-5	
		.283	8	.015	.080	.100	.185	.389	.071	.318	11	5-103577-3	
12	OBSOLETE	.318	8	.015	.080	.100	.200	.424	.071	.353	11	5-103577-1	
		.245	5	.015	.080	.080	.230	.451	.071	.380	11	1-103577-9	
		.235	5	.015	.080	.100	.185	.341	.071	.270	11	1-103577-7	
		.283	5	.015	.080	.100	.185	.389	.071	.318	11	1-103577-5	
		.318	5	.015	.080	.100	.200	.424	.071	.353	11	1-103577-3	
		.235	3	-	-	-	-	.341	.071	.270	11	1-103577-1	
12	OBSOLETE	.283	3	-	-	-	-	.389	.071	.318	11	103577-9	
		.318	3	-	-	-	-	.424	.071	.353	11	103577-7	
		.235	2	.015	.080	.100	.185	.341	.071	.270	11	103577-5	
		.283	2	.015	.080	.100	.185	.389	.071	.318	11	103577-3	
		.318	2	.015	.080	.100	.200	.424	.071	.353	11	103577-1	
		MATING HEIGHT ABOVE BOARD (REF)	FINISH	G	F	E	D	C	B	A		ASSEMBLY PART NUMBER	

THIS DRAWING IS A CONTROLLED DOCUMENT.

DIMENSIONS: INCHES	TOLERANCES UNLESS OTHERWISE SPECIFIED:	DIN G-DOUTY 12AUG87	12SEP87	
0 PLC ± -	1 PLC ± -	2 PLC ± -	3 PLC ± .005	
4 PLC ± -	ANGLES ± -	APPROVED: R.FELICKER 12SEP87	NAME: ASSEMBLY, BANDOLIER, .100 CL, .025 SQUARE POSTS	RESTRICTED TO
MATERIAL: BANDOLIER - BRASS	FINISH: BANDOLIER - NONE	WEIGHT: 0.000000	SIZE: A1	SCALE: 10:1
POST-PHOS BRONZE	POST-SEE TABLE	CUSTOMER DRAWING	00779	SHEET 1 OF 1