

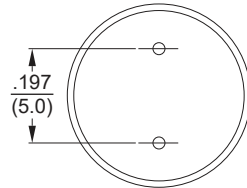
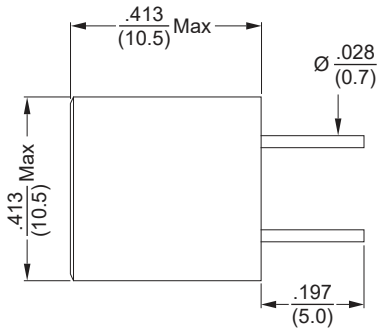

Radial Leaded Shielded Inductor

RBS181

Dimensions: $\frac{\text{inch}}{\text{mm}}$ 

| Allied Part Number | Inductance (mH) | Tolerance ($\pm\%$)* | Q Min. | Q Test Freq (KHz) | SRF Min. (MHz) | DCR Max (Ω). | IDC (mA) |
|--------------------|-----------------|------------------------|--------|-------------------|----------------|-----------------------|----------|
| RBS181-102_ | 1.0 | J,K | 70 | 50 | 0.77 | 3.4 | 90 |
| RBS181-122_ | 1.2 | J,K | 70 | 50 | 0.70 | 3.7 | 75 |
| RBS181-152_ | 1.5 | J,K | 70 | 50 | 0.64 | 4.0 | 70 |
| RBS181-182_ | 1.8 | J,K | 70 | 50 | 0.57 | 4.5 | 65 |
| RBS181-222_ | 2.2 | J,K | 70 | 50 | 0.51 | 5.2 | 60 |
| RBS181-272_ | 2.7 | J,K | 70 | 50 | 0.48 | 5.8 | 55 |
| RBS181-332_ | 3.3 | J,K | 100 | 50 | 0.44 | 6.1 | 50 |
| RBS181-392_ | 3.9 | J,K | 100 | 50 | 0.41 | 7.2 | 45 |
| RBS181-472_ | 4.7 | J,K | 100 | 50 | 0.38 | 7.5 | 40 |
| RBS181-562_ | 5.6 | J,K | 100 | 50 | 0.35 | 8.4 | 40 |
| RBS181-682_ | 6.8 | J,K | 100 | 50 | 0.32 | 9.7 | 35 |
| RBS181-822_ | 8.2 | J,K | 100 | 50 | 0.28 | 10.4 | 30 |
| RBS181-103_ | 10 | J,K | 100 | 50 | 0.25 | 12.1 | 25 |
| RBS181-123_ | 12 | J,K | 100 | 50 | 0.22 | 13.0 | 25 |
| RBS181-153_ | 15 | J,K | 100 | 50 | 0.22 | 15.0 | 20 |
| RBS181-183_ | 18 | J,K | 100 | 50 | 0.19 | 17.0 | 22 |
| RBS181-223_ | 22 | J,K | 100 | 50 | 0.19 | 19.5 | 21 |
| RBS181-273_ | 27 | J,K | 100 | 50 | 0.16 | 22.0 | 18 |
| RBS181-333_ | 33 | J,K | 100 | 50 | 0.16 | 26.0 | 17 |
| RBS181-363_ | 36 | J,K | 100 | 50 | 0.14 | 27.0 | 16 |
| RBS181-393_ | 39 | J,K | 100 | 50 | 0.12 | 45.0 | 15 |
| RBS181-473_ | 47 | J,K | 100 | 50 | 0.12 | 52.0 | 13 |
| RBS181-563_ | 56 | J,K | 100 | 50 | 0.12 | 58.0 | 12 |
| RBS181-683_ | 68 | J,K | 100 | 50 | 0.09 | 67.0 | 11 |
| RBS181-823_ | 82 | J,K | 100 | 50 | 0.09 | 71.0 | 10 |
| RBS181-104_ | 100 | J,K | 100 | 50 | 0.09 | 82.0 | 9 |
| RBS181-124_ | 120 | J,K | 100 | 50 | 0.08 | 97.0 | 8 |

*Insert letter at the end of the part number for desired tolerance J=5%, K=10%
All specifications subject to change without notice

Features

- For R.F. and other applications
- Magnetically Shielded Construction
- Extensive Inductance Range
- RoHS Compliance

Electrical

Inductance Range: 1.0mH - 120mH
Tolerance: *Available in 5% and 10% as indicated
Test Frequency: (L) @1KHZ, Q @ 50KHZ
Operating Temperature: -55°C to +105°C
Rated Current: The current at which the inductance will decrease by no more than 10% from initial value without current

Test Equipment

Inductance: HP4342A & HP4284A
DCR: CH-301 Current Source & DCR Meter
Current: CH-301 Current Source & DCR Meter

Physical

Packaging: 400/Tray
Marking: EIA Inductance code