

RECOMMENDED PCB LAYOUT (TOP VIEW)

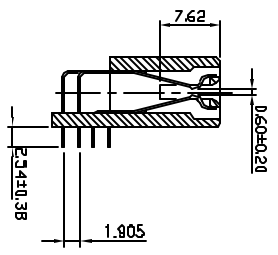

MATERIAL
 INSULATOR: GLASS-REINFORCED THERMOPLASTIC.
 CONTACT: COPPER ALLOY.
 PLATING: MATING AREA - SELECTED GOLD OVER NICKEL.
 SOLDER AREA - TIN/LEAD OVER NICKEL.

ELECTRICAL
 VOLTAGE RATING: 250 VAC RMS.
 CURRENT RATING: 1 AMP.
 DIELECTRIC WITHSTANDING VOLTAGE: 500 VAC RMS 60Hz FOR 1 MINUTE.
 INSULATION RESISTANCE: 1000 MEGOHMS MIN AT 500 VDC.
 CONTACT RESISTANCE: 30 MILLIOHMS MAX.

MECHANICAL
 RETENTION FORCE: 480 GRAMS MIN PER CONTACT.
 INSERTION FORCE: 230 GRAMS MAX PER CONTACT.
 WITHDRAWAL FORCE: 15 GRAMS MIN PER CONTACT PAIR.

ENVIRONMENTAL
 TEMPERATURE RANGE: -55°C TO +85°C.

TOLERANCE		ANGLES		TITLE	
LINEAR	X±0.20	X°.±		64 BIT PCI CONN., 50V TYPE RIGHT ANGLE	
	X±0.15	X°.±		PART NO.	TRWB092DKAN-1750
	.XX±0.10	.XX°.±		DWG NO.	1750
	.XXX±0.05	.XXX°.±			
APPD:	Sullins Electronics				
CHKD:	San Marcos, CA				
DRWN:	www.SullinsElectronics.com				
DATE:	90.06.01	FINISH:			
NAME:	Jason	MAT'L:			
ECN NO.:	0601	QTY:			
REV:	A	UNITS:	MM	SCALE:	2 : 1
		SHEET:	1	OF:	1
		REV:			A