

This document is the property of Amphenol Corporation and is delivered on the express condition that it is not to be disclosed, reproduced or used, in whole or in part, for manufacture or sale by anyone other than Amphenol Corporation without its prior consent, & that no right is granted to disclose or to use any information in this document.

Customer Drawing

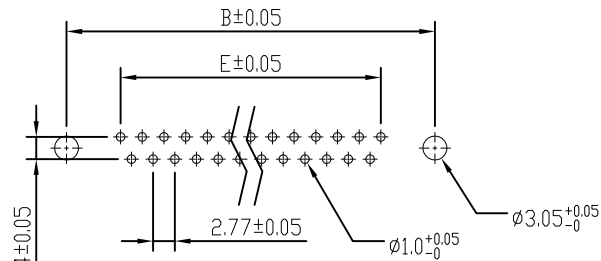

Recommended PCB layout
Tolerance: +/-0.05mm

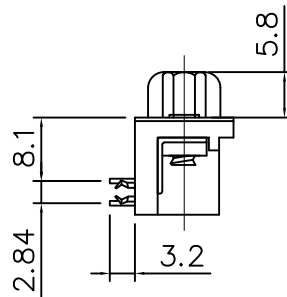
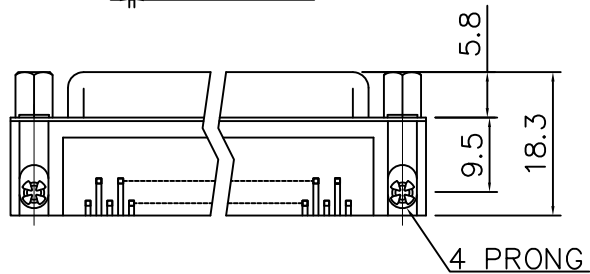
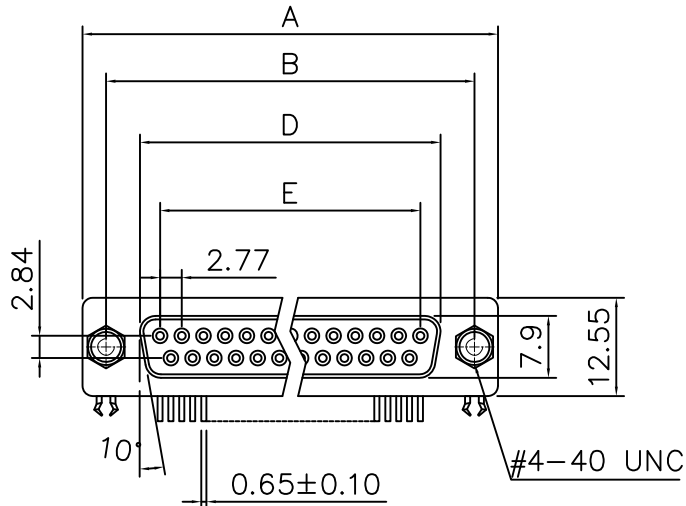

Dimensions

Shell size	Positions	A	B	D	E
E	09	30.81	24.99	16.33	11.08
A	15	39.20	33.30	24.70	19.39
B	25	53.05	47.04	38.40	33.24
C	37	69.40	63.50	54.80	49.86

REVISIONS

SYM	ECN	DESCRIPTION	DATE	APPROVED
1	HK--	First Release Drawing	01/07/08	IP
2	HK--	Update the Drawing	08/01/14	IP
3	HK--	Adding solder pin dimension	04/24/18	IP

D-SUB TECHNICAL DATA

SHELL : Steel, 100u" min tin over 50u" min nickel over 50u" copper
 BODY : PBT, UL 94V-0, Color:Black.
 CONTACTS : Copper Alloy
 Gold flash over 50u" min nickel on mating area
 100u" min tin over 50u" min nickel on solder area
 CLINCH NUT : Brass, Nickel plated
 SCREWLOCK: Brass, Nickel plated
 BOARDLOCK: Brass, Tin plated
 ELECTRICAL : Voltage Rating 250 V Rms Max
 Current Rating 3A
 Withstanding Voltage >1000 V Rms
 Insulation Resistance >1000 M Ohms
 Contact Resistance 20 mOhms max.
 MARKING : Amphenol...(Series No.)
 Commercial reference
 Manufacturing date

PRODUCT CODE

L 77 SD XXX S A4 CH 4F

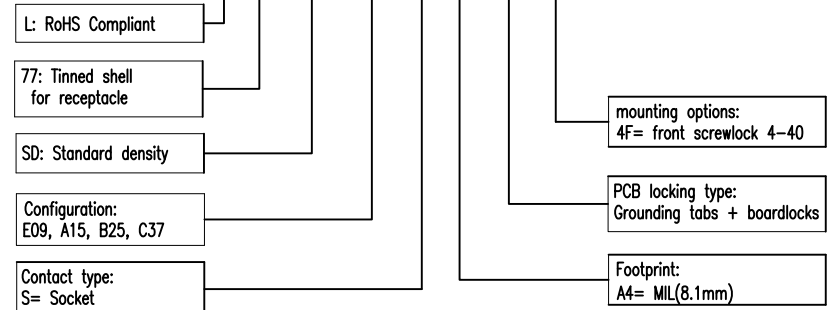

UNLESS OTHERWISE SPECIFIED TOLERANCES	APPROVAL		DATE
	DRAWN	DATE	
.X +/-	Patric Liu	04/24/18	
.XX +/-	Tommy Tong	04/24/18	
.XXX +/-			
FRACTIONS +/-			
ANGLES +/-			
FOR MATERIALS AND FINISHES SEE NOTES	DRAWING FILE :		
REMOVE SHARP EDGES	ANGLE OF PROJECTION		
DIMENSIONS			
U.S. INCHES			
METRIC MM			

Amphenol		
D-SUB connector, SD Series		
SIZE	DRAWING NO.	REV.
A4	L77SDXXXSA4CH4F	3
SCALE	NONE	SHEET 1 OF 1