

REV.	EQV. NO.	MODIFY. CONTENT	DATE
X1		新增規格	3/16/06
X2		更改磁盤電線規格	7/27/06
A	ES.D0003.003	暫行版轉正式版	3/17/07

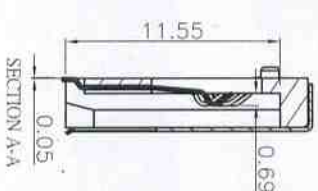

XD DEFINITION

PN. NO.	FUNCTION
1/9	CMO/CARD DETECT
2	REMOV/RETRY
3	READ ENABLE
4	CARD ENABLE
5	COMMAND LATCH ENABLE
6	ADDRESS LATCH ENABLE
7	WRITE ENABLE
8	WRITE PROTECT
9	CMO
10	DATA0
11	DATA1
12	DATA2
13	DATA3
14	DATA4
15	DATA5
16	DATA6
17	DATA7
18/20	VCC

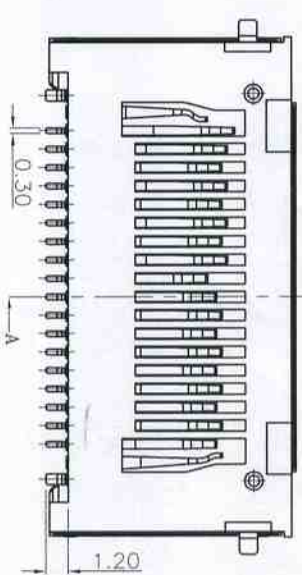
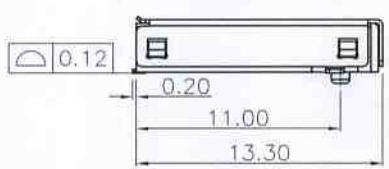
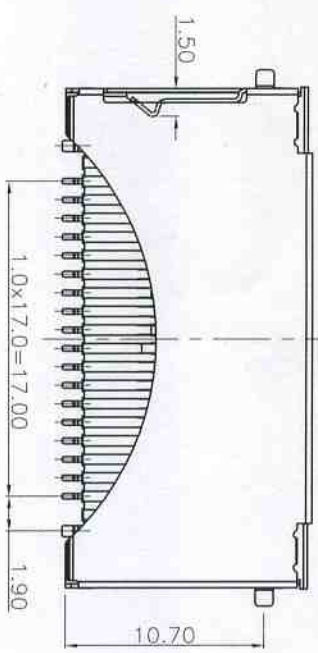
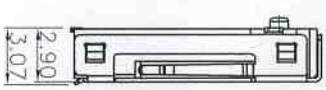
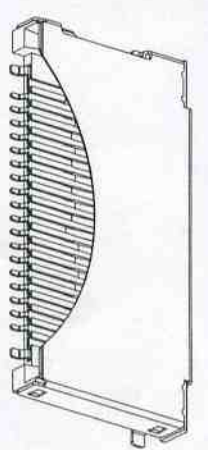
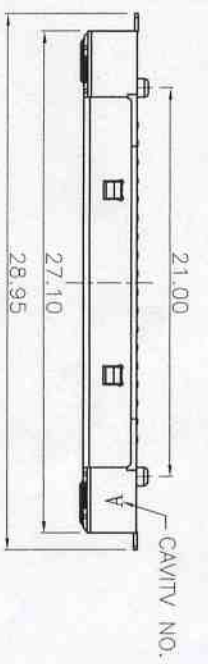

THE PART NUMBER:
101-00158-***

- NOTE:
- MECHANICAL CHARACTERISTICS
 - Insertion Force: 9.8 N (MAX)
 - Extraction Force: 1.47 N (MIN)
 - Mating cycle: 10000 cycles
 - ELECTRICAL CHARACTERISTICS
 - Current rating : 0.5 A
 - Operating voltage : 3.3V
 - Contact resistance: 40m ohms max.
 - Insulation resistance: 1000M ohms min. at 500 VDC
 - Dielectric withstanding voltage: 250 VAC/1minute
 - Operating Temperature: -0°C~+55°C
 - Storage Temperature: -20°C~+65°C
 - Operation/Storage humidity: 95% or less

- 2-1.50±0.05
- 29 功能區鍍金1u", 錫腳鍍亮地鍍至少 160u"
30 功能區鍍金3u", 錫腳鍍亮地鍍至少 160u"
31 功能區鍍金5u", 錫腳鍍亮地鍍至少 160u"
32 功能區鍍金10u", 錫腳鍍亮地鍍至少 160u"
33 功能區鍍金15u", 錫腳鍍亮地鍍至少 160u"
34 功能區鍍金30u", 錫腳鍍亮地鍍至少 160u"
35 功能區鍍金1u", 錫腳鍍亮地鍍至少 160u"
36 功能區鍍金1u", 錫腳鍍亮地鍍至少 160u"
37 功能區鍍金5u", 錫腳鍍亮地鍍至少 160u"
38 功能區鍍金15u", 錫腳鍍亮地鍍至少 160u"
39 功能區鍍金30u", 錫腳鍍亮地鍍至少 160u"

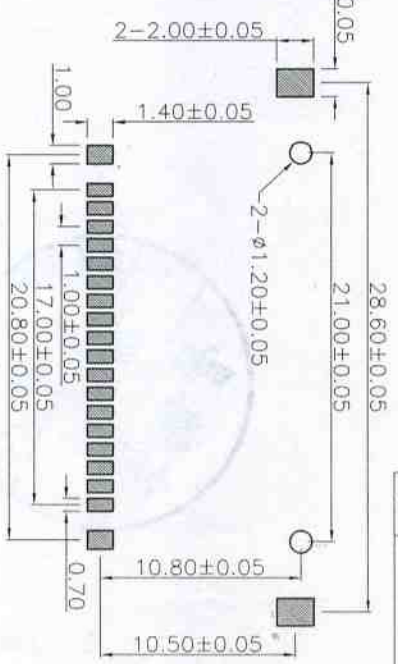

MATERIALS & PLATINGS TABLE

ITEM	DESCRIPTION	QTY	MATERIAL	FINISH
③	SHELL	1	STAINLESS STEEL	STAINLESS STEEL, t=0.20±0.02mm
②	TER	1	PHOSPHER	SELECTIVE GOLD 1-30u" ON CONTACT AREA TIN PLATED (160 u") ON SOLDER AREA
①	HOUSING	1	LOP	LOP, 30% G/F, UL 94V-0, COLOR: BLACK

GENERAL	TOLERANCE	FILE NO.	PART NO.	DRAWN	LZH	MATERIAL	SCALE	NO SCALE
x.±0.50	x.±1.5*	101-00158	101-00158-***	LZH				
x.±0.38	x.±2*	REV. A	TITLE XD NO PUSH CONN.-I	CHECKED	楊奎奎 3/16/07	DATE 3/17/07	UNIT	mm
xx±0.25	xx±1*	SIZE A4	SHEET 1/1	APPROVED	Jeffrey	SM	Shouh Min Industry (ShenZhen)CO.,LTD	