

CUSTOMER PRINT

PART NUMBER: 16280-XSG-5XX

ASS'Y P/N	CONTACT QTY
16280-2SG-5XX	2
16280-3SG-5XX	3

ASS'Y P/N	GROMMET SIZE
16280-XSG-518	CABLE O.D. .175-.185 [4.4-4.7]
16280-XSG-521	CABLE O.D. .205-.215 [5.2-5.5]
16280-XSG-522	CABLE O.D. .215-.225 [5.5-5.7]

NOTES:

1. ALL PARTS TO BE BULK PACKED
2. SEE DRAWING HPMCSTD FOR HOLE PATTERN
3. ALL DIMENSIONS ARE REFERENCE EXCEPT THOSE WITH A TOLERANCE

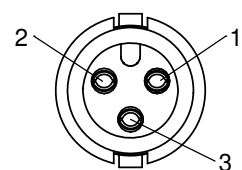

**FACE VIEW**  
16280-3SG-5XX

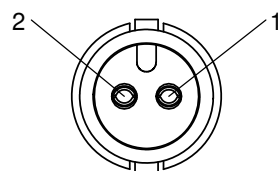
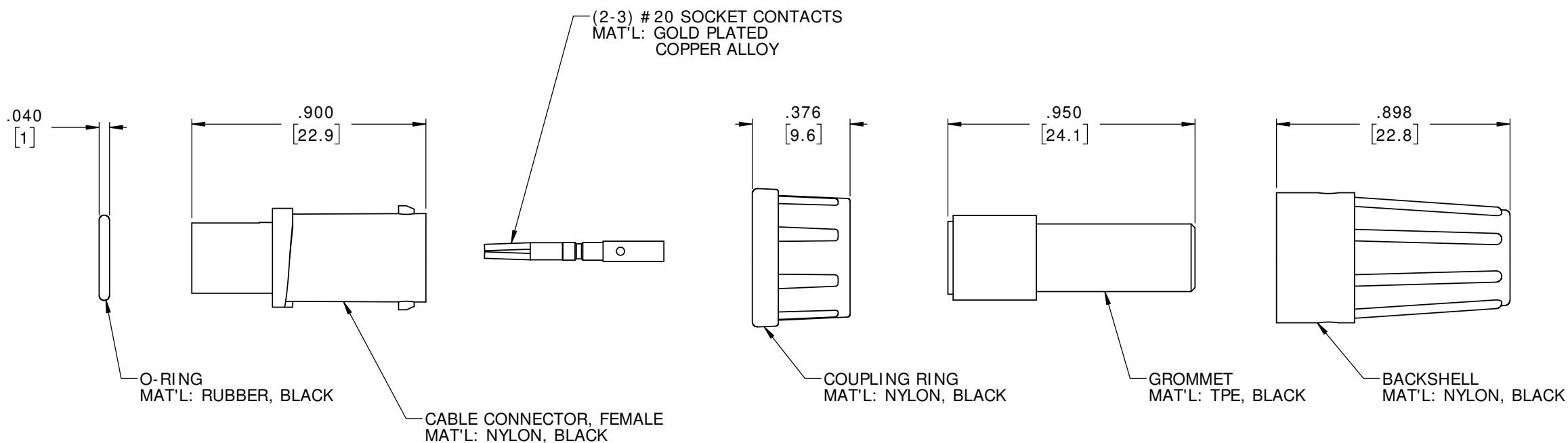

**FACE VIEW**  
16280-3SG-5XX

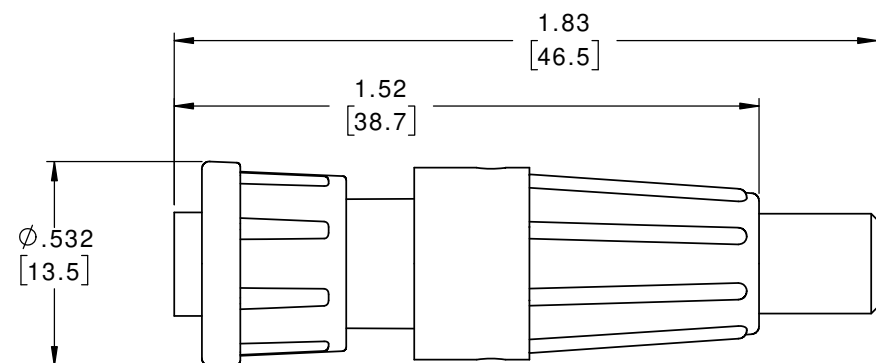

DIMENSIONS IN BRACKETS [ ] ARE IN MILLIMETERS

CUSTOMER APPROVAL

THIS DOCUMENT CONTAINS CONFIDENTIAL INFORMATION PROPRIETARY TO CONXALL CORPORATION. ANY REPRODUCTION, DISCLOSURE, OR USE OF THIS DOCUMENT / INFORMATION IS EXPRESSLY PROHIBITED UNLESS AUTHORIZED IN WRITING BY CONXALL CORPORATION.

APPROVED BY: \_\_\_\_\_  
DATE: \_\_\_\_\_

RoHS COMPLIANT

A	MA	05-01-18	DRAWING CREATED PER DOR 18-E149SL #8	
REV.	INIT.	DATE	DESCRIPTION	
	MA	05-01-18	ORIG. DRAWN BY: _____ DATE: 05-01-18 CHECKED BY: _____ APPROVED BY: _____ TITLE: CONNECTOR KIT (2-3) #20 SOCKET CONTACTS MICRO-CON-X STANDARD PRODUCT CUSTOMER: STANDARD PRODUCT	
ALL INFORMATION ILLUSTRATED IS THE PROPERTY OF CONXALL CORPORATION. UNAUTHORIZED DUPLICATION OR DISTRIBUTION OF THIS DOCUMENT IS PROHIBITED.			601 E. WILDWOOD VILLA PARK, IL 60181	
ALL UNITS ARE IN FEET, INCHES, FRACTION OF INCHES AND DECIMALS.			SCALE: NTS SIZE: B SHEET: 1 OF 1	FILE: 16280-XSG-5XX DIRECTORY: SLW
- CRITICAL CHARACTERISTIC FLAG PER SPEC. XXXX			PART NUMBER: 16280-XSG-5XX	REV: A