

PART NUMBER	REV	USED USED
466909-1	K	854040-3

TERMINAL NAME: CONTACT, ROUND WIRE					
PIN	RECEPT	VISIBLE	CRIMPING DATA		
LTR		PAD	CRIMP HEIGHT		WIRE SIZE
86557	86566		A	.028 ±.002 [0.71 ±0.05mm]	22
86599	88067		B	.025 ^{+.001} _{-.002} [0.63 ^{+0.02} _{-0.05} mm]	24 OR 26
			C	NOT	USED
			D	NOT	USED
		CRIMP	SIZE	TYPE	RANGE
			.055 [1.4mm]	F	26-22
		WIRE	INSUL		
			△.062 [1.57mm]	0	.043-.054
WIRE STRIP LENGTH	TERM APPL SPEC	FEED	APPL INSTRUCTION	SET UP GAGE	LAYOUT
-	114-16003	.330	SEE CUSTOMER MANUAL	NONE	470

SIM TO HDM 466572

QTY	REV	REF	DESCRIPTION	ITEM NO
				70
				69
				68
				67
				66
				65
				64
				63
				62
				61
				60
				59
				58
				57
				56
				55
				54
				53
				52
				51
				50
				49
				48
				47
				46
				45
				44
				43
				42
				41
				40
				39
				38
				37
				36
				35
				34
				33
				32
				31
				30
				29
				28
				27
				26
				25
				24
				23
				22
				21
				20
				19
				18
				17
				16
				15
				14
				13
				12
				11
				10
				9
				8
				7
				6
				5
				4
				3
				2
				1

QTY	REV	REF	DESCRIPTION	ITEM NO
2	-	C	7-354779-2 PIN, WIRE DISC (.3350)D	129
2	-	C	6-354779-6 PIN, WIRE DISC (.3320)C	128
				127
				126
1	-	A	986950-1 WASHER, FLAT PRECISION	125
1	-	A	217238-3 DOCUMENTATION PACKAGE	124
				123
				122
				121
1	-	B	690701-2 PLATE, SERIAL NO.	120
2	-	A	21899-2 WASHER, FLAT (#10) S G ADJ BLK	119
				118
2	-	A	21024-5 WASHER, LOCK (#10) ADJ BLOCK	117
				116
				115
2	-	A	21024-2 WASHER, LOCK (#4) FRONT STP GUIDE	114
REF	-	A	21024-4 WASHER, LOCK (#8) FEED FINGER	113
2	-	A	21024-4 WASHER, LOCK (#8) DEP-HOLD	112
REF	-	A	21024-4 WASHER, LOCK (#8) STRIPPER	111
				110
				109
				108
				107
				106
				105
				104
1	-	A	21009-2 SCR, SKT 5ET (1/4-20x.25 LW) RAM	103
				102
4	-	A	21017-2 SCR, DRIVE (#2x.19) ID PLATE	101
1	-	B	819347-1 PLATE, IDENTIFICATION	100
2	-	A	3-21002-0 SCR, BHC (10-32x.88) DRAG	99
1	-	A	22733-8 SCR, BHC (8-32x.38 LW) ANVIL	98
2	-	A	1-21002-6 SCR, BHC (6-32x.25) TERM HOLDER	97
1	-	A	3-21000-8 SCR, SHC (10-32x.88) MOUNTING	96
1	-	A	2-21002-7 SCR, BHC (10-32x.50) S6 ADJ BLK	95
4	-	A	2-21002-2 SCR, BHC (8-32x.50) SHEAR-TERM SUP	94
				93
				92
1	-	A	1-21002-7 SCR, SHC (6-32x.50) CAM	91
2	-	A	2-21000-7 SCR, SHC (8-32x.50) SCR BLK	90
				89
				88
2	-	A	3-21000-0 SCR, SHC (8-32x.81) DEP-HOLD DOWN	87
REF	-	A	2-22603-0 SCR, HEX HD (8-32x.31) FEED FINGER	86
2	-	A	1-21000-3 SCR, SHC (4-40x.25) F ST GUIDE	85
REF	-	A	22733-9 SCR, BHC (8-32x.50 SL) STRIPPER	84
				83
				82
1	-	A	3-22603-1 SCR, HEX (10-32x.38) S6 ADJ BL	81
				80
				79
				78
2	-	B	463310-6 BLADE, STRIPPING (#22)	77
				76
				75
1	-	A	690603-1 SPRING, ASSIST	74
1	-	A	23030-1 SCR, SKT CAP (6-32x.25) CP DSC	73
				72
				71

QTY	REV	REF	DESCRIPTION	ITEM NO
-1	U/M			

QTY	REV	REF	DESCRIPTION	ITEM NO
-1	U/M			

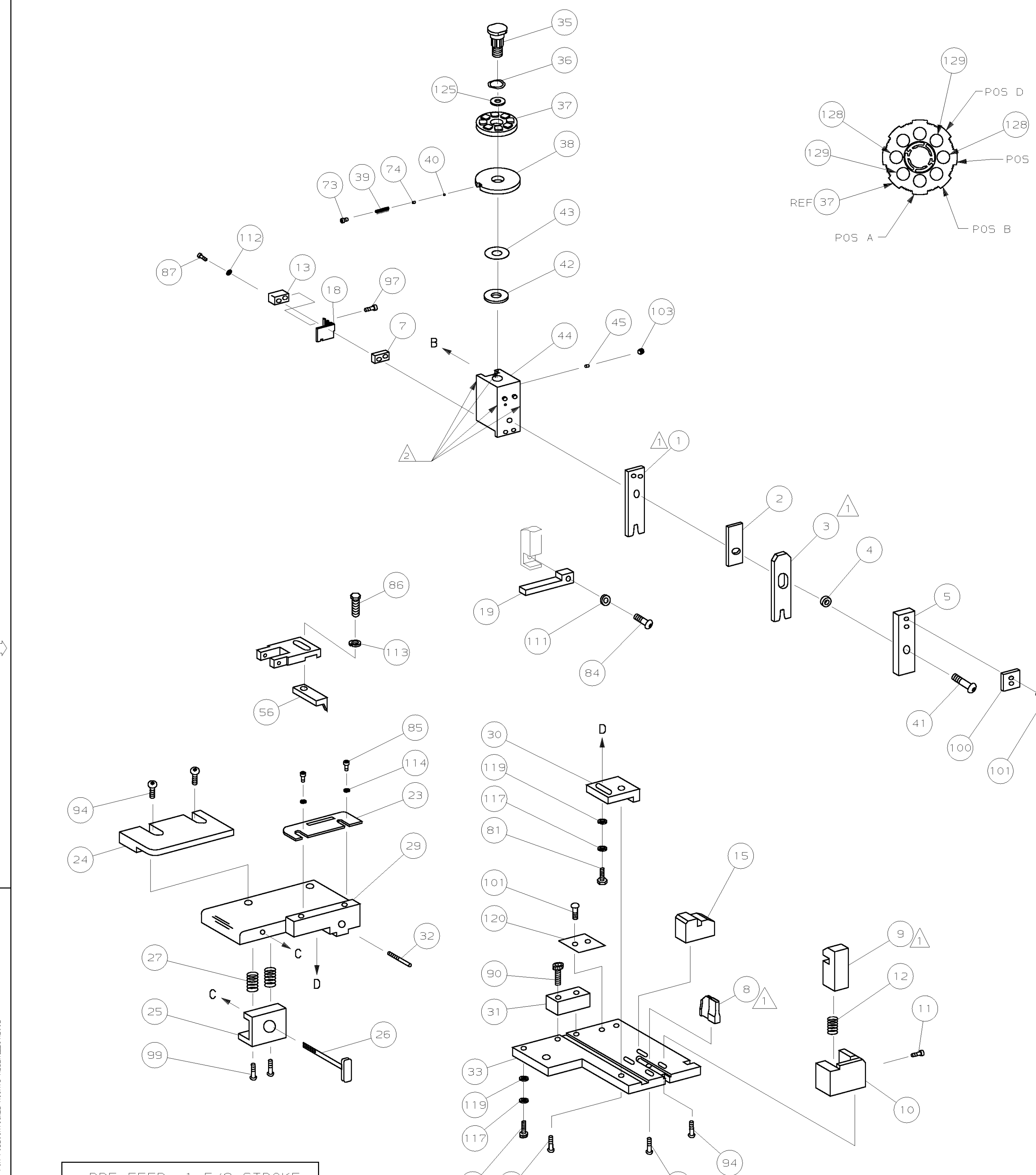

1 RECOMMENDED SPARE PARTS.
 2 GREASE LIGHTLY.
 3 ITEM NOT SHOWN
 4 CUT TO LENGTH AT ASSEMBLY.
 5 INSULATION CRIMP HEIGHT, .068 MAX.

PRE-FEED 1 5/8 STROKE
 ROTATED 180°

QTY	REV	REF	DESCRIPTION	ITEM NO
-1	U/M			

QTY	REV	REF	DESCRIPTION	ITEM NO
-1	U/M			