

# 2400-2485 & 5150-5875 MHz SLIM LINE DUAL BAND WLAN / BLUETOOTH ANTENNA

Part Numbers: 2118899-1, 2118899-2  
2118899-3, 2118899-4

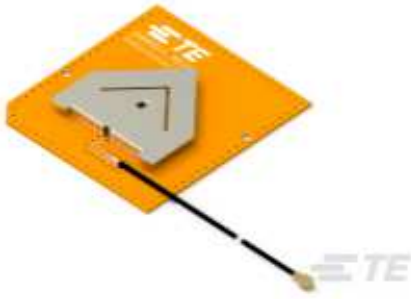

## FEATURES & BENEFITS

- Slim line (3mm height) WLAN Dual band stamped metal antenna element on PCB ground
- Patented innovate PIFA design for metal enclosure applications
- Reduced SINR (Signal-to-Interference-plus-Noise Ratio)
- Omnidirectional coverage
- Requires direct contact to plastic housing
- Wide selection of micro-coaxial cable lengths

## SPECIFICATIONS (with polycarbonate 1.5mm top cover and including losses of 278 mm cable)

Frequency Range (MHz)	2400-2485	5150-5875
VSWR	< 1.9 : 1	< 1.9 : 1
Average Efficiency	45%	50%
Peak Gain	1.0dBi	1.5dBi
Average Gain	-3.6dBi	-3.0dBi
Power Handling	10 Watt cw	
Feed Point Impedance	50 ohms	
Polarization	Linear	
Size	54.50 mm x 54.50 mm x 3.80mm	
Weight	< 8.0 g	
Mounting	Under plastic housing	
Mating Connectors	MHF and MHF 4L-type Refer to page 5	
CABLE(Coaxial)	1.13mm Dia. Refer to page 5	
Operating Temperature	-40 to +85°C	
Storage Temperature	-40 to +85°C	
Hazardous Materials	A certificate of conformance is available from the product page on TE website.	

## RF DATA

VSWR

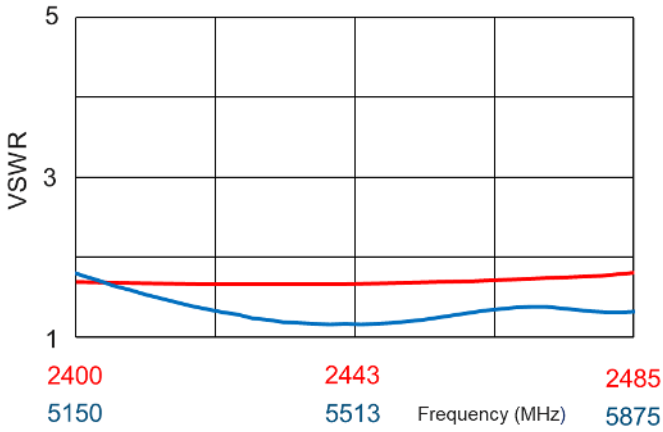

Return Loss

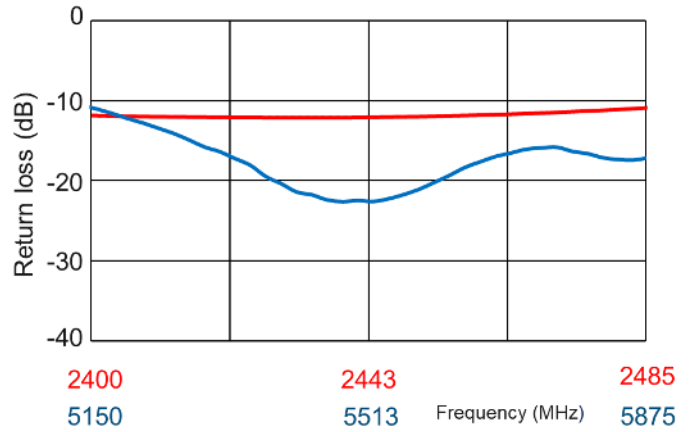

Efficiency

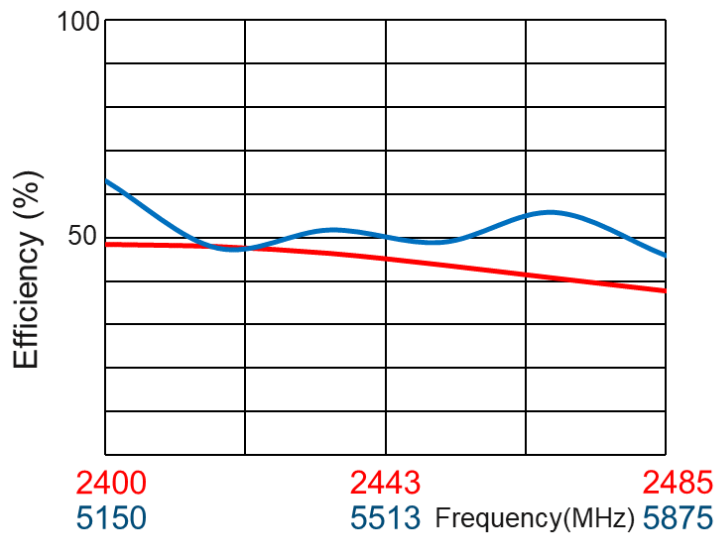

Data measured in free space and under plastic device enclosure

# RADIATION PATTERN

## Test setup

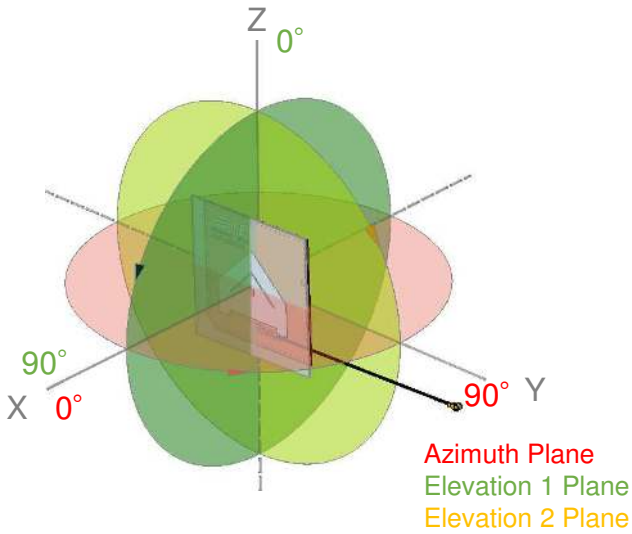

## Azimuth

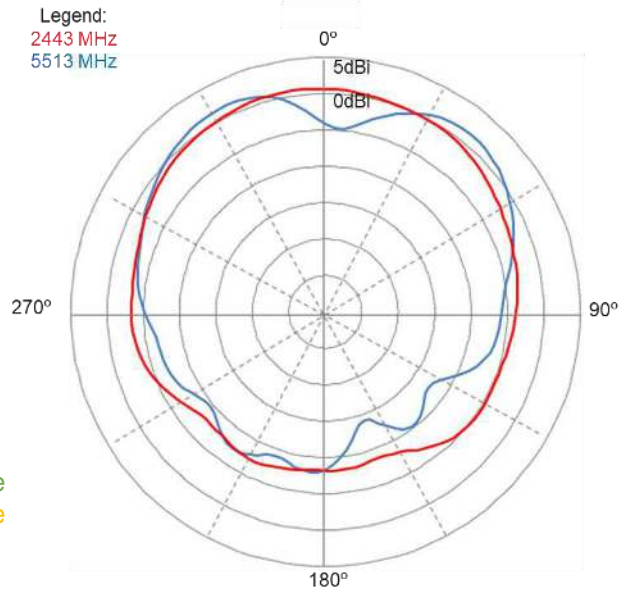

## Elevation 1

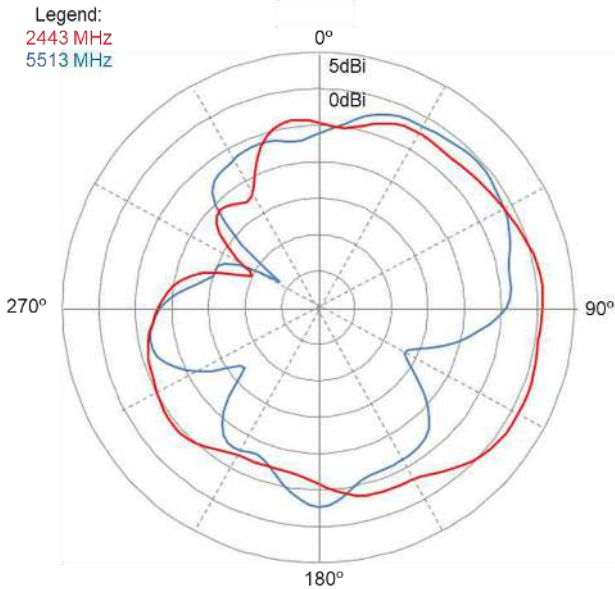

## Elevation 2

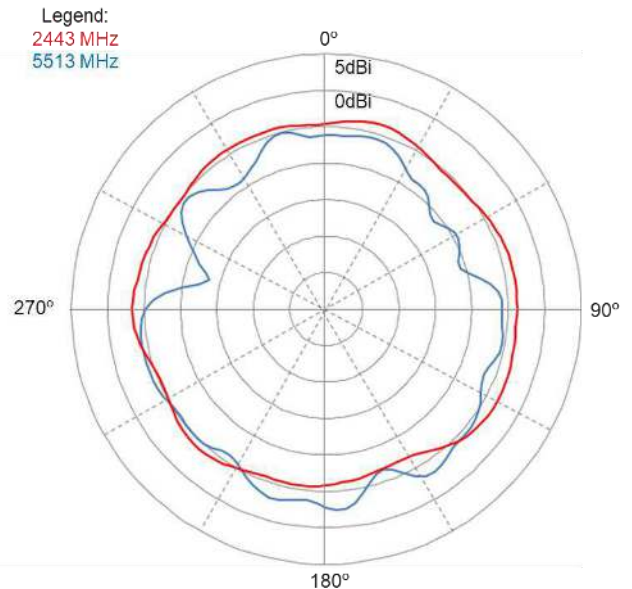

Data measured in free space and under plastic device enclosure

## KEEP OUT AREA / APPLICATION

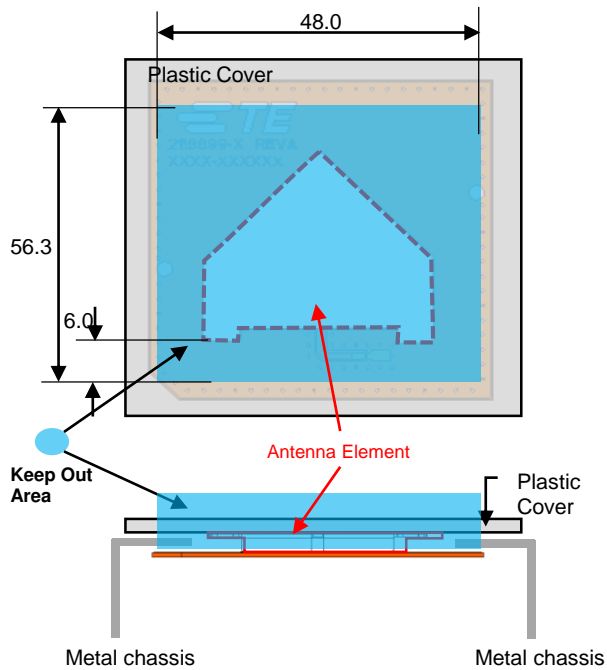

### APPLICATION DETAIL VIEW

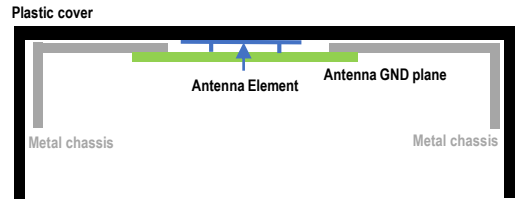

### SECTION "A"

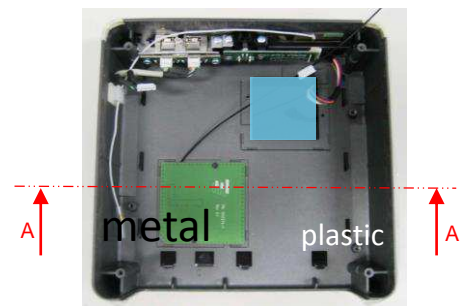

- NOTES:
1. Antenna designed to be mounted under plastic cover.
  2. Area in blue above indicates Keep Out Area.
  3. No matching circuits required.
  4. For more information please call TE.
  5. Performance dependent on plastic material and position

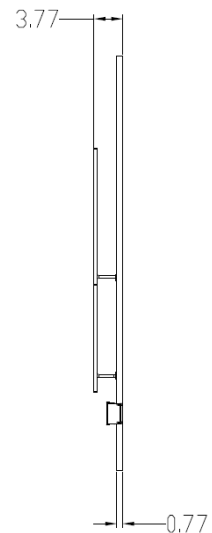
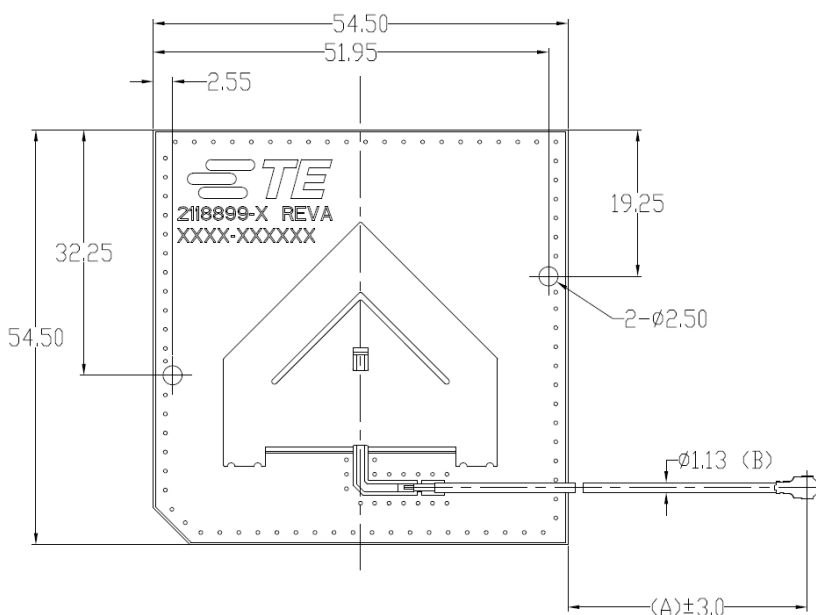

Dimensions: mm  
Diagram is not to scale

## DIMENSIONS



Dimensions: mm  
Diagram is not to scale

## MATING COMPONENTS TO PART NUMBERS AND DIMENSIONS

2118899-1	278	10.944	1.13	MHF-TYPE PLUG	RECEPTACLE (TE PN: 2337019-1)	
2118899-2	480	18.897	1.13	MHF-TYPE PLUG	RECEPTACLE (TE PN: 2337019-1)	
2118899-3	278	10.944	1.13	MHF4L-TYPE PLUG	RECEPTACLE (TE PN: 2334884-1)	
2118899-4	480	18.897	1.13	MHF4L-TYPE PLUG	RECEPTACLE (TE PN: 2334884-1)	
PART NUMBER	MM	INCH	MM	CONNECTOR TYPE (ON CABLE)	PART NUMBER	IMAGE
NUMBER	CABLE LENGTH (A)		CABLE O.D(B)		MATING COMPONENTS	

## PACKAGING

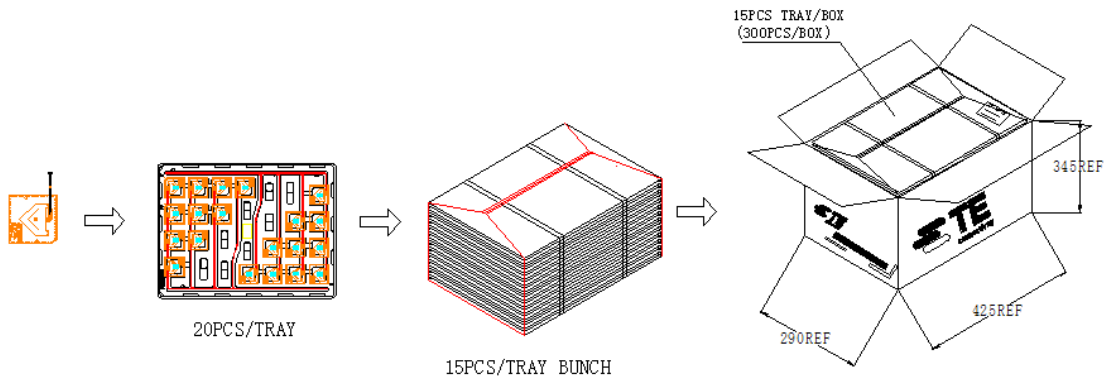

### TE TECHNICAL SUPPORT CENTER

USA: +1 (800) 522-6752  
 Canada: +1 (905) 475-6222  
 Mexico: +52 (0) 55-1106-0800  
 Latin/S. America: +54 (0) 11-4733-2200  
 Germany: +49 (0) 6251-133-1999  
 UK: +44 (0) 800-267666  
 France: +33 (0) 1-3420-8686  
 Netherlands: +31 (0) 73-6246-999  
 China: +86 (0) 400-820-6015

For phone numbers in other countries, go to [te.com/support-center](http://te.com/support-center)

### te.com

TE Connectivity, TE Connectivity (logo) are trademarks. All other logos, products and/or company names referred to herein might be trademarks of their respective owners.

The information given herein, including drawings, illustrations and schematics which are intended for illustration purposes only, is believed to be reliable. However, TE Connectivity makes no warranties as to its accuracy or completeness and disclaims any liability in connection with its use. TE Connectivity's obligations shall only be as set forth in TE Connectivity's Standard Terms and Conditions of Sale for this product and in no case will TE Connectivity be liable for any incidental, indirect or consequential damages arising out of the sale, resale, use or misuse of the product. Users of TE Connectivity products should make their own evaluation to determine the suitability of each such product for the specific application.

© 2020 TE Connectivity Ltd. family of companies All Rights Reserved.

06/2022