

CUSTOMER: SECUI

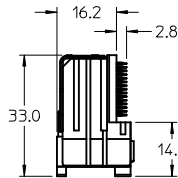
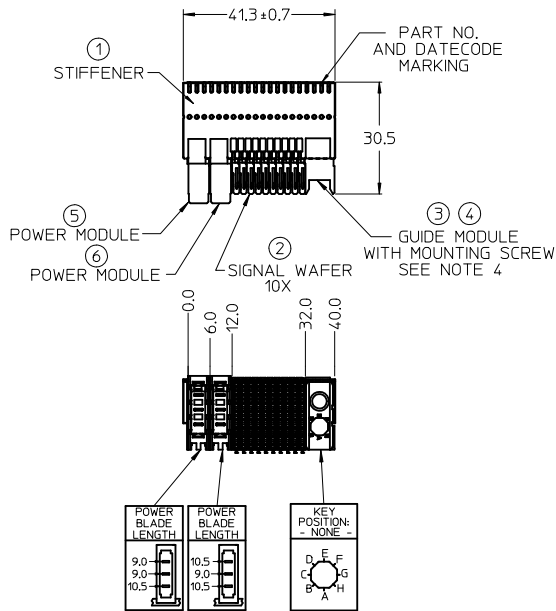

NOTES:

- MATERIALS: HOUSING : LIQUID CRYSTAL POLYMER (LCP) GLASS-FILLED, UL94V-0, BLACK. TERMINALS: COPPER ALLOY STIFFENER: STAINLESS STEEL
- FINISH: SELECTIVE GOLD (Au) 0.76 MICROMETER MINIMUM IN CONTACT AREA, SELECTIVE MATTE TIN (Sn) IN TAIL AREA, NICKEL (Ni) UNDERPLATE OVERALL.
- REFER TO MOLEX PRODUCT SPECIFICATION PS-74031-999 FOR PERFORMANCE SPECIFICATIONS.
- PARTS TO BE PACKAGED PER PK-70873-5041. SCREWS PACKED IN BAG INSIDE TUBE.
- THIS PART CONFORMS TO CLASS 'B' REQUIREMENTS OF MOLEX COSMETIC SPECIFICATION PS-45499-002.
- REFER TO MOLEX DOCUMENT SD-74041-002 FOR ADDITIONAL DETAIL ON THE SIGNAL WAFER.
- REFER TO MOLEX DOCUMENT SD-74037-006 FOR ADDITIONAL DETAIL ON THE GUIDANCE MODULE.
- REFER TO MOLEX DOCUMENT SD-75885-002 FOR ADDITIONAL DETAIL ON THE LEAD-FREE POWER MODULE.
- REFER TO MOLEX DOCUMENT SD-74038-004 FOR ADDITIONAL DETAIL ON THE END CAP.
- LABEL MARKED WITH MOLEX PART NUMBER AND DATE CODE. LABEL MAY BE REPLACED WITH LASER MARKING ON THE STIFFENER.

LEAD-FREE
PLATING

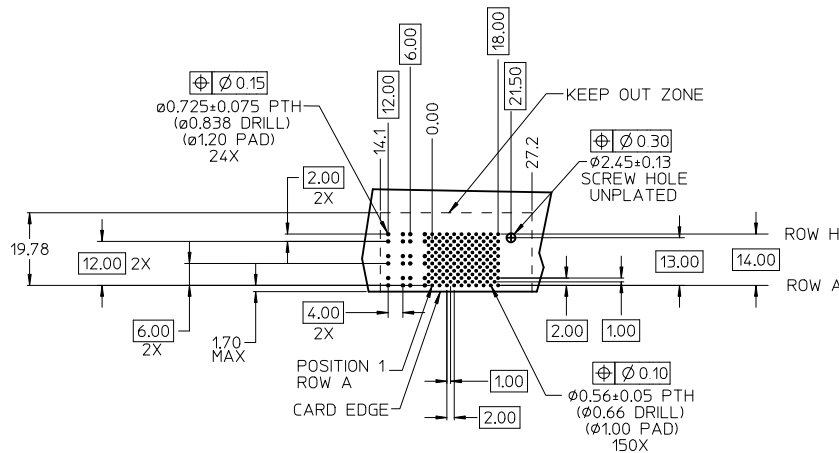

DAUGHTERCARD HOLE PATTERN
(CONNECTOR SIDE)

ITEM	PART NUMBER	DESCRIPTION	QTY
1	74046-0041	STIFFENER	1
2	74041-1001	SIGNAL WAFER, LF	10
3	74037-0008	GUIDANCE MODULE	1
4	73726-0000	GUIDE MNTG SCREW	1
5	75885-8322	POWER MODULE, LF	1
6	75885-8323	POWER MODULE, LF	1

CHG TO LEAD-FREE EC NO: UCP2012-2179 DRAWING: 2012/01/13 CHK: SDANIELLEY 2012/01/13 APPR: SMILLER 2012/02/09	QUALITY SYMBOLS ∇=0 ∇=0 ∇=0	GENERAL TOLERANCES (UNLESS SPECIFIED)		DIMENSION STYLE MM ONLY		SCALE 2:1	DESIGN UNITS METRIC	THIRD ANGLE PROJECTION	
		4 PLACES ± 0.25 3 PLACES ± 0.25 2 PLACES ± 0.25 1 PLACE ± 0.38	mm INCH	DRAWN BY VARVARA	DATE 06/04/04	TITLE VHDM 8 ROW, LF DAUGHTERCARD SALES DRAWING			
		ANGULAR ± 1/2°		APPROVED BY SMILLER	DATE 2012/02/09	MATERIAL NO. 74040-1173			
DRAFT WHERE APPLICABLE MUST REMAIN WITHIN DIMENSIONS		DOCUMENT NO. SD-74040-1173		SHEET NO. 1 OF 1		MOLEX INCORPORATED			