

Technical Data

Material:
 Pin (outer sleeve): Brass, machined, CuZn38Pb2
 Clip (contact 4 finger): Beryllium copper, heat treated or PHBZ
 Plating (outer sleeve): Tin plated : 2um/80u"nickel, 5um/200u"Tin
 Plating clip(contact): 2um/80 u"nickel, gold Flash

Electrical

Current rating: 3 Amps/contact max.
 Contact resistance: 4m /contact
 Rated voltage: 100 VRMS/150VDC

Mechanical

Operating temperature: -40° C to +105° C
 (Continuous) -67° F to +105° F

Average insertion force with steel pin of: $\pm 0.43\text{mm}/0.017"$ - 250g
 Average withdrawal force with steel pin of: $\pm 0.43\text{mm}/0.017"$ - 50g
 Mechanical life: min. 200 Cycles

Environmental data

Solderability (IEC 60068-2-20. Ta): 235° C, 2s
 Resistance to soldering heat (IEC 60068-2-20. Tb):
 -Through hole mount components: 260° C, 10s

RoHS Compliant

- +Biodegradable Carrier
- +Environmentally Friendly
- +Auto Insertable
- +Dissolves in Water: The Wash-Away socket carrier completely dissolves in water as the board is being washed in any of the standard board washing systems.

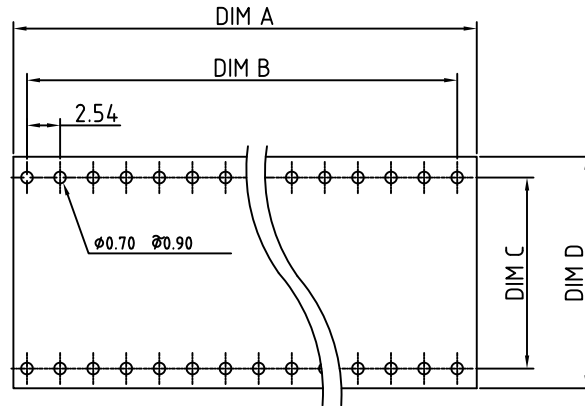
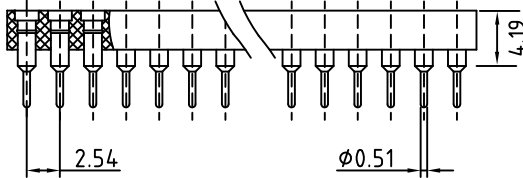

P.C.B. LAYOUT

×Part Number: Add 1 for .3 spacing on 24(1) and 28(1) contacts

P/N	Contact	Dim A	Dim B	Dim C	Dim D	P/N	Contact	Dim A	Dim B	Dim C	Dim D
WMS-060Z	06	7.62	5.08	7.62	10.16	WMS-240Z	24	30.48	27.94	15.24	17.78
WMS-080Z	08	10.16	7.62	7.62	10.16	WMS-280Z	28	35.56	33.02	15.24	17.78
WMS-100Z	10	12.70	10.16	7.62	10.16	WMS-320Z	32	40.64	38.10	15.24	17.78
WMS-140Z	14	17.78	15.24	7.62	10.16	WMS-400Z	40	50.80	48.26	15.24	17.78
WMS-160Z	16	20.32	17.78	7.62	10.16	WMS-420Z	42	53.34	50.80	15.24	17.78
WMS-180Z	18	22.86	20.32	7.62	10.16	WMS-480Z	48	60.96	58.42	15.24	17.78
WMS-200Z	20	25.40	22.86	7.62	10.16	WMS-640Z	64	81.28	78.74	22.86	25.40
WMS-2410Z	24	30.48	27.94	7.62	10.16						
WMS-2810Z	28	35.56	33.02	7.62	10.16						

THESE DRAWINGS AND SPECIFICATIONS ARE THE PROPERTY OF ON-SHORE TECHNOLOGY, INC. AND SHALL NOT BE REPRODUCED, COPIED OR USED IN ANY MANNER WITHOUT THE PRIOR WRITTEN CONSENT OF ON-SHORE TECHNOLOGY, INC. PATENTED



TITLE		Wash Away IC Socket			
PART NO.	WMS-XXOZ	DWG NO.	WMS-0Z.dwg		
APPROVED	CHECKED	DESIGNED	DRAWN	CUST NO.	Tolerance
		Aaron 2006.01.12	Aaron 2006.01.12		X. ±0.50 X.X ±0.30 X.XX ±0.10 X* ±1*
				UNIT: mm SCALE: NONE SHEET: 01/01	REV: D