

THIS DRAWING IS UNPUBLISHED. RELEASED FOR PUBLICATION
 © COPYRIGHT - By - ALL RIGHTS RESERVED.

LOC		DIST		REVISIONS			
P	LTR	DESCRIPTION		DATE	DWN	APVD	
AF	50	B2	ECR-15-005665	10AUG2015	BDA	PKS	

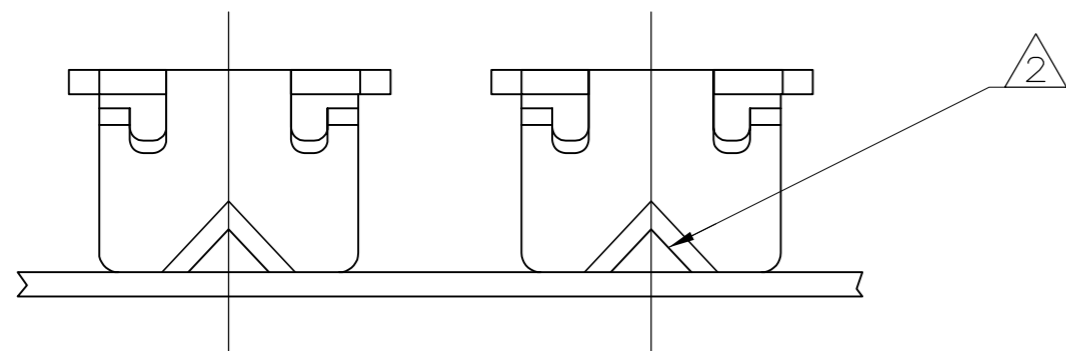

IDENTIFICATION NUMBER 6 FOR MAGNET WIRE RANGE

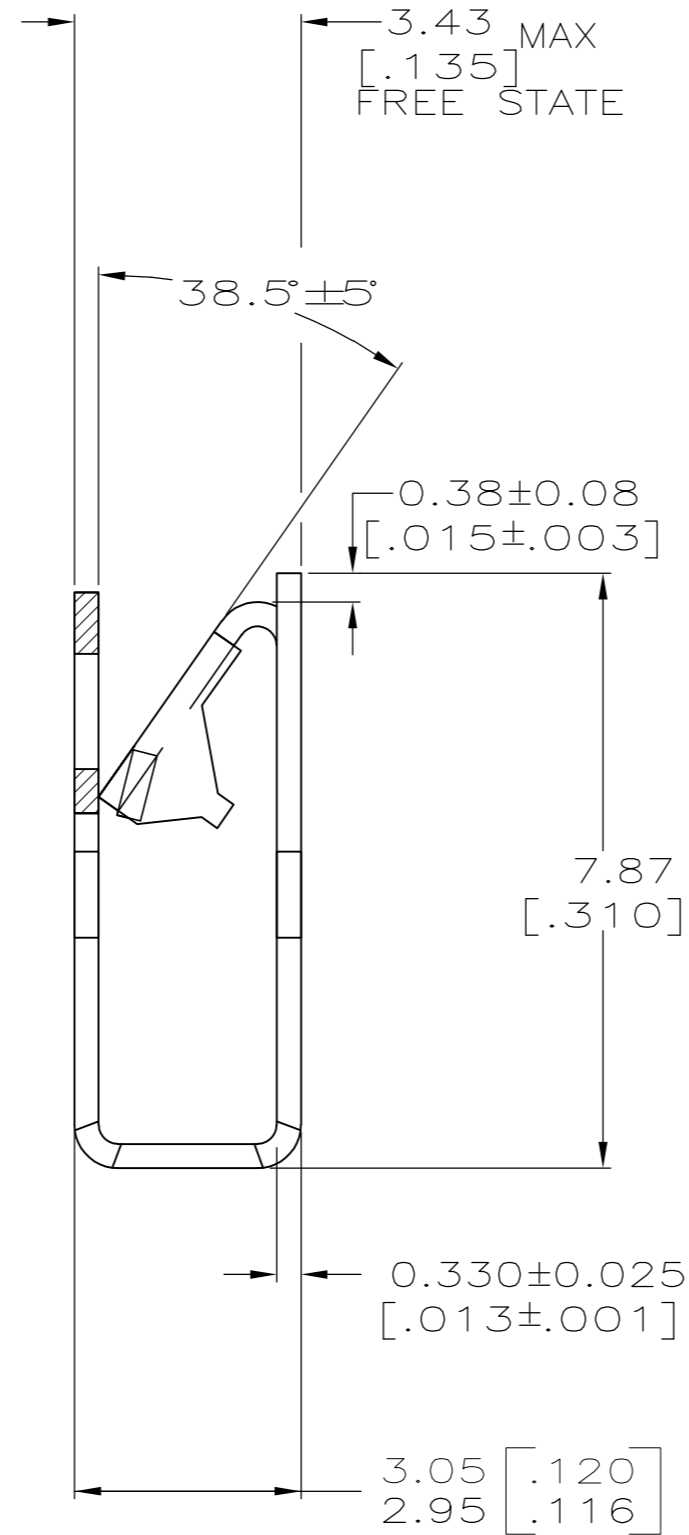
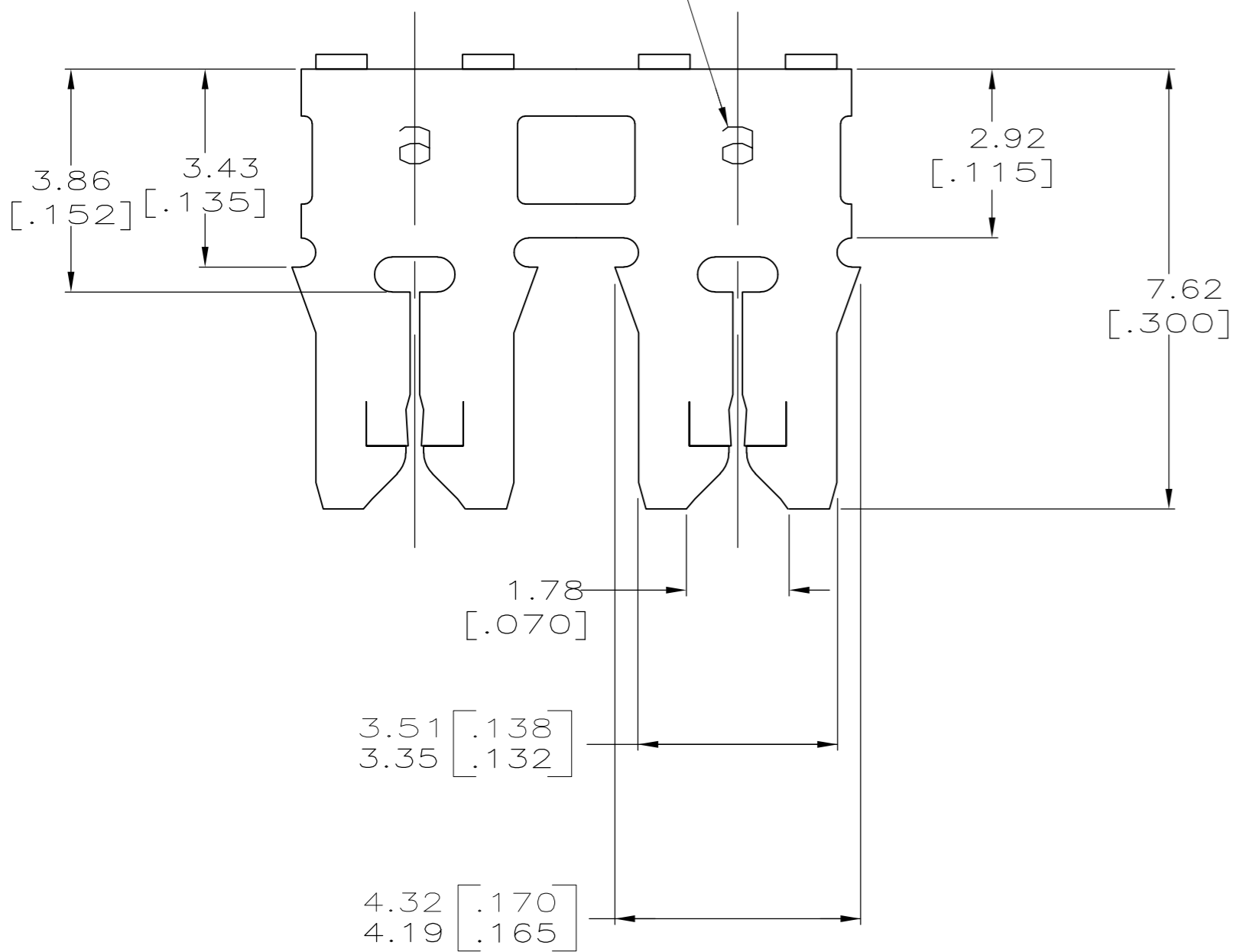

- ① SLOT TERMINATES EITHER A SINGLE OR DOUBLE MAGNET WIRE OF THE SAME SIZE AND TYPE. COPPER RANGE: 0.25-0.36mm [#30-#27] AWG. ALUMINUM RANGE: 0.32-0.45mm [#28-#25] AWG. ALUMINUM WIRE RANGE APPLIES FOR POST-TIN PLATED VERSIONS ONLY.
- ② POKE-IN ACCEPTS A 0.5-0.9mm² [#20-#18] AWG SOLID OR FUSED STRANDED LEAD WIRE.
- ③ BLUE COLORING ON THIS SURFACE TO PROVIDE CODING OF MAGNET WIRE RANGE

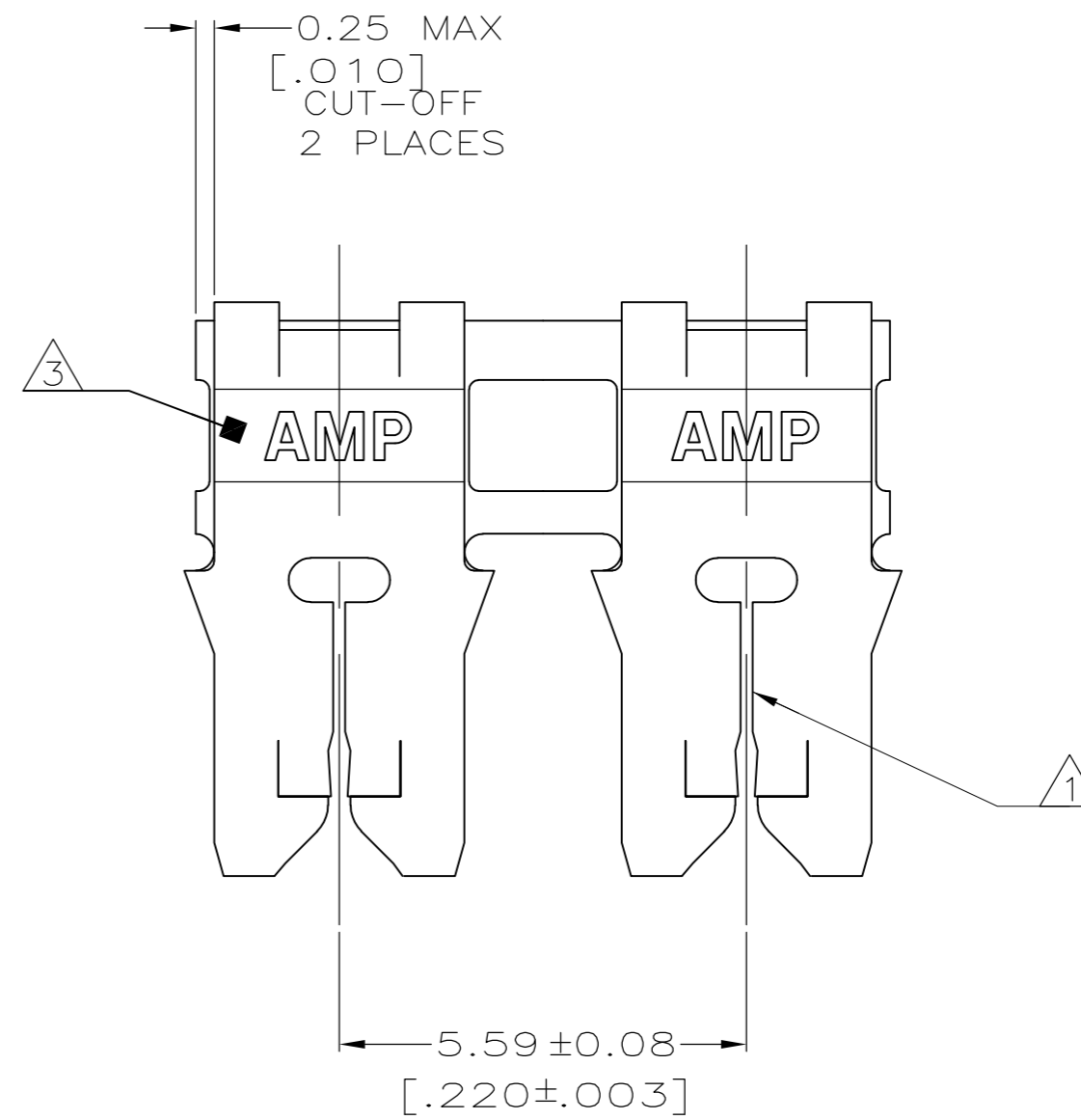

63885-1

THIS DRAWING IS A CONTROLLED DOCUMENT.		DWN R.GRZYBOWSKI 22/NOV/95	TE TE Connectivity	
DIMENSIONS: INCHES		CHK M.S.FEHER 22/NOV/95		
TOLERANCES UNLESS OTHERWISE SPECIFIED:		APVD NELSON E NEFF 22/NOV/95	NAME	
0 PLC ± -		PRODUCT SPEC	108-2012	
1 PLC ± -		APPLICATION SPEC	114-2046	
2 PLC ± 0.25 [.010]		WEIGHT	SIZE A2	CAGE CODE 00779
3 PLC ± -		MATERIAL BRASS	DRAWING NO C=63885	RESTRICTED TO
4 PLC ± -		FINISH TIN PLATED	SCALE 10:1	SHEET 1 of 1
ANGLES ± -		CUSTOMER DRAWING	REV B2	