

THESE DRAWINGS ARE THE PROPERTY OF QUALTEK ELECTRONICS AND NOT TO BE REPRODUCED FOR OR COMMUNICATED TO A THIRD PARTY WITHOUT THE EXPRESS WRITTEN PERMISSION OF AN OFFICER OF QUALTEK ELECTRONICS.

| REVISION |             |      |          |
|----------|-------------|------|----------|
| REV.     | DESCRIPTION | DATE | APPROVED |
|          |             |      |          |
|          |             |      |          |

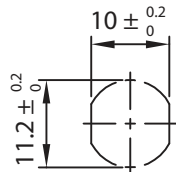

PANEL CUTOUT

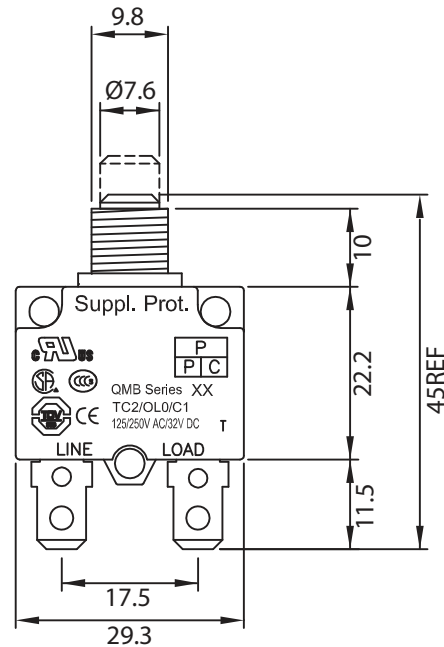
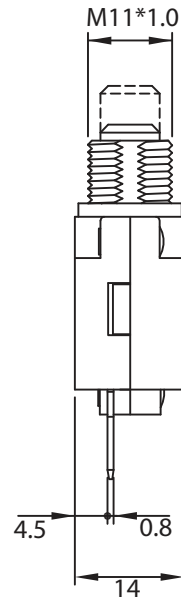
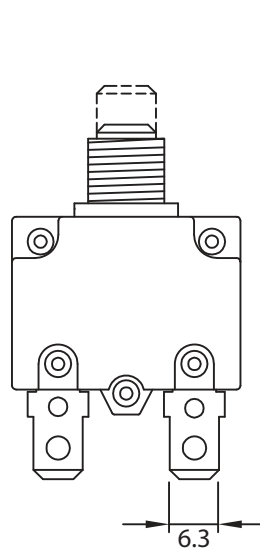
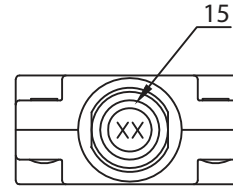

**CONTROLLED**

NOTES:

RATING: 15A 125/250V AC/32V DC  
 APPROVALS: UL, cUL, TUV, CCC, CE, CSA  
 BUTTON COLOR: BLACK  
 BUTTON PRINT COLOR: WHITE  
 PLASTIC BUSHING  
 PLASTIC MOUNTING NUT  
 RoHS COMPLIANT

| Dim range (mm) | Tolerance +/- (mm) | Qualtek Electronics Corp.<br>PPC DIVISION |                |                 |
|----------------|--------------------|---|----------------|-----------------|
|                |                    | Part Number: QMB-153-11C3N-3BA            |                | RoHS Compliant  |
| 0-1            | 0.15               | Description: CIRCUIT BREAKER              |                |                 |
| 1-6            | 0.20               |   |                |                 |
| 6-18           | 0.30               |   |                |                 |
| 18-50          | 0.50               |   |                |                 |
| 50-120         | 0.70               | Drawn / Date                              | Checked / Date | Approved / Date |
| 120-250        | 0.90               | R.Nuti<br>06-02-15                        | 06-02-15       | LY / 06-02-15   |
| 250-500        | 1.20               |   |                |                 |