

**ADJUST. 2 HOLES FLANGE JACK RECEPTACLE  
WITH CYLINDRICAL CONTACT**

**R124.464.000**  
**SERIES SMA-COM**

4 Creves pour immobilisation du contact-central  
(4 idents for center-contact captivation).  
(4-Punkt-Crimping zur Fixierung des innenleiters).

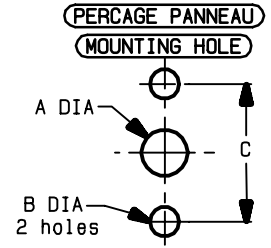
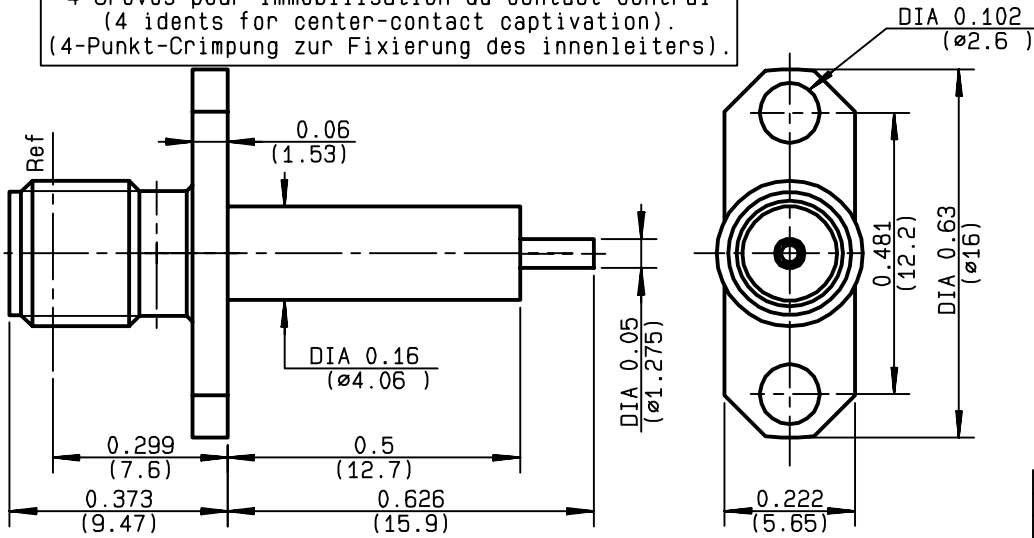

	MM		INCH	
	maxi	mini	maxi	mini
A	4.2	4.1	.165	.16
B	2.65	2.6	.104	.102
C	12.25	12.15	.482	.478

NOMINAL IMPEDANCE	<b>50</b>	$\Omega$
FREQUENCY RANGE	<b>0-18</b>	GHz
TEMPERATURE RATING	<b>-65/+165</b>	$^{\circ}\text{C}$
V.S.W.R	<b>1.04 + .0045</b>	$\times F(\text{GHz})\text{Maxi}$
RF INSERTION LOSS	<b>0.05</b>	$\sqrt{F}(\text{GHz}) \text{ dB Maxi}$
VOLTAGE RATING	<b>500</b>	$V_{\text{eff}} \text{ Maxi}$
DIELECTRIC WITHSTANDING VOLTAGE	<b>1000</b>	$V_{\text{eff}} \text{ Mini}$
INSULATION RESISTANCE	<b>5000</b>	$M \Omega \text{ Mini}$
HERMETIC SEAL	<b>NA</b>	$\text{Atm. cm}^3/\text{s}$
LEAKAGE (pressurized only)	<b>NA</b>	
MECHANICAL DURABILITY	<b>100</b>	Cycles
WEIGHT	<b>2.15</b>	gr
SPECIFICATION		

CABLES :

OTHERS CHARACTERISTICS

**cc15.9-1s12.7-tro12.7-cr**

CABLE RETENTION	<b>NA</b>	N Mini
CENTER CONTACT RETENTION		
Axial force - mating end	<b>27</b>	N Mini
Axial force - opposite end	<b>27</b>	N Mini
Torque	<b>2.8</b>	cm.N Mini
RECOMMENDED TORQUES		
Mating	<b>NA</b>	cm.N
Panel nut	<b>NA</b>	cm.N
Clamp nut	<b>NA</b>	cm.N

CONNECTOR PARTS:	MATERIALS	FINISH	(all values are given in micrometers)
BODY	BRASS	BBR 2	
OUTER CONTACT			
CENTER CONTACT	BERYLLIUM COPPER	GOLD 1.3 OVER COPPER 2.5	
INSULATOR	PTFE	-	
GASKET		-	
OTHERS PIECES			

ISSUE	CREATION DATE	FILE PART-NUMBER
<b>9901A00</b>	<b>10/07/1996</b>	<b>96-1200-018</b>



TRIQUES

The information given here is subject to change without notice.  
Design changes may be in order to improve the product.

*Connect to the future*