

THIS COPY IS PROVIDED ON A RESTRICTED BASIS AND IS NOT TO BE USED IN ANY WAY DETRIMENTAL TO THE INTERESTS OF PANDUIT CORP.

PANDUIT P/N	WEIGHT
PEV1296	62.5 LBS/EACH (28.4 kg/EACH)

NOTES:

- VISIT OUR ON-LINE CATALOG AT WWW.PANDUIT.COM FOR A CURRENT LIST OF PRODUCTS APPLICABLE FOR USE WITH THIS PART.
- COMPONENTS: (1) 8FT TALL 12" DUAL-SIDE VERTICAL MANAGER
(1) HARDWARE KIT
(2) LEFT PEV96 FINGER KITS
(2) RIGHT PEV96 FINGER KITS
(4) DOOR BRACKET BASES
- CAN BE USED WITH ANY 19 OR 23 INCH EIA STANDARD RACK.
- 3 ROWS OF 2RU 19" CEA OPENINGS (6 TOTAL RU)
- 8FT TALL 12" DOOR SOLD SEPARATELY (P/N: PED1296B1)
- DIMENSIONS IN PARENTHESIS ARE METRIC.
- ALL DIMENSIONS ARE REFERENCE ONLY.

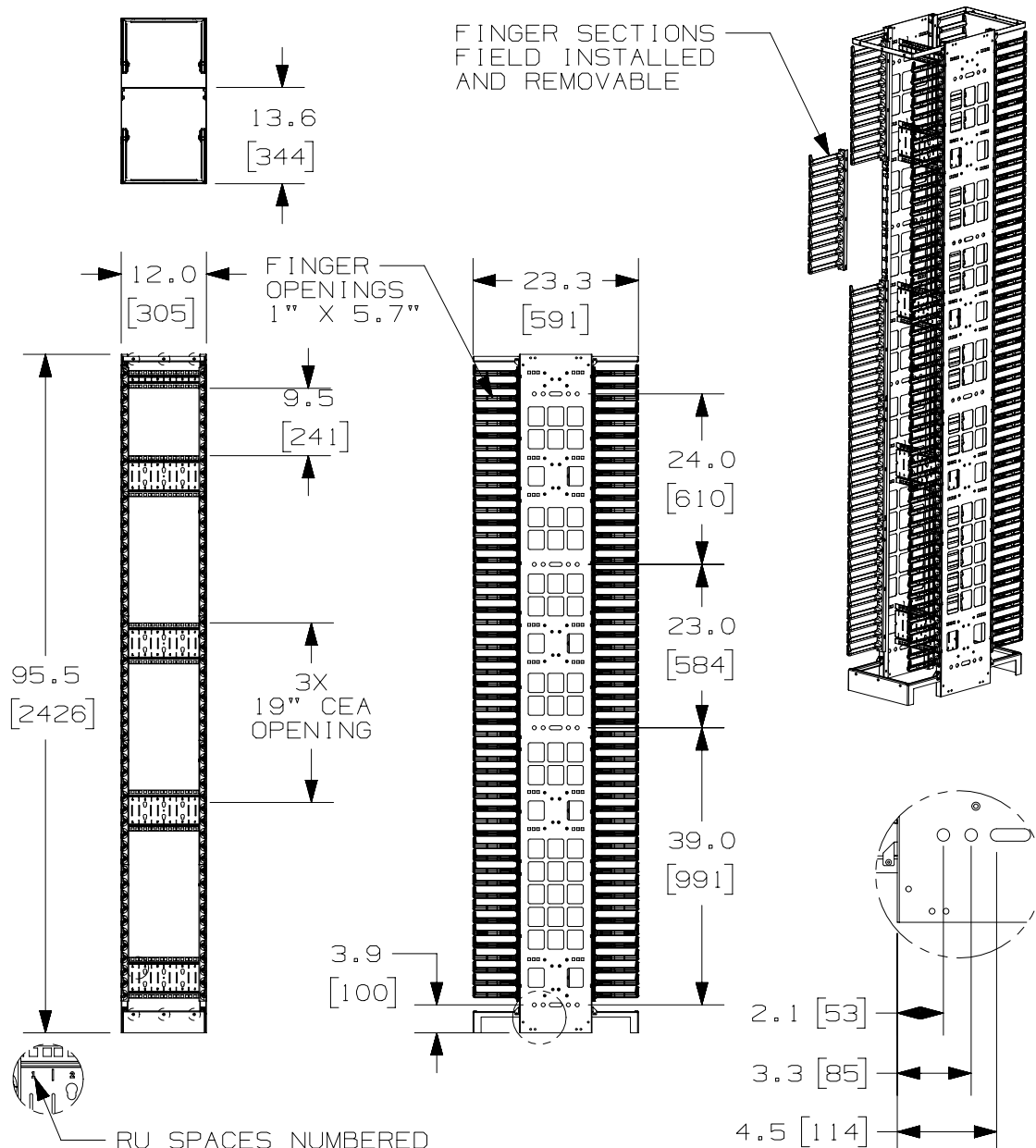

TITLE
PATCHRUNNER HIGH CAPACITY VERTICAL MANAGER 8FT TALL 12" WIDE, DUAL-SIDED (PEV1296)
 CONTROL DRAWING

ITEM REVISION NAME
 10V179AD/04
 DATASET FILE NAME
 10V179AD_DC/04A



UNLESS OTHERWISE SPECIFIED, DIMENSIONAL TOLERANCES ARE:
 ANGLE
 +/- 1°

MATERIAL:
**BACKBONE- STEEL
 FINGERS- ABS**

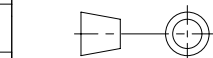

THIRD ANGLE PROJECTION

DRAWING NUMBER:
 10V179AD-DC

04A	3-2-17	TWV	KZU	JEFK	REPLACED P/N PED1296 WITH PED1296B1 IN NOTE #5	10V179AD-DC
03A	7-21-16	AMF	KZU	KRKE	REMOVED DOOR BRACKETS	10V179AD-DC
REV	DATE	BY	CHK	APR	DESCRIPTION	ECN

DRAWN BY BAME	DATE 7-13-11	CHK SRK	SCALE NONE	SHT 1 OF 1	SIZE A
------------------	-----------------	------------	---------------	------------	-----------