

REV.	DESCRIPTION	DATE
A	New Drawing	2022/03/01

Compliance with:
 PCIe4.0(16GTS),
 USB4 Gen3(40Gbps),
 USB3.2 Gen2(10Gbps).
 Mating with:
 "BBBD-XXXG1063BCLI-C"

Specifications:
 Current Rating: 0.3A AC,DC
 Voltage Rating: 30V AC,DC
 Contact Resisittance: 80m ohm.Max
 Insulation Resisittance: 1000M ohm.Min
 Withstanding Voltage: 150V AC/Minute
 Operating Temperature Range:-55°C~+85°C

Material:
 Insulator: Temp Plastic(UL94V-0)
 Insulator Color: Black
 Contact: Copper Alloy
 Plated: Gold Plated

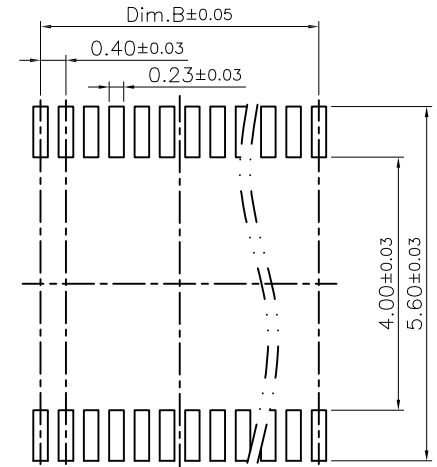
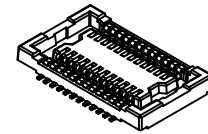
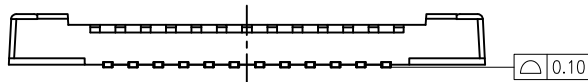
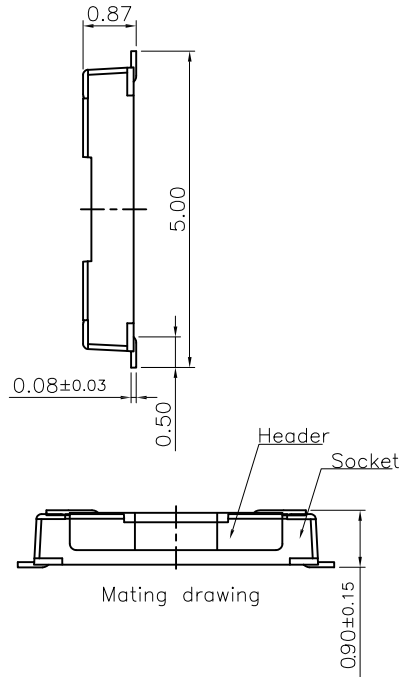
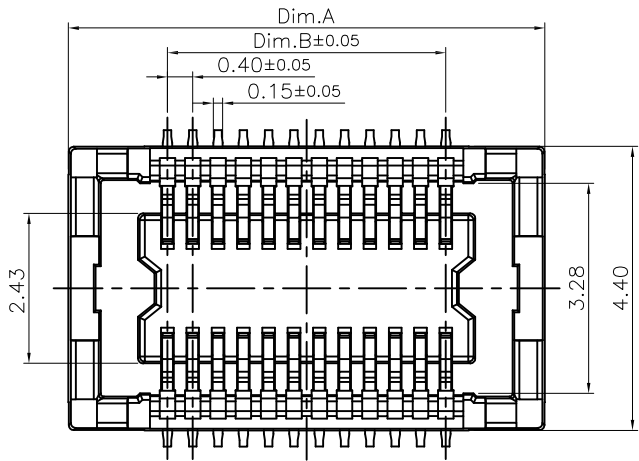

P.C.B Layout

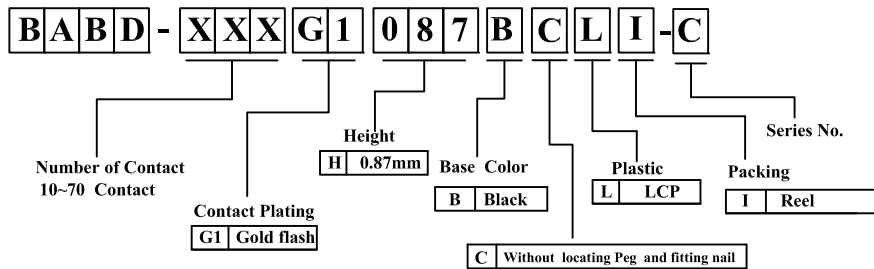

Circuits	Dim.A	Dim.B	Circuits	Dim.A	Dim.B
10	4.70	1.60	40	10.70	7.60
20	6.70	3.60	50	12.70	9.60
24	7.50	4.40	60	14.70	11.60
30	8.70	5.60	70	16.70	13.60

RoHS compliant

Superior Tech Co., Ltd.

General Tolerance

TITLE

PH 0.4mm Female BTB MH0.9mm

X. ± 0.5

DRAWN

DATE

NO.

.X ± 0.3

Tom

03-01-22'

T230

.XX ± 0.2

CHECK

DATE

PART NO.

BABD-XXXG1087BCLI-C

.XXX ± 0.1

APPROVED

DATE

CUSTOMER NO.

DK

REV.

A

UNIT

mm

SCALE

1:1

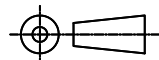

Angle

± 5°

(Q2-R03-01A) ST-R05-07

REV.	DESCRIPTION	DATE
A	New Drawing	2022/03/24

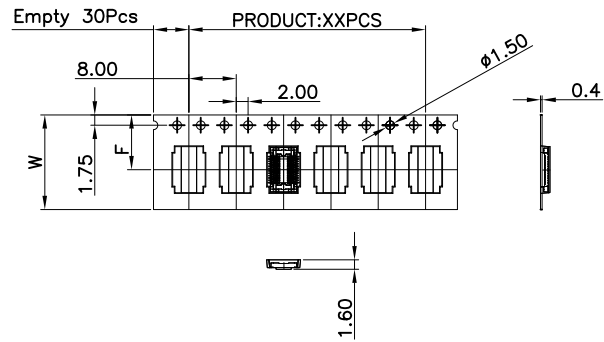
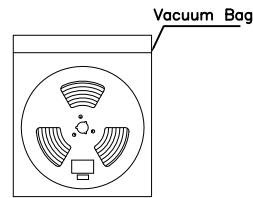
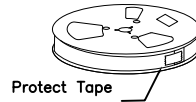
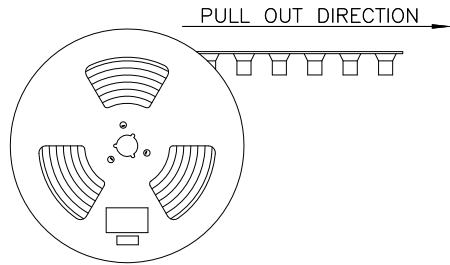
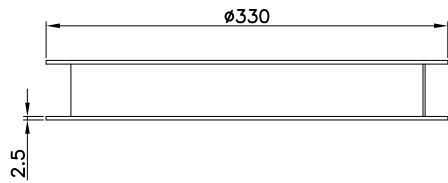

For Reel width (dimension W) 16/24mm.

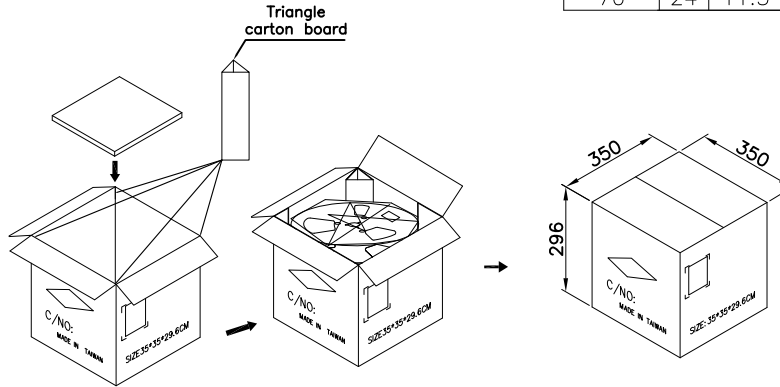

Note:

- All dimensions meet EIA-481-D requirements.
- Material: Transparent Conductive Polystyrene Alloy 100% recyclable.
- Thickness : 0.4±0.05mm
- Component load per 13" reel :5000 pcs.
- Carton Size:
Carton Size:350*350*296(MM)

Pin No.	W	F	PCS/R	R/CTN	Q'TY
10	16	7.5	5000	12	60,000
20	16	7.5	5000	12	60,000
24	16	7.5	5000	12	60,000
30	16	7.5	5000	12	60,000
40	24	11.5	5000	9	45,000
50	24	11.5	5000	9	45,000
60	24	11.5	5000	9	45,000
70	24	11.5	5000	9	45,000

RoHS compliant

Superior Tech Co., Ltd.

General Tolerance		TITLE	BABD-XXXG1087BCLI-C_Packing	
X. ± 0.5	DRAWN	Jacky	DATE	NO.
.X ± 0.3			03-24-22'	T230
.XX ± 0.2	CHECK	Tom	DATE	PART NO.
.XXX ± 0.1			03-24-22'	BABD-XXXG1087BCLI-C
Angle	± 5°	APPROVED	DATE	CUSTOMER NO.
		Tom	03-24-22'	DK

REV.	UNIT	SCALE
A	mm	1:5

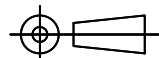

(Q2-R03-01A) ST-R05-07