

PRE-FEED 1 1/8" STROKE
POST-FEED 1 5/8" STROKE

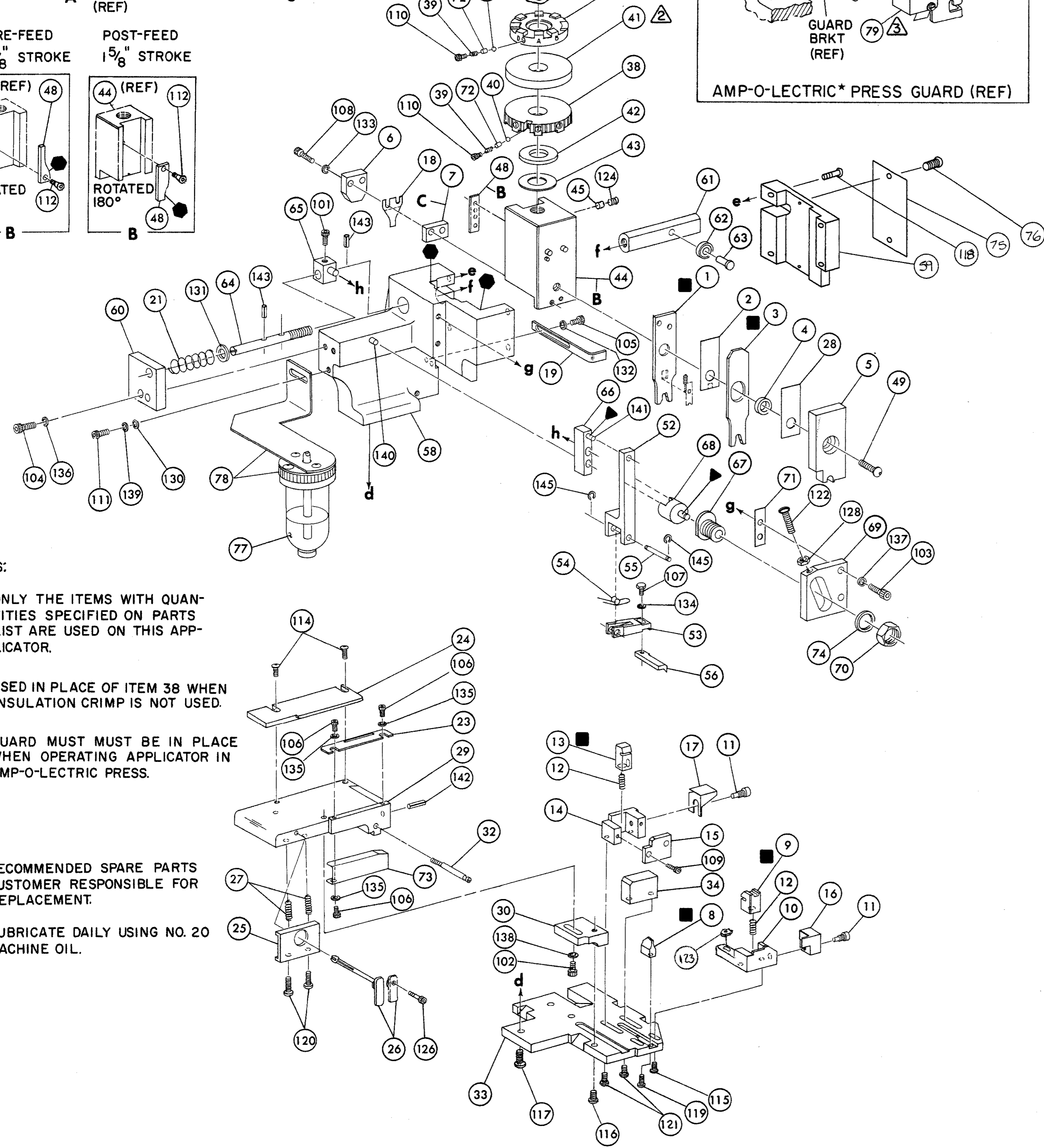
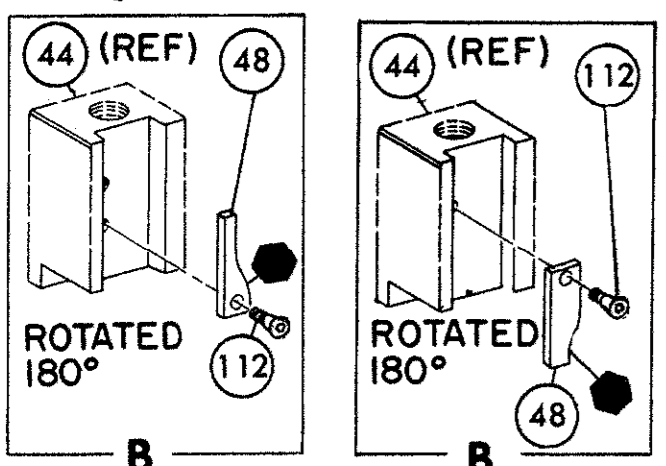

NOTES:

1.- ONLY THE ITEMS WITH QUANTITIES SPECIFIED ON PARTS LIST ARE USED ON THIS APPLICATOR.

2- USED IN PLACE OF ITEM 38 WHEN INSULATION CRIMP IS NOT USED.

3- GUARD MUST BE IN PLACE WHEN OPERATING APPLICATOR IN AMP-O-LECTRIC PRESS.

KEY:

■ - RECOMMENDED SPARE PARTS CUSTOMER RESPONSIBLE FOR REPLACEMENT.

▲ - LUBRICATE DAILY USING NO. 20 MACHINE OIL.

QTY	PART NO	DESCRIPTION	ITEM NO
2	21045-3	RING, RETAINING 'C' (.187 DIA) FEED FINGER PIN	145
2	5-21028-1	PIN, SLOT SPR (.125 DIA X .50) ADJ ROD	144
1	4-21028-0	PIN, SLOT SPR (.093 DIA X .75) STR G PLATE	143
1	1-21030-1	PIN, DOWEL (.187 DIA X .50) LEVER	142
1	1-21030-6	PIN, DOWEL (.187 DIA X 1.25) HOUSING	141
1	21024-5	WASHER, LOCK (NO 10) LUB ASSY	140
1	21024-5	WASHER, LOCK (NO 10) STRIP GUIDE ADJ BLOCK	139
2	21024-5	WASHER, LOCK (NO 10) ADJ PLATE	138
2	21024-5	WASHER, LOCK (NO 10) FEED GUIDE ROD	137
3	21057-2	WASHER, LOCK (NO 4) FRONT STRIP GUIDE	136
1	21024-4	WASHER, LOCK (NO 8) FEED FINGER	135
2	21024-4	WASHER, LOCK (NO 8) DEPRESSOR	134
1	21024-4	WASHER, LOCK (NO 8) STRIPPER	133
1	21899-4	WASHER, FLAT (5/16 DIA) SCREW ADJ	132
1	21899-2	WASHER, FLAT (NO 10) LUB ASSY	131
1	21018-5	NUT, HEX MACH (6-32) HOLDDOWN	130
1	21068-5	NUT, HEX MACH (6-32) FEED ADJ	129
1	22353-8	SCR, SHLD. (.187 DIA X .250 LG) DRAG LEVER	128
1	22651-9	SCR, SKT SET (1/4-20 X .25) (LOC-WEL) RAM	127
1	3-21064-2	SCR, RD HD MACH (6-32 X 1.50) FEED ADJ	126
2	3-21002-0	SCR, BUT HD SKT CAP (10-32 X .88) DRAG	125
1	24073-2	SCR, BUT HD SKT CAP (8-32 X .38) (LOC-WEL) ANVIL	124
4	2-21002-9	SCR, BUT HD SKT CAP (10-32 X .75) CAP	123
3	1-24073-9	SCR, BUT HD SKT CAP (1/4-20 X .75) HOUSING	122
1	2-21002-7	SCR, BUT HD SKT CAP (10-32 X .50) SG ADJ BLOCK	121
2	2-21002-2	SCR, BUT HD SKT CAP (8-32 X .50) SHEAR	120
2	2-21002-2	SCR, BUT HD SKT CAP (8-32 X .50) R STRIP GUIDE	119
1	1-21002-7	SCR, BUT HD SKT CAP (6-32 X .38) CAM	118
1	3-21000-4	SCR, SKT HD CAP (10-32 X .38) LUBRICATOR ASSY	117
2	3-23657-8	SCR, SKT HD CAP (6-32 X .25) (LOC-WEL) CP DISC	116
2	2-21000-7	SCR, SKT HD CAP (6-32 X .50) REAR SHEAR PLATE	115
1	2-22603-0	SCR, HEX HD MACH (8-32 X .31) FEED FINGER	114
3	1-21000-3	SCR, SKT HD CAP (4-40 X .25) F STRIP GUIDE	113
1	2-21000-7	SCR, SKT HD CAP (8-32 X .50) STRIPPER	112
2	3-21000-7	SCR, SKT HD CAP (10-32 X .75) FEED ROD GUIDE	111
2	3-21000-6	SCR, SKT HD CAP (10-32 X .62) FEED ADJ BLOCK	110
1	3-21000-4	SCR, SKT HD CAP (10-32 X .38) SG ADJ BLOCK	109
1	3-21000-4	SCR, SKT HD CAP (10-32 X .38) PIVOT BLOCK	108
REF	455749-1	GUARD, WINDOW	79
1	1-465184-0	LUBRICATOR ASSY OIL, LUBRICATING	78
2	21017-2	SCR, DRIVE (#2 X .19) ID PLATE	77
1	461264-1	PLATE, ID	76
1	458109-1	WASHER, SPECIAL	75
1	454877-3	PLATE, STRIP GUIDE COVER	74
2	690603-1	SPRING, ASSIST	73
1	690517-1	SPACER	72
1	22594-8	NUT, HEX	71
1	240628-1	PLATE, ADJUSTMENT	70
1	240626-1	SHAFT, PIVOT	69
1	240633-1	BUSHING	68
1	455680-1	LEVER, INTERMEDIATE	67
1	240629-1	BLOCK, PIVOT	66
1	240632-2	SCREW, ADJUSTMENT FEED ROD	65
1	240659-3	PIN, CAM ROLLER	64
1	240658-1	ROLLER, CAM	63
1	454398-2	ROD, FEED	62
1	454178-1	GUIDE, FEED ROD	61
1	454220-1	CAP, HOUSING	59
1	454485-1	HOUSING	58
1	458537-2	PAWL, FEED	57
1	240624-1	PIN, FEED FINGER	56
1	691499-1	SPRING, FEED FINGER	55
1	690541-1	FINGER, FEED	54
1	455679-1	LEVER, TERMINAL FEED ARM	53
1	811242-2	BUMPER, HOLDDOWN	52
1	690753-1	SPACER, TONKER	51
1	690686-2	BOLT, CRIMPER	50
1	690501-4	CAM Post FEED 1 5/8 STROKE	49
1	459456-1	APPLICATOR, BASIC (SUB ASSY)	48
1	690191-1	PLUG, NYLON	47
1	455673-1	RAM	46
1	690125-1	WASHER, LAMINATED	45
1	690124-1	WASHER, RAM	44
1	23241-6	DISC, SPACER	43
1	690170-1	BALL, STEEL	42
1	23241-6	SPRING, COMPRESSION	41
1	690142-1	DISC, INSULATION	40
1	7-455029-1	DISC, WIRE	39
1	22480-5	WASHER, SPRING	38
1	690212-1	POST, RAM	37
1	455675-1	SUPPORT, TERMINAL	36
1	690432-3	PLATE, BASE	35
1	455689-1	SCREW, ADJUSTMENT	34
1	455888-8	BLOCK, STRIP GUIDE ADJ	33
1	455888-8	PLATE, STRIP GUIDE	32
1	1-22284-0	SPACER, FRONT SHEAR DEPRESSOR	31
1	1-22284-0	SPRING, DRAG	30
1	240793-1	LEVER, DRAG RELEASE	29
1	240792-1	DRAG, STOCK	28
1	4-690440-1	GUIDE STRIP (REAR)	27
1	690438-1	GUIDE, STRIP (FRONT)	26
1	4-22284-9	SPRING, FEED RETURN	25
1	690472-2	STRIPPER	24
1	690472-2	HOLDER, TERMINAL	23
1	691667-1	GUARD, CHIP (REAR)	22
1	691667-1	GUARD, CHIP (FRONT)	21
1	691667-1	PLATE, SHEAR (REAR)	20
1	691667-1	HOLDER, SHEAR (REAR)	19
1	691667-1	SHEAR, FLOAT (REAR)	18
1	691667-1	SPRING, SHEAR	17
1	691667-1	STOP, SHEAR	16
1	691667-1	HOLDER, SHEAR (FRONT)	15
1	691667-1	SHEAR, FLOAT (FRONT)	14
1	691667-1	ANVIL	13
1	691667-1	SPACER, DEPRESSOR (REAR)	12
1	691667-1	DEPRESSOR, SHEAR (REAR)	11
1	691667-1	DEPRESSOR, SHEAR (FRONT)	10
1	691667-1	SPACER, TUBULAR, INS CRIMPER	9
1	691667-1	CRIMPER, INSULATION	8
1	691667-1	SPACER, CRIMPER	7
1	691667-1	CRIMPER, WIRE	6

CRIMPING DATA				APPLICATOR WILL APPLY
PAD LTR	CRIMP HEIGHT	WIRE SIZE	WIRE STRIP LENGTH	350080
A	.090	(2) 16		
B	.085	14 OR (2) 18		
C	.078	16 OR (2) 20		
D	.073	18 OR (2) 22		

REMARKS		NO	REV
TO APPLY TERMINAL SPEC 114-2084			
APPL USED ON MACHINE PART NO	MACH SERIAL NO	DISTRIBUTION	
CUSTOMER NAME	APPL SERIAL NO	ORIGINAL	
ADDRESS	PURCHASE ORDER	CUSTOMER COPY	
CITY	ENG APP	FIELD ENG COPY	

CRIMP	SIZE	TYPE	FEED	APPL INST
WIRE	.140	F	.530	A1 8040
INSUL	.220	F	.530	A1 8040
WIRE RANGE	INSULATION RANGE PRESS NO			
REMARKS	AMPOMATOR			

QTY	PART NO	DESCRIPTION	ITEM NO
1	G 0150-0761-01	SET UP GAGE 10-1	10-1
1	F 0150-4876-93	DR 11-1-74	11-1
1	E ECN 0150-4143-92	DR 11-1-74	11-1
1	D ECN A-290530	CHK 11-1-74	11-1
1	C ECN A-230090	CHK 11-1-74	11-1
1	B REV PER B3474	CHK 11-1-74	11-1
1	A REV PER ECN R1723	CHK 11-1-74	11-1



AMP INCORPORATED
HARRISBURG, PA.

NO 466355-1

MINIATURE QUICK CHANGE APPLICATOR
SIDE FEED (RING EXTERNAL TOOTH)

THIS DRAWING IS A CONTROLLED DOCUMENT.

RELEASED FOR INFORMATION PURPOSES ONLY. ALL RIGHTS RESERVED. © AMP INCORPORATED 2001