

PRE-FEED 1/8" STROKE
POST-FEED 15/8" STROKE

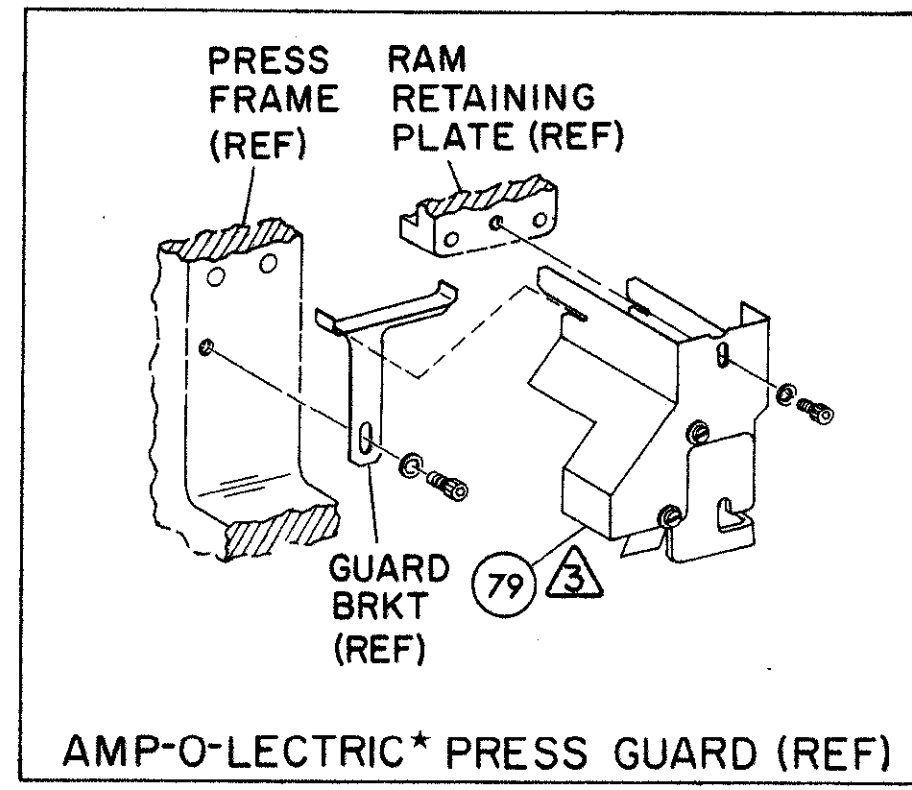

NOTES:
1- ONLY THE ITEMS WITH QUANTITIES SPECIFIED ON PARTS LIST ARE USED ON THIS APPLICATOR.
2- USED IN PLACE OF ITEM 38 WHEN INSULATION CRIMP IS NOT USED.
3- GUARD MUST BE IN PLACE WHEN OPERATING APPLICATOR IN AMP-O-LECTRIC PRESS.
KEY:
■ - RECOMMENDED SPARE PARTS CUSTOMER RESPONSIBLE FOR REPLACEMENT.
▲ - LUBRICATE DAILY USING NO. 20 MACHINE OIL.

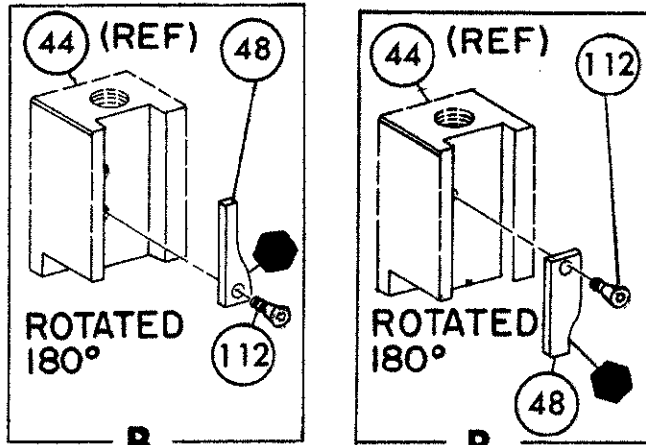
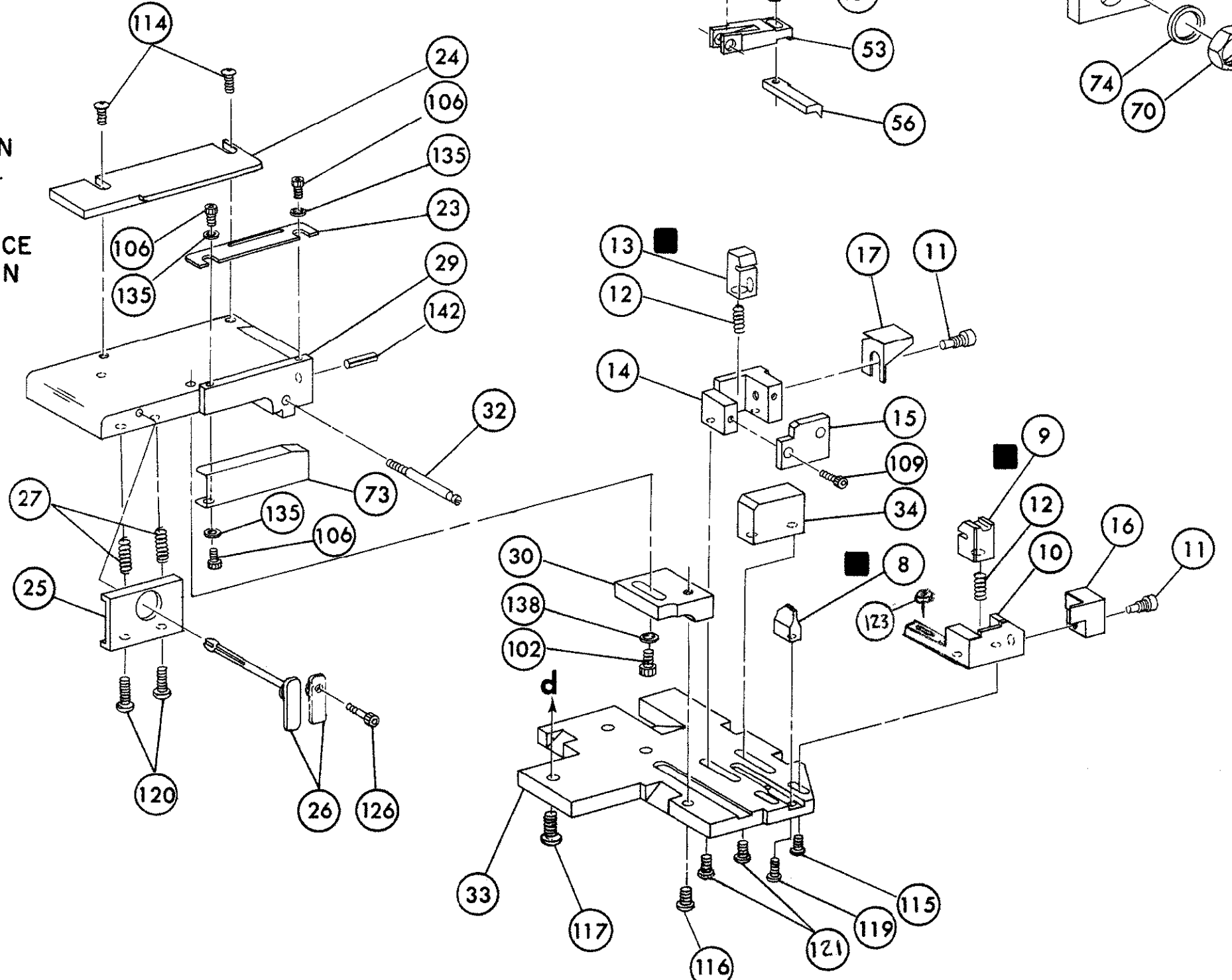

QTY	PART NO	DESCRIPTION	ITEM NO
2	21045-3	RING, RETAINING 'C' (.187 DIA) FEED FINGER PIN	145
			144
			143
2	5-21028-1	PIN, SLOT SPR (.125 DIA X .50) ADJ ROD	142
1	4-21028-0	PIN, SLOT SPR (.093 DIA X .75) STR G PLATE	141
1	1-21030-1	PIN, DOWEL (.187 DIA X .50) LEVER	140
1	1-21030-6	PIN, DOWEL (.187 DIA X 1.25) HOUSING	139
1	21024-5	WASHER, LOCK (NO 10) LUB ASSY	138
1	21024-5	WASHER, LOCK (NO 10) STRIP GUIDE ADJ BLOCK	137
2	21024-5	WASHER, LOCK (NO 10) ADJ PLATE	136
2	21024-5	WASHER, LOCK (NO 10) FEED GUIDE ROD	135
3	21057-2	WASHER, LOCK (NO 4) FRONT STRIP GUIDE	134
1	21024-4	WASHER, LOCK (NO 8) FEED FINGER	133
2	21024-4	WASHER, LOCK (NO 8) DEPRESSOR	132
1	21024-4	WASHER, LOCK (NO 8) STRIPPER	131
1	21899-4	WASHER, FLAT (5/16 DIA) SCREW ADJ	130
1	21899-2	WASHER, FLAT (NO 10) LUB ASSY	129
1	21018-5	NUT, HEX MACH (6-32) HOLDDOWN	128
1	21068-5	NUT, HEX MACH (6-32) FEED ADJ	127
1	22353-8	SCR, SHLD. (.187 DIA X .250 LG) DRAG LEVER	126
1	456567-1	SCR SHLD (.187 DIA X .25 LG) STRIPPER	125
1	21009-2	SCR, SKT SET (1/4-20 X .25) (LOC-WEL) RAM	124
2	1-21124-0	NUT, HEX	123
1	3-21064-2	SCR, RD HD MACH (6-32 X 1.50) FEED ADJ	122
2	2-21002-3	SCR, BHC (8-32 X .62)	121
2	3-21002-0	SCR, BUT HD SKT CAP (10-32 X .50) DRAG	120
1	2-2733-8	SCR, BUT HD SKT CAP (8-32 X .38) (LOC-WEL) ANVIL	119
4	2-21002-9	SCR, BUT HD SKT CAP (10-32 X .75) CAP	118
3	2-2733-8	SCR, BUT HD SKT CAP (1/4-20 X .62) HOUSING	117
1	2-21002-7	SCR, BUT HD SKT CAP (10-32 X .50) SG ADJ BLOCK	116
2	2-21002-2	SCR, BUT HD SKT CAP (8-32 X .50) SHEAR	115
2	2-21002-2	SCR, BUT HD SKT CAP (8-32 X .50) R STRIP GUIDE	114
1	1-21002-7	SCR, BUT HD SKT CAP (6-32 X .38) CAM	113
1	3-21000-4	SCR, SKT HD CAP (10-32 X .38) LUBRICATOR ASSY	112
2	23030-1	SCR, SKT HD CAP (6-32 X .25) (LOC-WEL) CP DISC	111
1	2-21000-7	SCR, SKT HD CAP (8-32 X .50) STRIPPER	110
2	3-21000-7	SCR, SKT HD CAP (10-32 X .75) FEED ROD GUIDE	109
2	3-21000-6	SCR, SKT HD CAP (10-32 X .62) FEED ADJ BLOCK	108
1	3-21000-4	SCR, SKT HD CAP (10-32 X .38) SG ADJ BLOCK	107
1	3-21000-4	SCR, SKT HD CAP (10-32 X .38) PIVOT BLOCK	106
REF	455749-1	GUARD, WINDOW	79
1	1-465184-0	LUBRICATOR ASSY	78
REF	852931-2	OIL, LUBRICATING	77
2	21017-2	SCR, DRIVE (#2 X .19) ID PLATE	76
1	461264-1	PLATE, ID	75
1	458109-1	WASHER, SPECIAL	74
1	454877-3	PLATE, STRIP GUIDE COVER	73
2	690603-1	SPRING, ASSIST	72
1	690517-1	SPACER	71
1	22594-8	NUT, HEX	70
1	240628-1	PLATE, ADJUSTMENT	69
1	240626-1	SHAFT, PIVOT	68
1	240633-1	BUSHING	67
1	455680-1	LEVER, INTERMEDIATE	66
1	240629-1	BLOCK, PIVOT	65
1	240632-2	SCREW, ADJUSTMENT FEED ROD	64
1	240659-3	PIN, CAM ROLLER	63
1	240658-1	ROLLER, CAM	62
1	454398-2	ROD, FEED	61
1	454178-1	GUIDE, FEED ROD	60
QTY	PART NO	DESCRIPTION	ITEM NO
CRIMPING DATA			
PAD LTR	CRIMP HEIGHT	WIRE SIZE	WIRE STRIP LENGTH
A	.070	(2) 16	
B	.085	14 or (2) 18	
C	.078	16 or (2) 20	
D	.073	18 or (2) 22	
CRIMP SIZE	TYPE	FEED	APPL INST
WIRE	.140	F	.530 A1 8040
INSUL	.220	F	
WIRE RANGE	INSULATION RANGE	PRESS NO	
18-14	085-120	563435-5	
REMARKS			
AMP-O-LECTRIC PRE FEED			
APPL USED ON MACHINE PART NO			
MACH SERIAL NO			
DISTRIBUTION			
CUSTOMER NAME			
APPL SERIAL NO			
ORIGINAL			
ADDRESS			
PURCHASE ORDER			
CUSTOMER COPY			
CITY			
ENG APP			
FIELD ENG COPY			

REVISION RECORD	APP DATE	REVISION RECORD	APP DATE
N	ECN 0150-1167-04	11/17/94	
M	ECN 0150-0695-04	5-24-94	
L	0150-0761-01	7-01-94	
K	0150-4876-93	3-93	
J	ECN 0150-4143-92	11-32-92	
H	ECN A-272190	10-10-90	
G	ECN A-240590	11-2-90	
F	ECN A-230890	11-19-90	
E	ECN A188288	11-11-88	
D	REV PER ECN A-124402	11-11-88	
C	REV PER R3474	11-11-88	
B	REV PER ECN R1723	11-11-88	
A	REV PER ECN R1555	11-11-88	

THIS DRAWING IS A CONTROLLED DOCUMENT.

27 JUL 94
RELEASED FOR INSPECTION
BY AMP INCORPORATED
© COPYRIGHT 1994 AMP INCORPORATED



LOC A D NO 406355-2
MINIATURE QUICK CHANGE APPLICATOR
SIDE FEED (RING (EXTERNAL TOOTH))
CUSTOMER AND ASSEMBLY DRAWING