

REVISIONS					
REV	ECO	DESCRIPTION	DATE	BY	APPR
A1	-	RELEASE	14MAY19	SULLEN	TOMMY

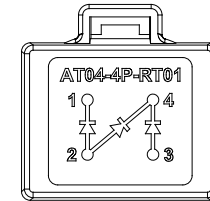

NOTES: UNLESS OTHERWISE SPECIFIED

- MATERIAL:
HOUSING: THERMOPLASTIC, BLACK
CONTACT: COPPER ALLOY
CONTACT PLATING: NICKEL PLATED
- MODIFICATIONS: DIODE
- SPECIFICATIONS:
 - DIODE P/N: MUR460G
 - PEAK REVERSE VOLTAGE: 600.0 V MAX.
 - PEAK FORWARD VOLTAGE: 1.28 V MAX.
 - AVERAGE FORWARD CURRENT: 4.0 A MAX.
 - OPERATING TEMPERATURE: -55°C TO +125°C
 - MOISTURE RESISTANCE: IP67
 - MATING CYCLE DURABILITY: 100 CYCLES
 - RoHS COMPLIANT
- MATING PART: AT06-4S*
(* = ALL MODIFICATIONS)
- ALL DIMENSIONS ARE FOR REFERENCE USE ONLY

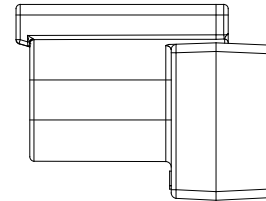
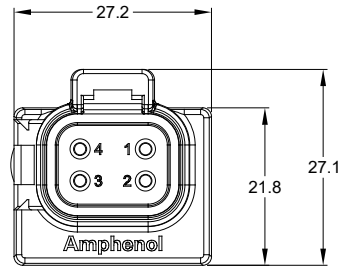
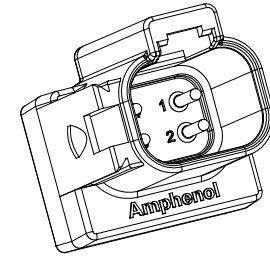
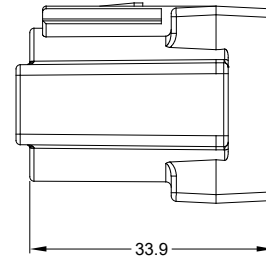
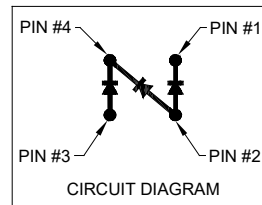

AT04-4P-RT01		REF: DT04-4P-RT01	
PART NUMBER		DESCRIPTION	
ITEM		ITEM	
QUANTITY		MATERIALS LIST	
UNLESS OTHERWISE SPECIFIED: 1) All dimensions are in metric (mm). 2) Tolerances are as follows: 1 PL DEC ±0.30 2 PL DEC ±0.15 3 PL DEC ±0.08 Fractions ±1/64 Angles ±1°		SIGNATURES DATE DRAWN: SULLENZHANG 19SEP18 CHECKED: ORION LI 19SEP18 ENGINEER: APPROVAL: TOMMY XIE 19SEP18	
MATERIAL SPECIFICATIONS:		CUSTOMER:	
PROCESS SPECIFICATIONS:		THIS DRAWING IS SUPPLIED FOR INFORMATION ONLY. DESIGN FEATURES, SPECIFICATIONS AND PERFORMANCE DATA SHOWN HEREON ARE THE PROPERTY OF THE AMPHENOL CORPORATION. NO RIGHTS OF REPRODUCTION ARE IMPLIED. ALL DIMENSIONS ARE SUBJECT TO NORMAL MANUFACTURING VARIATIONS.	
NEXT ASSY:		SCALE: NONE	
		Amphenol Sine Systems - www.amphenol-sine.com 44724 Morley Drive Clinton Township, MI 48036 RECEPTACLE 4PIN, TERMINATOR, AT SERIES	
		SIZE: B C- DWG NO: AT04-4P-RT01 REVISION: A1 SHEET 1 OF 1	

TITLE: RECEPTACLE 4PIN, TERMINATOR, AT SERIES
 DWG NO: AT04-4P-RT01
 REV: A1
 SH: 1
 OF: 1