

NOTES: UNLESS OTHERWISE SPECIFIED

1. CONSTRUCTION:  
 HOUSING: MOLDED NYLON AVAILABLE IN ALL TEN COLORS  
 FRAME: NICKEL PLATED BRASS.  
 CONTACT: NICKEL PLATED BeCu OR PHOSPHOR BRONZE.
2. PERFORMANCE:  
 MAXIMUM CURRENT: 15 AMPS  
 MAXIMUM VOLTAGE: 3500 VRMS  
 MAXIMUM TEMPERATURE: 200°F (93°C)

LTR	REVISIONS		DATE	APPROVED
	DESCRIPTION			

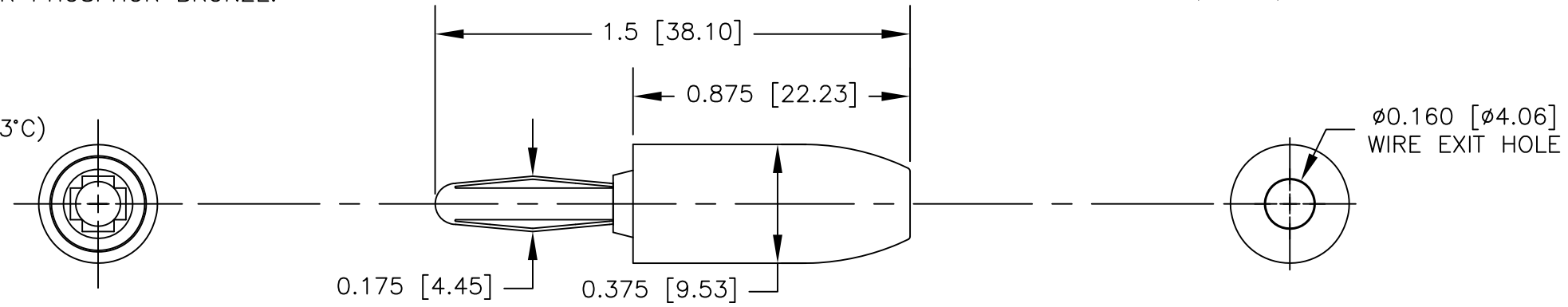

### ASSEMBLY INSTRUCTIONS

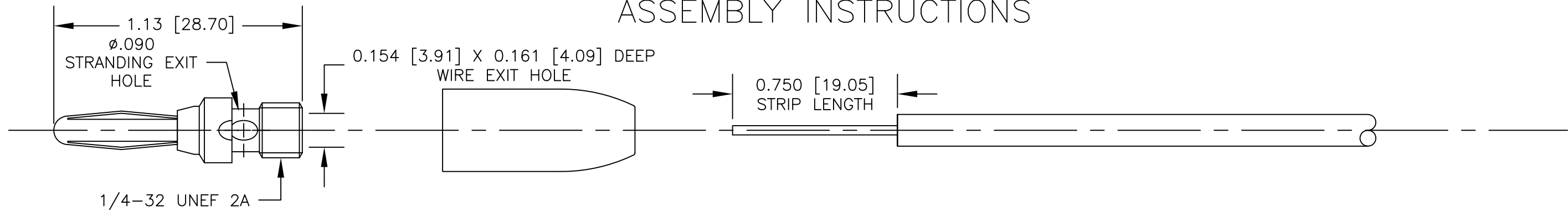

WRAP THE STRANDING UNDERNEATH THE THREADED SECTION OF THE BANANA PLUG IN A CLOCKWISE DIRECTION.  
 \*\*\*\*\*  
 NOTE: PLACING THE STRANDING ABOVE THE THREADED SECTION WILL CAUSE THE STRANDING TO BREAK OFF.

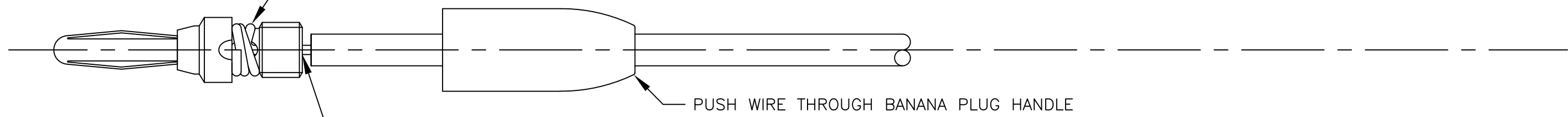

INSERT WIRE THROUGH WIRE EXIT HOLE. PUSH WIRE STRANDING THROUGH THE STRANDING EXIT HOLE.

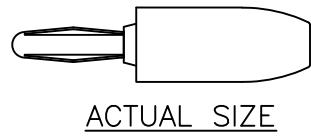
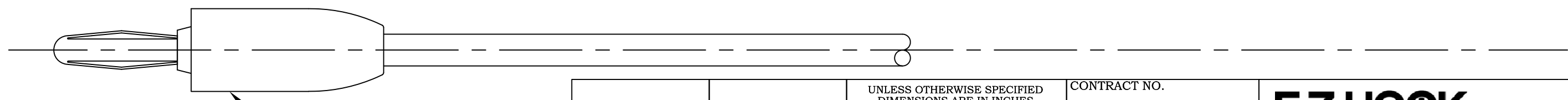

		UNLESS OTHERWISE SPECIFIED DIMENSIONS ARE IN INCHES TOLERANCES ARE: FRACTIONS DECIMALS ANGLES $\pm N/A$ .XX $\pm N/A$ $\pm N/A$ .XXX $\pm N/A$		CONTRACT NO.		<b>E-Z-HOOK</b> DIVISION OF TEKTEST INC. ARCADIA, CA 91006 U.S.A.			
		MATERIAL SEE NOTE		APPROVALS	DATE			DESCRIPTION	
		FINISH SEE NOTE		DRAWN	R.L.	4/17	STANDARD BANANA PLUG		
NEXT ASSY		USED ON		APPROVED BY		SIZE	CODE IDENT NO.	DRAWING NO.	REV.
APPLICATION		DO NOT SCALE DRAWING				B	08505	9202	
						SCALE	2:1		SHEET 1 OF 1