

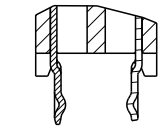

Copyright FCI.

PRODUCT NO
10046971-047LF

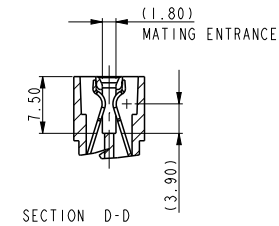
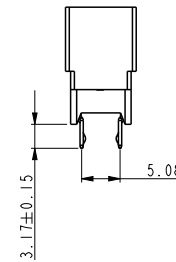
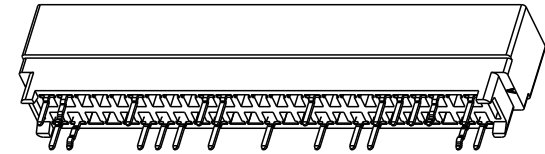
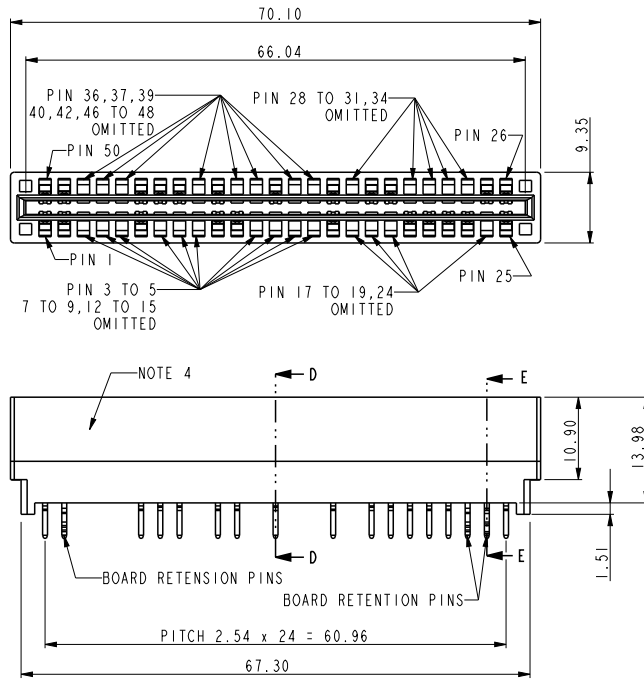

SECTION E-E
SCALE 2.000
BOARD RETENSION PINS

NOTE:

1. MATERIAL:

HOUSING: HIGH TEMPERATURE THERMOPLASTIC,
UL 94 V-0 FLAME RETARDANT.

TERMINAL: HIGH CONDUCTIVITY COPPER ALLOY.
PLATING SPEC AS BELOW:

Ni 50u" UNDER PLATED.
Au 30u" OVER CONTACT AREA (ONE SIDE)
MATTE TIN 120u" OVER SOLDERING AREA.

2. PACKING SPEC. GS-14-937

3. PRODUCT SPEC. GS-12-338.

4. MANUFACTURER'S NAME, P/N AND DATE CODE
TO APPEAR ON THIS SURFACE AS PER GS-24-007.

5. PART NUMBER 10046971-047LF MEETS EUROPEAN UNION DIRECTIVE AND OTHER
COUNTRY REGULATIONS AS DESCRIBED IN GS-22-008.

THE HOUSING WILL WITHSTAND EXPOSURE TO 260°C PEAK TEMPERATURE FOR 10 SECONDS
IN A WAVE SOLDER APPLICATION WITH A CIRCUIT BOARD.

6. THE PINS 3 TO 5, 7 TO 9, 12 TO 15, 17 TO 19, 24, 28 TO 31, 34, 36, 37, 39, 40,
42, 46 TO 48 ARE OMITTED.

spec ref	*	dr	Julia Wang	2014/02/13	projection	MM	size	A4	scale	1.000
tolerance std	TOLERANCES UNLESS OTHERWISE SPECIFIED	eng	De-Ming Lu	2014/02/26			ecn no	-	rel level	Released
ISO 406 ISO 1101		chr	-	-						
surface	linear	appr	Pei-Ming Zheng	2014/02/26	product family	Power edge card	rel level	Released	dwg no	10046971-047
ISO 1302	angular				title	VERTICAL TYPE 2X25P (OMITTED 27P)	rev	A	cat. no.	Product - Customer Drw
	0.X ±0.50 0.XX ±0.25 0.XXX ±0.13									sheet 1 of 2
	0° ±2°									

PRODUCT NO
10046971-047LF

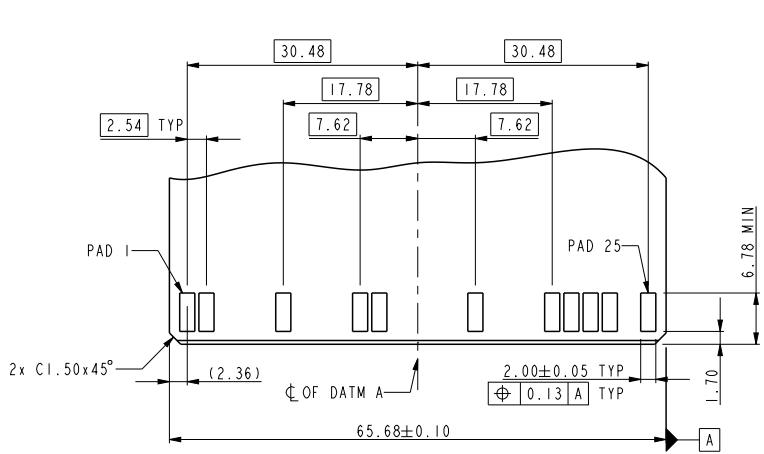

RECOMMENDED MATING BOARD

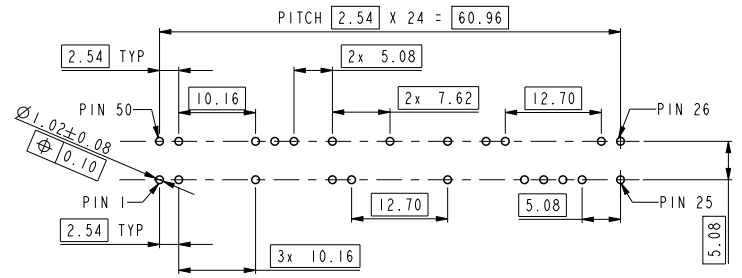
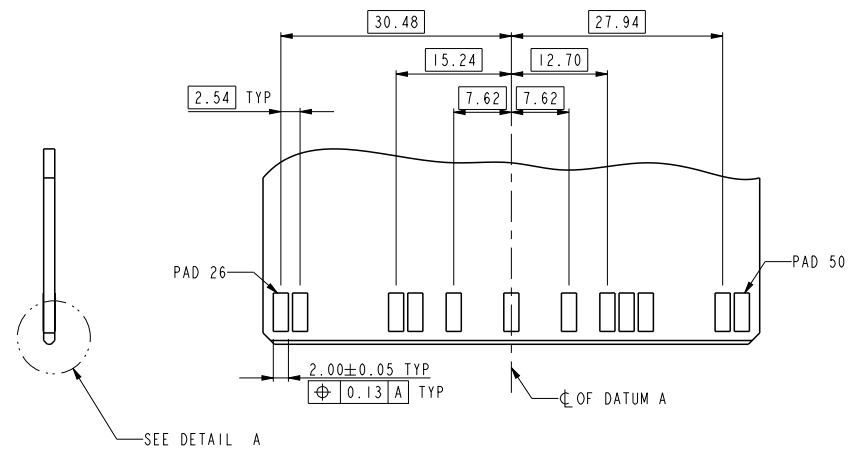

RECOMMENDED PC BOARD LAYOUT AND THE THICKNESS IS 2.36mm

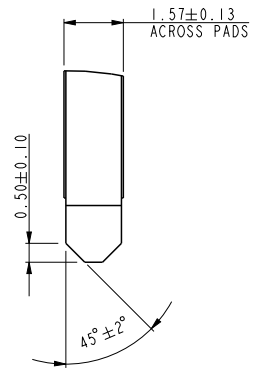

DETAIL A SCALE 5.000



Copyright FCI.

spec ref	*	dr	Julia Wang	2014/02/13	projection	MM	size	A4	scale	1.000
tolerance std	TOLERANCES UNLESS OTHERWISE SPECIFIED	eng	De-Ming Lu	2014/02/26		←→	ecn no	-	rel level	Released
ISO 406		chr	-	-						
ISO 1101		appr	Pei-Ming Zheng	2014/02/26	product family	Power edge card				
surface	linear	0.X	±0.50		title	VERTICAL TYPE	dwg no	10046971-047	rev	A
		0.XX	±0.25							
		0.XXX	±0.13							
ISO 1302	angular	0°	±2°	www.fci.com	cat. no.	*	Product - Customer Drw	sheet 2 of 2		

ProjE File - REV C - 2009-06-09