

LOC	DIST	REV	DESCRIPTION	DATE	DWN	APPD
GP	0					
B		REV: EC 001C-0007-01		22JAN01	JA	TW
C		REVISED PER EC 0S15-0450-02		21JAN2003	DLD	RPM
D		REVISED PER EC 0S15-0324-03		08DEC03	JB	CF

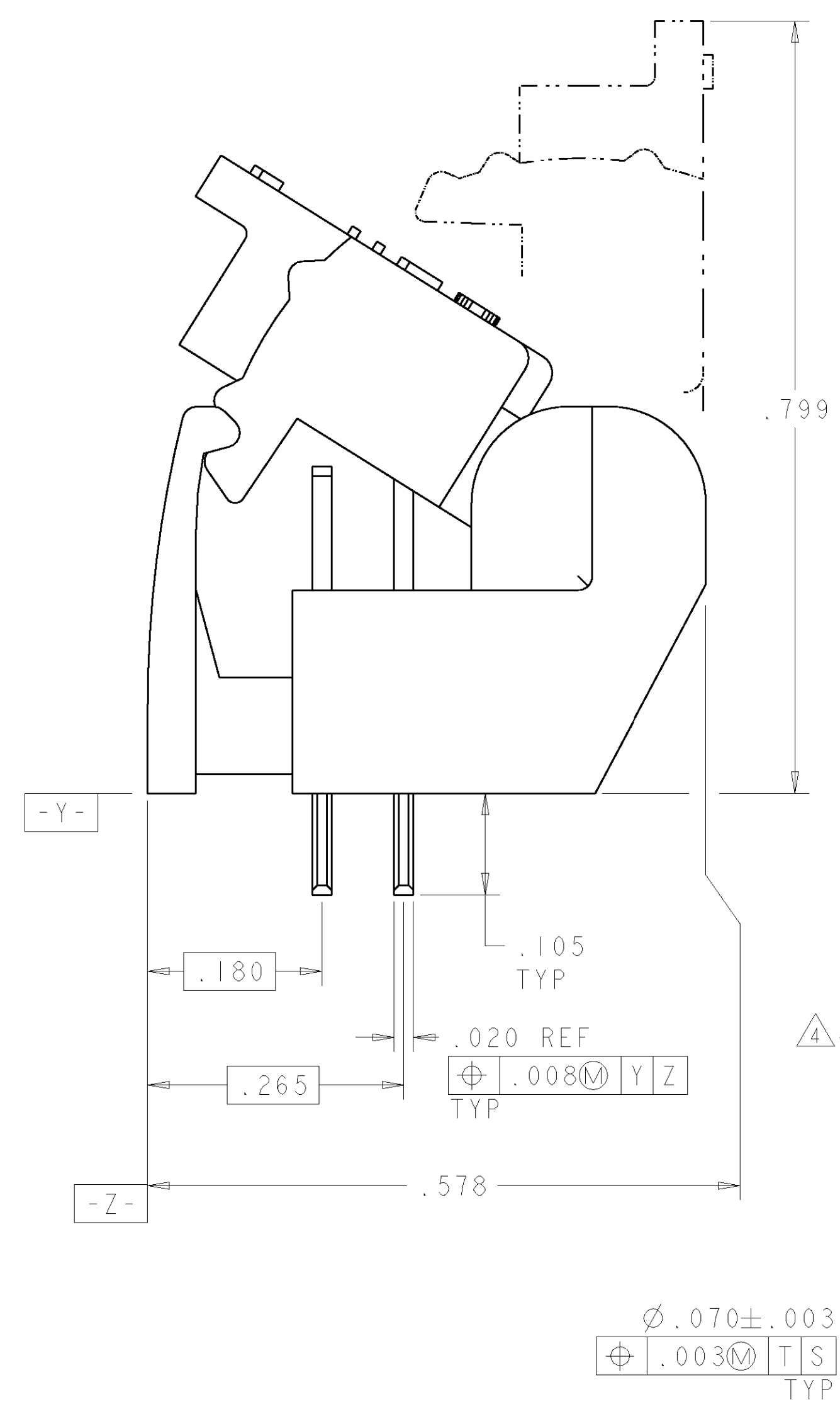

- △ MATERIAL: BASE - POLYESTER MOLDING COMPOUND, BLACK.  
 WIRE STUFFER: - POLYESTER MOLDING COMPOUND, SEE TABLE FOR COLOR.  
 TERMINAL - COPPER ALLOY, PLATED WITH 3.81μm MINIMUM THICK TIN OVER 1.27μm MINIMUM THICK NICKEL UNDERPLATE.
- △ EACH WIRE ENTRY HOLE ACCEPTS ONE UNSTRIPPED SOLID COPPER 22-26 AWG WIRE WITH WIRE INSULATION DIAMETER RANGE FROM .060 THROUGH .040. OTHER WIRE SIZES AND TYPES SHALL BE SUBMITTED TO AMP ENGINEERS FOR APPLICATION APPROVAL.
- 3. SOLDER TABS PROVIDED FOR PERMANENT BOARD MOUNTING.
- △ LOCATION OF HOLE PATTERN DETERMINED BASED ON CUSTOMER REQUIREMENTS.

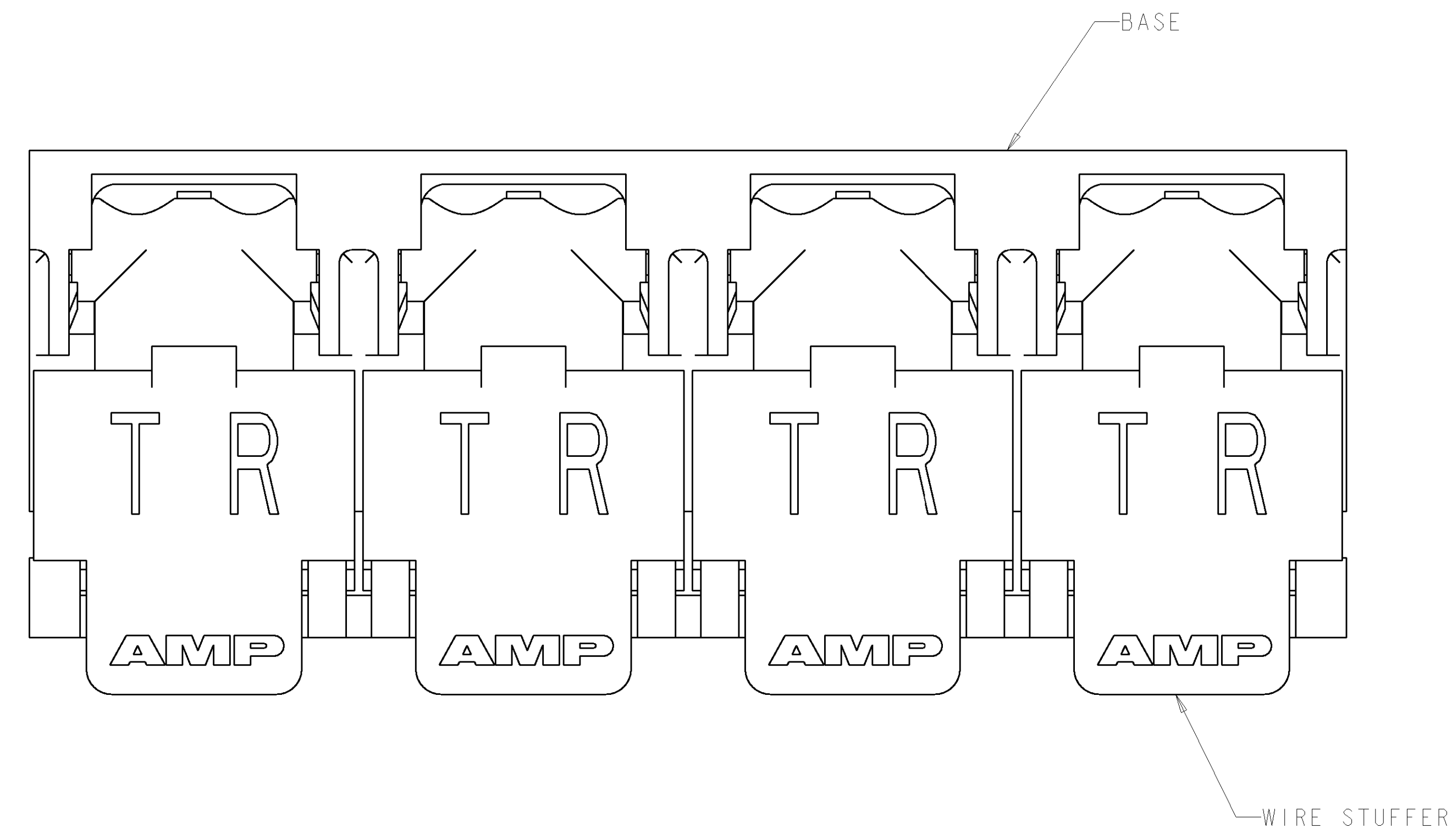
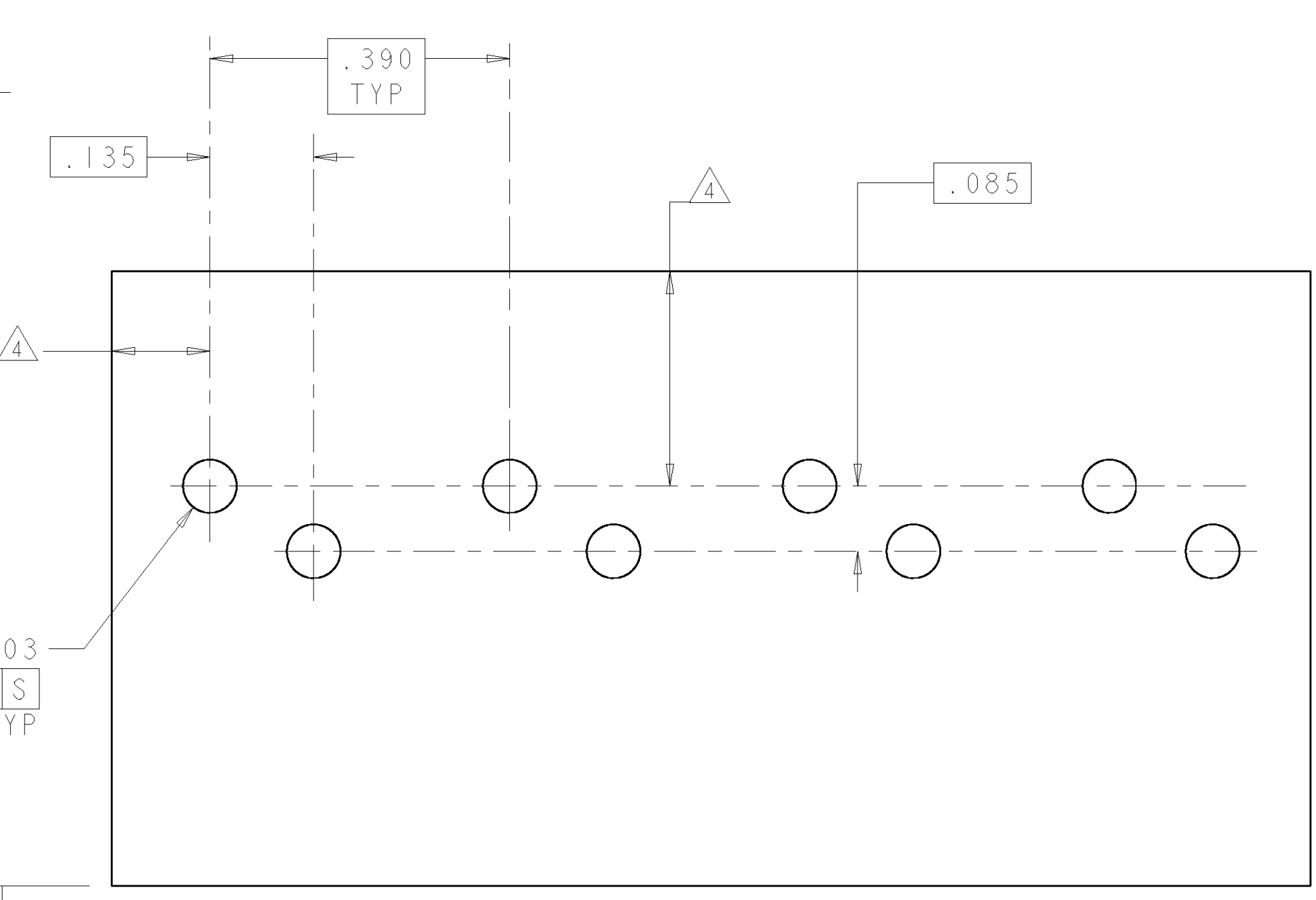

SUGGESTED PRINTED CIRCUIT BOARD MOUNTING DIMENSIONS VIEWED FROM SOLDER SIDE

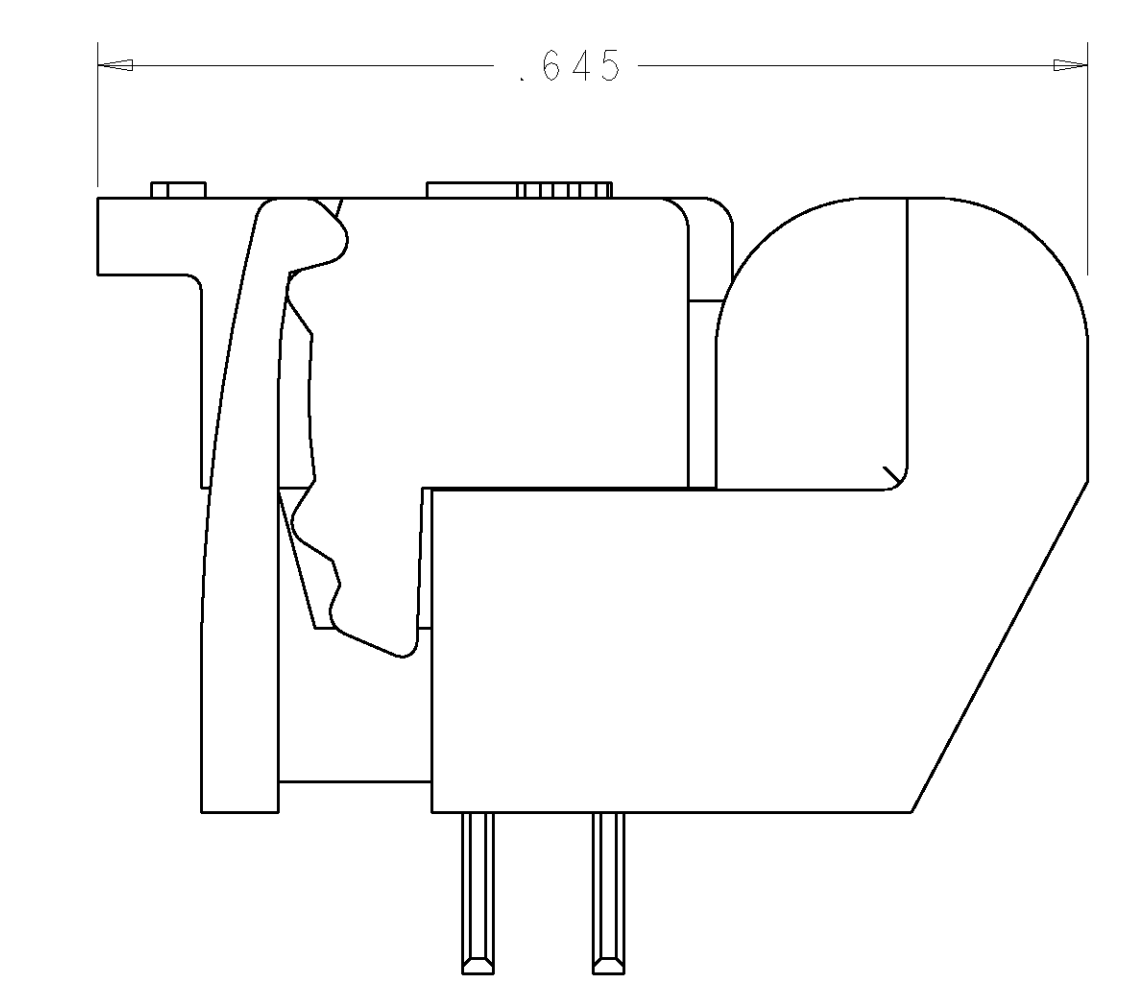
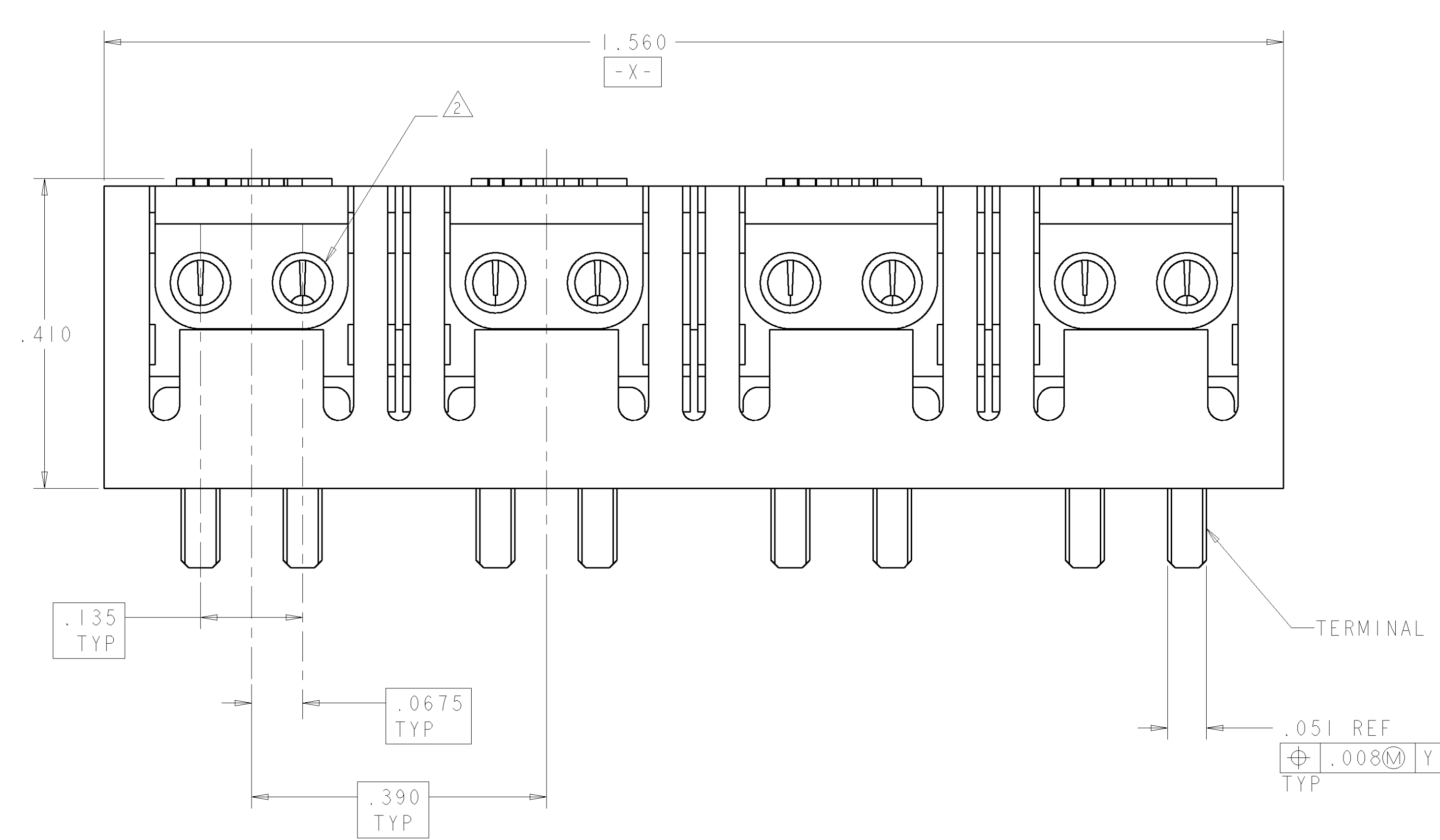

CLOSED POSITION

BLACK	1339375-2
CLEAR	1339375-1
STUFFER COLOR	PART NUMBER

DIMENSIONS: INCHES		TOLERANCES UNLESS OTHERWISE SPECIFIED:	
Ø	PLC	±	
1	PLC	±	.01
2	PLC	±	.005
3	PLC	±	
4	PLC	±	
MATERIAL		FINISH	

DRAWN	J. AHERON	30NOV00	NAME	ASSEMBLY, FOUR PAIR, DOUBLE ENTRY, PIVOT II CONNECTOR
CHKD	S. ROBERTSON	30NOV00	PRODUCT SPEC	
APVD			APPLICATION SPEC	
SIZE	A1	CAGE CODE	00779	DRAWING NO
SCALE	8:1	REV		