

THIS DRAWING IS UNPUBLISHED.
 © COPYRIGHT BY TYCO ELECTRONICS CORPORATION. ALL RIGHTS RESERVED.

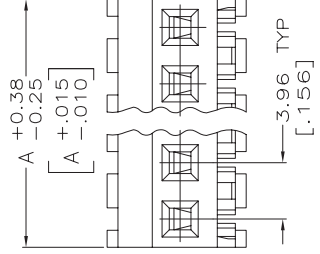

- 1 MATERIAL: CONNECTOR - NYLON UL94V-2 (WHITE). CONTACTS - 0.30[.012] THICK COPPER ALLOY. PLATING - 0.00038[.000015] GOLD IN CONTACT AREA. 0.00203[.000080] MIN THICKNESS BRIGHT TIN-LEAD IN SLOT AREA FOR 641151-2 THRU 2-641151-4 OR MATTE WHISKER MITIGATED TIN IN SLOT AREA FOR 3-641151-2 THRU 5-641151-4 OVER NICKEL UNDERPLATE.
2. CONTACTS ACCEPT 24 AWG WIRE WITH 2.41[.095] MAX INSULATION DIAMETER.
3. CONTACTS MUST ACCEPT 1.14±0.03[.045±.001] SQUARE POST AND REMAIN LOCKED IN POSITION.
- 4 IDENTIFICATION NUMBER FOR LAST CIRCUIT MAY NOT APPEAR ON ALL ASSEMBLIES.
5. DIMENSIONS IN BRACKETS ARE IN INCHES.
6. HOUSING FEATURES ARE: FEED-THRU WITHOUT LOCKING RAMP.

NOTE DELETED.
 NOTE DELETED.

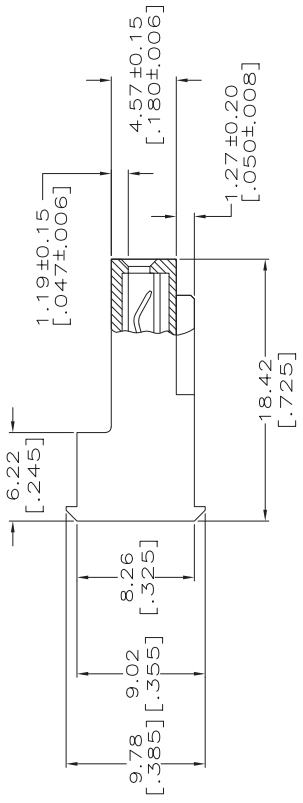
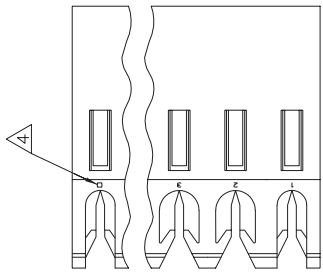

LOC CM O
 P LTR H
 ECO-07-012886

REVISIONS
 DESCRIPTION DATE
 22JUN07 KW DB

95.10	3.744	24	5-641176-4
91.14	3.588	23	5-641176-3
87.17	3.432	22	5-641176-2
83.21	3.276	21	5-641176-1
79.25	3.120	20	5-641176-0
75.29	2.964	19	4-641176-9
71.32	2.808	18	4-641176-8
67.36	2.652	17	4-641176-7
63.40	2.496	16	4-641176-6
59.44	2.340	15	4-641176-5
55.47	2.184	14	4-641176-4
51.51	2.028	13	4-641176-3
47.55	1.872	12	4-641176-2
43.59	1.716	11	4-641176-1
39.62	1.560	10	4-641176-0
35.66	1.404	9	3-641176-9
31.70	1.248	8	3-641176-8
27.74	1.092	7	3-641176-7
23.77	0.936	6	3-641176-6
19.81	0.780	5	3-641176-5
15.85	0.624	4	3-641176-4
11.89	0.468	3	3-641176-3
7.92	0.312	2	3-641176-2
95.10	3.744	24	2-641176-4
91.14	3.588	23	2-641176-3
87.17	3.432	22	2-641176-2
83.21	3.276	21	2-641176-1
79.25	3.120	20	2-641176-0
75.29	2.964	19	1-641176-9
71.32	2.808	18	1-641176-8
67.36	2.652	17	1-641176-7
63.40	2.496	16	1-641176-6
59.44	2.340	15	1-641176-5
55.47	2.184	14	1-641176-4
51.51	2.028	13	1-641176-3
47.55	1.872	12	1-641176-2
43.59	1.716	11	1-641176-1
39.62	1.560	10	1-641176-0
35.66	1.404	9	641176-9
31.70	1.248	8	641176-8
27.74	1.092	7	641176-7
23.77	0.936	6	641176-6
19.81	0.780	5	641176-5
15.85	0.624	4	641176-4
11.89	0.468	3	641176-3
7.92	0.312	2	641176-2

THIS DRAWING IS A CONTROLLED DOCUMENT.
 DIMENSIONS: mm [INCHES]
 TOLERANCES UNLESS SHOWN OTHERWISE:
 0 PL ± .010 [0.000]
 1 PL ± .010 [0.000]
 2 PL ± .010 [0.000]
 3 PL ± .010 [0.000]
 4 PL ± .010 [0.000]
 ANGLES FINISH

CONTRACT FINISH DIM A NO. OF CIRCUITS PART NO.
 TIN-LEAD 47.55 1.872 12 1-641176-2
 43.59 1.716 11 1-641176-1
 39.62 1.560 10 1-641176-0
 35.66 1.404 9 641176-9
 31.70 1.248 8 641176-8
 27.74 1.092 7 641176-7
 23.77 0.936 6 641176-6
 19.81 0.780 5 641176-5
 15.85 0.624 4 641176-4
 11.89 0.468 3 641176-3
 7.92 0.312 2 641176-2

REV B. LEWIS 3-11-98 Tyco Electronics Tyco Electronics Corporation Harrisburg, Pa 17105-3608
 OK SWING NAME
 PRODUCT SPEC 108-1051
 APPLICATION SPEC 114-1020
 WEIGHT
 CUSTOMER DRAWING

SCALE 4:1 SHEET 1 OF 1

RESTRICTED TO
 MTA-156 CONNECTOR ASSEMBLY,
 24 AWG, STANDARD
 DRAWING NO
 A2 00779 © 641176