

NOTE:
- CRIMPING SPECIFICATION ACCORDING TO AS-64324-001

2	BOX TERMINAL	STAINLESS STEEL thickness : 0.15 mm
1	BODY TERMINAL	HIGH CONDUCTIVITY COPPER ALLOY thickness : 0.35 mm
MARK	DESIGNATION	MATERIAL

MATERIAL NUMBER	CONTACT AREA	CRIMPING AREA	UNDERLAYER	CRIMPING RANGE (mm ²)	A ±0.2	B	Rc ±0.1	G ±0.05	D ±0.1	P1 ±0.1	P2 ±0.1	WEIGHT (g)	Identification
0643241119	Au 1.27μ MINI	Sn	Ni	>3 TO 5	5.0	5.2	1.3	0.8	1.55	0.5	0.95	0.4902	D
0643241019	Sn	Sn			0.4795								
0643241129	Au 1.27μ MINI	Sn	Ni	>2 TO 3	4.1	4.4	1.0	0.8	1.45	0.5	0.95	0.4604	C
0643241029	Sn	Sn			0.4470								
0643241139	Au 1.27μ MINI	Sn	Ni	>1 TO 2	4.1	3.5	0.9	0.8	1.3	0.6	1.3	0.4274	B
0643241039	Sn	Sn			0.4191								
0643241149	Au 1.27μ MINI	Sn	Ni	0.50 TO 1	2.8	2.6	0.7	1.15	1.1	0.6	1.3	0.3916	A
0643241049	Sn	Sn			0.3815								

crimping range identification

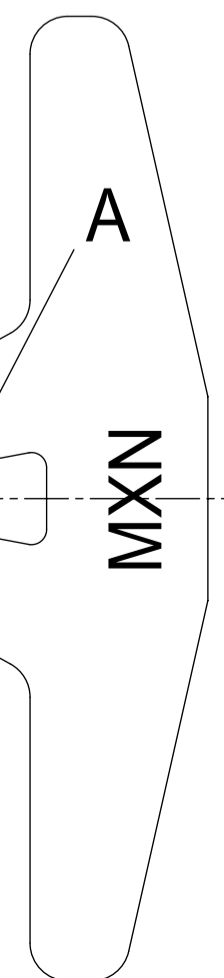

(SKC)	COTES CARACTERISTIQUES SPECIALES SPECIAL KEY CHARACTERISTICS
☒	INDICATION DIMENSIONS S.P.C DENOTES S.P.C DIMENSIONS
⊗	INDICATION DIMENSIONS CRITIQUES DENOTES CRITICAL DIMENSIONS
●	INDICATION DIMENSIONS FONCTIONNELLES DENOTES FUNCTIONAL DIMENSIONS
☒ 2	QUANTITE PAR FEUILLE INDIVIDUELLE QUANTITY PER INDIVIDUAL SHEET
⊗ 0	
● 6	(SKC) 0

THIS DRAWING CONTAINS INFORMATION THAT IS PROPRIETARY TO MOLEX ELECTRONIC TECHNOLOGIES, LLC AND SHOULD NOT BE USED WITHOUT WRITTEN PERMISSION

DIMENSION UNITS	SCALE	CURRENT REV DESC: NX RE-MASTERING. CHANGED ENGINEERING CONTROL ID FROM MXG TO MXN.
mm	10:1	
GENERAL TOLERANCES (UNLESS SPECIFIED)		
ANGULAR TOL	± 2.0 °	
4 PLACES	± 0.1	
3 PLACES	± 0.1	
2 PLACES	± 0.1	
1 PLACE	± 0.1	
0 PLACES	±	
DRAFT WHERE APPLICABLE MUST REMAIN WITHIN DIMENSIONS		
FIRST ANGLE PROJECTION	DRAWING	SERIES
	A1-SIZE	64324
EC NO: 607772 DRWN: GMANIVANNAN 2018/04/05 CHK'D: TBADAROUX 2018/11/21 APPR: SLAFAURE 2018/11/26 INITIAL REVISION: DRWN: VGUERIN 2007/11/07 APPR: LSTICKER 2007/11/07		

molex

CP RCPT TRM 2.8

PRODUCT CUSTOMER DRAWING

DOCUMENT NUMBER	DOC TYPE	DOC PART	REVISION
SD-64324-001	PSD	001	D1
MATERIAL NUMBER	CUSTOMER	SHEET NUMBER	
	GENERAL MARKET	1 OF 1	