

SS

Miniature Slide Switches

RoHS Compliant

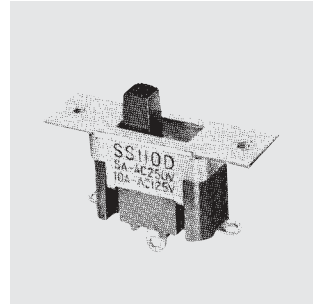

Part Numbering

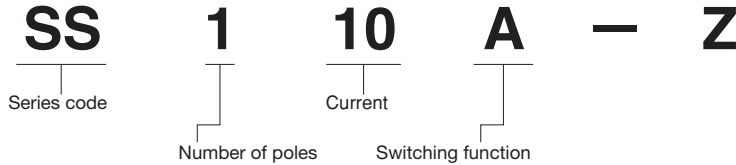

| 1 pole | 2 poles | Switching function |
|--------|---------|--------------------|
| A | K | OFF - ON |
| D | N | ON - ON |
| E | P | ON - OFF - ON |

Terminal style

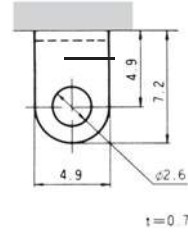

SS110-Z 1-pole

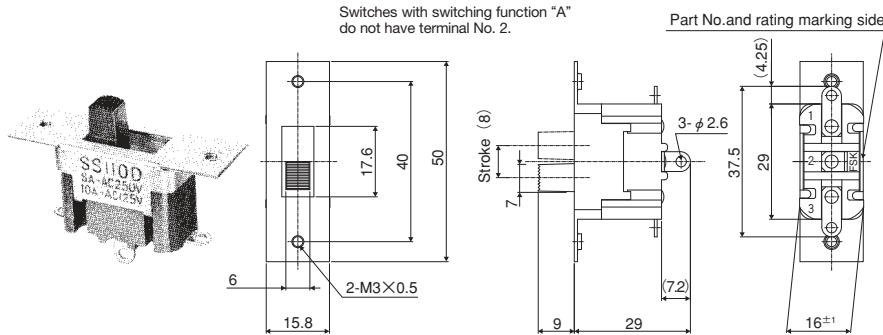

| Switching function | Viewed from part No. marking side | | |
|----------------------|-----------------------------------|-----|-----|
| | Part No. | | |
| ★SS110A-Z | OFF | — | OFF |
| Connecting terminals | — | — | 1-3 |
| ★SS110D-Z | ON | — | ON |
| ▲SS110E-Z | ON | OFF | ON |
| Connecting terminals | 2-1 | — | 2-3 |

Panel Cut-Out Dimension

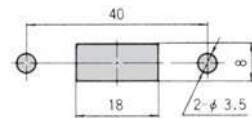

Specifications

Terminal numbers are shown on the bottom of the switch.

| Rating | Initial contact resistance | Dielectric strength | Insulation resistance | Electrical life |
|-------------------------------------|----------------------------|---------------------|------------------------|-----------------|
| SS110A~E AC125V 10A AC250V 6A | 20mΩ Max. (DC2~4V 1A) | AC1500V 1 minute | 100MΩ Min. (DC500V) | 10,000 cycles |

SS210-Z 2-pole

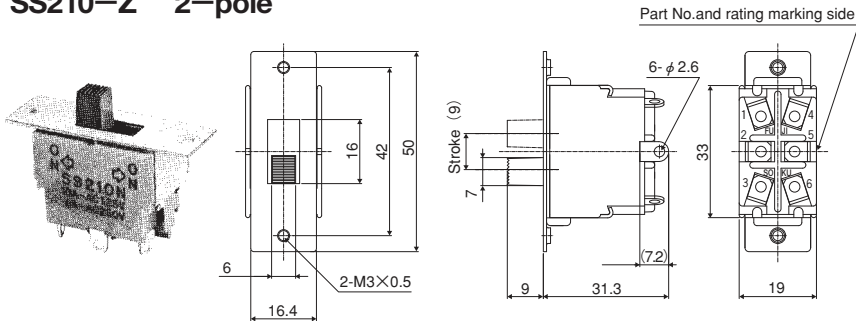

| Switching function | Viewed from part No. marking side | | |
|----------------------|-----------------------------------|-----|------------|
| | Part No. | | |
| ★SS210K-Z | OFF | — | ON |
| Connecting terminals | — | — | 1-3 4-6 |
| ☆SS210N-Z | ON | — | ON |
| ★SS210P-Z | ON | OFF | ON |
| Connecting terminals | 2-1 5-4 | — | 2-3 5-6 |

Panel Cut-Out Dimension

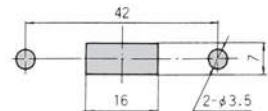

Specifications

Terminal numbers are shown on the bottom of the switch.

| Rating | Initial contact resistance | Dielectric strength | Insulation resistance | Electrical life |
|-------------------------------------|----------------------------|---------------------|------------------------|-----------------|
| SS210K~P AC125V 10A AC250V 6A | 20mΩ Max. (DC2~4V 1A) | AC1500V 1 minute | 100MΩ Min. (DC500V) | 10,000 cycles |

☆ : Semi-standard products. ★ : Made to order products. ▲ : Inquiry products.

● For Soldering Specifications and Flux Cleaning, Please refer to P.525.