

THIS DRAWING IS UNPUBLISHED. RELEASED FOR PUBLICATION 2006  
 © COPYRIGHT 2006 BY - ALL RIGHTS RESERVED.

**creo**  
 Creo Parametric 2.0  
**DO NOT REVISE**  
**EXCEPT BY CAD**

REVISIONS					
P	LTR	DESCRIPTION	DATE	DWN	APVD
A1		REVISED BY ECO-07-011564	17MAY2007	RKTL	GO
A2		REVISED BY ECN-23-222894	27JUL2023	MJI	SLF

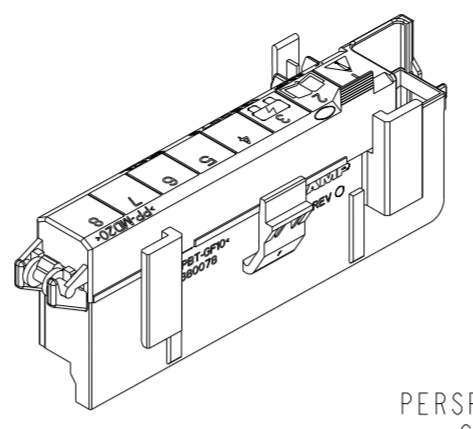
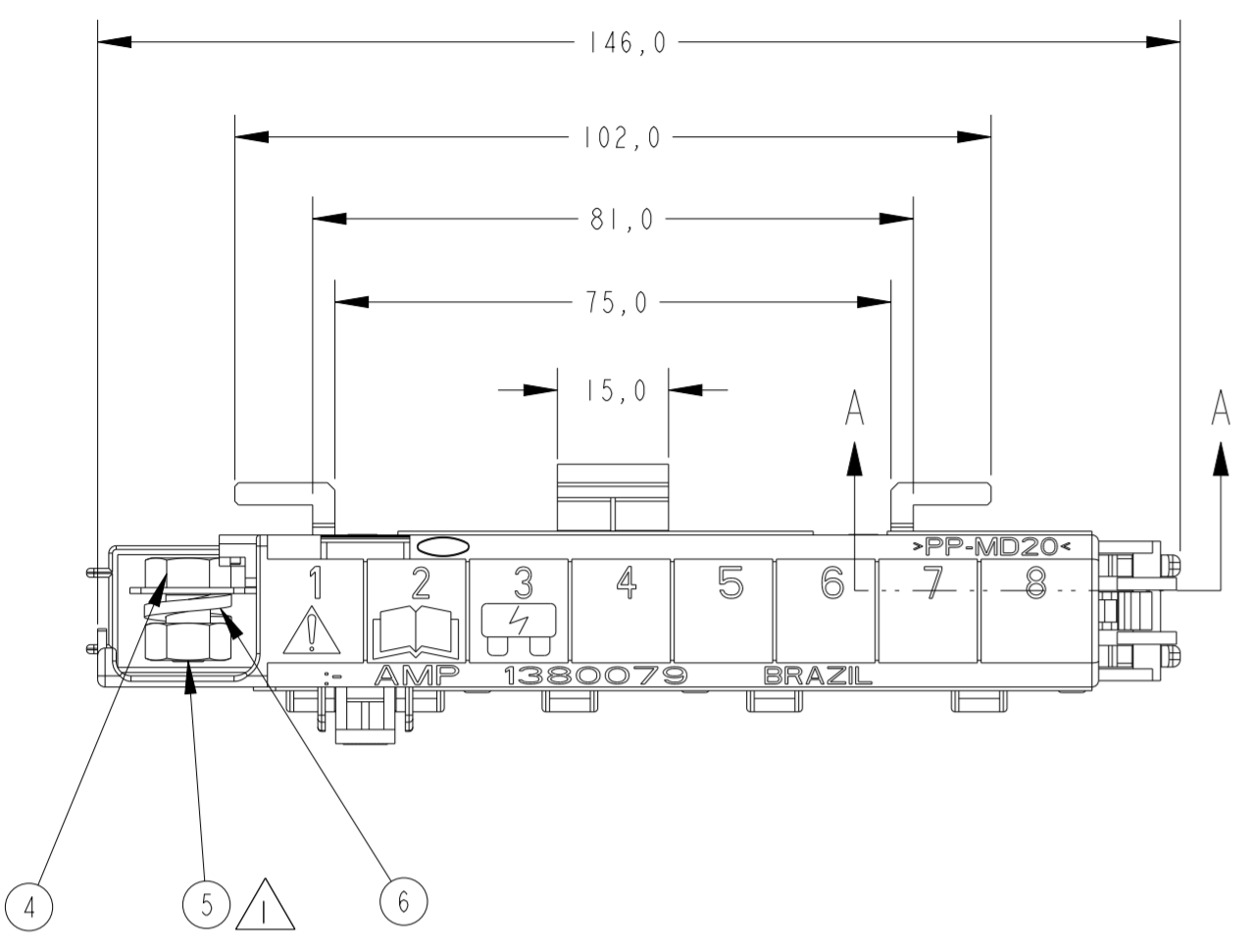

2  
 PERSPECTIVE VIEWS  
 SCALE 1:2

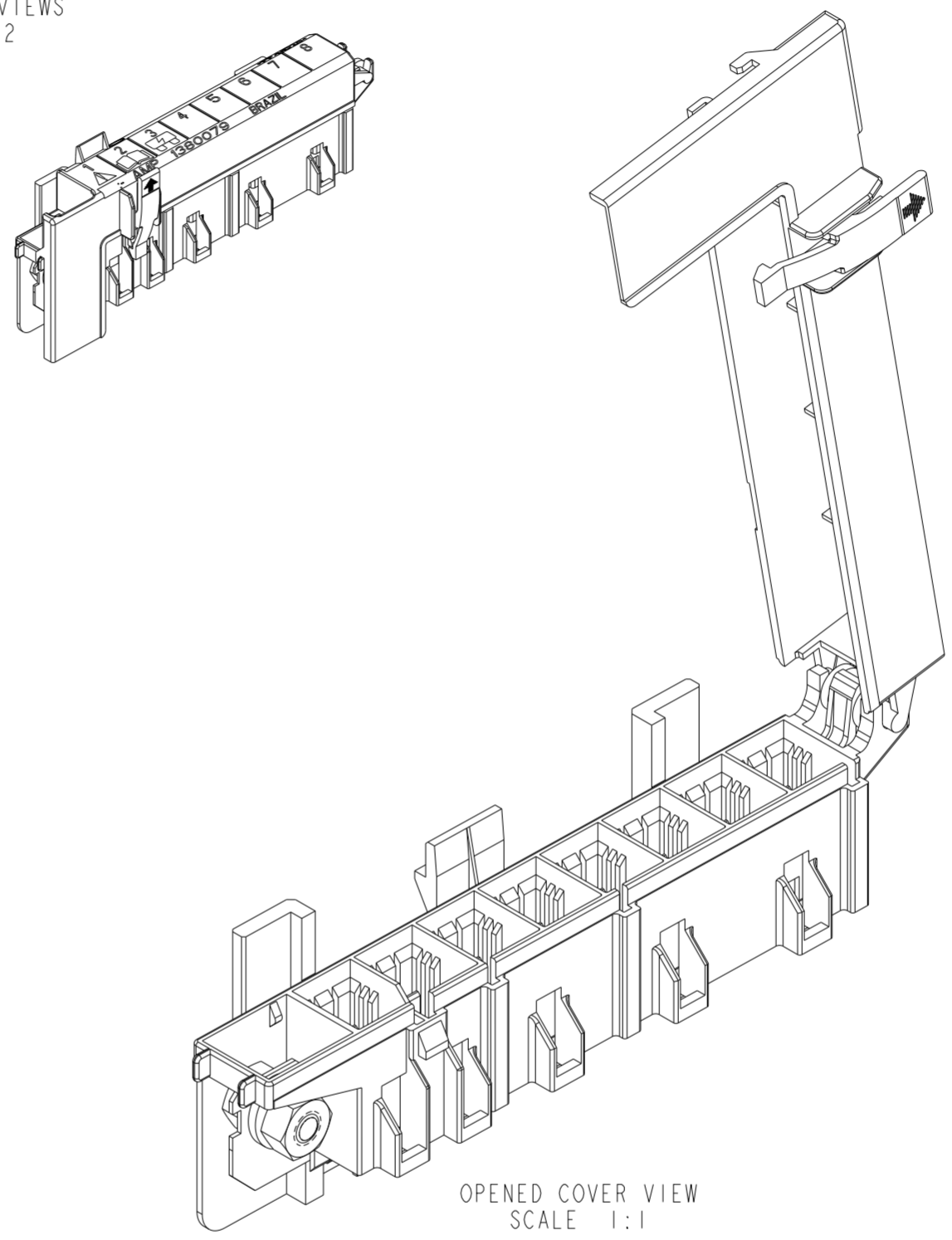

OPENED COVER VIEW  
 SCALE 1:1

- 1 - TORQUE DE APERTO NA PORCA DE RETENÇÃO: 5,0 - 7,0 Nm.
- 2 - CONDIÇÃO DE FORNECIMENTO.
- 3 - VER DESENHO DE CLIENTE RESTRITO.

- 1 - NUT RETENTION TIGHTENING TORQUE: 5,0 - 7,0 Nm.
- 2 - SUPPLYING CONDITION.
- 3 - SEE RESTRICTED CUSTOMER DRAWING.

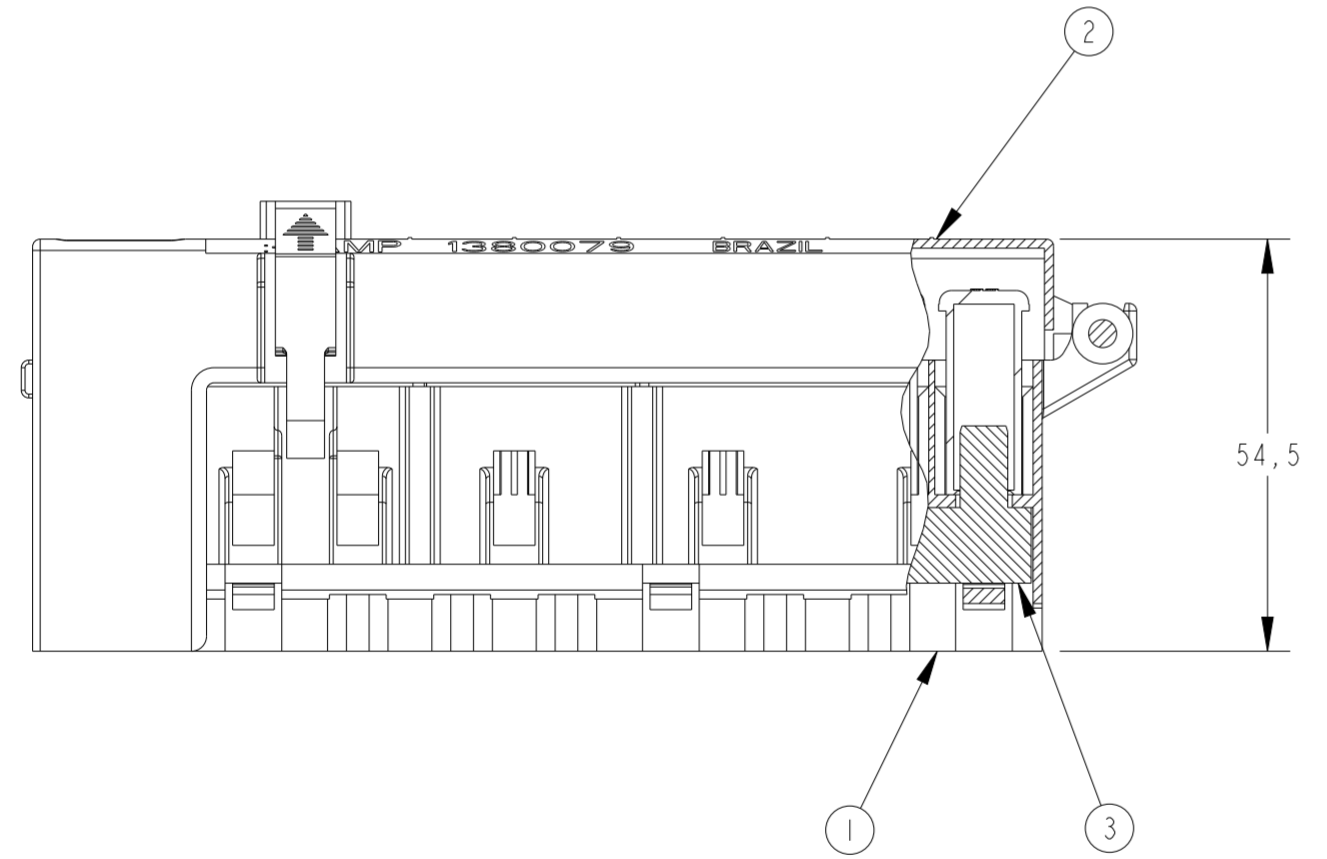

SECTION A-A

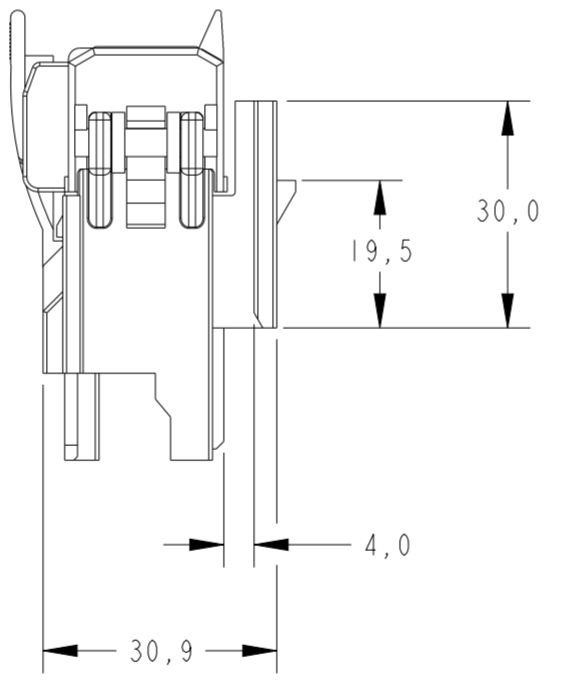

GRAVAÇÕES MARKINGS	
LOGOTIPO AMP	AMP LOGO
CÓDIGO PAÍS PRODUTOR	MANUFACTURER COUNTRY CODE
NOMENCLATURA MATERIAL	MATERIAL NOMENCLATURE
NÚMERO COMPONENTE TE	TE COMPONENT NUMBER
NÚMERO CAVIDADE	CAVITY NUMBER
IDENTIFICAÇÃO CIRCUITO	CIRCUIT IDENTIFICATION
PAÍS PRODUTOR	MANUFACTURER COUNTRY
REV+ LETRA REV.DA PEÇA	REV.+ PART REV.LETTER

REQ.	PER	ASSY	ITEM	DESCRIPTION	MATERIAL	FINISH
3	3	3	3	1 6 WASHER SPRING LOCK M6	AÇO MOLA / SPRING STEEL	ZINCADO / ZINC PLATED
				1 5 NUT M6	AÇO / STEEL	ZINCADO / ZINC PLATED
				1 4 SCREW M6 X 10	AÇO / STEEL	ZINCADO / ZINC PLATED
				1 3 BUSBAR 8 POSN. J-CASE FUSE	LIGA DE COBRE / COOPER ALLOY	ESTANHADO / TIN PLATED
				1 2 COVER 8 POSN. J-CASE FUSE	POLIPROPILENO / POLYPROPYLENE	PRETO / BLACK
				1 1 HOUSING 8 POSN. J-CASE FUSE	PBT	PRETO / BLACK

THIS DRAWING IS A CONTROLLED DOCUMENT.

DIMENSIONS:		TOLERANCES UNLESS OTHERWISE SPECIFIED:	
mm		0 PLC	±
		1 PLC	±0,3
		2 PLC	±
		3 PLC	±
		4 PLC	±
		ANGLES	±°
		FINISH	
MATERIAL	SEE TABLE	FINISH	SEE TABLE

DWN	A. PERUSSI	19SEP2006	 TE Connectivity	NAME MAXI FUSE BOX ASS'Y J-CASE FUSE			
CHK	P. L. FARIA	19SEP2006					
APVD	M. L. OGAWA	19SEP2006					
PRODUCT SPEC	- / -						
APPLICATION SPEC	- / -		SIZE	CAGE CODE	DRAWING NO	RESTRICTED TO	
WEIGHT	- / -		A2	00779	C-1599962	-	
Customer Drawing			SCALE	1:1	SHEET	OF	REV
							A2