

REVISIONS					
REV	ECO	DESCRIPTION	DATE	BY	APPR
B1	-	RELEASE NEW DWG FORMAT	06/16/14	TOD	TOMMY
B2	-	UPDTAED SPECIFICATION	09/14/15	TOD	TOMMY

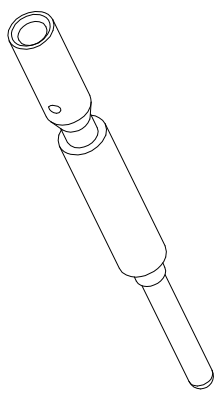
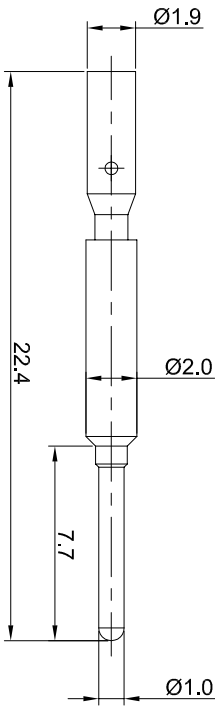
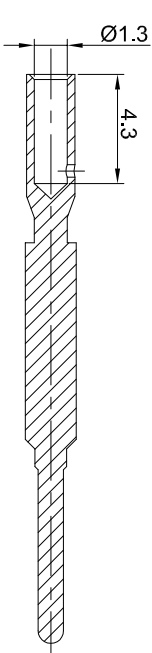

- NOTES: UNLESS OTHERWISE SPECIFIED
1. MATERIAL: COPPER ALLOY, GOLD PLATED
 2. SPECIFICATIONS:
 - 2.1 RATED CURRENT: 10 AMPS
 - 2.2 CONTACT RESISTANCE: <5 milliohm
 - 2.3 AVAILABLE WIRE RANGE: 22AWG~18AWG
 - 2.4 ROHS COMPLIANT
 3. ALL DIMENSIONS ARE FOR REFERENCE USE ONLY.

QUANTITY	SEE PART NUMBER CHART	PART NUMBER	DESCRIPTION	ITEM					
MATERIALS LIST									
UNLESS OTHERWISE SPECIFIED									
1) All dimensions are in millimeters.									
2) Tolerances are as follows:									
1 Pt. DEC 20.030 Fractions 1/164									
2 Pt. DEC 20.030 Fractions 1/164									
3 Pt. DEC 20.030 Fractions 1/164									
3) Note reference = A									
MATERIAL SPECIFICATIONS:									
CUSTOMER:									
THE DRAWING IS SUPPLIED FOR INFORMATION ONLY. DESIGN FEATURES, SPECIFICATIONS AND PERFORMANCE DATA ARE SUBJECT TO CHANGE WITHOUT NOTICE. THE APPLICABLE CORPORATION HOLDS ALL RIGHTS IN THE DRAWING. REPRODUCTION OF THIS DRAWING WITHOUT THE WRITTEN PERMISSION OF THE APPLICABLE CORPORATION IS PROHIBITED.									
PROCESS SPECIFICATIONS:									
NEXT ASSY:									
SCALE:	NONE	SIZE:	B	TYPE:	C-	DWG NO.:	SC000035	REVISION:	B2
Pin contact, 20#, Chmp 22-18AWG		Sine Systems - www.amphenol-sine.com 44724 Modely Drive Clifton Township, MI 48036			Amphenol				
DRAWN: tod		DATE: 09/14/15		SIGNATURES:					
CHECKED:		ENGINEER:		APPROVAL:					