

## INSULATION

### Silver-Series Removable Cloth Insulators

#### (SSI Series)

Silver-Series Removable Cloth Insulators are a configurable system of removable insulator blankets and covers that feature durable high-temperature cloth, energy-efficient fiberglass insulation, and hook & loop closures for easy installation and removal. This cost-effective solution improves thermal efficiency for hot and cold pipes, tanks, and vessels in industrial and commercial environments. Custom designs can be manufactured for unique requirements.

- ▶ **Configurable system**
- ▶ **Easy-to-install**
- ▶ **Removable and reusable**
- ▶ **Economical solution**
- ▶ **Cut-to-length straights**
- ▶ **Moisture/chemical resistant**
- ▶ **Durable design**
- ▶ **Long service life**
- ▶ **High-temperature**
- ▶ **Fire-retardant**
- ▶ **Asbestos-free**



**Moisture and  
Chemical  
Resistant**

#### Specifications:

**Maximum Exposure Temperature:** Up to 500°F (260°C)

**Outer Cloth Material:** PTFE cloth

**Insulation:** 1 in (25 mm) fiberglass

**Thermal Performance:** R3.3, K0.21@75°F (24°C)

**Ingress Protection Rating:** IP54

#### Quality Construction

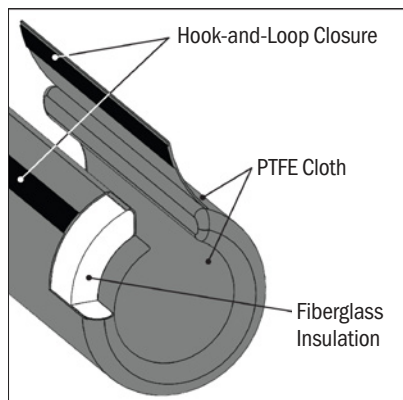

#### Cut-to-Length Versatility



Straight pipe insulators can be cut-in-the-field

#### Custom Design Options:

##### Cloth Materials/Max Exposure Temperature

- Other materials available upon request with higher temperature ratings up to 1100°F (593°C)

##### Closure Types

- Hook and loop (Standard)
- D-Rings
- Hook and lace
- Grommets
- Rope draw-cord

##### Insulation Thickness

- 1 in (25 mm) (standard) or your choice of thickness

**Custom Sizes and Designs Available for Pipes, Tanks, Vessels, and Much More:**

**Contact your local distributor or BriskHeat® for more information.**

## INSULATION

### Silver-Series Removable Cloth Insulators

(SSI Series)

#### Ordering Information:

##### Straight Sections (Cut-to-length)



Part No.	A ID of Insulator in (mm)
SSIP10V	1.00 (25)
SSIP15V	1.50 (38)
SSIP20V	2.00 (51)
SSIP30V	3.50 (89)
SSIP40V	4.00 (102)

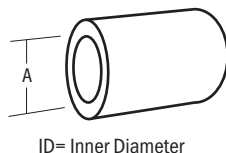

Total usable length for each straight insulator is 83 in (2108 mm) – can be cut-to-length in the field in 6 in (152 mm) and 12 in (305 mm) increments

##### 90° Elbows



Part No.	A ID of Insulator in (mm)	B Height in (mm)
SSI9010V	1.25 (32)	5.00 (127)
SSI9020V	1.50 (38)	7.00 (178)
SSI9030V	3.50 (89)	8.50 (216)
SSI9040V	4.50 (114)	11.00 (279)

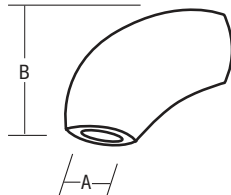

##### Flanges



Part No.	A ID of Insulator in (mm)	B Length in (mm)
SSIF10V	4.25 (108)	8.00 (203)
SSIF15V	5.00 (127)	8.00 (203)
SSIF20V	6.00 (152)	8.00 (203)
SSIF25V	7.00 (178)	8.00 (203)
SSIF30V	9.00 (229)	8.00 (203)
SSIF40V	11.25 (286)	8.00 (203)

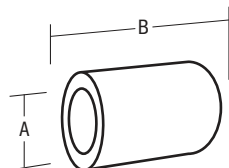

##### Tees



Part No.	A ID of Insulator in (mm)	B ID of Insulator in (mm)	C Length in (mm)	D Height- Center-line to top in (mm)
SSIT10V	1.50 (38)	1.50 (38)	8.00 (203)	2.00 (51)
SSIT20V	2.00 (51)	2.75 (70)	9.00 (229)	2.63 (67)
SSIT30V	4.25 (108)	3.50 (89)	12.00 (305)	5.13 (130)

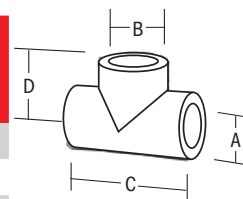

##### 2-way Ball Valve



Part No.	A ID of Insulator in (mm)	B Opening ID in (mm)	C Length in (mm)
SSIVB102V	4.50 (114)	3.00 (76)	8.00 (203)
SSIVB202V	5.25 (133)	2.00 (51)	8.00 (203)
SSIVB302V	7.25 (184)	2.50 (64)	8.00 (203)
SSIVB402V	9.00 (229)	2.50 (64)	8.00 (203)

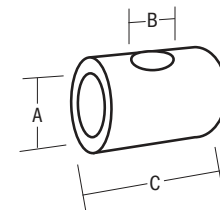

##### Seam Covers



Part No.	A ID of Insulator in (mm)	B Length in (mm)
SSIC10V	3.17 (81)	3.25 (83)
SSIC20V	4.00 (102)	3.88 (99)
SSIC30V	5.25 (133)	4.00 (102)
SSIC40V	6.80 (173)	3.88 (99)

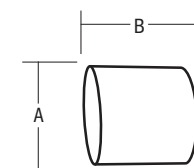

# INSULATE

**ENERGY EFFICIENCY • PROTECTION**

**Custom Sizes and Designs Available for Pipes, Tanks, Vessels, and Much More:**

**Contact your local distributor or BriskHeat® for more information.**