

LOC	DIST	REVISIONS			
		REV	DATE	BY	APPV
CM	00	D1	REVIS PER ECR-18-004355	18JUN2018	BDA SG

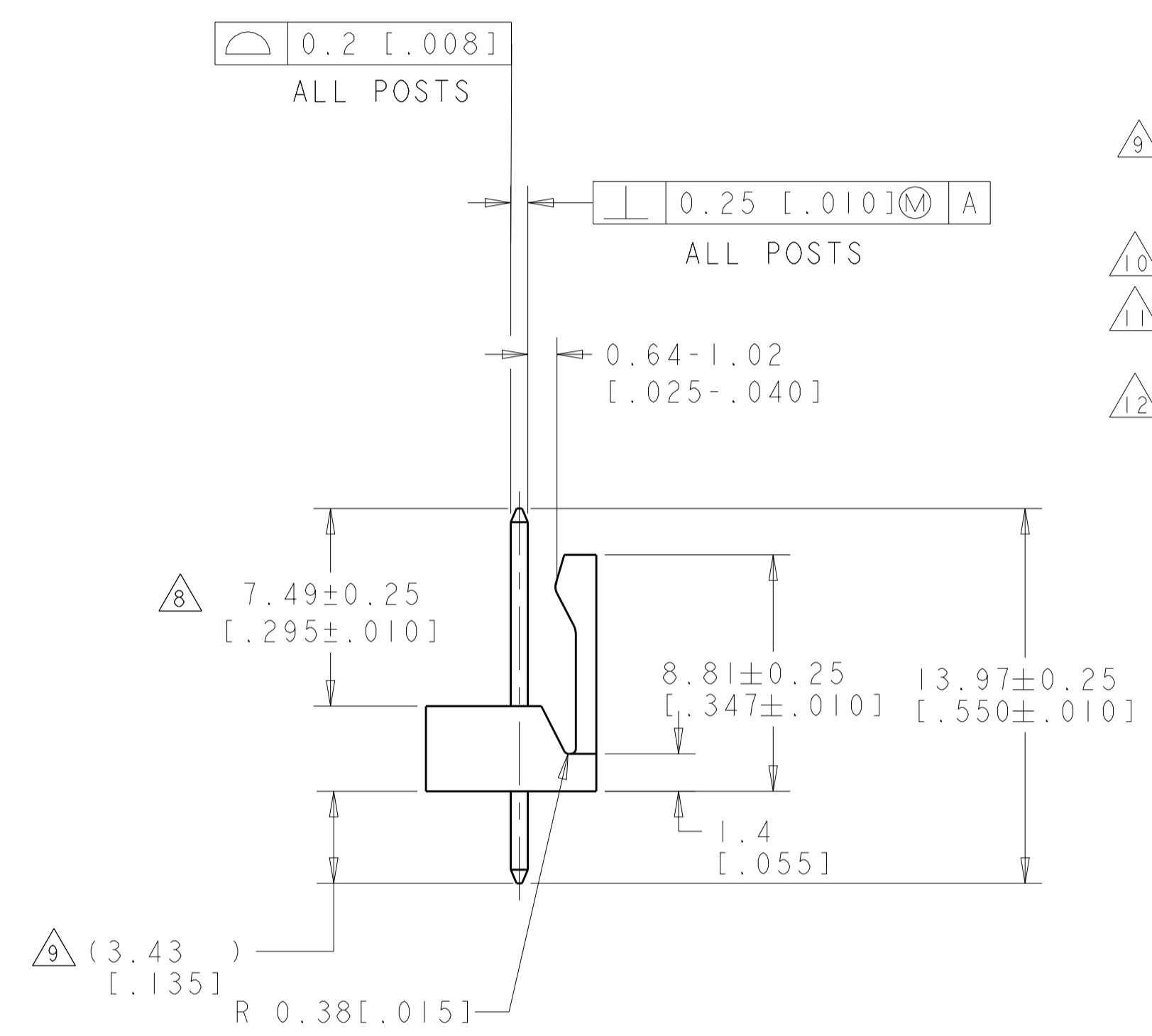

0.25 [0.010]
0.2 [0.008] (M)
0.05 [0.002]

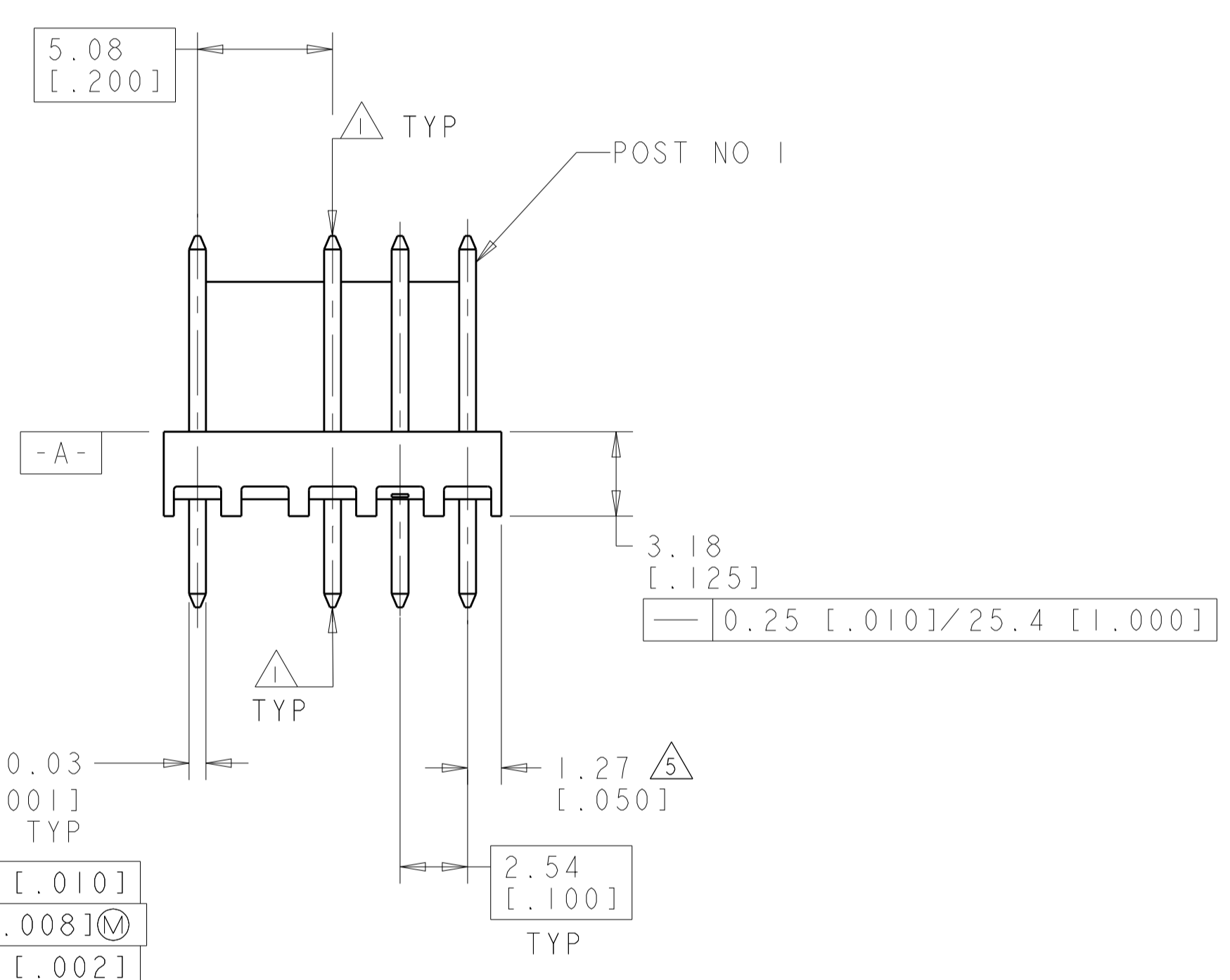
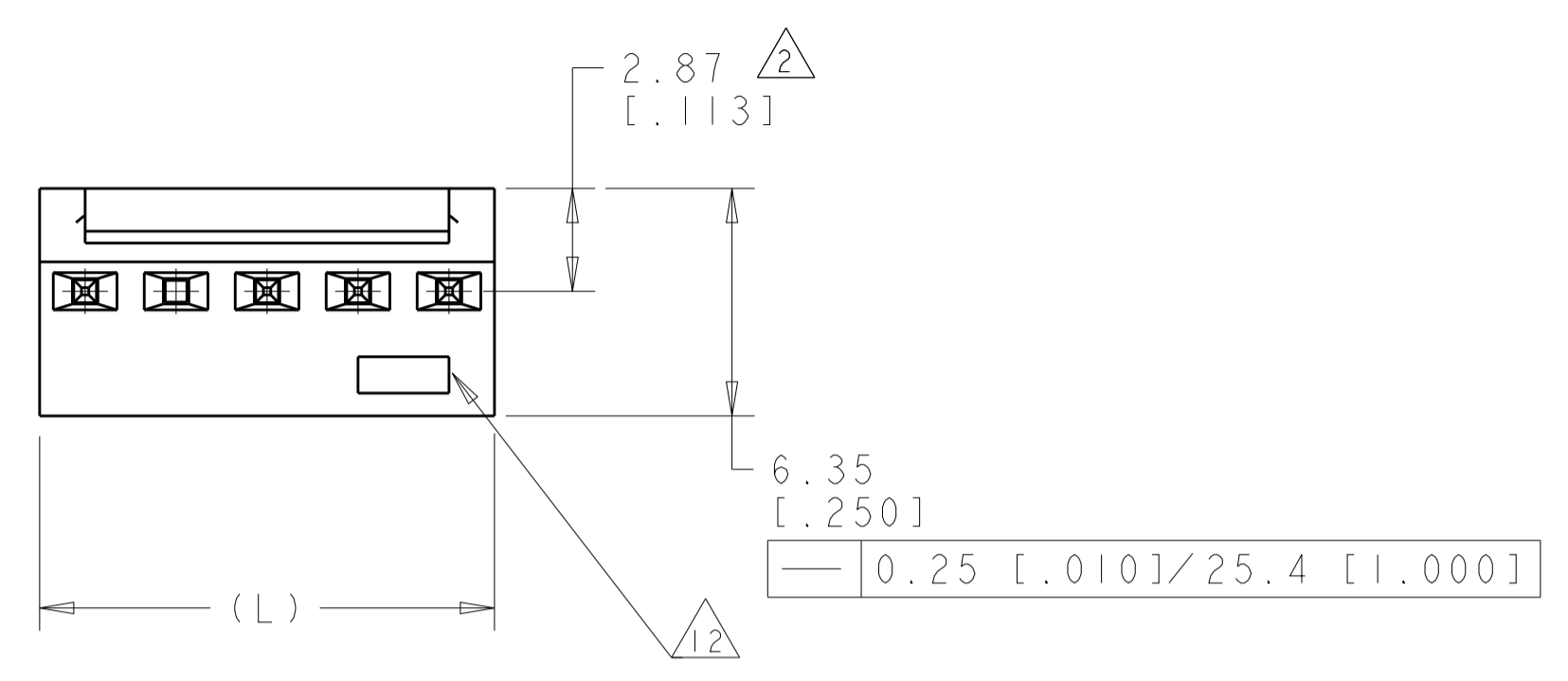
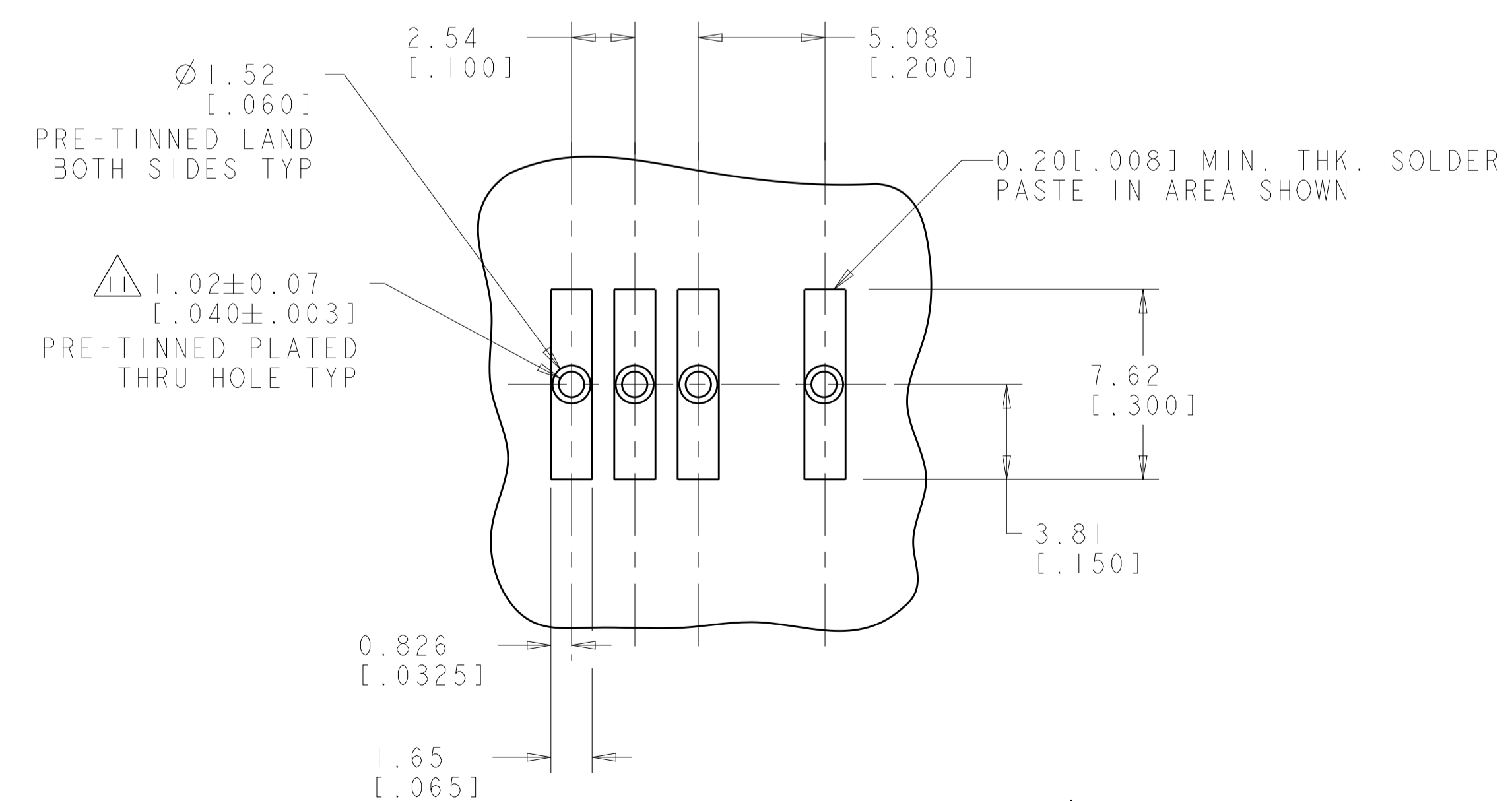

RECOMMENDED MOUNTING HOLE PATTERN FOR 1.57 ± 0.20 [0.062 ± 0.008] THICK P.C. BOARD

- 1 POST WITHSTAND 13 NEWTONS (3 LBS) MIN AXIAL FORCE IN DIRECTION SHOWN WITHOUT DISLODGING.
- 2 MEASURED AT -A-.
- 3 PARTS COMPLY WITH SOLDERABILITY SPEC 109-11-2.
- 4 MATERIAL: HOUSING: NYLON, 4/6, HIGH TEMP, BLACK. POST: COPPER ALLOY (SEE NOTES 8 & 9 FOR PLATING.)
- 5 COORDINATE DIMENSION APPLIES FROM CENTER OF ACTUAL FEATURE.
- 6 POSTS TO BE MEASURED WHEN STRIP HELD FLAT.
- 7 DIMENSIONS IN BRACKETS ARE IN INCHES.
- 8 PLATING: GOLD PLATE AREA, 0.00038 [0.000015] GOLD OR 0.00008 [0.000003] MIN GOLD FLASH OVER 0.00030 [0.000012] PALLADIUM NICKEL PER TE CONNECTIVITY'S DISCRETION, ALL SIDES, OVER NICKEL UNDERPLATE, 0.00127 [0.000050] MIN, ALL SIDES AND ENTIRE LENGTH OF POST.
- 9 PLATING: MATTE TIN PLATE AREA, 0.00381-0.00889 [0.000150-.000350] THICK, ALL FOUR SIDES 3.18 [0.125].
- 10 TOLERANCES APPLY TO SOLDER SIDE OF BOARD.
- 11 ONE HOLE MAY BE UNDERSIZED 0.81-0.90 [0.032-.035] DIAMETER FOR ASSEMBLY RETENTION DURING PROCESSING.
- 12 TE LOGO, UL, AND CSA TRADEMARKS TO APPEAR ON THIS SURFACE.

YES	4	12.70 [0.500]	5	1744053-1
LEAD FREE	OMIT POST(S) NO.	L	NO OF POSN	PART NO

THIS DRAWING IS A CONTROLLED DOCUMENT.

OWN: R. WHITAKER 13APR04
 CHK: D. BOSSI 13APR04
 APVD: D. BOSSI 13APR04

STE TE Connectivity

NAME: MTA-100 HEADER ASSY, HIGH TEMPERATURE
 PRODUCT SPEC: FRICTION LOCK, .025 SQUARE, STRAIGHT POST, .000015 GOLD, OMIT POST 4
 APPLICATION SPEC: -
 SIZE: -
 CAGE CODE: -
 DRAWING NO: A100779
 WEIGHT: -
 CUSTOMER DRAWING: -

DIMENSIONS: mm [INCHES]
 TOLERANCES UNLESS OTHERWISE SPECIFIED:
 0 PLC ±
 1 PLC ±
 2 PLC ±0.381 [0.015]
 3 PLC ±
 4 PLC ±
 ANGLES: ±30°

MATERIAL: 4
 FINISH: 4

SCALE: 5:1 SHEET 1 OF 1 REV: D1