

NOTES:

1. MATERIALS:

COVER & BASE - STEEL
 FINISH MIL-F-14072 (SIG. - C)
 BASIC FINISH #P-211 TYPE I EXPOSURE
 FINAL FINISH PER TT-E-529 ENAMEL
 SYNTHETIC SEMI-GLOSS
 NAVY GRAY - 26187 - A3

GASKET - SYNTHETIC RUBBER
 TORSION SPRING - STAINLESS STEEL
 AXLE - COPPER ALLOY, NICKEL PLATED
 NUT - COPPER ALLOY, NICKEL PLATED

3/8-32 UNEF-2B
 THREAD

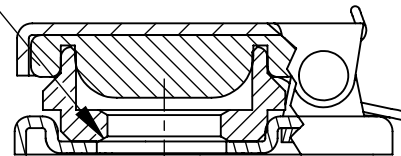

$\phi 0.386$
 REF

- 2. HEX NUT SHIPPED UNASSEMBLED.
- 3. THIS PRODUCT IS RoHS COMPLIANT.

CUSTOMER DRAWING

THIS DRAWING DESCRIBES A DESIGN CONSIDERED PROPRIETARY IN NATURE, DEVELOPED AND MANUFACTURED BY SWITCHCRAFT INC. AND IS RELEASED ON A CONFIDENTIAL BASIS FOR IDENTIFICATION PURPOSES ONLY.

					UNLESS OTHERWISE SPECIFIED 1. ALL DIMENSIONS IN INCHES - TWO PLACE DECIMALS ± 0.02 - THREE PLACE DECIMALS ± 0.005	SIZE	WIDTH	MULT	LBS/M	TEMPER	
						FINISH	MATERIAL				
						SPEC No.	SPEC No.				
						FIRST USED ON	SCALE		Switchcraft®		
						DATE DRAWN	BY	CHKD	APVD	SHEET 1 OF 1	
B	26771	05/13/11	JEB	TJK			RF	TJK			
A	25429	9-19-07	RF	TJK		9-19-06	9-19-06	9-19-07			
REV	ECO NUMBER	DATE	BY	APVD		NAME			PART No.	REV	
REVISIONS					DO NOT SCALE DRAWING	JAX COVER, RoHS			520X	B	

