

| REVISIONS | | | | |
|-----------|-----|---------------------------|-----------|---------|
| P | LTN | DESCRIPTION | DATE | APVD |
| B | | REVISED PER ECO-17-008034 | 07AUG2017 | JDS JDS |
| B1 | | REVISED PER ECO-20-001920 | 22JAN2020 | NRS NRS |
| C | | REVISED PER ECN-22-160264 | 21JUN2022 | FC CB |
| C1 | | REVISED PER ECN-22-181824 | 19SEP2022 | GB BC |

1. ISL AND CPA (OPTIONAL) ARE SHIPPED IN THEIR PRE-LATCHED POSITIONS.
2. TERMINALS SOLD SEPARATELY. FOR USE WITH TE MCON 1.2mm CLEAN BODY STANDARD RECEPTACLE CONTACT. SEE TABLE.
3. APPLICABLE INTERFACE DRAWINGS : TE 2295114.
4. MINIMUM FEED-THROUGH CONDITION WITH 1.0mm CLEARANCE ALL AROUND
5. TE PART NUMBER AND DATE CODE (YY = TWO DIGIT YEAR, JJJ = 3 DIGIT JULIAN DAY. MARKED IN APPROX. AREA SHOWN.
6. FOR OPTIONAL TERMINAL CAVITY BLOCKING, REFER TO INSTRUCTION SHEET 408-32256 OR CONTACT TE SALES REPRESENTATIVE OR CUSTOMER SERVICE.
7. SEE INSTRUCTION SHEET 408-32256 FOR CONNECTOR SERVICE AND ISL OPERATION
8. PRIMARY LOCK TERMINAL RETENTION FORCE 25N MINIMUM.
9. CONTACT PLATING IS APPLICATION DEPENDENT, CONTACT TE SALES REPRESENTATIVE OR CUSTOMER SERVICE FOR DETAILS
10. FOR WIRE CRIMP DETAILS, SEE TE APPLICATION SPECIFICATION 114-18464.
11. WIRE INSULATION DIAMETER RANGE: \varnothing 1.22-2.1.
12. CONNECTOR SHOWN CAN BE USED WITH THE FOLLOWING WIRE DRESS COVERS:
STRAIGHT EXIT: TE PN 2272168-1
OR RIGHT ANGLE EXIT: TE PN 2272169-1
WIRE DRESS COVERS ARE PURCHASED SEPARATELY.
13. CONNECTOR SHOWN MATES WITH 2P CAP: 2292937-1 (KEY A) OR 2292937-2 (KEY B).
14. INGRESS PROTECTION LEVEL FOR WIRE DIA 1.22-1.55 IS EQUAL TO IP6K7 STANDARD AND FOR 1.55-2.1 TO USCAR2 STANDARD.

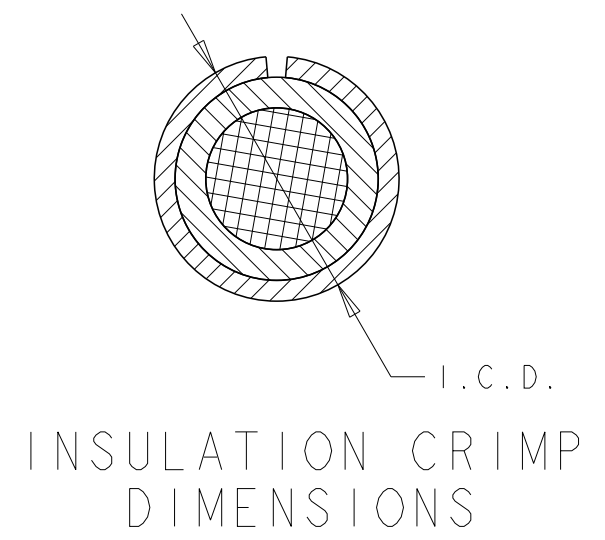
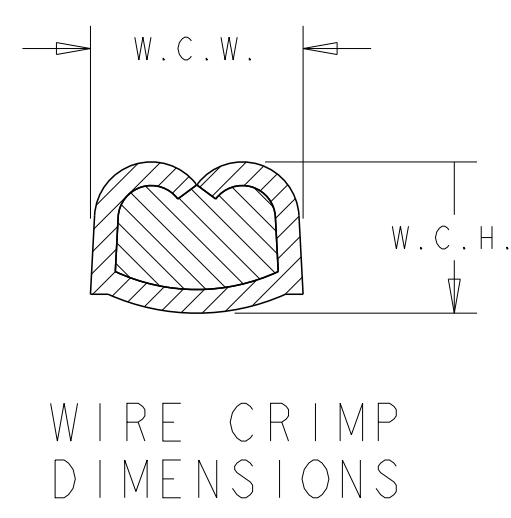
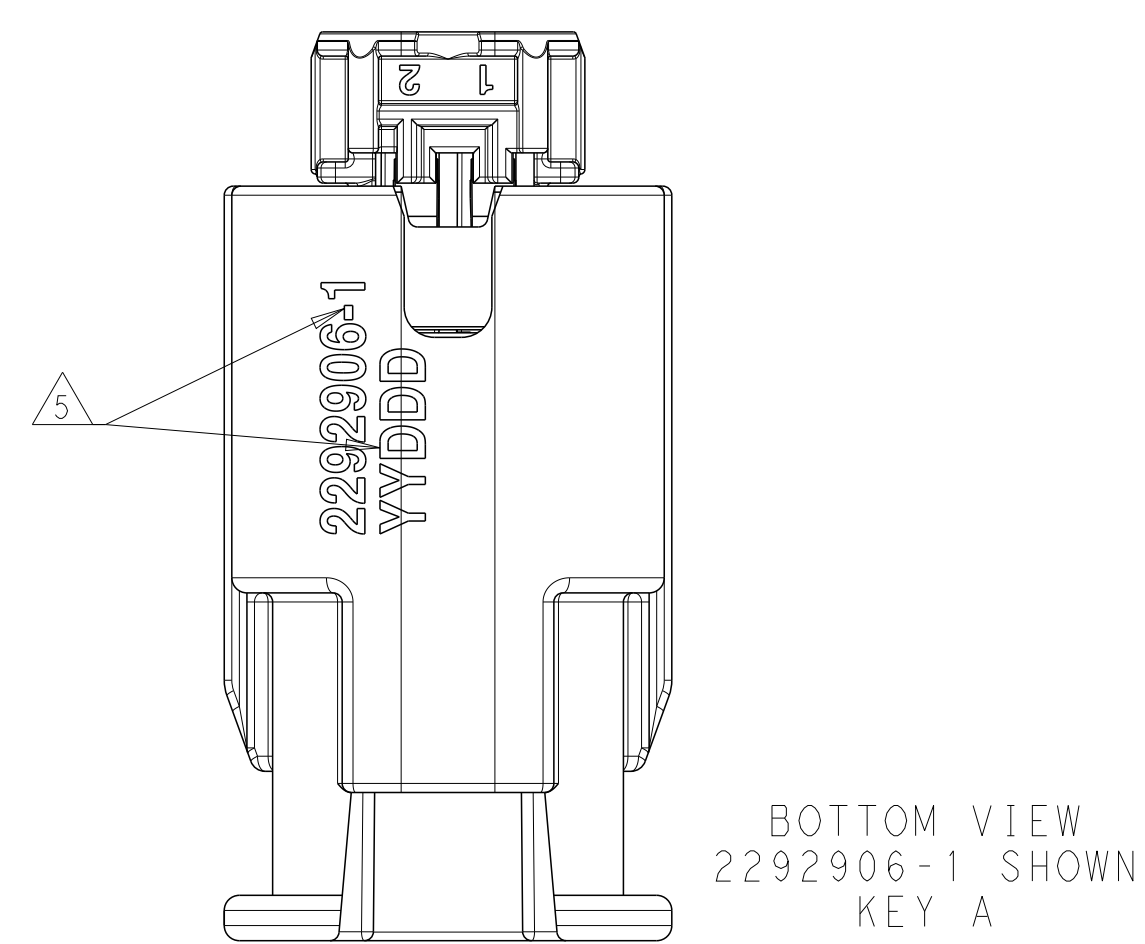
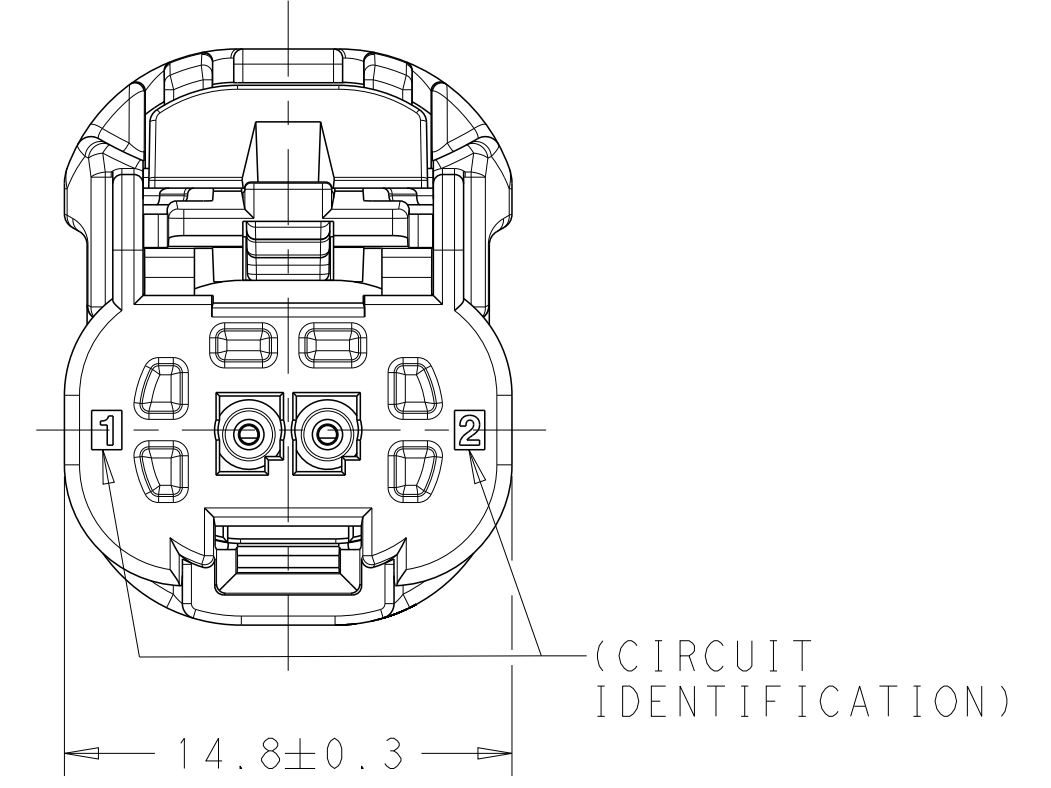
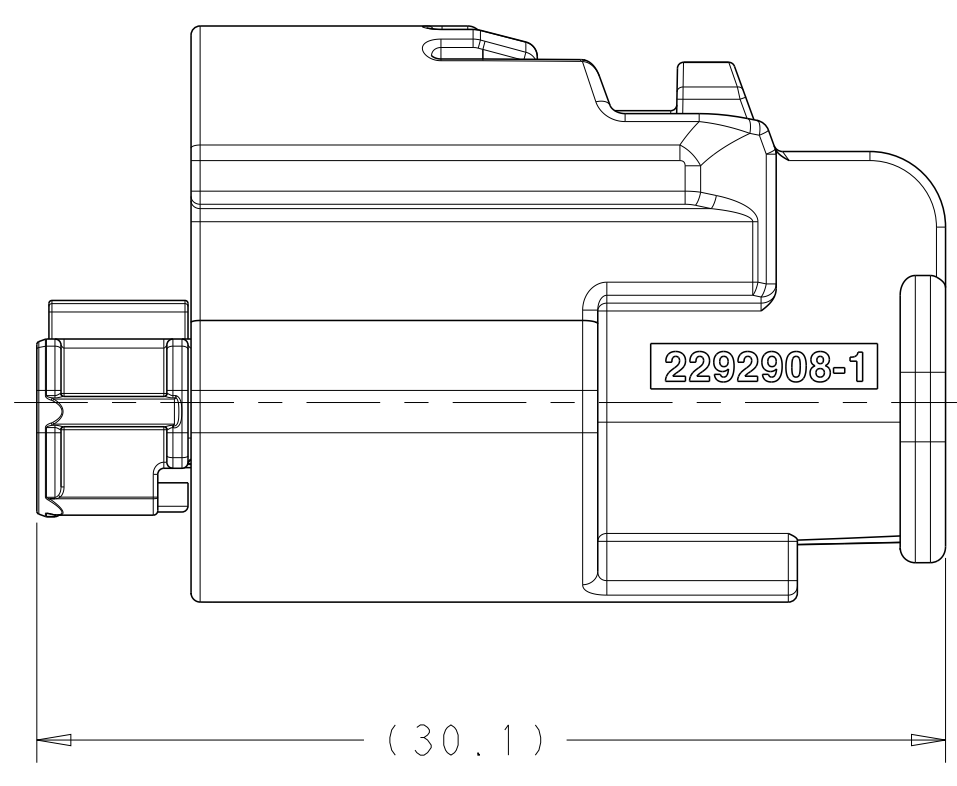
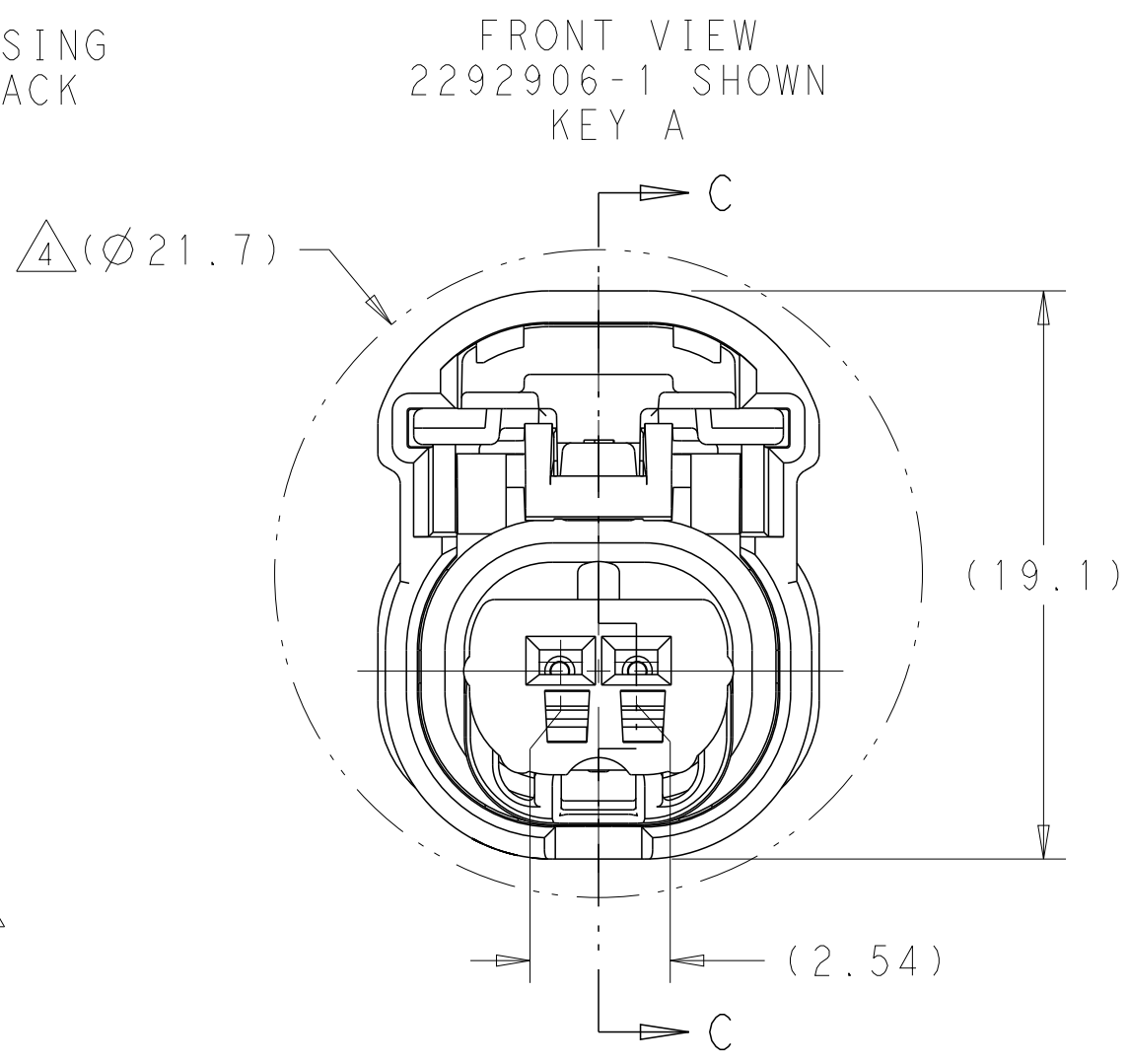
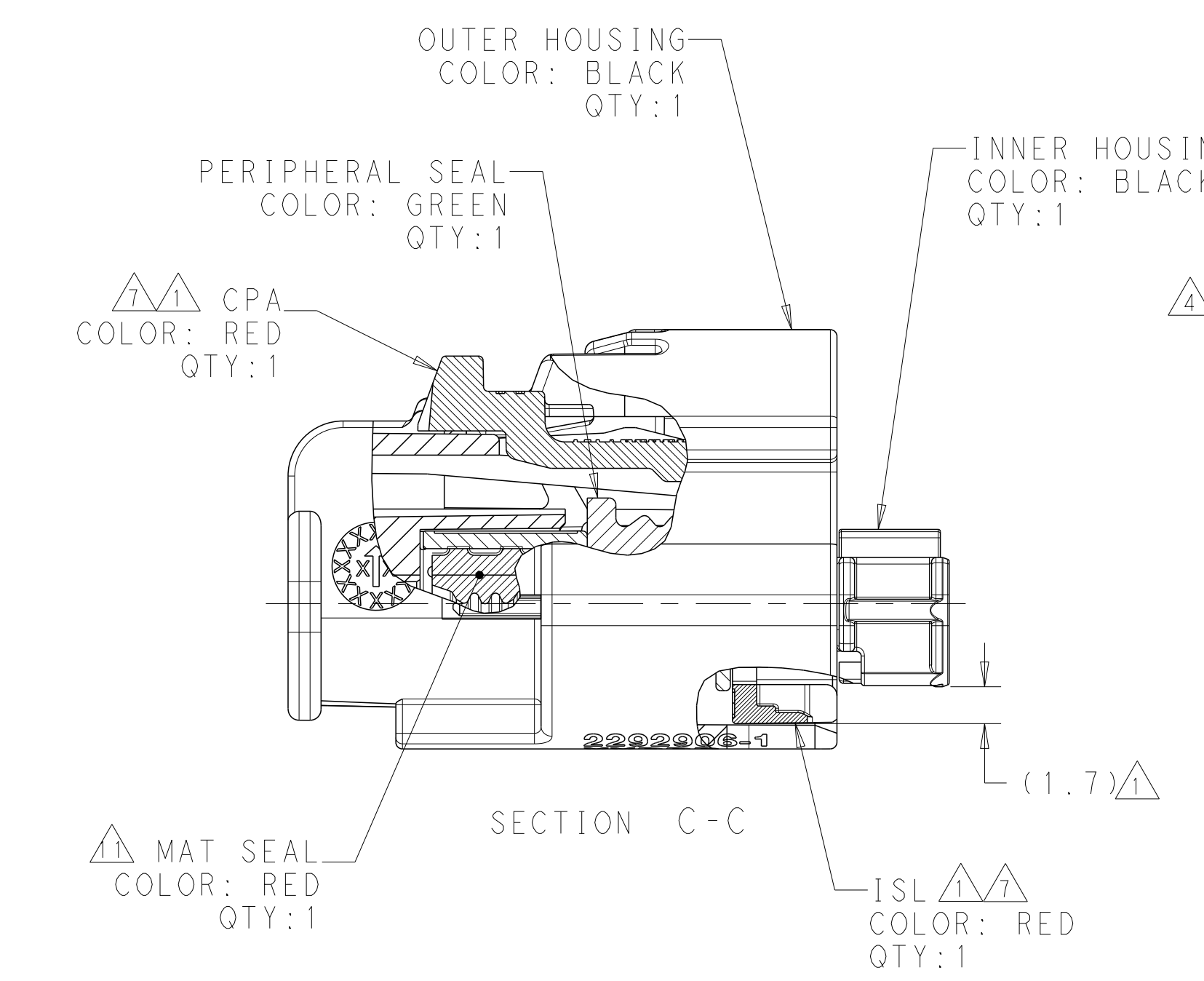

| | | | | | |
|----------|------------------|--|-------|-------|--------|
| 125°C | 9 | 1670144 0.50mm ² - 0.75mm ² (INCLUDES #20 AWG) | 10 | 10 | (2.05) |
| | | 1534594 0.25mm ² - 0.35mm ² (INCLUDES #22 AWG) | | | (1.85) |
| MAX TEMP | TERMINAL PLATING | FEMALE TERMINAL P/N WIRE SIZE | W.C.H | W.C.W | I.C.D |

| | | |
|--|---|---------------------------|
| THIS DRAWING IS A CONTROLLED DOCUMENT. | | OWN J MCNEAL 17AUG2015 |
| DIMENSIONS: mm | | CHK J SANDBURG 17AUG2015 |
| TOLERANCES UNLESS OTHERWISE SPECIFIED: | | APVD J SANDBURG 17AUG2015 |
| 0 PLC | ± | PRODUCT SPEC |
| 1 PLC | ± | 108-151045 |
| 2 PLC | ± | APPLICATION SPEC |
| 3 PLC | ± | 114-151045 |
| 4 PLC | ± | WEIGHT 4.5 g |
| ANGLES | ± | CUSTOMER DRAWING |
| FINISH | | |

| | |
|--|----------------------|
| KEY CODE "B" | 2292906-2 |
| KEY CODE "A" | 2292906-1 |
| KEY CONFIGURATION | PART NUMBER |
| STE TE Connectivity | |
| NAME PLUG ASSEMBLY, SEALED, 2 POSITION | |
| SIZE | CAGE CODE DRAWING NO |
| A1 | C=2292906 |
| RESTRICTED TO | |
| SCALE 4:1 | SHEET 1 OF 1 |
| REV C1 | |