



LEAF HINGE



Specifications

- Material:
Body: Polyamide DIN-EN ISO 1043-1 PA6 GFR 30
Pin: Stainless Steel
- Maximum hinge rotation 270°

Features

- Generally used for plain / flush-mounted doors
- Stud versions fitted with M6 x 12 mm threaded stud
- Stainless steel (AISI 304) hinge pin
- Applications: Electric panels, built-in covers

Hinge Rotation Angle

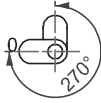

Version 1

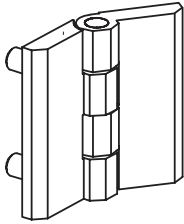

Version 2

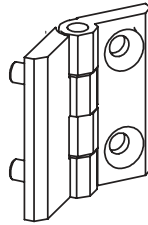

Version 3

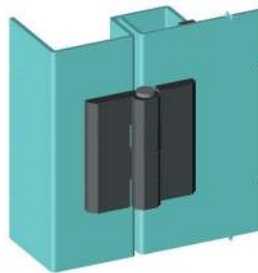
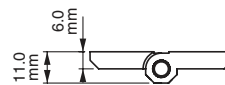
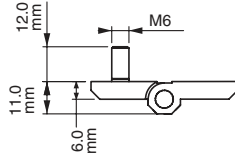
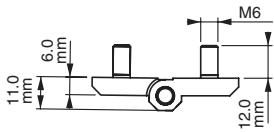
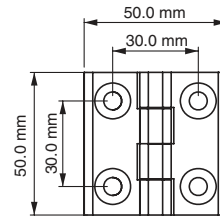
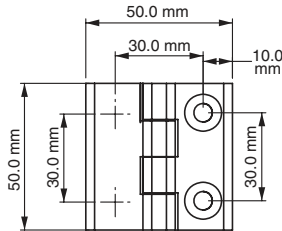
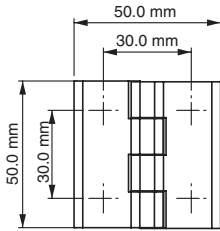
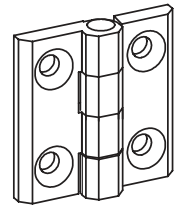

| Item Number | Hinge Rotation | Material | Finish | Version |
|-------------|----------------|----------|--------|---------|
| 199201 | 270° | Nylon | Black | 1 |
| 199202 | 270° | Nylon | Black | 2 |
| 199203 | 270° | Nylon | Black | 3 |