

- NOTES:
1. MATERIAL: SEE TABLE
 2. FINISHES: SEE TABLE
 3. "XX" REFERS TO THE QUANTITY OF CIRCUITS.
 4. SCREWS SUPPLIED UNASSEMBLED WITH -59 OPTION.
 5. ROHS COMPLIANT.

ITEM	QTY.	DESCRIPTION	MATERIAL	FINISH
7	XX	SCREW, M3.5X0.6X.304, CHSHD, POSI-SL, SQ/WSHR (-88 OPT)	STEEL	ZINC CHROMATE
6	XX	SCREW, M3.5X0.6X6MM PAN HD, PHIL-SLOT (-M, -49 OPT)	BRASS	NICKEL PLATE
5	XX	SCREW, #6-32X.250 BHD, PHIL-SLOT, SQ. WASHER (-50 OPT)	STEEL	ZN, CLEAR CHROMATE
4	XX	SCREW, #6-32X.250 BHD, PHIL-SLOT (STD OPT)	STEEL	ZN, CLEAR CHROMATE
3	XX	TERMINAL, WW, EXTRA LONG, -M OPT, -88 OPT	BRASS	TIN PLATE
2	XX	TERMINAL, WW, EXTRA LONG	BRASS	TIN PLATE
1	1	INSULATOR, SR, PC, MOLDED MTG	POLYESTER (PBT)	BLACK

REVISE & REDRAWN
 EC NO: IPG2014-1260
 DRAWN: JENC INAS 2013/08/28
 CHKD: JENC INAS
 APPR: JMACNEIL 2014/03/10

QUALITY SYMBOLS
 ▽=0
 ▽=0

	GENERAL TOLERANCES (UNLESS SPECIFIED)	
	mm	INCH
4 PLACES	± ---	± ---
3 PLACES	± ---	± .005
2 PLACES	± 0.13	± .01
1 PLACE	± 0.3	± ---
ANGULAR ± 2 °		

DRAFT WHERE APPLICABLE MUST REMAIN WITHIN DIMENSIONS

DIMENSION STYLE
MM/IN

DRAWN BY R. KEMP DATE 2005/08/17
 CHECKED BY GR DATE 2005/08/17
 APPROVED BY JMACNEIL DATE 2014/03/10

MATERIAL NO.
SEE SHEET 2

SCALE
2:1

DESIGN UNITS
INCH

THIRD ANGLE PROJECTION

TITLE
11.11/.438 SR BTS ASSY NO PADS, 81

MOLEX INCORPORATED

DOCUMENT NO.
SD-38639-006

SHEET NO.
1 OF 2

THIS DRAWING CONTAINS INFORMATION THAT IS PROPRIETARY TO MOLEX INCORPORATED AND SHOULD NOT BE USED WITHOUT WRITTEN PERMISSION

NO. OF CIRCUITS "XX"	DIM. "A"		DIM. "B"		DIM. "C"		DIM. "D"		ASSEMBLY MATERIAL NO. (-W-81)	ASSEMBLY MATERIAL NO. (-W-50-81)	ASSEMBLY MATERIAL NO. (-W-81-88)	ASSEMBLY MATERIAL NO. (-W-81-50-59)	ASSEMBLY MATERIAL NO. (-M-W-49-81)
	mm	in	mm	in	mm	in	mm	in					
02	43.4	1.71	11.11	.438	33.34	1.313	25.9	1.02	386390021		386390054	386390016	386390003
03	54.5	2.15	22.23	.875	44.45	1.750	37.0	1.46	386390025	386390027		386390017	
04	65.7	2.59	33.34	1.313	55.56	2.188	48.1	1.90	386390031		386390055	386390018	386390004
05	76.8	3.02	44.45	1.750	66.68	2.625	59.2	2.33	386390033			386390019	
06	87.9	3.46	55.56	2.188	77.79	3.063	70.4	2.77	386390036			386390020	
07	99.0	3.90	66.68	2.625	88.90	3.500	81.5	3.21	386390010				
08	110.1	4.34	77.79	3.063	100.01	3.938	92.6	3.65	386390011			386390087	
09	121.2	4.77	88.90	3.500	111.13	4.375	103.7	4.08	386390012			386390125	
10	132.3	5.21	100.01	3.938	122.24	4.813	114.8	4.52	386390013			386390088	
11	143.4	5.65	111.13	4.375	133.35	5.250	125.9	4.96	386390014				
12	154.6	6.09	122.24	4.813	144.46	5.688	137.0	5.40	386390015				

(B)

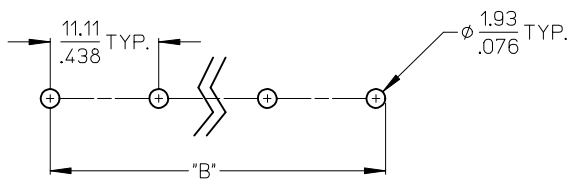

RECOMMENDED PCB LAYOUT

SEE SHEET ONE EC NO: IPG2014-1260 DRAWN: JENCINAS 2013/08/28 CHKD: APPR: JMACNEIL 2014/03/10 REV: B	DESCRIPTION QUALITY SYMBOLS ▽=0 ▽=0	GENERAL TOLERANCES (UNLESS SPECIFIED)		DIMENSION STYLE	SCALE	DESIGN UNITS	THIRD ANGLE PROJECTION	
				MM/IN	2:1	INCH		
		4 PLACES	± .005	± .005	DRAWN BY	DATE	TITLE 11.11/.438 SR BTS ASSY NO PADS, 81	
		3 PLACES	± .01	± .01	R. KEMP	2005/08/17		
2 PLACES	± 0.13	± .01	CHECKED BY	DATE	MOLEX INCORPORATED			
1 PLACE	± 0.3	± .01	GR	2005/08/17				
ANGULAR ± 2°		APPROVED BY		DATE	DOCUMENT NO.		SHEET NO.	
DRAFT WHERE APPLICABLE MUST REMAIN WITHIN DIMENSIONS		JMACNEIL		2014/03/10				
		MATERIAL NO.		SEE CHART		SD-38639-006		
		SIZE		THIS DRAWING CONTAINS INFORMATION THAT IS PROPRIETARY TO MOLEX INCORPORATED AND SHOULD NOT BE USED WITHOUT WRITTEN PERMISSION				