

NOTES:

- MATERIAL: 0.006" TIN PLATED STEEL PER ASTM A623/A624

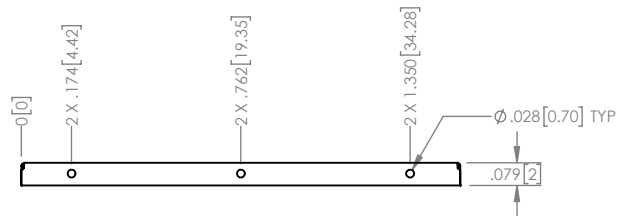
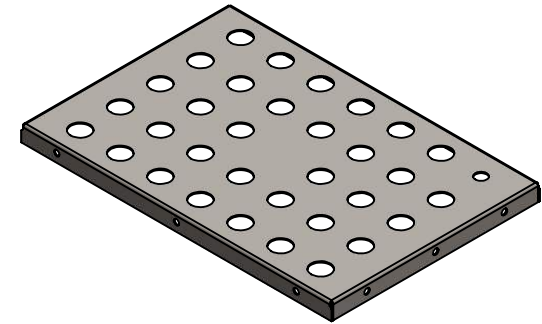
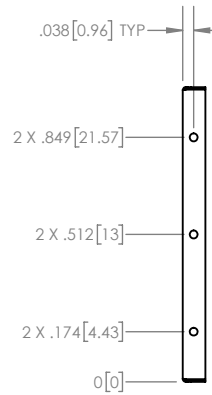
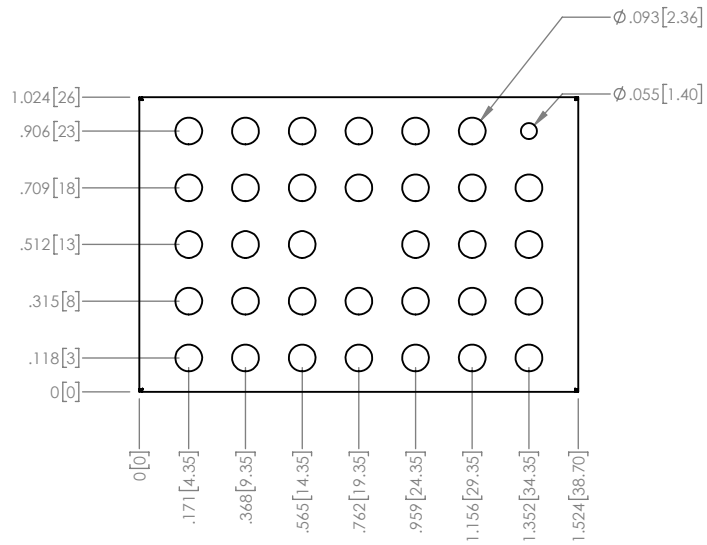

PROPRIETARY NOTICE: THESE DRAWINGS, LISTS OR SPECIFICATIONS ARE THE CONFIDENTIAL INFORMATION AND/OR TRADE SECRETS OF 3G SHIELDING SPECIALTIES (P), AND SHOWN IN STRICT CONFIDENCE EXCEPT AS AUTHORIZED BY 3G SHIELDING SPECIALTIES IN WRITING. THESE DRAWINGS, LISTS OR SPECIFICATIONS SHALL NOT BE REPRODUCED, RETRANSMITTED, USED FOR THE DESIGN, MANUFACTURE OR SALE OF EQUIPMENT OR USED FOR ANY OTHER PURPOSES WITHOUT WRITTEN EVALUATION.

UNLESS OTHERWISE SPECIFIED U/M TOLERANCE INCHES ±0.005	ROHS COMPLIANCE 2011/65/EU
DATE 16-01-26	



PART NUMBER <b>PIC-S-205C</b>	REV. <b>0</b>
DESCRIPTION SHIELD COVER	
SCALE 1.5:1	SHEET 1 OF 1