

THIS DRAWING IS A CONTROLLED DOCUMENT.

RELEASED FOR PUBLICATION JULY, 1988.
 BY AMP INCORPORATED. ALL RIGHTS RESERVED.
 © COPYRIGHT 1988

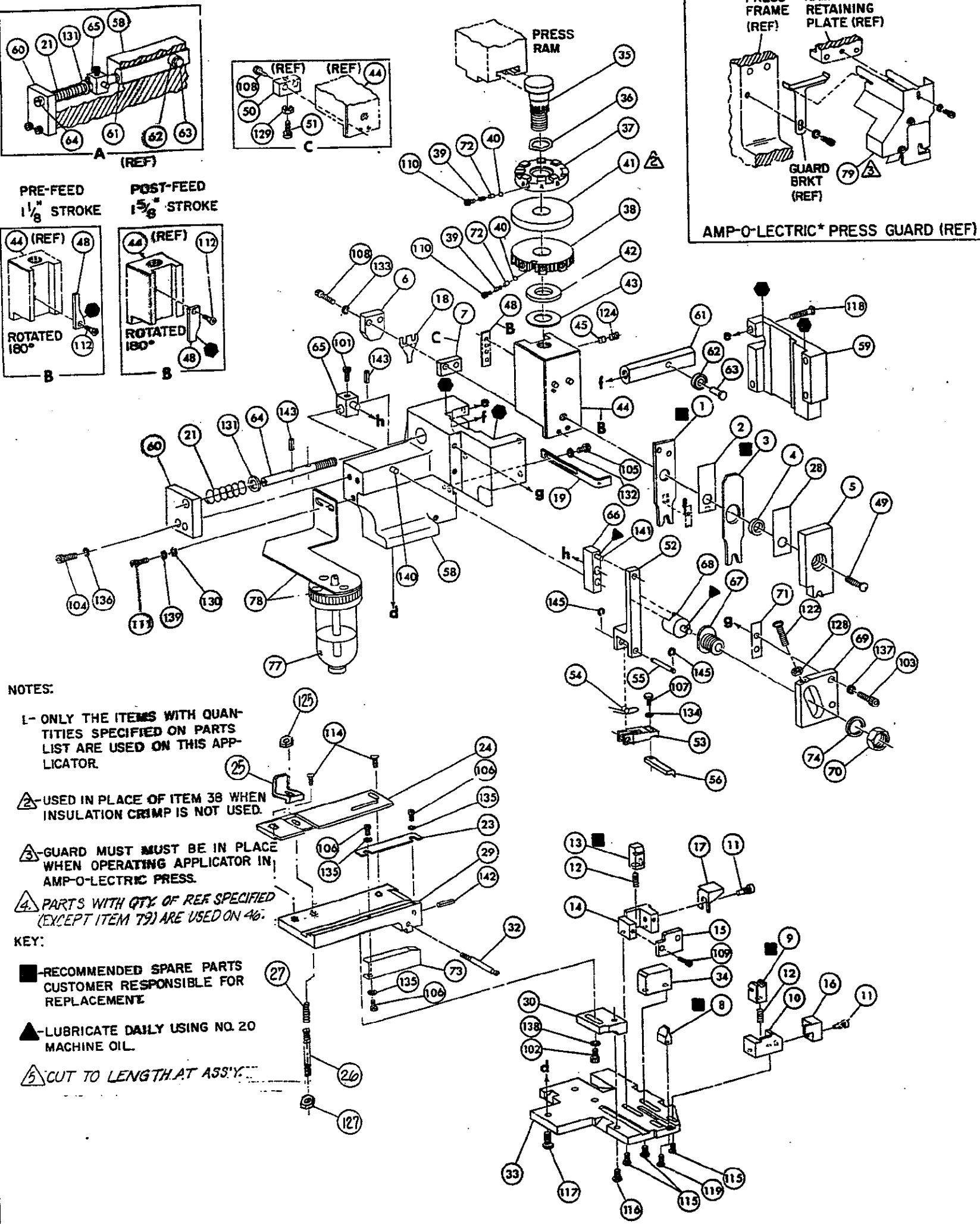

NOTES:

I- ONLY THE ITEMS WITH QUANTITIES SPECIFIED ON PARTS LIST ARE USED ON THIS APPLICATOR.

Δ- USED IN PLACE OF ITEM 38 WHEN INSULATION CRIMP IS NOT USED.

Δ- GUARD MUST BE IN PLACE WHEN OPERATING APPLICATOR IN AMP-O-LECTRIC PRESS.

Δ- PARTS WITH QTY OF REF SPECIFIED (EXCEPT ITEM 79) ARE USED ON 46.

KEY:

■- RECOMMENDED SPARE PARTS CUSTOMER RESPONSIBLE FOR REPLACEMENT

▲- LUBRICATE DAILY USING NO. 20 MACHINE OIL.

△- CUT TO LENGTH AT ASS'Y.

*Trademark of AMP Incorporated
 AMP 2983-3 (8-73)

REF.	21045-3	RING, RETAINING 'C' (.187 DIA) FEED FINGER PIN	145	REF.	454226-1	CAP. HOUSING	59
	144			REF.	454485-1	HOUSING	58
							57
REF.	5-21028-1	PIN, SLOT SPR (.125 DIA X .50) ADJ ROD	143				56
	4-21028-0	PIN, SLOT SPR (.093 DIA X .75) STR G PLATE	142	1	694425-7	PAWL, FEED	55
REF.	1-21030-1	PIN, DOWEL (.187 DIA X .50) LEVER	141	REF.	240624-1	PIN, FEED FINGER	54
	1-21030-6	PIN, DOWEL (.187 DIA X 1.25) HOUSING	140	REF.	691499-1	SPRING, FEED FINGER	53
	21024-5	WASHER, LOCK (NO 10) LUB ASSY	139	REF.	690541-1	FINGER, FEED	52
	21024-5	WASHER, LOCK (NO 10) STRIP GUIDE ADJ BLOCK	138	REF.	455679-1	LEVER, TERMINAL FEED ARM	51
REF.	21024-5	WASHER, LOCK (NO 10) ADJ PLATE	137	+		BUMPER, HOLDDOWN	50
	21024-5	WASHER, LOCK (NO 10) FEED GUIDE ROD	136	+		SPACER, TONKER	49
	21057-2	WASHER, LOCK (NO 4) FRONT STRIP GUIDE	135	1	7-21002-9	BOLT, CRIMPER	48
	21024-4	WASHER, LOCK (NO 8) FEED FINGER	134	1	690501-4	CAM POST FEED	47
	21024-4	WASHER, LOCK (NO 8) DEPRESSOR	133				46
REF.	21024-4	WASHER, LOCK (NO 8) STRIPPER	132	1	459456-1	APPLICATOR, BASIC (SUB ASSY)	45
	21899-4	WASHER, FLAT (5/16 DIA) SCREW ADJ	131	1	690191-1	PLUG, NYLON	44
	21899-2	WASHER, FLAT (NO 10) LUB ASSY	130	1	455673-1	RAM	43
	21068-5	NUT, HEX MACH (6-32) HOLDDOWN	129	1	690125-1	WASHER, LAMINATED	42
	21068-5	NUT, HEX MACH (6-32) FEED ADJ	128	1	690124-1	WASHER, RAM	41
REF.	21021-5	NUT, HEX LACK (DRAG)	127	1	690 273-1	DISC, SPACER	40
	22353-8	SCR, SHLD. (.187 DIA X .250 LG) DRAG LEVER	126	1	23241-6	BALL, STEEL	39
	21018-6	NUT, HEX, MACH. 8-52 (DRAG)	125	1	690170-1	SPRING, COMPRESSION	38
	22651-9	SCR, SKT SET (1/4-20 X .25) (LOC-WEL) RAM	124	+		DISC, INSULATION	37
			123	1	1-690697-2	DISC, WIRE	36
REF.	3-21064-2	SCR, RD HD MACH (6-32 X 1.50) FEED ADJ	122	1	22480-5	WASHER, SPRING	35
			121	1	690212-1	POST, RAM	34
	2-21002-9	SCR, BUT HD SKT CAP (10-32 X .75) DRAG	120	+		SUPPORT, TERMINAL	33
	24073-2	SCR, BUT HD SKT CAP (8-32 X .38) (LOC-WEL) ANVIL	119	REF.	455675-1	PLATE, BASE	32
REF.	2-21002-9	SCR, BUT HD SKT CAP (10-32 X .75) CAP	118	1	690432-3	SCREW, ADJUSTMENT	31
	1-24073-9	SCR, BUT HD SKT CAP (1/4-20 X .75) HOUSING	117				30
REF.	2-21002-9	SCR, BUT HD SKT CAP (10-32 X .50) SG ADJ BLOCK	116	REF.	455689-1	BLOCK, STRIP GUIDE ADJ	29
	2-21002-2	SCR, BUT HD SKT CAP (8-32 X .50) SHEAR	115	1	460976-1	PLATE, STRIP GUIDE	28
	1-21002-7	SCR, BUT HD SKT CAP (6-32 X .35) R STRIP GUIDE	114	1	1-455688-0	SPACER, FRONT SHEAR DEPRESSOR	27
			113	2	3-22720-5	SPRING, DRAG	26
	2-21003-0	SCR, FLAT HD SKT CAP (6-32 X .50) CAM	112	1	22254-8	DRAG, STUD	25
	3-21000-4	SCR, SKT HD CAP (10-32 X .38) LUBRICATOR ASSY	111	1	387650-5	DRAG, STOCK	24
	3-23657-8	SCR, SKT HD CAP (6-32 X .25) (LOC-WEL) CP DISC	110	1	480462-3	GUIDE STRIP (REAR)	23
	1-21000-9	SCR, SKT HD CAP (6-32 X .35) REAR SHEAR PLATE	109	1	460975-1	GUIDE, STRIP (FRONT)	22
	2-21000-2	SCR, SKT HD CAP (8-32 X .77) DEPRESSOR	108				21
	2-22603-0	SCR, HEX HD MACH (8-32 X .31) FEED FINGER	107	K E F	4-22284-9	SPRING, FEED RETURN	20
	1-21000-9	SCR, SKT HD CAP (6-32 X .25) F STRIP GUIDE	106				19
	2-21000-7	SCR, SKT HD CAP (8-32 X .50) STRIPPER	105	1	690472-1	STRIPPER	18
REF.	3-21000-7	SCR, SKT HD CAP (10-32 X .75) FEED ROD GUIDE	104	+		HOLDER, TERMINAL	17
REF.	3-21000-6	SCR, SKT HD CAP (10-32 X .62) FEED ADJ BLOCK	103	1	691668-1	GUARD, CHIP (REAR)	16
	3-21000-4	SCR, SKT HD CAP (10-32 X .38) SG ADJ BLOCK	102	1	691667-1	GUARD, CHIP (FRONT)	15
REF.	3-21000-4	SCR, SKT HD CAP (10-32 X .38) PIVOT BLOCK	101	1	460974-1	PLATE, SHEAR (REAR)	14
REF.	455749-1	GUARD, WINDOW	79	1	690462-4	HOLDER, SHEAR (REAR)	13
	1-455184-0	LUBRICATOR ASSY	78	1	690463-5	SHEAR, FLOAT (REAR)	12
		OIL, LUBRICATING	77	2	5-22280-0	SPRING, SHEAR	11
			76	2	690461-1	STOP, SHEAR	10
			75	1	690459-1	HOLDER, SHEAR (FRONT)	9
REF.	458109-1	WASHER, SPECIAL	74	1	454276-1	SHEAR, FLOAT (FRONT)	8
		PLATE, STRIP GUIDE COVER	73	1	5-690572-8	ANVIL	7
	690603-1	SPRING, ASSIST	72	1	1-240641-8	SPACER, DEPRESSOR (REAR)	6
REF.	690517-1	SPACER	71	1	690468-1	DEPRESSOR, SHEAR (FRONT)	5
	22594-8	NUT, HEX	70	1	455259-9	DEPRESSOR, SHEAR (FRONT)	4
	240628-1	PLATE, ADJUSTMENT	69	+		SPACER, TUBULAR, INS CRIMPER	3
	240626-1	SHAFT, PIVOT	68	+		CRIMPER, INSULATION	2
	240633-1	BUSHING	67	+		SPACER, CRIMPER	1
	455680-1	LEVER, INTERMEDIATE	66	1	3-456402-3	CRIMPER, WIRE	1
	240629-1	BLOCK, PIVOT	65				
	240632-2	SCREW, ADJUSTMENT FEED ROD	64				
	240629-3	PIN, CAM ROLLER	63				
	240628-1	ROLLER, CAM	62				
	454398-2	ROD, FEED	61				
REF.	454178-1	GUIDE, FEED ROD	60				
QTY	PART NO	DESCRIPTION	REV	QTY	PART NO	DESCRIPTION	REV

CRIMPING DATA				APPLICATOR WILL APPLY	
PAD LTR	CRIMP HEIGHT	WIRE SIZE	WIRE LENGTH		
A	.045	20			41987
B	.040	22			41989
C	NOT USED				42233
D	NOT USED				
CRIMP	SIZE	TYPE	FEED	APPL INST	
WIRE	.095	F	.700	A1 804-0	
INSUL					
WIRE RANGE	22-20	INSULATION RANGE	PRESS NO		
REMARKS	AMPOMATOR FRO				
	J. D. PLATE (REF) 461264-1				
	SET UP PAGE 10-1 458637-1 746				
	BY 5/17/88 [Signature]				
	CNS 460129-1				
	NAME MANUFACTURE QUICK CHANGE APPLICATOR				
	SIDE FEED (TAB RECEIPT)				