

PRODUCT NO.  
10116658-\*52\*\*

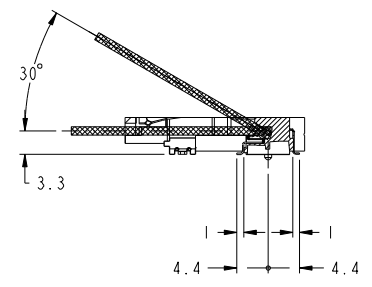

SECTION XI-XI

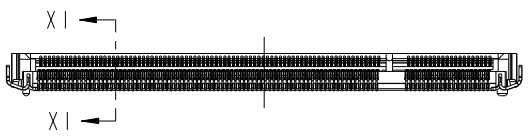
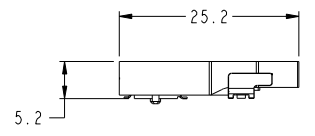
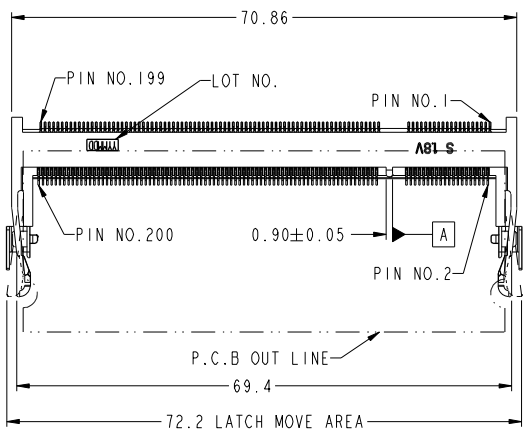
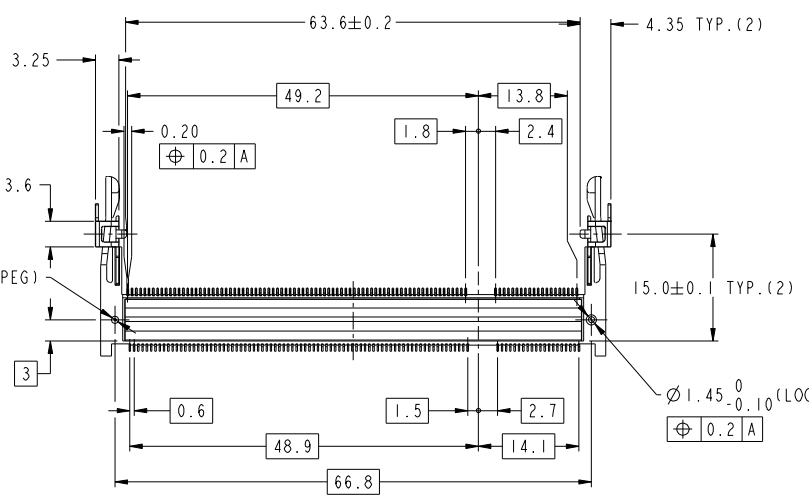

- NOTE
1. PRODUCT SPEC. : GS-12-195
  2. PACKAGING SPEC. : GS-14-786

3. MATERIAL:
  - 1) HOUSING : LCP, UL94V-0, COLOR BLACK
  - 2) CONTACT : COPPER ALLOY
  - 3) HOLD DOWN : BRASS

4. FINISH
  - 1) TERMINAL : SEE TABLE
  - 2) HOLD DOWN : SEE TABLE
5. CO-PLANARITY : 0.1 MAX. (INCLUDE HOLD DOWN)

6. THIS PRODUCT MEETS EUROPEAN UNION DIRECTIVES AND OTHER COUNTRY REGULATIONS AS DESCRIBED IN GS-22-008.
7. THE HOUSING WILL WITHSTAND EXPOSURE TO 260° PEAK TEMPERATURE FOR 10 SECONDS IN A REFLOW SOLDER APPLICATION.

Copyright FCI.

www.fciconnect.com				surface	tolerance std	projection	MM
				ASME Y14.5	ASME Y14.5		
				TOLERANCES UNLESS OTHERWISE SPECIFIED			
rev	ecn no	dr	date	Dr	SH MIAO	2011-03-28	ANGULAR
A	DG11-0085	SH	2011-03-28	Eng	SH MIAO	2011-03-28	LINEAR
				Chr	RICK BIAN	2011-03-28	0° ±5°
				Appr	RICK BIAN	2011-03-28	0.xxx ±0.15
							0.xxx ±0.08
							size A2
							Scale 1:1
							ECN DG11-0085
							Product family 50UF
							SO-DIMM Spec ref RELEASED
							Rev. A
							10116658
							customer copy sheet 1 of 4

PRODUCT NO.

10116658-\*52\*\*

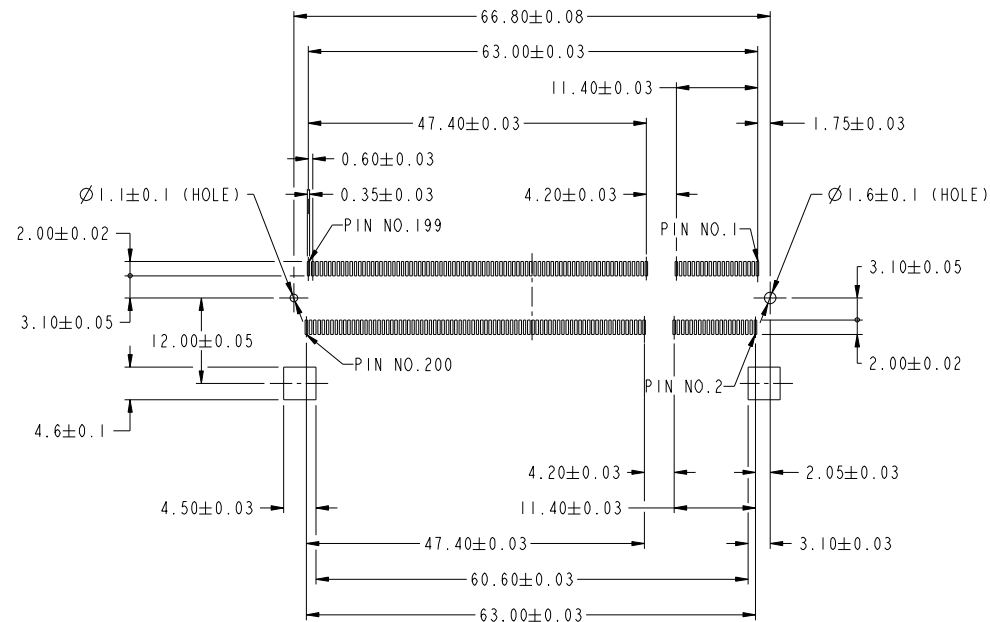

RECOMMENDED MOUNTING P.C.B. LAYOUT



Copyright FCI.

	FILE	DDR II 0.6mm PITCH 200 POS	diag no	10116658	Rev.
	TYPE	STANDARD TYPE ASS'Y			A
	CATALOG NO		CUSTOMER COPY	sheet 2 of 4	

PDM: Rev:A

STATUS: Released

Printed: Apr 22, 2011

PRODUCT NO.

10116658-\*52\*\*

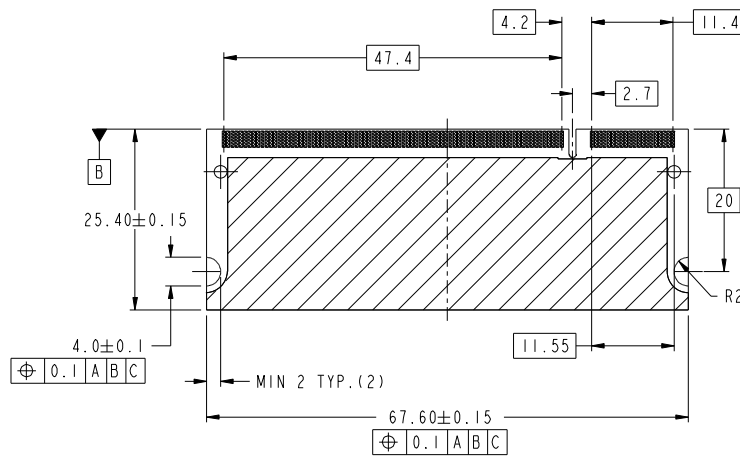
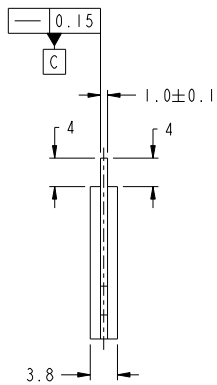
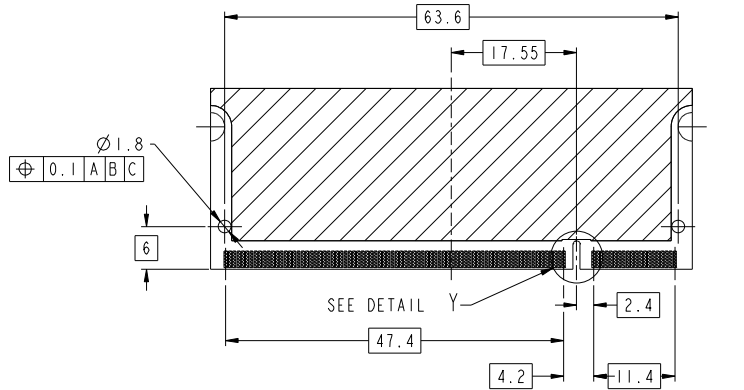

RECOMMENDED MODULE P.C.B LAYOUT

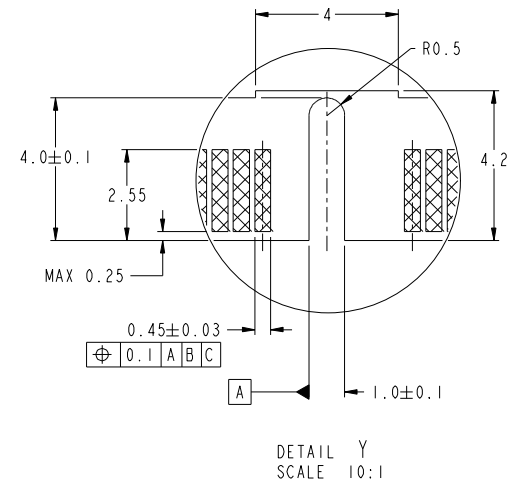

Copyright FCI.



FCI	TITLE	DDR II 0.6mm PITCH 200 POS	Rev.	
	STANDARD TYPE ASS'Y		A	
CATALOG NO.		CUSTOMER COPY	sheet 3 of 4	

PDM: Rev:A

STATUS Released

Printed: Apr 22, 2011

1		2		3		4		5		6		7		8	
PRODUCT NO.	LOCATING PEG	TERMINAL CONTACT AREA FINISH	HOLD-DOWN FINISH	SOLDER TAIL FINISH											
A	10116658-052FSLF	YES	Au FLASH	PURE Sn PLATING	Au FLASH	10116658-□□□□□ LF For Rohs OPTIONS: TAIL PLATING CODE MUST BE 0-3. HOLD-DOWN PLATING CODE MUST BE "S". "LF" CODE IS EXIST IN THE END. EX: 10116658-252TSLF  FOR NOT Rohs COMPATIBLE: THIS "LF" CODE IS "BLANK". EX: 10116658-452TS  <PACKING METHOD> R : TAPE REEL DEFAULT : TRAY  <HOLD-DOWN FINISH> S : Pure Sn B : Sn-Pb  <CONTACT AREA FINISH> F : Au FLASH T : Au 0.3μm MIN. A : Au 0.76μm MIN.  <TOTAL HEIGHT> 52 : 5.2mm  <LOCATING PEG, SOLDER TAIL FINISH> 0 : YES, Au FLASH 1 : NO, Au FLASH 2 : YES, Pure Sn PLATING 3 : NO, Pure Sn PLATING 4 : YES, Sn-Pb PLATING 5 : NO, Sn-Pb PLATING									
	10116658-152FSLF	NO													
	10116658-052TSLF	YES	Au 0.3μm MIN.												
	10116658-152TSLF	NO													
B	10116658-052ASLF	YES	Au 0.76μm MIN.	Sn-Pb PLATING											
	10116658-152ASLF	NO													
	10116658-052FB	YES	Au FLASH												
	10116658-152FB	NO													
10116658-052TB	YES	Au 0.3μm MIN.													
10116658-152TB	NO														
C	10116658-052AB	YES	Au 0.76μm MIN.	Pure Sn PLATING											
	10116658-152AB	NO													
	10116658-252FSLF	YES	Au FLASH												
	10116658-352FSLF	NO													
10116658-252TSLF	YES	Au 0.3μm MIN.													
10116658-352TSLF	NO														
D	10116658-252ASLF	YES	Au 0.76μm MIN.		Sn-Pb PLATING										
	10116658-352ASLF	NO													
	10116658-252FB	YES	Au FLASH												
	10116658-352FB	NO													
10116658-252TB	YES	Au 0.3μm MIN.													
10116658-352TB	NO														
E	10116658-252AB	YES	Au 0.76μm MIN.	Sn-Pb PLATING											
	10116658-352AB	NO													
	10116658-452FS	YES	Au FLASH												
	10116658-552FS	NO													
10116658-452TS	YES	Au 0.3μm MIN.													
10116658-552TS	NO														
F	10116658-452AS	YES	Au 0.76μm MIN.												
	10116658-552AS	NO													
	10116658-452FB	YES	Au FLASH												
	10116658-552FB	NO													
10116658-452TB	YES	Au 0.3μm MIN.													
10116658-552TB	NO														
10116658-452AB	YES	Au 0.76μm MIN.													
10116658-552AB	NO														

Copyright FCI.

FCI	DDR II 0.6mm PITCH 200 POS	10116658	Rev.
	STANDARD TYPE ASS'Y	A	
catalog no	CUSTOMER COPY		sheet 4 of 4