

Recommended P.C. Board Layout
SCALE 6:1

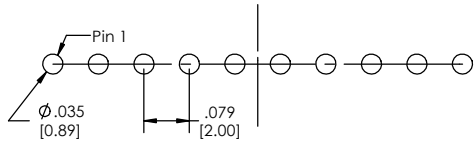

SINGLE ROW

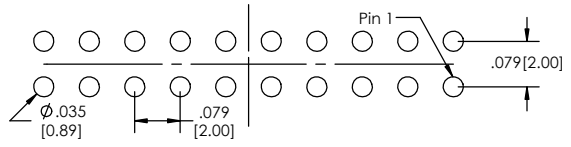

DOUBLE ROW

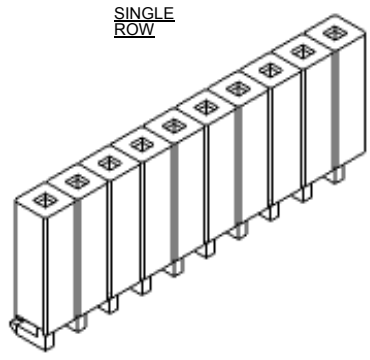

SINGLE ROW

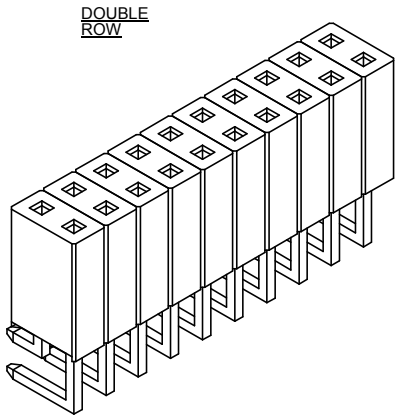

DOUBLE ROW

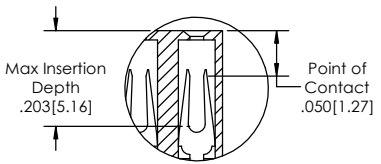

APPLICATION

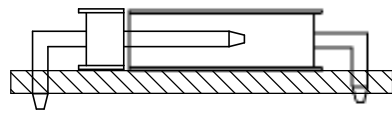

SINGLE ROW

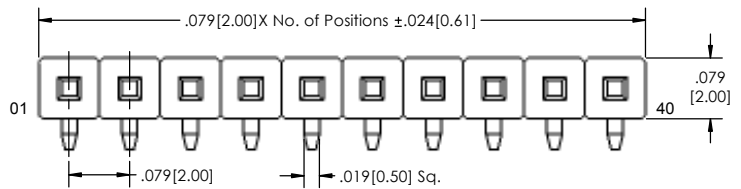
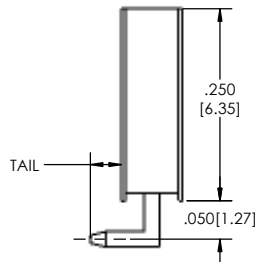

DOUBLE ROW

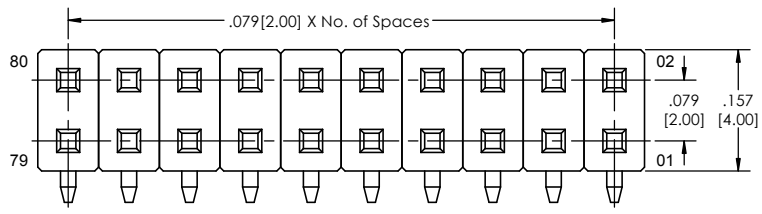
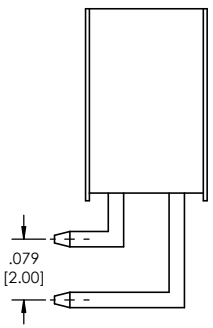

SSHQR-2 **XX** - **X** - **XX** - **XX** - **XX** - **XXX** - **LF**
(A) (B) (C) (D) (E) (F) (G)

- A. Pins Per Row**
- 1 through 40
- B. Row Specification**
- S= Single Row
- D= Double Row
- C. Pin Options**
- See Pin Options below
- D. Plating Options**
- See Plating Options below
- E. Lock Tight "LT" (Optional)**
- Leave blank if not needed
- LT= With
- F. Polarized Position**
- Leave blank if not needed
- If required, specify empty pin position
- e.g. 012 for Pin 12
- G. Lead Free**

- Mates with:
- BSTC TSHR
 - BSTCM TSHRE
 - BSTCR TSHS
 - BSTCRSM TSHRE
 - BSTS TSHS
 - TBSTC TSHSCM
 - TBSTCM TTSHC
 - TBSTS TTSHCR
 - TSHC TTSHCRE
 - TSHCR TTSHR
 - TSHCRE TTSHRE
 - TSHCRSM TTSHS
 - TTSHM

Plating options	
G	-10µ Gold on Contact Area/ Flash on Tail
T	-Matte Tin all Over
GT	-10µ Gold on Contact Area/ Matte Tin on Tail
H	-30µ Gold on Contact Area/ Matte Tin on Tail
F	-Gold Flash over Entire Pin
FT	-Gold Flash on Contact Area/ Matte Tin on Tail

Specifications:
 Insertion Force- Single Contact only- H Plating
 4oz. [1.11N] avg with .079[2.00mm] sq. pin
 Withdrawal Force- Single Contact only- H Plating:
 3oz. [0.83N] avg with .079[2.00mm] sq. pin
 Current Rating: 2.0 Ampere
 Insulation Resistance: 1000M Ohms Min.
 Dielectric Withstanding: 500V AC
 Contact Resistance: 10M Ohms Max.
 Operation Temperature: -40°C to +105°C
 Max. Process Temperature
 Peak: 260°C up to 10 secs.
 Process: 230°C up to 60 secs.
 Wave: 260°C up to 6 secs.
 Manual Solder: 350°C up to 5 secs.

Pin Options	
Tail	
.090[2.29mm]	02
.248[6.30mm]	04
.406[10.31mm]	06

Materials:
 Contact Material: Phosphor Bronze
 Insulator Material: Nylon 6T
 Plating: Au or Sn over 50µ" (1.27) Ni

Tails may be clipped to achieve specific dimensions.

Products cut to specific sizes are uncancelable/ nonreturnable.
 Parts are subject to change without notice.



PROPRIETARY AND CONFIDENTIAL
 THE INFORMATION CONTAINED IN THIS DRAWING IS THE SOLE PROPERTY OF Major League Electronics. ANY REPRODUCTION IN PART OR AS A WHOLE WITHOUT THE WRITTEN PERMISSION OF Major League Electronics IS PROHIBITED.

UNLESS OTHERWISE SPECIFIED:		NAME		DATE	
DIMENSIONS ARE IN INCHES		DRAWN		EOW	
TOLERANCES:		CHECKED		GWE	
ONE DECIMALS ±.100		ENG APPR.			
TWO DECIMAL ±.100		MFG APPR.			
THREE DECIMAL ±.002		ADDRESS:		2533 Centennial Blvd.	
FOUR DECIMAL ±.002		MATERIAL:		Jeffersonville, IN 47130	
NEXT ASSY		FINISH:		Phone: 812-670-4174	
USED ON		DO NOT SCALE DRAWING		Fax: 812-670-4175	
APPLICATION		E-Mail: mle@mlelectronics.com		E-Mail: mle@mlelectronics.com	
TITLE: SSHQR-2 SERIES				REV B	
SIZE DWG. NO. C				SHEET 1 OF 1	
SCALE 8:1					