

**MATERIAL:**

BACKSHELL: NICKEL PLATED DIE-CAST ZINC ALLOY  
 HARDWARE: NICKEL PLATED STEEL

**BACKSHELL KIT INCLUDES:**

- (2x) BACKSHELL HALVES
- (2x) HOUSING SCREWS
- (2x) HOUSING NUTS
- (2x) STRAIN RELIEF CLAMPS
- (2x) STRAIN RELIEF SCREWS

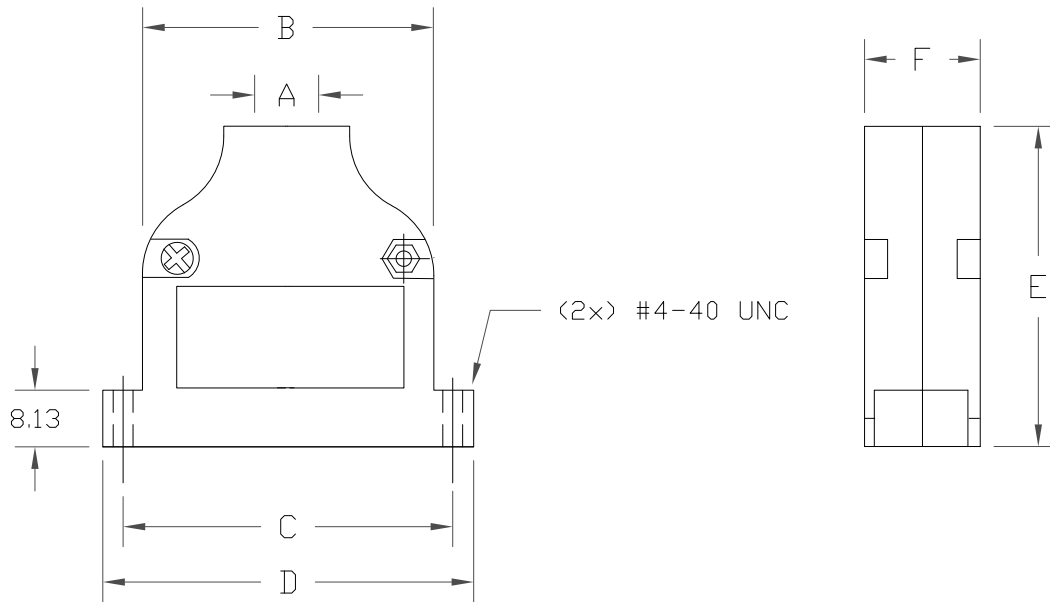

DIMENSIONS(mm) [All tolerances ±0.5m]						
SIZE	A	B	C	D	E	F
9	11.00	20.07	24.99	31.80	46.00	16.00
15	11.00	28.83	33.32	40.00	46.00	16.90
25	11.00	41.66	47.04	53.50	46.00	16.10

**994-YYY-030R121**

SERIES \_\_\_\_\_  
 POSITIONS \_\_\_\_\_  
 009  
 015  
 025

RoHS COMPLIANT

UNITS = mm

DO NOT SCALE FROM DRAWING



THESE DRAWINGS AND SPECIFICATIONS ARE THE PROPERTY OF NorComp AND SHALL NOT BE REPRODUCED, COPIED OR USED AS THE BASIS FOR THE MANUFACTURE OR SALE OF APPARATUS WITHOUT WRITTEN PERMISSION.

DRAWN:  
**P. JENKINS**  
 DATE:  
 09/15/2005

**NorComp**

SCALE: NTS	SHEET 1	OF 1	REV 4
DWG NO. <b>994-0YY-030R121</b>			