

PRODUCT DATA DRAWING

REVISION HISTORY			
REV	DESCRIPTION	DATE	APPROVED
-	REL.NRN 33522	12/16/05	STW
A	REV. DCN 33957	02/16/06	STW

SMP FULL DETENT
INTERFACE PER
MIL-STD-348

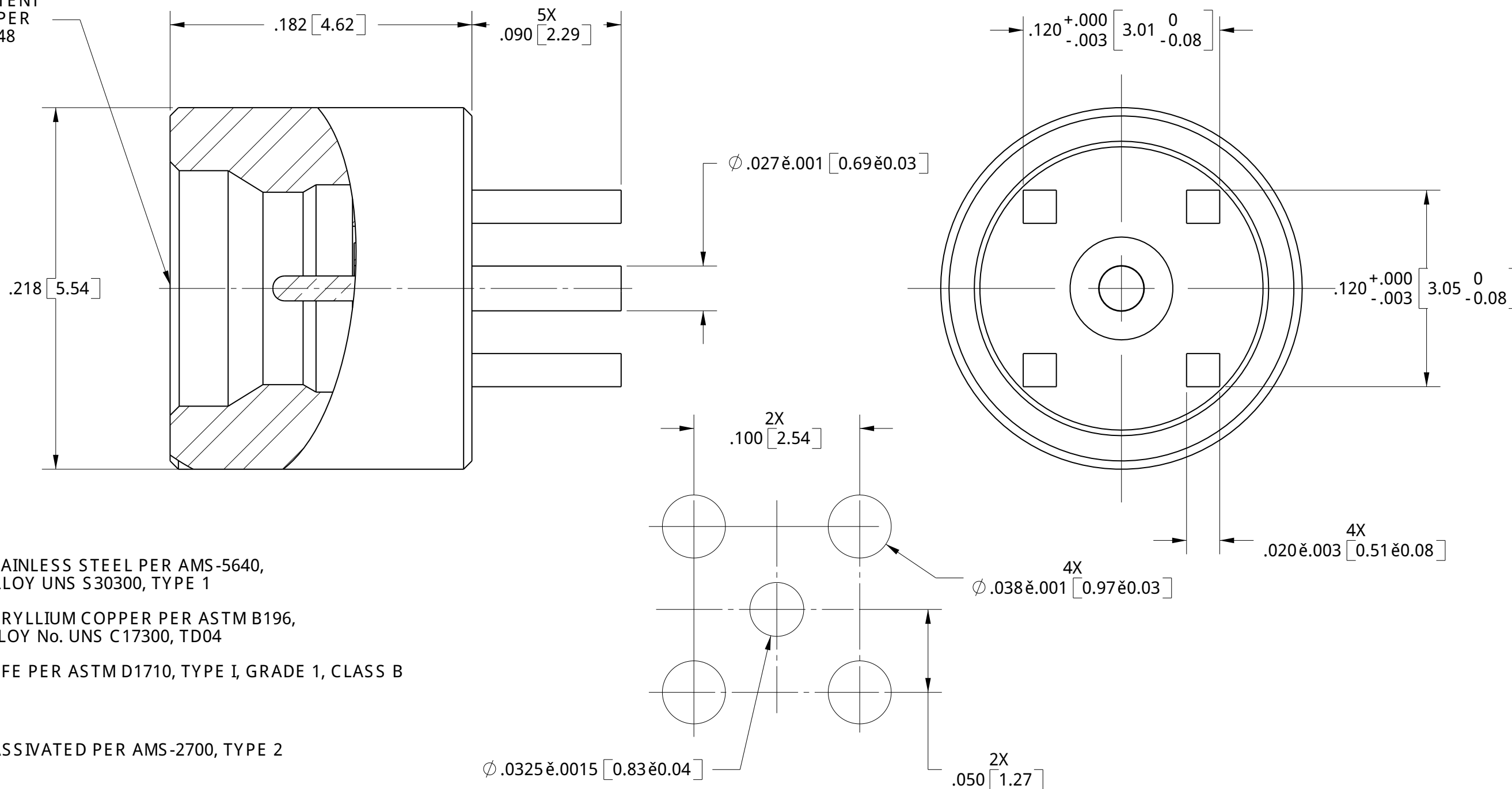

MATERIAL:
INTERFACE BODY: STAINLESS STEEL PER AMS-5640, ALLOY UNS S30300, TYPE 1
PC LEGS BODY & CONTACT: BERYLLIUM COPPER PER ASTM B196, ALLOY No. UNS C17300, TD04
INSULATOR: PTFE PER ASTM D1710, TYPE I, GRADE 1, CLASS B
FINISH:
INTERFACE BODY: PASSIVATED PER AMS-2700, TYPE 2
PC LEGS BODY & CONTACT: GOLD PER ASTM B488, TYPE II, CODE C, CLASS 1.27; OVER NICKEL PER AMS-QQ-N-290, CLASS 1, .00005" MIN.

PERFORMANCE :
IMPEDANCE: 50 OHMS
FREQ. RANGE: DC TO 40.0 GHz
DWV: 500 VRMS
OPERATING TEMP.: -55 °C TO +125 °C
ENGAGEMENT/DISENGAGEMENT: 15 LBS MAX. ENGAGEMENT
 5 LBS MIN. DISENGAGEMENT

RECOMMENDED MOUNTING HOLE PATTERN

NOTES:
 1. FOR A FOOTPRINT RECOMMENDATION SPECIFIC TO YOUR PCB, PLEASE CONTACT US AT applications@svmicro.com

MATERIAL: SEE NOTES	DIMENSIONS ARE IN INCHES TOLERANCES: FRACTIONAL: ±1/64 ANGULAR: X° ±1°0' X "X' ±15'	UNLESS OTHERWISE SPECIFIED 1) ALL DIMENSIONS ARE IN INCHES (MILLIMETERS) 2) ALL DIMENSIONS ARE AFTER PLATING. 3) BREAK CORNERS & EDGES .005 R. MAX. 4) CHAM. 1ST & LAST THREADS. 5) SURFACE ROUGHNESS 63-MIL-STD-10. 6) DIA. 5 ON COMMON CENTERS TO BE CONCENTRIC WITHIN .005 T.I.R. 7) REMOVE ALL BURRS	SV Microwave, Inc. 2400 Centrepark West Drive, Suite 100 West Palm Beach, FL 33409
FINISH: SEE NOTES	DECIMAL: .X ±.030 .XX ±.010 .XXX ±.005	INTERPRET DIMENSIONS AND TOLERANCES PER ASME Y14.5M - 1994	TITLE: SMP MALE PC MOUNT
SURFACE AREA: N/A	THIRD ANGLE PROJECTION	DRAWN: JMC 12/16/05 CHECKED: STW 12/16/05 APPROVED: STW 12/16/05	SIZE B CAGE CODE 95077 DWG. NO. SF1287-6001
PROPRIETARY THE INFORMATION CONTAINED IN THIS DRAWING IS THE SOLE PROPERTY OF SV MICROWAVE, INC. ANY REPRODUCTION IN PART OR AS A WHOLE WITHOUT THE WRITTEN PERMISSION OF SV MICROWAVE, INC IS PROHIBITED.			SCALE: 15:1 SHEET 1 OF 1