

REV.	DESCRIPTION	DATE
A	RELEASE	2012.11.12

# RoHS

NOTES:  
 Insulator Material: PBT, UL 94V-0  
 Contact Plating: TIN, 80-100µ"  
 Contact Material: Brass

Current Rating : 1A AC,DC  
 Contact Resistance: 20MΩ Max.  
 Dielectric Withstanding: AC 500V  
 Insulator Resistance: 1000MΩ Min.  
 Operating Temp.: -40°C~+105°C

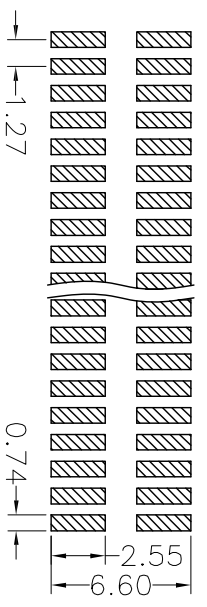
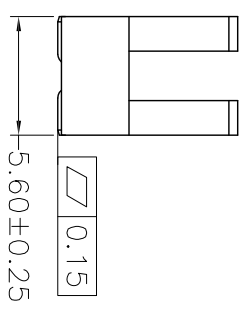
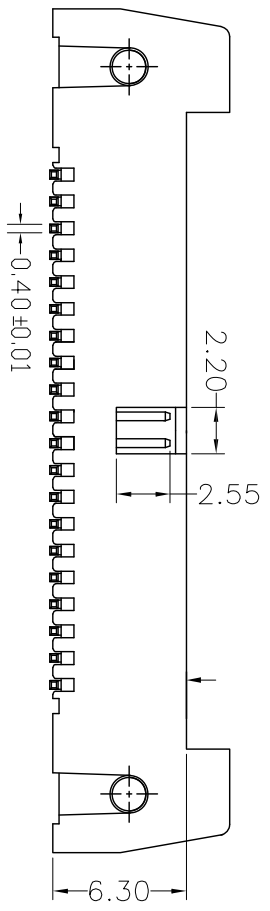
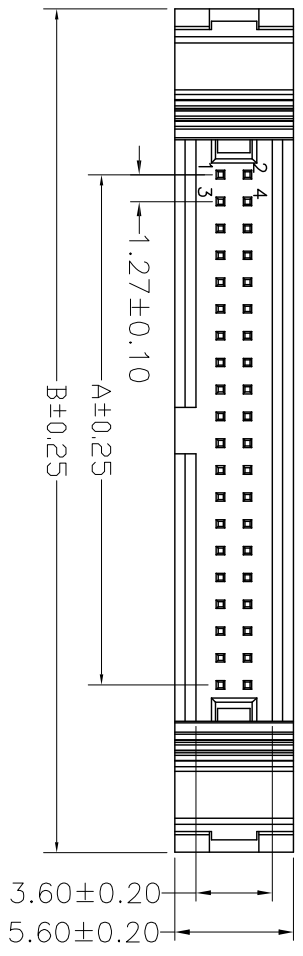

P.C.B LAYOUT

NUMBER OF POSITIONS	DIMENSIONS	
	A	B
06	2.54	18.31
08	3.81	19.58
10	5.08	20.85
12	6.35	22.12
14	7.62	23.39
16	8.89	24.66
18	10.16	25.93
20	11.42	27.20
24	13.97	29.74
26	15.24	31.01
30	17.78	33.55
34	20.32	36.09
40	24.13	39.90
50	30.48	46.25
60	36.83	52.60
64	39.37	55.14

CnC Tech,LLC

3210-XX-003-11-99

UNLESS TOLERANCE		DRAW BY	
GENERAL	ANGLE	DESIGN BY	CHECK BY
X ± 0.30	X° ± 3.0°		
.X ± 0.20	.X° ± 2.0°		
.XX ± 0.15	.XX° ± 1.0°		
.XXX ± 0.08	.XXX ± 0.5°		

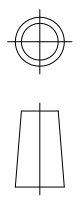

SCALE	SHEET	UNIT
1:1	1/1	MM

DRAW NO:	REV: A
3210-XX-003-11-99	A