

spec ref	-	dr	Leborn Luo	2017/09/11	projection	mm	size	A2	scale	5:1
tolerance std	ISO 406 ISO 1101	eng	Leborn Luo	2017/12/05		mm	ecn no	-	rel level	Released
TOLERANCES UNLESS OTHERWISE SPECIFIED		chr	Fancy Zhang	2017/12/04						
surface	ISO 1302	appr	Pei-Ming Zheng	2017/12/05	product family	-	cat. no.	-	Product - Customer Drw	sheet 1 of 3
	linear	0.X	±0.5		title		HPCE BTB VERT REC 24S(WITH GUIDE POST)	dwg no 10145311	rev A	
		0.XX	±0.25							
		0.XXX	±0.10							
	angular	0°	±2°							

CONTACT TYPE	TOP LAYER DESCRIPTION	TABLE 1 (HPCE / SOLDER TAILS) PLATED THROUGH-HOLE REQUIREMENTS				
		DRILLED HOLE DIAMETER	COPPER THICKNESS	TIN-LEAD THICKNESS	TIN THICKNESS	FINISHED HOLE DIAMETER
SIGNAL	TIN-LEAD	1.10-1.16 (1.15 DRILL)	0.025 - 0.050	0.005 - 0.015	--	0.94 - 1.10
	IMMERSION TIN	1.10-1.16 (1.15 DRILL)	0.025 - 0.050	--	0.9 - 1.5um	0.94 - 1.10
	COPPER	1.10-1.16 (1.15 DRILL)	0.025 - 0.050	--	--	0.94 - 1.10

CONTACT TYPE	TOP LAYER DESCRIPTION	TABLE 2 (HPCE / PRESS-FIT TAILS) PLATED THROUGH-HOLE REQUIREMENTS				
		DRILLED HOLE DIAMETER	COPPER THICKNESS	TIN-LEAD THICKNESS	TIN THICKNESS	FINISHED HOLE DIAMETER
SIGNAL	TIN-LEAD	0.81-0.86 (0.85 DRILL)	0.025 - 0.050	0.005 - 0.015	--	0.65 - 0.80
	IMMERSION TIN	0.81-0.86 (0.85 DRILL)	0.025 - 0.050	--	0.9 - 1.5um	0.70 - 0.80
	COPPER	0.81-0.86 (0.85 DRILL)	0.025 - 0.050	--	--	0.70 - 0.80

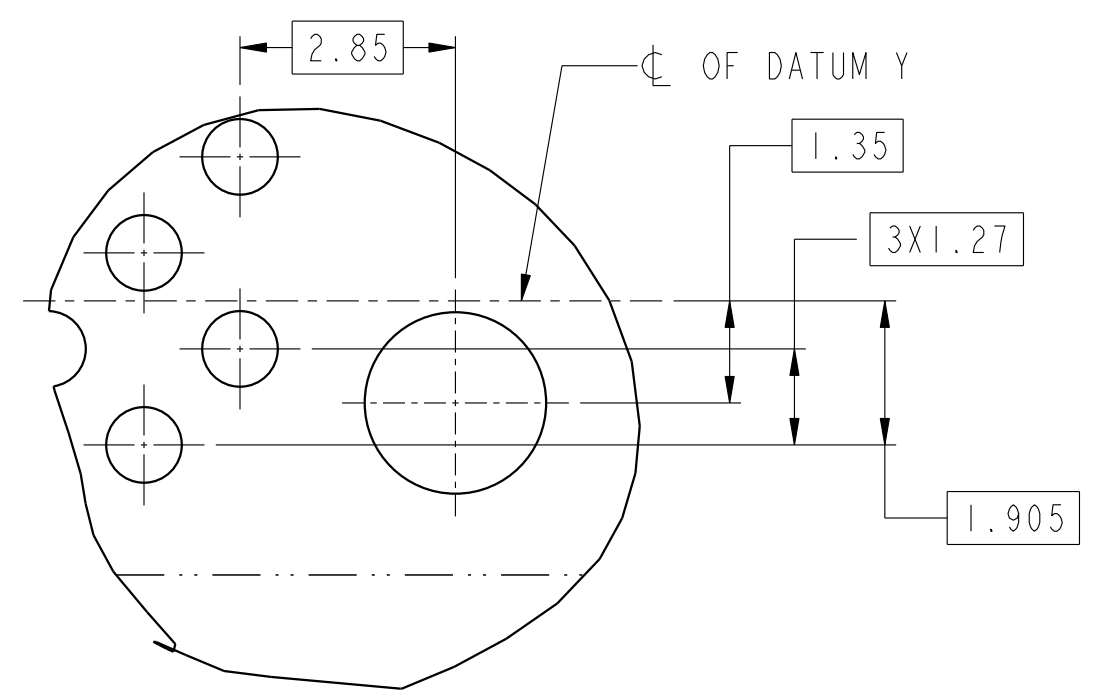
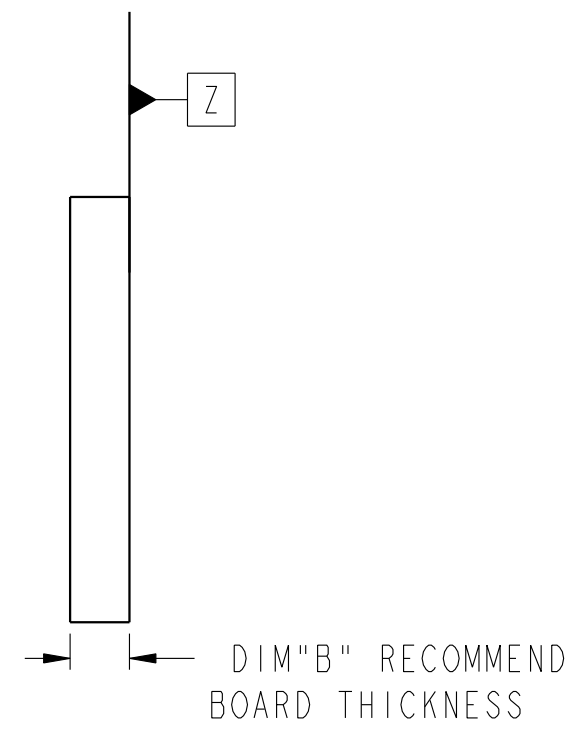
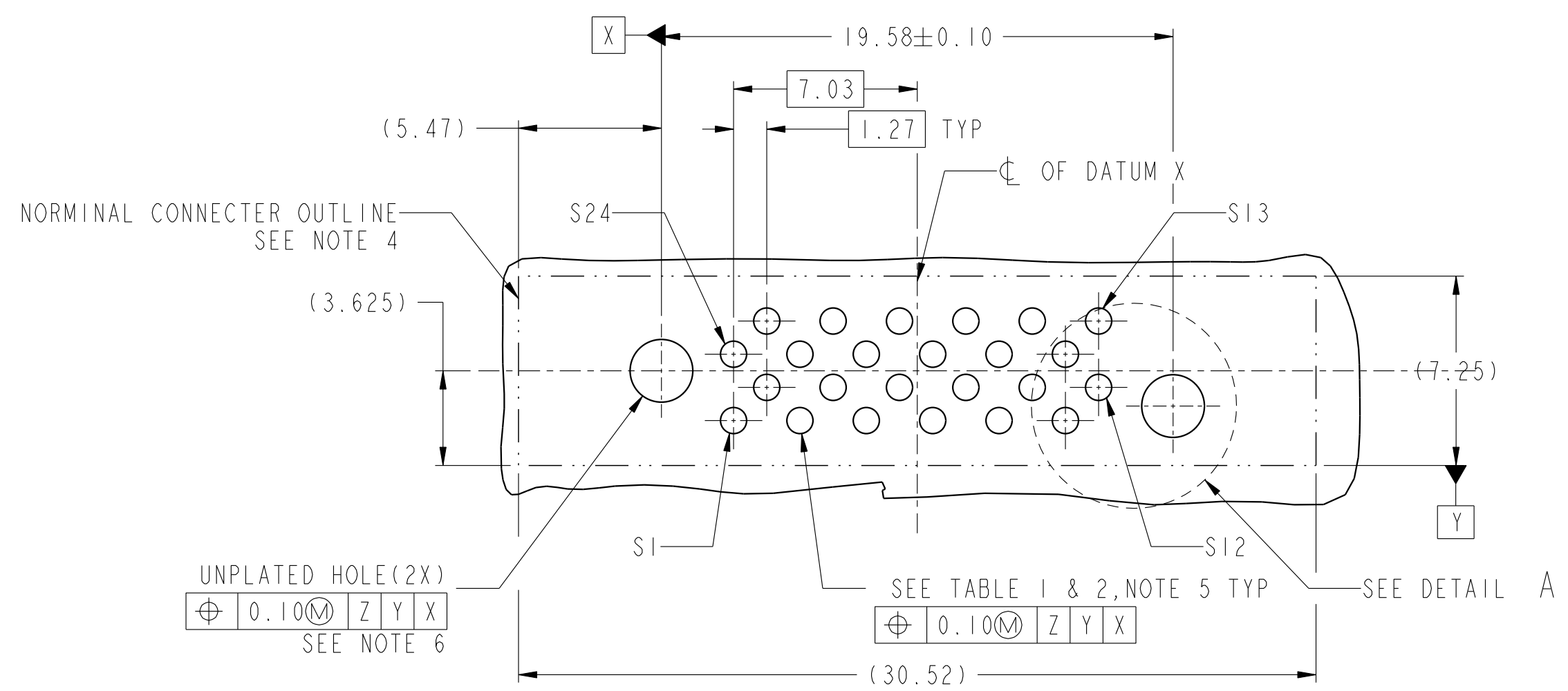

DETAIL A  
SCALE 10:1

spec ref	-	dr	Leborn Luo	2017/09/11	projection	mm	size	A2	scale	5:1	
tolerance std	ISO 406 ISO 1101	eng	Leborn Luo	2017/12/05			ecn no	-	rel level	Released	
surface	ISO 1302	chr	Fancy Zhang	2017/12/04			product family	-		rel level	Released
		appr	Pei-Ming Zheng	2017/12/05	<b>Amphenol FCI</b>		title	HPCE BTB VERT REC 24S(WITH GUIDE POST)		cat. no. - Product - Customer Drw	
							dwg no	10145311		rev	A

HPCE PART NUMBER (TABLE 3)

PART NUMBER	TAIL TYPE	DIM "A"±0.25 TAIL LENGTH	DIM "B" RECOMMENDED BOARD THICKNESS
10145311-001LF	STB	3.17	2.36±0.13
10145311-002LF	PF		1.57 MIN
10145311-003LF	STB	3.75	3.20±0.18

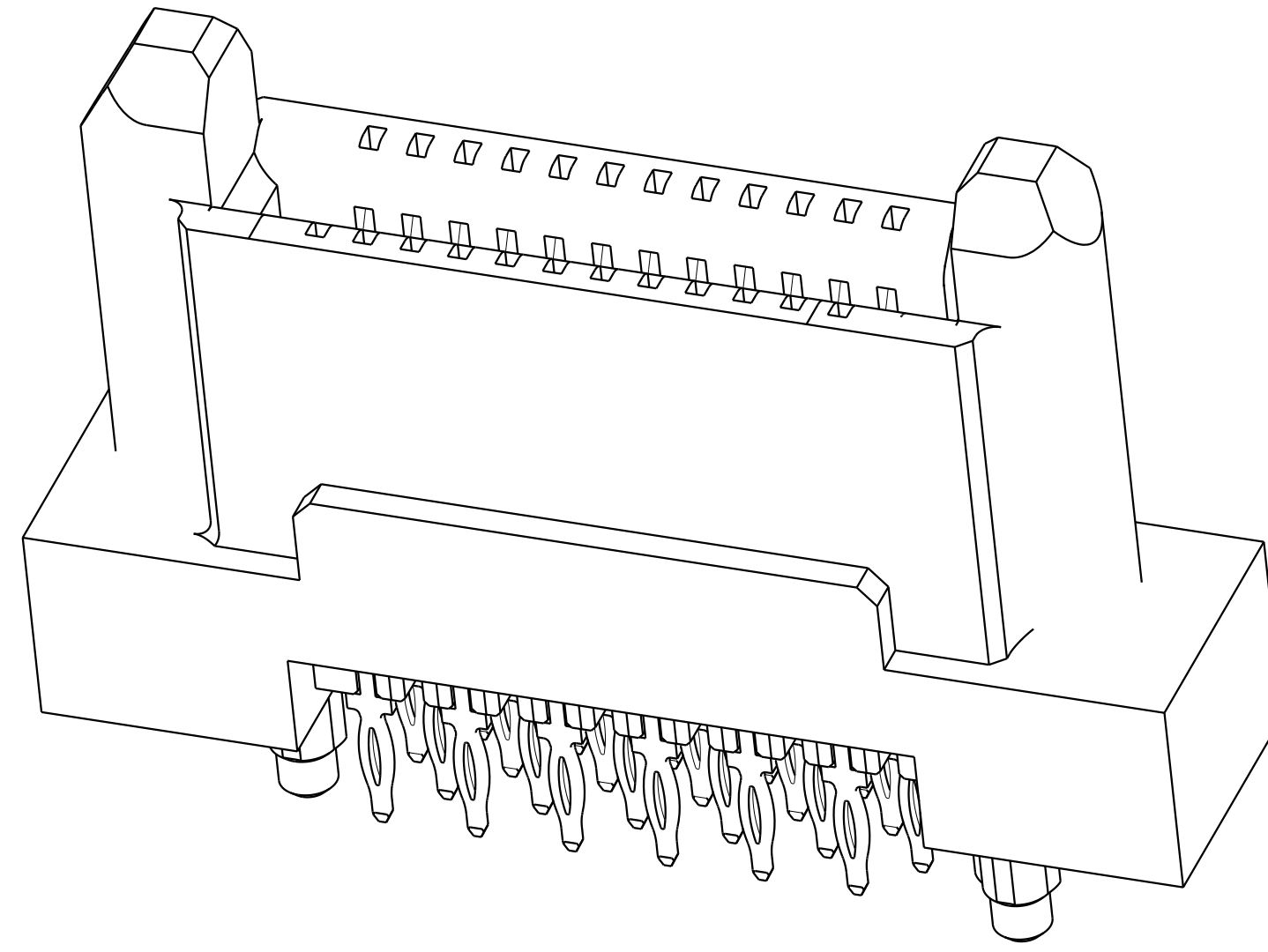

NOTES:

- ① PRODUCT MARK:  
PART NUMBER AND DATE CODE TO BE MARKED ON THIS SURFACE .  
THE MARK CAN BE OMITTED IF THERE IS NOT ENOUGH SPACE ON THIS SURFACE.
2. MATERIALS:  
-HOUSING : HIGH TEMPERATURE THERMOPLASTIC WITH GLASS FIBER, UL94V-0, BLACK.  
-CONTACT : COPPER ALLOY.
3. CONTACT FINISH REF: GS-12-1031 SECTION TBD.
- ④ DENOTES CONNECTOR KEEP OUT ZONE.
- ⑤ ALL HOLE DIAMETERS ARE FINISHED HOLE SIZES.
- ⑥ MOUNTING HOLES ARE UNPLATED  
 $\varnothing 2.18 \pm 0.03$  FOR SOLDER TAILS  
 $\varnothing 2.40 \pm 0.10$  FOR PRESS-FIT TAILS
7. THE HOUSING WILL WITHSTAND EXPOSURE TO 245°C PEAK TEMPERATURE FOR 10 SECONDS  
IN A WAVE SOLDER APPLICATION.
8. THIS PRODUCT MEETS EUROPEAN UNION DIRECTIVES AND OTHER COUNTRY  
REGULATIONS AS DESCRIBED IN GS-47-0004.
9. PRESS FIT APPLICATION TOOL DRAWING : 10125182.
10. PRODUCT SPECIFICATION : GS-12-1125.  
APPLICATION SPECIFICATION : GS-20-0388.  
PACKAGING SPECIFICATION: GS-14-2272.

spec ref	-	dr	Leborn Luo	2017/09/11	projection	mm	size	A2	scale	5:1	
tolerance std	ISO 406 ISO 1101	eng	Leborn Luo	2017/12/05			ecn no	-			
TOLERANCES UNLESS OTHERWISE SPECIFIED		chr	Fancy Zhang	2017/12/04			rel level	Released			
surface	linear	appr	Pei-Ming Zheng	2017/12/05	product family	-	cat. no.	HPCE BTB VERT REC	24S(WITH GUIDE POST)	rev	A
ISO 1302	angular				Product - Customer Drw	sheet 3 of 3					