

**SAW Filter 1601.0MHz**

**Model: TA0550A**

**Part No: MP05145**

**Rev No: 1**

**A. MAXIMUM RATING:**

Electrostatic Sensitive Device (ESD)

1. Input Power Level: 10dBm
2. DC Voltage: 3V
3. Operating Temperature: -55°C to +85°C
4. Storage Temperature: -55°C to +85°C

**B. ELECTRICAL CHARACTERISTICS: (By 20°C)**

1. Terminating source impedance (single ended):  $Z_S = 50\Omega$
2. Terminating load impedance (single ended):  $Z_L = 50\Omega$

Item	Unit	Min.	Typ.	Max.	Note
Center Frequency Fc	MHz	-	1601	-	-
Min. Insertion Loss IL	dB	-	3.4	5	-
Amplitude Ripple (1593 ~ 1609MHz)	dB	-	1.1	1.5	-
Group Delay Ripple (1593 ~ 1609MHz)	ns	-	9	15	-
VSWR (1593 ~ 1609MHz)		-	1.9	2.2	-
Relative Attenuation (relative to 0dB)					
DC ~ 1560MHz	dB	35	50	-	-
1563 ~ 1580MHz	dB	11	16.5	-	-
1622 ~ 1650MHz	dB	11	20.5	-	-
1650 ~ 3000MHz	dB	35	43.5	-	-

Deviation of Center and Bounder Frequencies in temperature range from -55°C to +85°C by TCD = -35ppm / grad.

**SAW Filter 1601.0MHz**  
**Part No: MP05145**

**Model: TA0550A**  
**Rev No: 1**

**C. OUTLINE DRAWING:**

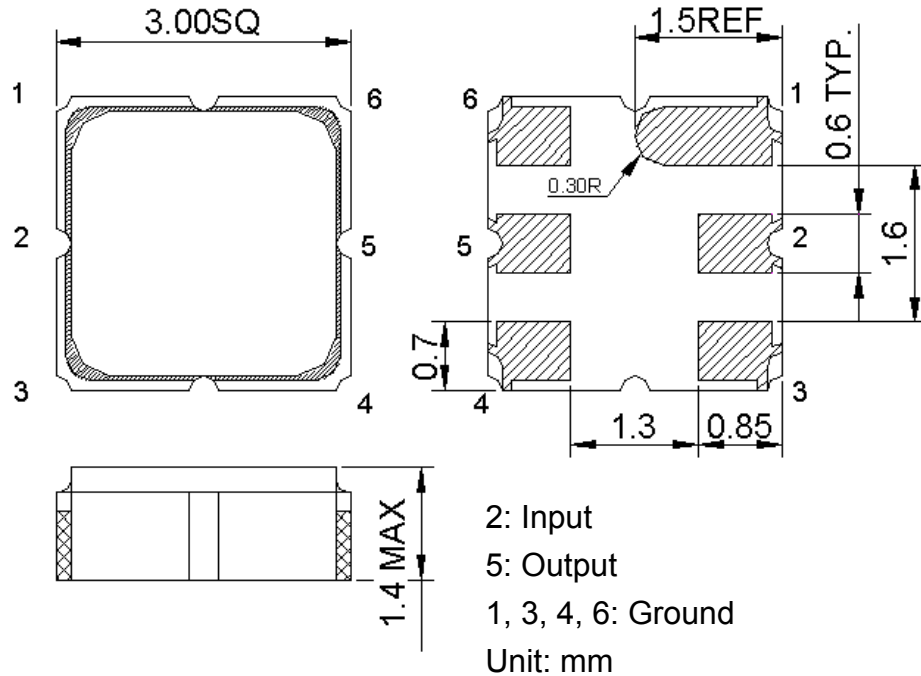

**D. MEASUREMENT CIRCUIT:**

HP Network analyzer

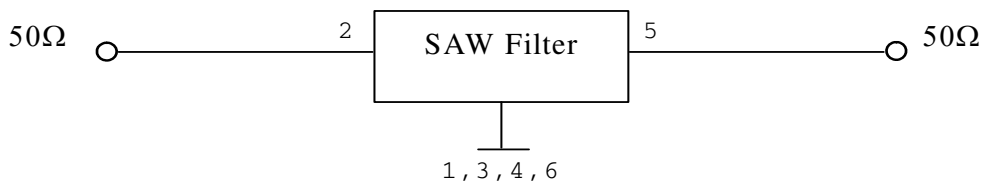

**E. PCB FOOTPRINT:**

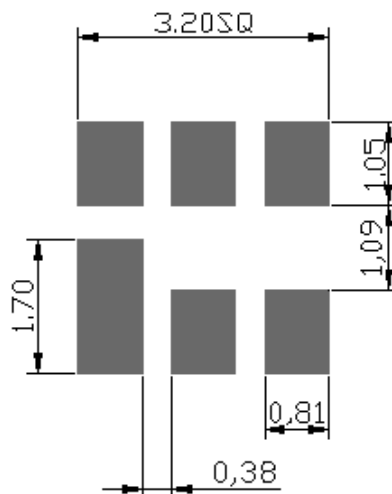

**SAW Filter 1601.0MHz**  
**Part No: MP05145**

**Model: TA0550A**  
**Rev No: 1**

**F. FREQUENCY CHARACTERISTICS:**

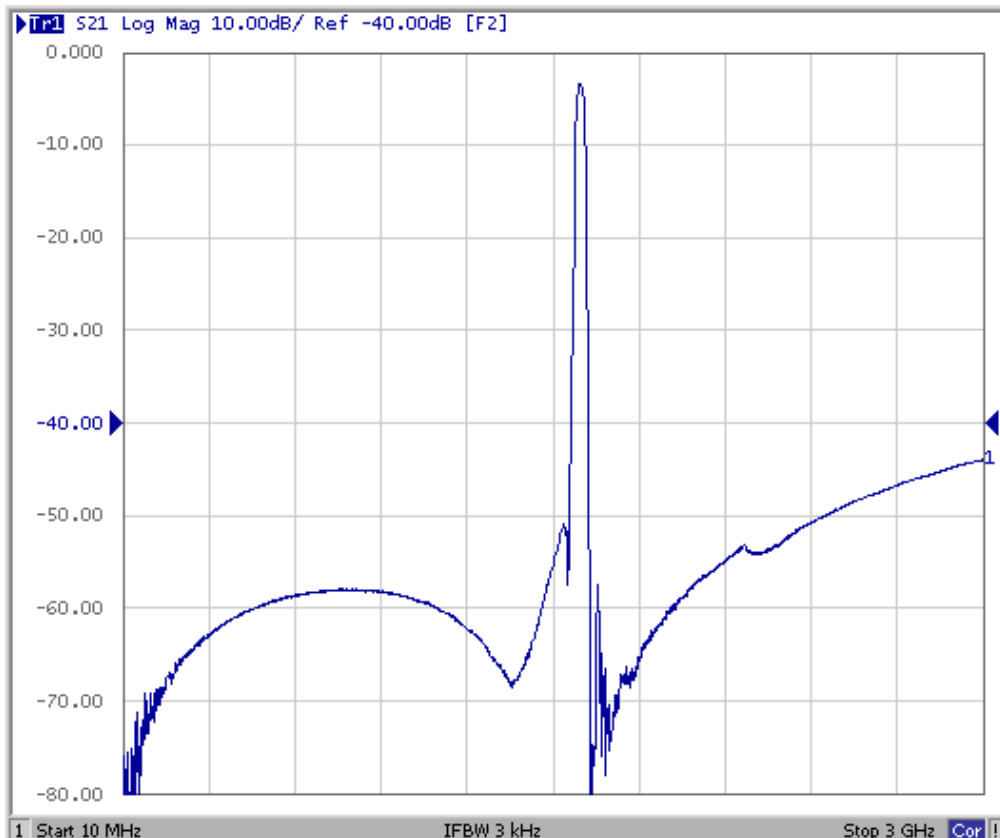
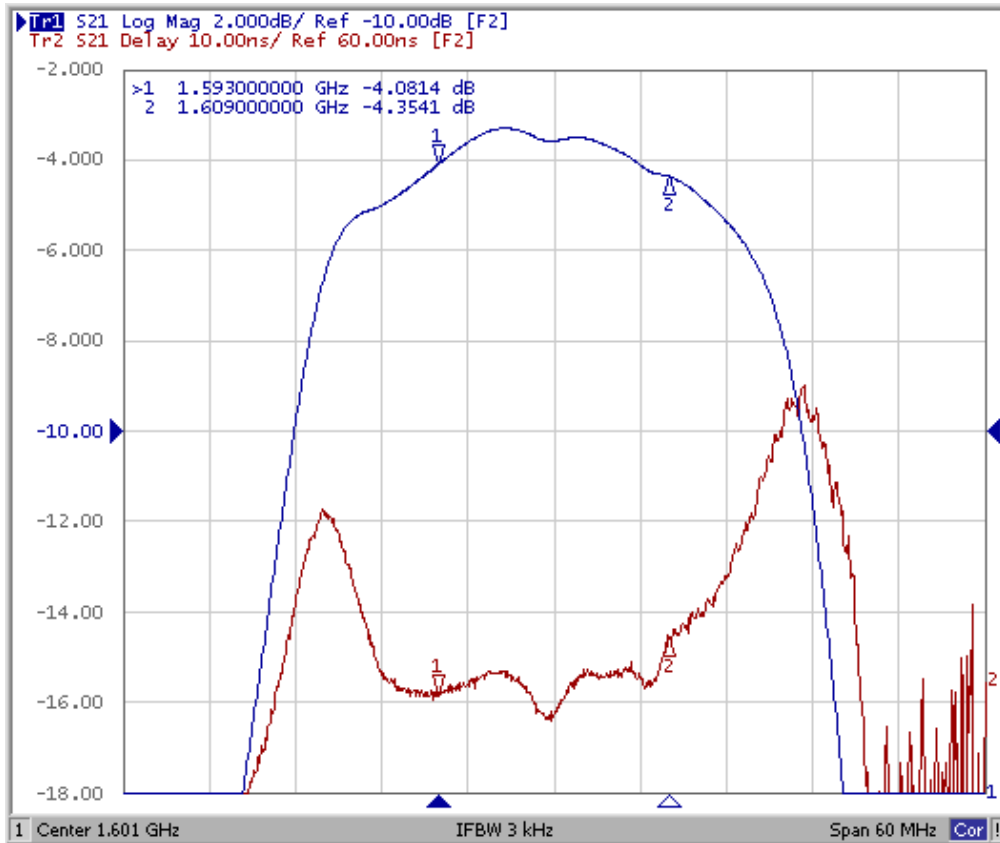

**SAW Filter 1601.0MHz**  
**Part No: MP05145**

**Model: TA0550A**  
**Rev No: 1**

Reflections Functions

S11 VSWR

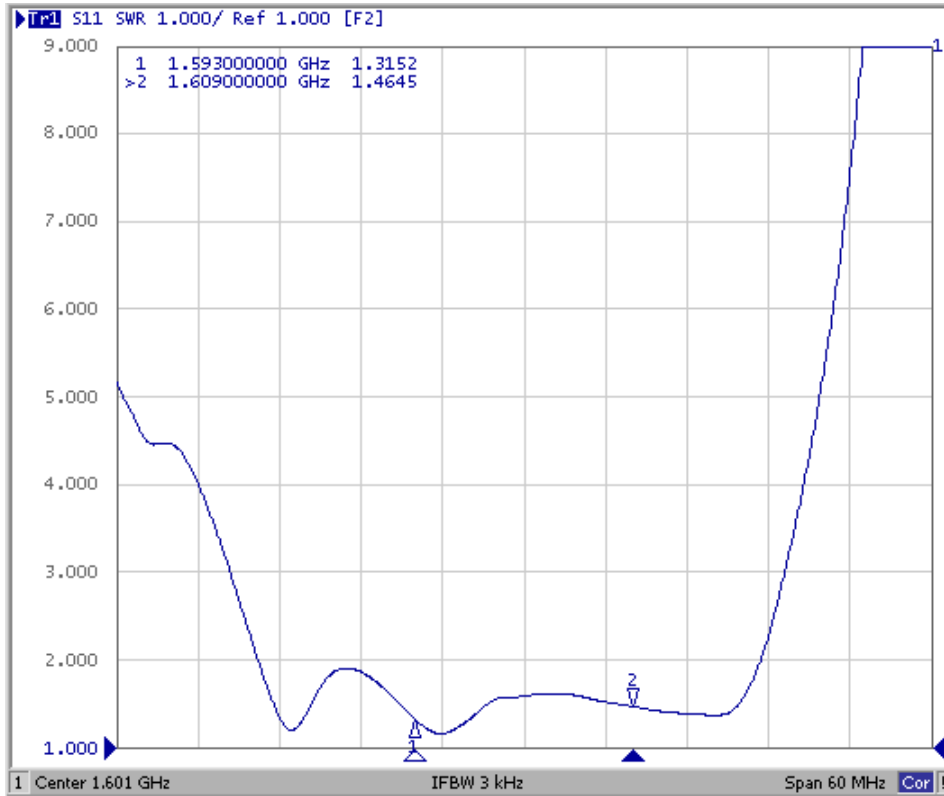

S22 VSWR

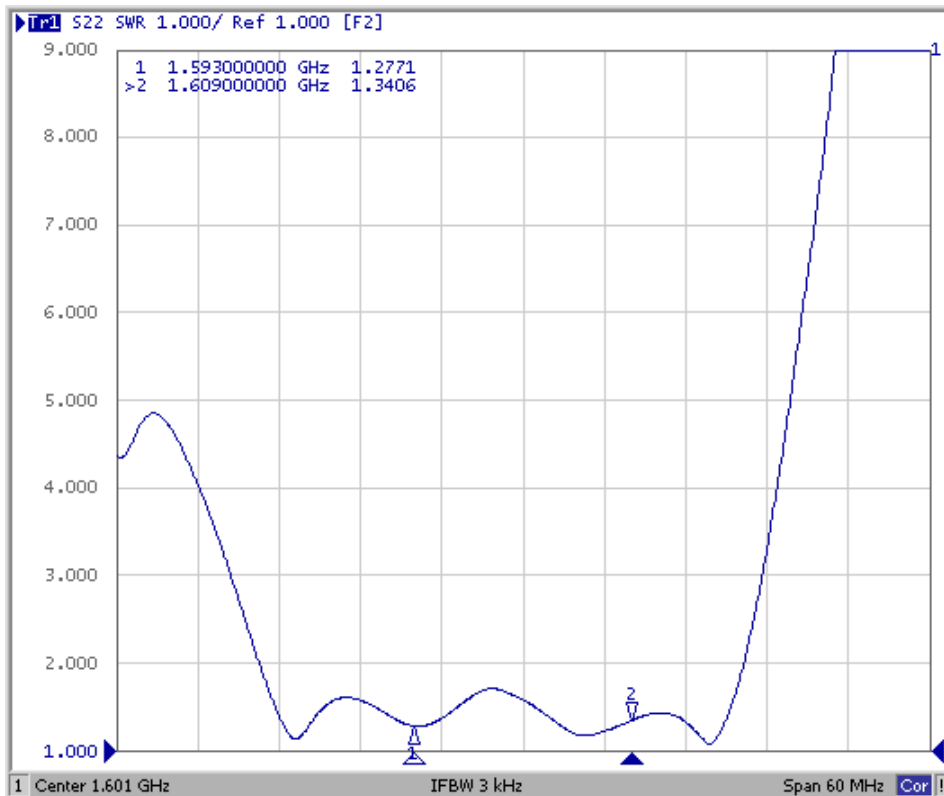

**SAW Filter 1601.0MHz**  
**Part No: MP05145**

**Model: TA0550A**  
**Rev No: 1**

**G. PACKING:**

1. Reel Dimension (Please refer to FR-75D10 for packing quantity)

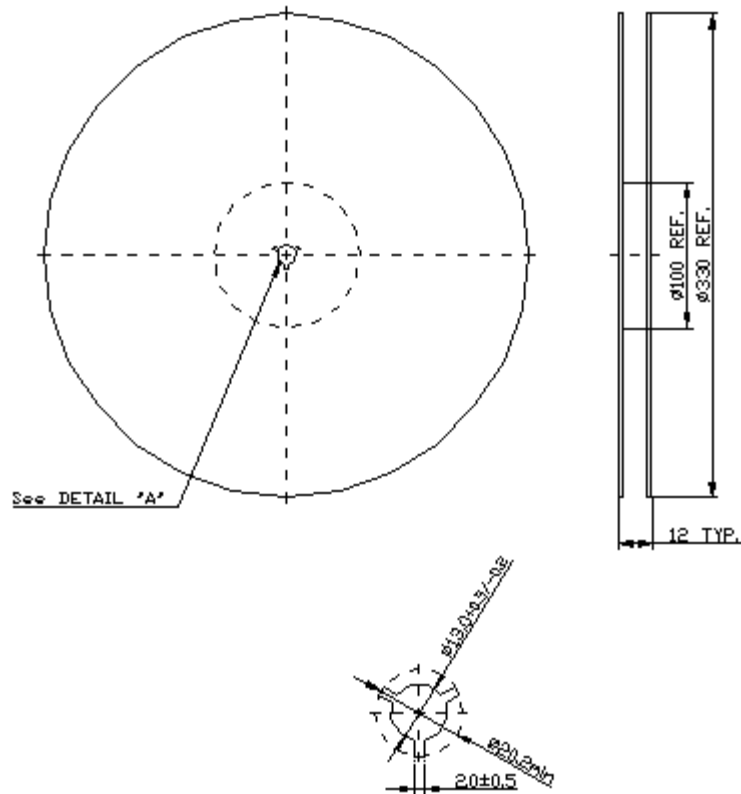

2. Tape Dimension

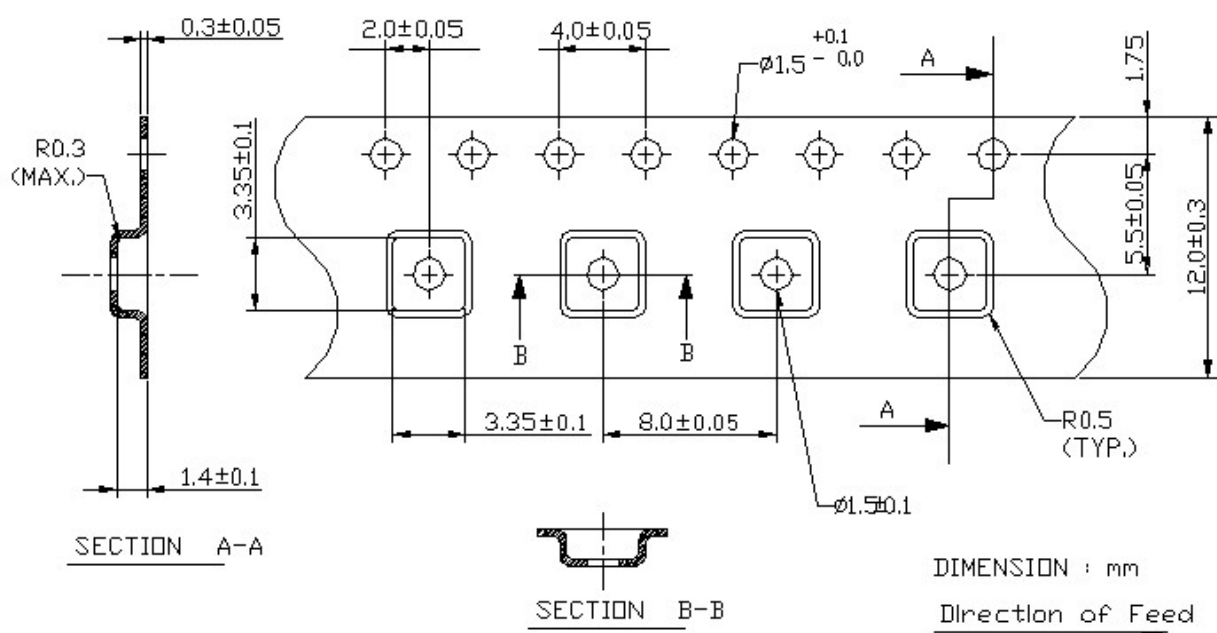

**SAW Filter 1601.0MHz**  
**Part No: MP05145**

**Model: TA0550A**  
**Rev No: 1**

**H. RECOMMENDED REFLOW PROFILE:**

1. Preheating shall be fixed at 150 ~ 180°C for 60 ~ 90 seconds.
2. Ascending time to preheating temperature 150°C shall be 30 seconds min.
3. Heating shall be fixed at 220°C for 50 ~ 80 seconds and at 245 ~ 260°C peak (min. 10 sec).
4. Time: 2 times.

