

# Printed-circuit board connector - DMC 1,5/11-G1F-3,5-LRP20THRR72 - 1706065

Please be informed that the data shown in this PDF Document is generated from our Online Catalog. Please find the complete data in the user's documentation. Our General Terms of Use for Downloads are valid (<http://phoenixcontact.com/download>)



Header, Nominal current: 8 A, Rated voltage (III/2): 160 V, Number of positions: 11, Pitch: 3.5 mm, Color: black, Contact surface: Tin, Mounting: THR soldering

The figure shows a 10-pos. version with 20 contacts

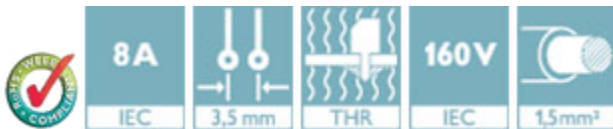

## Key Commercial Data

|                        |          |
|------------------------|----------|
| Packing unit           | 1 pc     |
| Minimum order quantity | 180 pc   |
| Custom tariff number   | 85366990 |
| Country of origin      | Germany  |

## Technical data

|                     |                                       |
|---------------------|---------------------------------------|
| Product type        | PCB headers                           |
| Approval            | VDE report with production monitoring |
|                     | IECEE CB Scheme                       |
|                     | cULus Recognized                      |
|                     | EAC                                   |
| Rated voltage (IEC) | 160                                   |
| Rated current (IEC) | 8                                     |
| Mounting type       | THR soldering                         |
| Number of positions | 11                                    |
| Pitch               | 3.5 mm                                |
| Levels              | double-level                          |
| Type of locking     | Lock & release threaded flange        |
| Plug-in system      | MINI COMBICON - DFMC 1,5              |

# Printed-circuit board connector - DMC 1,5/11-G1F-3,5-LRP20THRR72 - 1706065

## Technical data

|                |                    |
|----------------|--------------------|
| Product family | DMC 1,5/...G1F-THR |
| Contact type   | Male connector     |

## Classifications

### eCl@ss

|            |          |
|------------|----------|
| eCl@ss 4.0 | 272607xx |
| eCl@ss 4.1 | 27260701 |
| eCl@ss 5.0 | 27260701 |
| eCl@ss 5.1 | 27260701 |
| eCl@ss 6.0 | 27260704 |
| eCl@ss 7.0 | 27440402 |
| eCl@ss 8.0 | 27440402 |
| eCl@ss 9.0 | 27440402 |

### ETIM

|          |          |
|----------|----------|
| ETIM 3.0 | EC001121 |
| ETIM 4.0 | EC002637 |
| ETIM 5.0 | EC002637 |

### UNSPSC

|               |          |
|---------------|----------|
| UNSPSC 6.01   | 30211810 |
| UNSPSC 7.0901 | 39121409 |
| UNSPSC 11     | 39121409 |
| UNSPSC 12.01  | 39121409 |
| UNSPSC 13.2   | 39121409 |

## Approvals

### Approvals

---

#### Approvals

VDE Gutachten mit Fertigungsüberwachung / IECCE CB Scheme / cULus Recognized / EAC

---

#### Ex Approvals

---

# Printed-circuit board connector - DMC 1,5/11-G1F-3,5-LRP20THRR72 - 1706065

## Approvals

Approvals submitted

### Approval details

|   |       |
|---|-------|
| VDE Gutachten mit Fertigungsüberwachung  |       |
| Nominal current IN  | 8 A   |
| Nominal voltage UN  | 160 V |

|   |       |
|---|-------|
| IECEE CB Scheme  |       |
| Nominal current IN  | 8 A   |
| Nominal voltage UN  | 160 V |

|                    |       |      |
|--------------------|-------|------|
| cULus Recognized   |       |      |
|                    | B     | C    |
| Nominal current IN | 8 A   | 8 A  |
| Nominal voltage UN | 150 V | 50 V |

|     |
|-----|
| EAC |
|-----|

## Drawings

# Printed-circuit board connector - DMC 1,5/11-G1F-3,5-LRP20THRR72 - 1706065

Schematic diagram

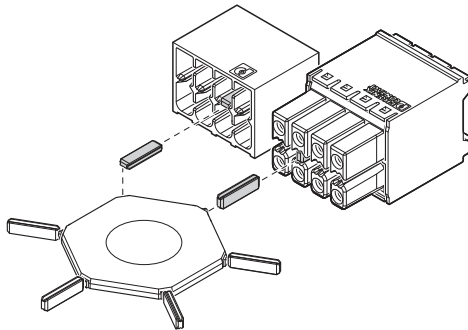

Drilling diagram

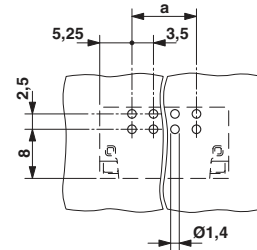

Use of the CP-DMC... coding profile

Diagram

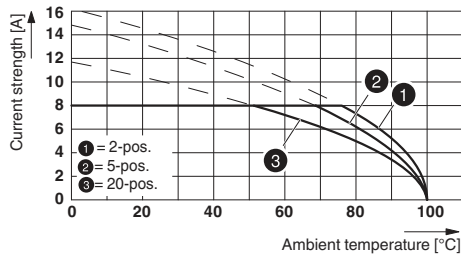

Dimensional drawing

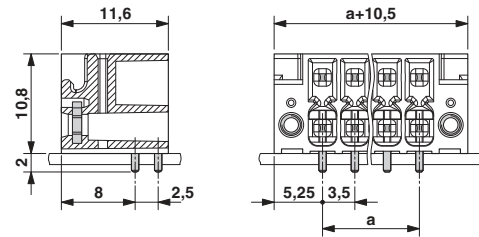

Schematic diagram

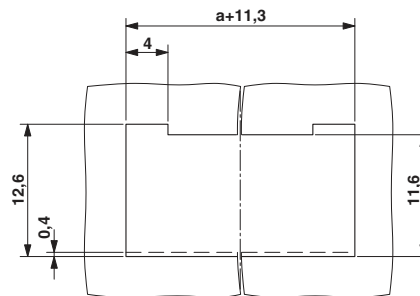

Panel cutout