

CAD FILE S90319X1.DGN SD 90319-****

DO NOT SCALE DRAWING

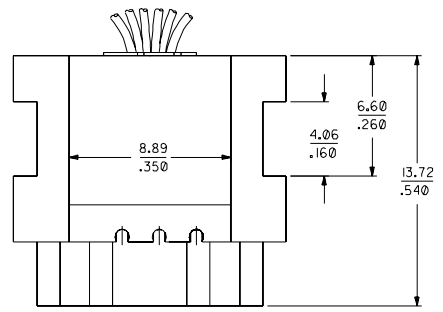

NOTES :
 1. JACK TO ACCEPT STANDARD W.E. AND W.E. TYPE PLUGS.
 2. FOR DIMENSIONS CONTACT GEOMETRY, SEE ES-87032.
 3. PLATING :
 CODE 1 : 1.27µM/50µIN. MIN. HARD GOLD IN CONTACT AREA OVER 2.54µM/100µIN. MIN. NICKEL OVERALL
 CODE 2 : 0.76µM/30µIN. MIN. HARD GOLD IN CONTACT AREA OVER 2.54µM/100µIN. MIN. NICKEL OVERALL
 CODE 3 : 0.38µM/15µIN. MIN. HARD GOLD IN CONTACT AREA OVER 2.54µM/100µIN. MIN. NICKEL OVERALL
 CODE 4 : 0.127µM/5µIN. MIN. HARD GOLD IN CONTACT AREA OVER 2.54µM/100µIN. MIN. NICKEL OVERALL
 CODE 5 : 0.51µM/20µIN. MIN. HARD GOLD IN CONTACT AREA OVER 2.54µM/100µIN. MIN. NICKEL OVERALL
 4. FOR L EXCESS 500MM, SEE TOLERANCES ON PART NO TABLE.

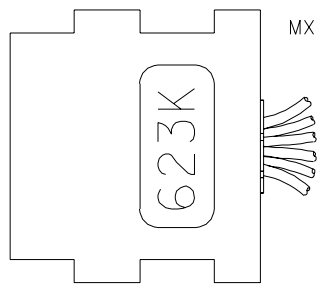
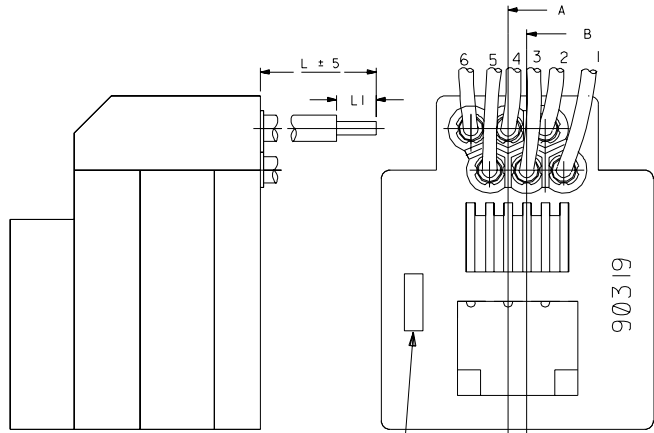
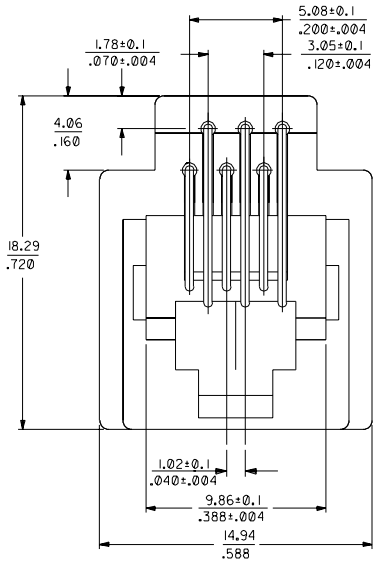

HOUSING WITH KEYS AND SLOTS

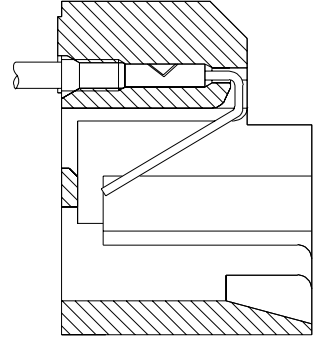
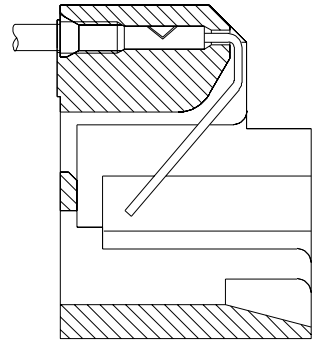

SECTION A - A

SECTION B - B

UL 1863 STRAIGHT OPTION

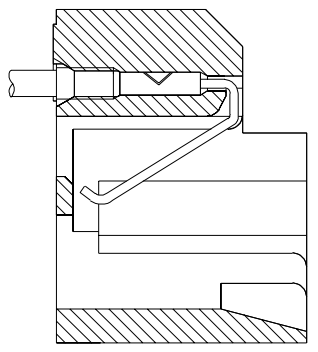
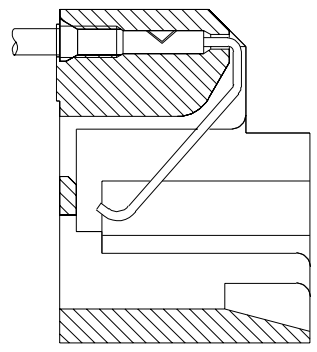

SECTION A - A

SECTION B - B

UL 1863 HOOK OPTION

MM
INCH

9 0 3 1 9 - * * * *

CONFIGURATION

- 0 - UL 1863 STRAIGHT OPTION
- 7 - UL 1863 HOOK OPTION

REV	J	P
SHT	1	2

J	REDUCE DWG TO 2 SHT.	S50440	JACK	950309
H	REVISED PER ECN*	S30333	LEE ANG	930119
G	REVISED PER ECN*	S2565	JACK ANG	920528
F	DRAWING AS PER ECN*	S1412	ANG JOE	910226
LTR	REVISION RECORD	ECN	DR	DATE
			CHK	

MATERIAL :
 HOUSING : ABS 94V-0 GREY DR BEIGE
 CONTACT : PHOSPHOR BRONZE C51000
 WIRES : UL1007 AWG26 05-1

FINISH :
 SEE ABOVE

DRAWN BY : 910226 ANG G W
 APPR'D BY : 920601 RWONG

CHK'D BY : 910601 JOEY NG
 SCALE : _____

MOLEX SINGAPORE PTE LTD
 SHEET 1 OF 2

GENERAL TOLERANCES : ± 0.20 / 0.008

DWG. NO. : SD 90319-****

TITLE : JACK TELEPHONE (623K) ASS'Y

REVISE ONLY ON CAD SYSTEM

DWG. NO. SD 1 90319-*****
 CAD FILE S90319X2.DGN

V

DO NOT SCALE DRAWING

PART NO	DIM "L"	DIM "L1"	WIRE 1	WIRE 2	WIRE 3	WIRE 4	WIRE 5	WIRE 6	NOS OF WIRE	HOUSING	PLATING
90319-0001	80	10.00±2.00	---	YELLOW	GREEN	RED	BLACK	---	4	90319-1011	CODE 1
90319-0002	80	10.00±2.00	---	---	GREEN	RED	---	---	2	90319-1011	CODE 1
90319-0003	170	10.00±2.00	---	---	GREEN	RED	---	---	2	90319-1011	CODE 1
90319-0004	80	10.00±2.00	---	---	GREEN	RED	---	---	2	90319-1012	CODE 1
90319-0005	80	10.00±2.00	BLUE	BLACK	RED	GREEN	YELLOW	WHITE	6	90319-1011	CODE 1
90319-0006	440	10.00±2.00	---	---	GREEN	RED	---	---	2	90319-1011	CODE 1
90319-0007	30	4.70±1.00	BLUE	BLACK	RED	GREEN	YELLOW	WHITE	6	90319-1011	CODE 1
90319-0008	200	3.00±0.40	---	---	RED	GREEN	---	---	2	90319-1011	CODE 1
90319-0009	200	3.00±0.40	---	---	YELLOW	BLUE	---	---	2	90319-1011	CODE 1
90319-0010	400	3.00±0.40	---	---	RED	GREEN	---	---	2	90319-1011	CODE 1
90319-0021	80	10.00±2.00	---	YELLOW	GREEN	RED	BLACK	---	4	90319-1011	CODE 4
90319-0022	80	10.00±2.00	---	---	GREEN	RED	---	---	2	90319-1011	CODE 4
90319-0023	80	10.00±2.00	BLUE	BLACK	RED	GREEN	YELLOW	WHITE	6	90319-1011	CODE 4
90319-0024	90	---	---	YELLOW	---	---	BLACK	---	2	90319-1011	CODE 4
90319-0025	170	10.00±2.00	BLUE	BLACK	RED	GREEN	YELLOW	WHITE	6	90319-1011	CODE 4
90319-0031	80	10.00±2.00	---	YELLOW	GREEN	RED	BLACK	---	4	90319-1011	CODE 2
90319-0032	80	10.00±2.00	---	---	GREEN	RED	---	---	2	90319-1011	CODE 2
90319-0033	80	10.00±2.00	BLUE	BLACK	RED	GREEN	YELLOW	WHITE	6	90319-1011	CODE 2
90319-0034	---	---	---	---	---	---	---	---	---	---	---
90319-0035	---	---	---	---	---	---	---	---	---	---	---
90319-0036	30	4.70±1.00	BLUE	BLACK	RED	GREEN	YELLOW	WHITE	6	90319-1011	CODE 2
90319-0037	305	10.00±2.00	---	YELLOW	GREEN	RED	BLACK	---	4	90319-1011	CODE 2
90319-0038	235	5.00±1.00	---	YELLOW	GREEN	RED	BLACK	---	4	90319-1011	CODE 2
90319-0039	100	10.00±2.00	---	YELLOW	GREEN	RED	BLACK	---	4	90319-1011	CODE 2
90319-0040	193	3.00±0.50	BLUE	BLACK	RED	GREEN	YELLOW	WHITE	6	90319-1011	CODE 2
90319-0041	170	10.00±2.00	---	---	GREEN	RED	---	---	2	90319-1011	CODE 2
90319-0101	400	3.00±0.40	---	---	YELLOW	BLUE	---	---	2	90319-1011	CODE 1
90319-0102	105	2.50±0.40	---	YELLOW	GREEN	RED	BLACK	---	4	90319-1011	CODE 1
90319-0103	50	10.00±2.00	---	YELLOW	GREEN	RED	BLACK	---	4	90319-1011	CODE 1
90319-0104	40	4.00±1.00	BLUE	BLACK	RED	GREEN	YELLOW	WHITE	6	90319-1011	CODE 1
90319-0105	80	2.50±0.40	---	YELLOW	GREEN	RED	BLACK	---	4	90319-1011	CODE 1
90319-0106	100	5.00±0.50	---	YELLOW	GREEN	RED	BLACK	---	4	90319-1011	CODE 1
90319-0107	91	6.50±0.50	---	---	GREEN	RED	---	---	2	90319-1011	CODE 1
90319-0108	155	5.00±0.50	---	---	GREEN	RED	---	---	2	90319-1011	CODE 1
90319-0109	100	5.00±0.50	---	---	GREEN	RED	---	---	2	90319-1011	CODE 1
90319-0110	100	10.00±2.00	---	YELLOW	GREEN	RED	BLACK	---	4	90319-1011	CODE 1
90319-0111	65	10.00±2.00	---	---	GREEN	RED	---	---	2	90319-1012	CODE 5
90319-0112	2134±20.00	10.00±2.00	---	---	GREEN	RED	---	---	2	90319-1011	CODE 1
90319-0113	450	10.00±2.00	BLUE	BLACK	RED	GREEN	YELLOW	WHITE	6	90319-1011	CODE 2
90319-0114	170	10.00±2.00	---	YELLOW	GREEN	RED	BLACK	---	4	90319-1011	CODE 1
90319-7001	200	5.00±1.00	BLUE	BLACK	RED	GREEN	YELLOW	WHITE	6	90319-1011	CODE 1
90319-7002	80	10.00±2.00	---	---	GREEN	RED	---	---	2	90319-1011	CODE 1

						MATERIAL :		MOLEX SINGAPORE PTE LTD SHEET 2 OF 2	
						FINISH :			
P		REDUCE DWG TO 2 SHT.		S50440		JACK		950309	
LTR		REVISION RECORD		ECN		DR		DATE	
						DRAWN BY		CHK'D BY	
						J.WAN 950309		SCALE	
						APPR'D BY		NTS	
								GENERAL TOLERANCES ± 0.20/008	
								REV P	
								DWG. NO.1	
								SD 1 90319-****	
								TITLE :	
								JACK TELEPHONE (623K) ASS'Y	

REVISE ONLY ON CAD SYSTEM