

Base strip - IPCV 5/ 2-GF-7,62 - 1708938

Please be informed that the data shown in this PDF Document is generated from our Online Catalog. Please find the complete data in the user's documentation. Our General Terms of Use for Downloads are valid (<http://phoenixcontact.com/download>)



Header, Nominal current: 41 A, Rated voltage (III/2): 630 V, Number of positions: 2, Pitch: 7.62 mm, Color: green, Contact surface: Tin, Assembly: Soldering

The figure shows a 5-pos. version of the product

Product Features

- ✓ Asymmetrical arrangement of solder pins to prevent mismatching
- ✓ Inverted vertical IPC 5 headers for implementing a touch-proof PCB output or a PCB/PCB connection (in combination with PC 5 base strips)
- ✓ Maximum contact reliability due to integrated double steel spring



Key commercial data

| | |
|--------------------------------------|----------|
| Packing unit | 1 pc |
| Weight per Piece (excluding packing) | 7.31 GRM |
| Custom tariff number | 85366990 |
| Country of origin | Germany |

Technical data

Dimensions

| | |
|----------------|---------|
| Length | 12.8 mm |
| Pitch | 7.62 mm |
| Dimension a | 7.62 mm |
| Pin dimensions | 1,2x0,8 |
| Pin spacing | 7.62 mm |
| Hole diameter | 1.3 mm |

General

| | |
|-----------------------------|---------------|
| Range of articles | IPCV 5/...-GF |
| Insulating material group | I |
| Rated surge voltage (III/3) | 6 kV |

Base strip - IPCV 5/ 2-GF-7,62 - 1708938

Technical data

General

| | |
|---|--------|
| Rated surge voltage (III/2) | 6 kV |
| Rated surge voltage (II/2) | 6 kV |
| Rated voltage (III/3) | 630 V |
| Rated voltage (III/2) | 630 V |
| Rated voltage (II/2) | 1000 V |
| Connection in acc. with standard | EN-VDE |
| Nominal current I _N | 41 A |
| Maximum load current | 41 A |
| Insulating material | PA |
| Inflammability class according to UL 94 | V0 |
| Color | green |
| Number of positions | 2 |

Classifications

eCl@ss

| | |
|------------|----------|
| eCl@ss 4.0 | 272607xx |
| eCl@ss 4.1 | 27260701 |
| eCl@ss 5.0 | 27260701 |
| eCl@ss 5.1 | 27260701 |
| eCl@ss 6.0 | 27260704 |
| eCl@ss 7.0 | 27440402 |
| eCl@ss 8.0 | 27440402 |

ETIM

| | |
|----------|----------|
| ETIM 3.0 | EC001121 |
| ETIM 4.0 | EC002637 |
| ETIM 5.0 | EC002637 |

UNSPSC

| | |
|---------------|----------|
| UNSPSC 6.01 | 30211810 |
| UNSPSC 7.0901 | 39121409 |
| UNSPSC 11 | 39121409 |
| UNSPSC 12.01 | 39121409 |
| UNSPSC 13.2 | 39121409 |

Base strip - IPCV 5/ 2-GF-7,62 - 1708938

Approvals

Approvals

Approvals

UL Recognized / cUL Recognized / cULus Recognized

Ex Approvals

Approvals submitted

Approval details

| | | | | |
|--------------------------------|-------|-------|-------|---|
| UL Recognized | | | | |
| | | B | C | D |
| Nominal current I _N | 41 A | 41 A | 5 A | |
| Nominal voltage U _N | 300 V | 300 V | 600 V | |

| | | | | |
|--------------------------------|-------|-------|-------|---|
| cUL Recognized | | | | |
| | | B | C | D |
| Nominal current I _N | 41 A | 41 A | 5 A | |
| Nominal voltage U _N | 300 V | 300 V | 600 V | |

| | | | | |
|------------------|--|--|--|--|
| cULus Recognized | | | | |
|------------------|--|--|--|--|

Drawings

Base strip - IPCV 5/ 2-GF-7,62 - 1708938

Drilling diagram

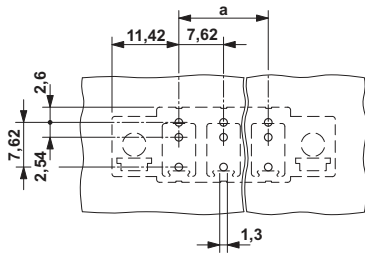

Dimensioned drawing

