

Base strip - MC 1,5/ 9-G-3,81 THT-R56 - 1943823

Please be informed that the data shown in this PDF Document is generated from our Online Catalog. Please find the complete data in the user's documentation. Our General Terms of Use for Downloads are valid (<http://phoenixcontact.com/download>)



Header, Nominal current: 8 A, Rated voltage (III/2): 160 V, Number of positions: 9, Pitch: 3.81 mm, Color: black, Contact surface: Tin, Assembly: Taped SMD/THT/THR components, User information and design recommendations for through hole reflow technology can be found under "Downloads"



Key commercial data

| | |
|--------------------------------------|----------|
| Packing unit | 1 pc |
| Minimum order quantity | 470 pc |
| Weight per Piece (excluding packing) | 3.57 GRM |
| Custom tariff number | 85366990 |
| Country of origin | Germany |

Technical data

Dimensions

| | |
|----------------|--------------|
| Length | 9.2 mm |
| Pitch | 3.81 mm |
| Dimension a | 30.48 mm |
| Pin dimensions | 0,8 x 0,8 mm |
| Hole diameter | 1.4 mm |

General

| | |
|-----------------------------|------------------|
| Range of articles | MC 1,5/...-G-THT |
| Insulating material group | IIIa |
| Rated surge voltage (III/3) | 2.5 kV |
| Rated surge voltage (III/2) | 2.5 kV |
| Rated surge voltage (II/2) | 2.5 kV |
| Rated voltage (III/3) | 160 V |
| Rated voltage (III/2) | 160 V |
| Rated voltage (II/2) | 250 V |

Base strip - MC 1,5/ 9-G-3,81 THT-R56 - 1943823

Technical data

General

| | |
|---|--------------------|
| Connection in acc. with standard | EN-VDE |
| Nominal current I_N | 8 A |
| Maximum load current | 8 A (per position) |
| Insulating material | PA-GF |
| Inflammability class according to UL 94 | V0 |
| Color | black |
| Number of positions | 9 |

Classifications

eCl@ss

| | |
|------------|----------|
| eCl@ss 4.0 | 272607xx |
| eCl@ss 4.1 | 27260701 |
| eCl@ss 5.0 | 27260701 |
| eCl@ss 5.1 | 27260701 |
| eCl@ss 6.0 | 27260704 |
| eCl@ss 7.0 | 27440402 |

ETIM

| | |
|----------|----------|
| ETIM 3.0 | EC001121 |
| ETIM 4.0 | EC002637 |
| ETIM 5.0 | EC002637 |

UNSPSC

| | |
|---------------|----------|
| UNSPSC 6.01 | 30211810 |
| UNSPSC 7.0901 | 39121409 |
| UNSPSC 11 | 39121409 |
| UNSPSC 12.01 | 39121409 |
| UNSPSC 13.2 | 39121409 |

Approvals

Approvals

Approvals

VDE Gutachten mit Fertigungsüberwachung / GOST / IECCEB Scheme / UL Recognized / cUL Recognized / GOST / CCA / cULus Recognized

Base strip - MC 1,5/ 9-G-3,81 THT-R56 - 1943823

Approvals

Ex Approvals

Approvals submitted

Approval details

| | |
|---|-------|
| VDE Gutachten mit Fertigungsüberwachung | |
| Nominal current I _N | 8 A |
| Nominal voltage U _N | 160 V |

| | |
|------|--|
| GOST | |
|------|--|

| | |
|--------------------------------|-------|
| IECEE CB Scheme | |
| Nominal current I _N | 8 A |
| Nominal voltage U _N | 160 V |

| | | |
|--------------------------------|-------|-------|
| UL Recognized | | |
| | B | D |
| Nominal current I _N | 8 A | 8 A |
| Nominal voltage U _N | 300 V | 300 V |

| | | |
|--------------------------------|-------|-------|
| cUL Recognized | | |
| | B | D |
| Nominal current I _N | 8 A | 8 A |
| Nominal voltage U _N | 300 V | 300 V |

Base strip - MC 1,5/ 9-G-3,81 THT-R56 - 1943823

Approvals

GOST

CCA

| | |
|--------------------------------|-------|
| Nominal current I _N | 8 A |
| Nominal voltage U _N | 160 V |

cULus Recognized

Drawings

Dimensioned drawing

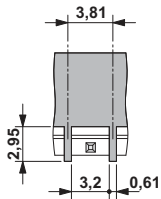

Drilling diagram

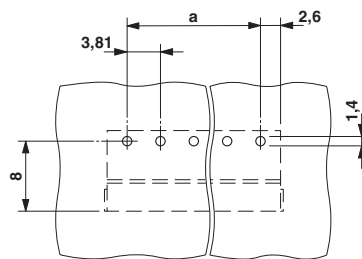

Dimensioned drawing

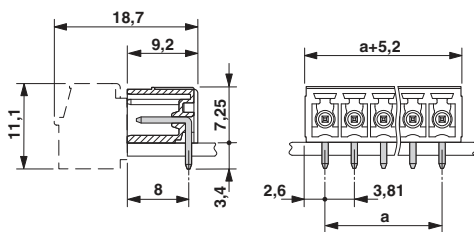

Dimensioned drawing

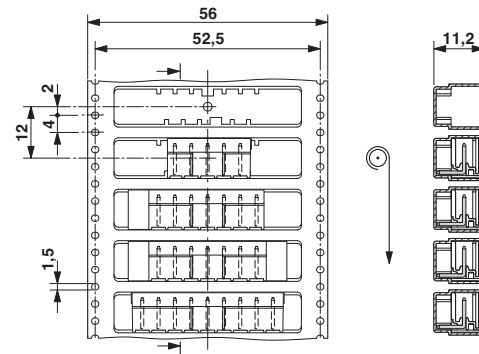

Base strip - MC 1,5/ 9-G-3,81 THT-R56 - 1943823

Dimensioned drawing

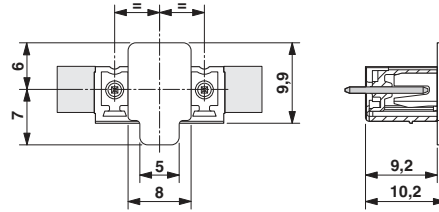

Dimensioned drawing

